

# FORM 1600

## SIMPLE SET RETROFIT INSTRUCTIONS

### Part No. SSW-R

The enclosed parts can be retrofitted to 1997 and newer non-remote Standard model sawmills. See the table below for specific applicable model/revision applications:

| Models | Revision |
|--------|----------|
| LT30   | F7.00+   |
| LT40   | F8.00+   |
| LT30HD | G1.00+   |
| LT40HD | G1.00+   |

### Pre-Installation Instructions

1. Use the sawmill controls to move the saw carriage so the hydraulic power strip (if applicable) is not engaged and raise the saw head to gain access to the battery box lid.
2. Turn the key switch to the OFF (#0) position and remove the key.
3. Remove the battery box cover and disconnect the negative battery terminal.



**WARNING!** Disconnect the negative battery terminal cable before performing any service to the 12-volt electrical system. Failure to do so may cause injury or electrical system damage.

See Figure 1.

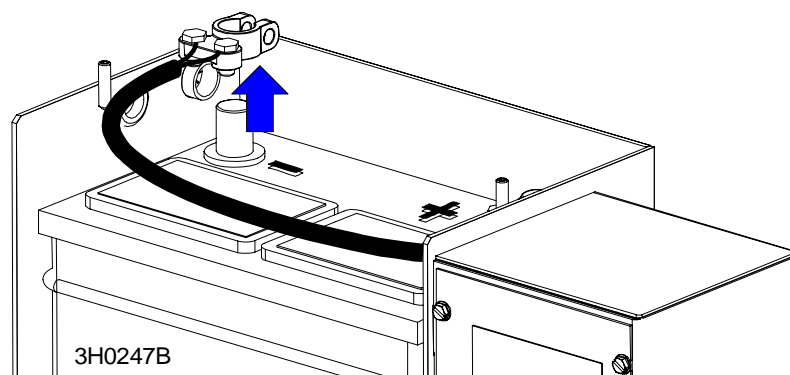
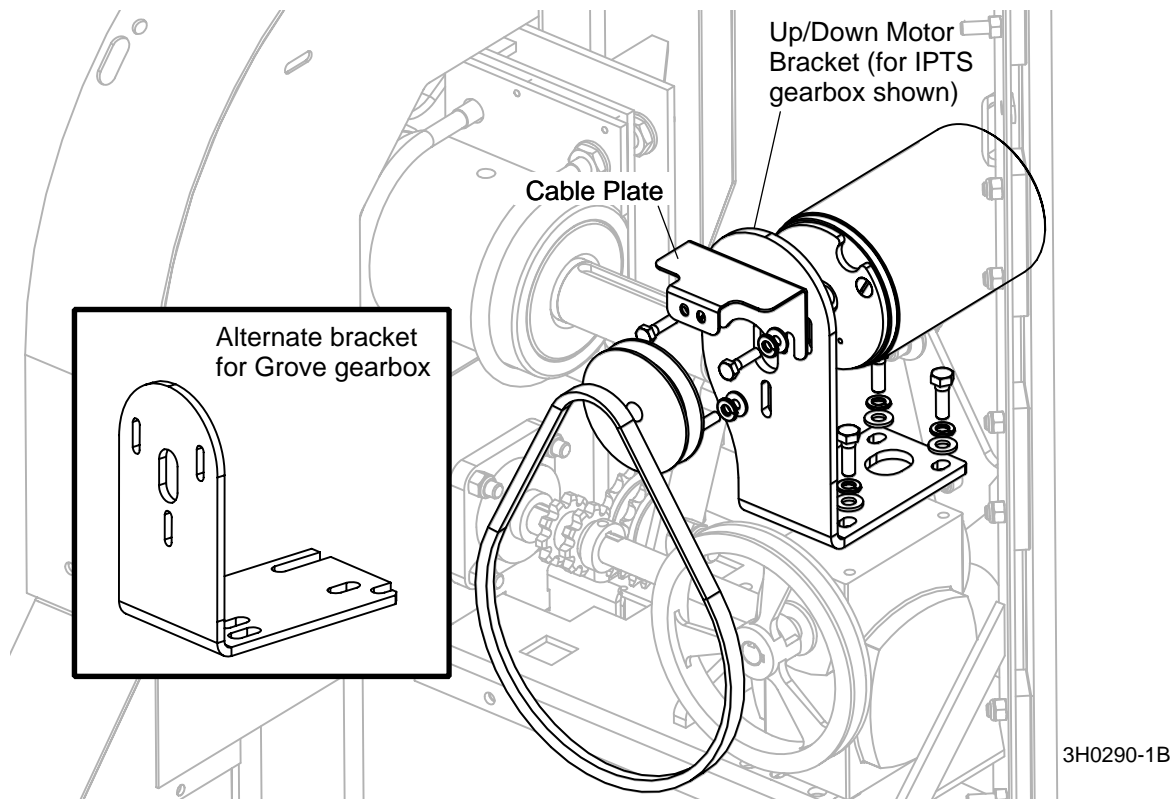

FIGURE 1

## Installation Instructions

1. Remove the drive belt housing cover to access the up/down drive system. Loosen the three up/down motor mount bolts and move the motor down to remove tension from the belt. Remove the belt, motor pulley and motor. Disassemble the up/down motor mount bracket from the gearbox and replace with the provided bracket. Be sure to use the appropriate bracket for the type of gearbox on your sawmill. Secure the bracket to the gearbox with the previously removed hardware.

See Figure 2.



**FIGURE 2**

See Figure 3.

- IPTS Gearbox Only:** Replace the gearbox pulley with the modified pulley provided.
- Reinstall the up/down motor, pulley & belt. Install the provided cable plate to the top two motor mount bolts. Push the motor up to tension the belt and tighten the motor mounting bolts.
- Install the shaft extension to the gearbox shaft. Secure the extension with the 1/4-20 x 1/2" set screw provided (Grove gearbox) or the two #8-32 x 1" flat head screws provided (IPTS gearbox).
- Assemble the sensor assembly to the up/down motor bracket with the two 5/16" bolts, lock washers and flat washers provided. Adjust the brackets using the slotted mounting holes to position the assembly so the shaft extension is inserted into the hole in the sensor assembly. Tighten the mounting bolts.
- Plug the provided sensor cable into the receptacle on the sensor assembly. Secure the cable to the bracket with a provided wire tie. Route the cable along the existing control box harness and secure with provided wire ties. Be sure the cable is clear of moving parts to avoid damage and has enough slack to move freely with saw head travel.

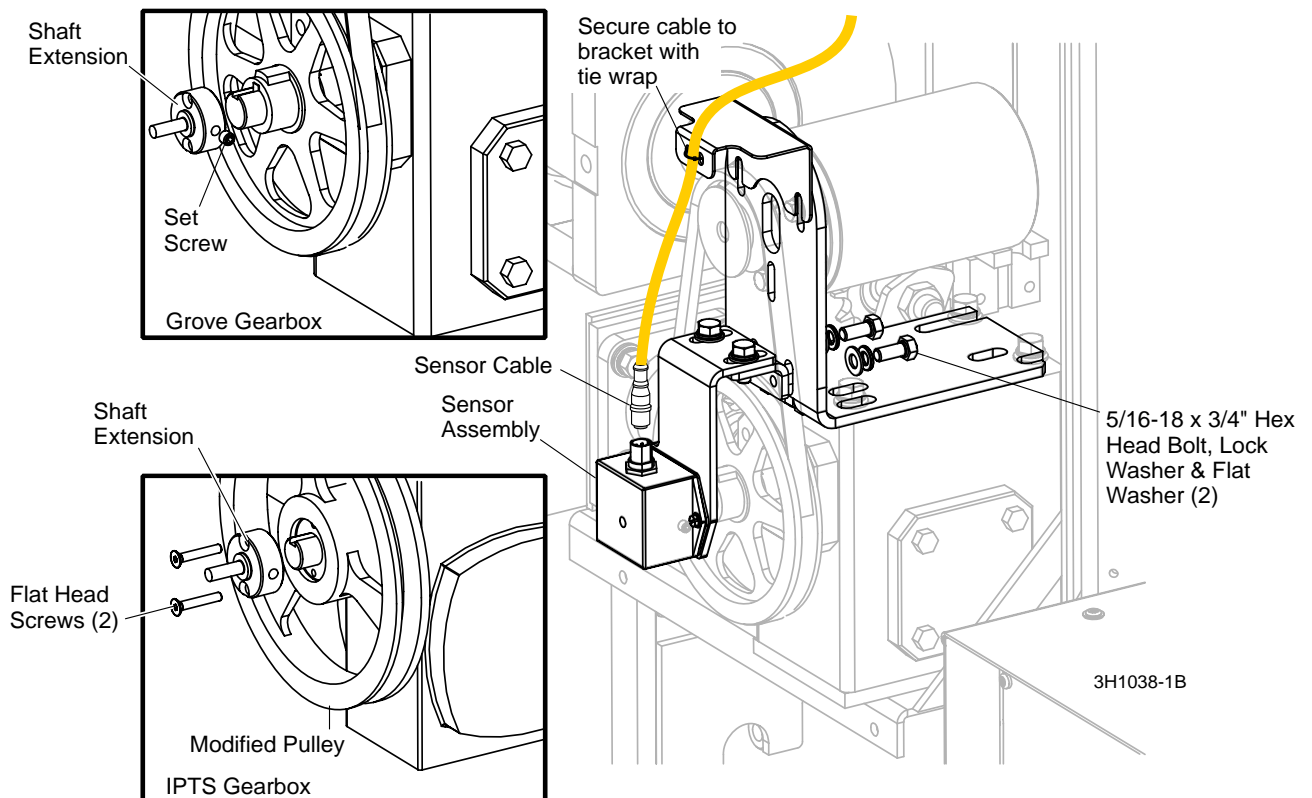
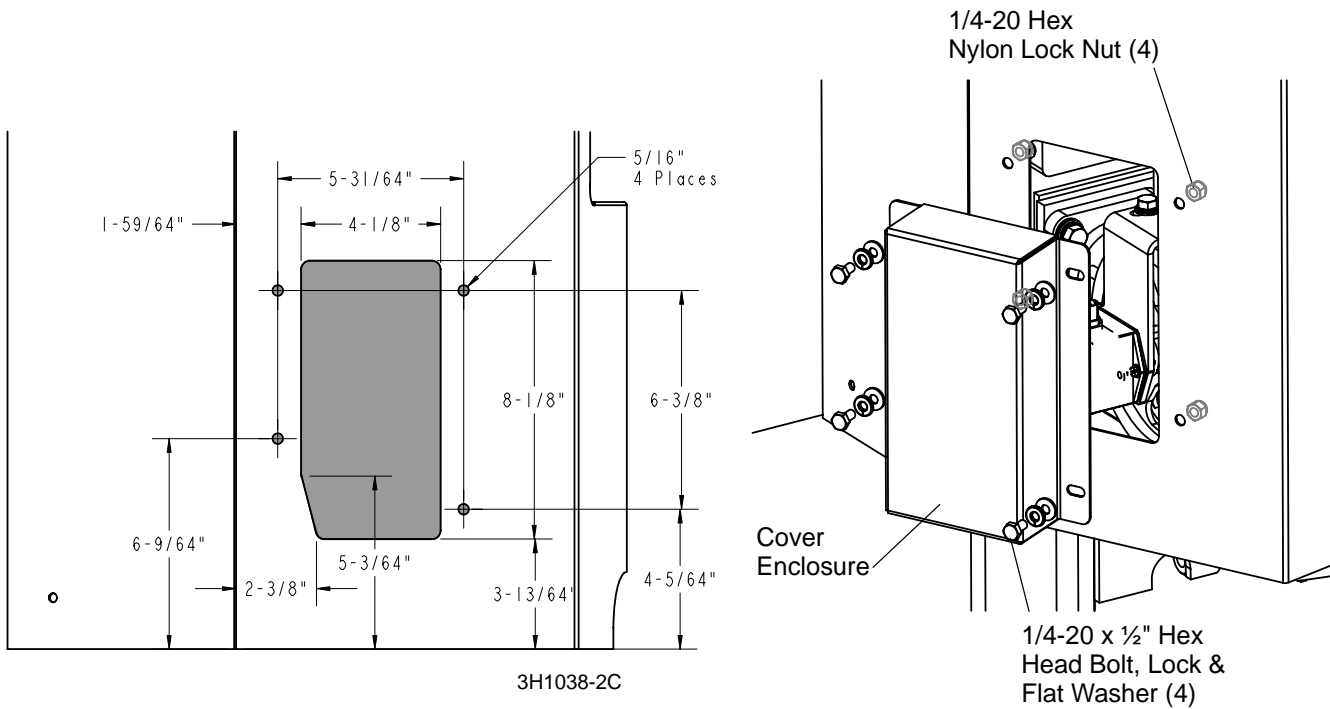

FIGURE 3

- Before reinstalling the drive belt housing cover, it will need to be modified to clear the sensor assembly. Alternately, you can replace the cover with a new one (Part No. W11537).

**See Figure 4.** Cut a rectangular hole and drill holes in the drive belt housing cover to accept the cover enclosure. Assemble the cover enclosure to the drive belt housing cover with four 1/4" bolts, lock washers, flat washers and hex nylon lock nuts.



**FIGURE 4**

See Figure 5.

8. Remove the sawmill control box lid, front panel, hole plug and two center plug screws and nuts. Remove the up/down drum switch handle and mounting hardware.

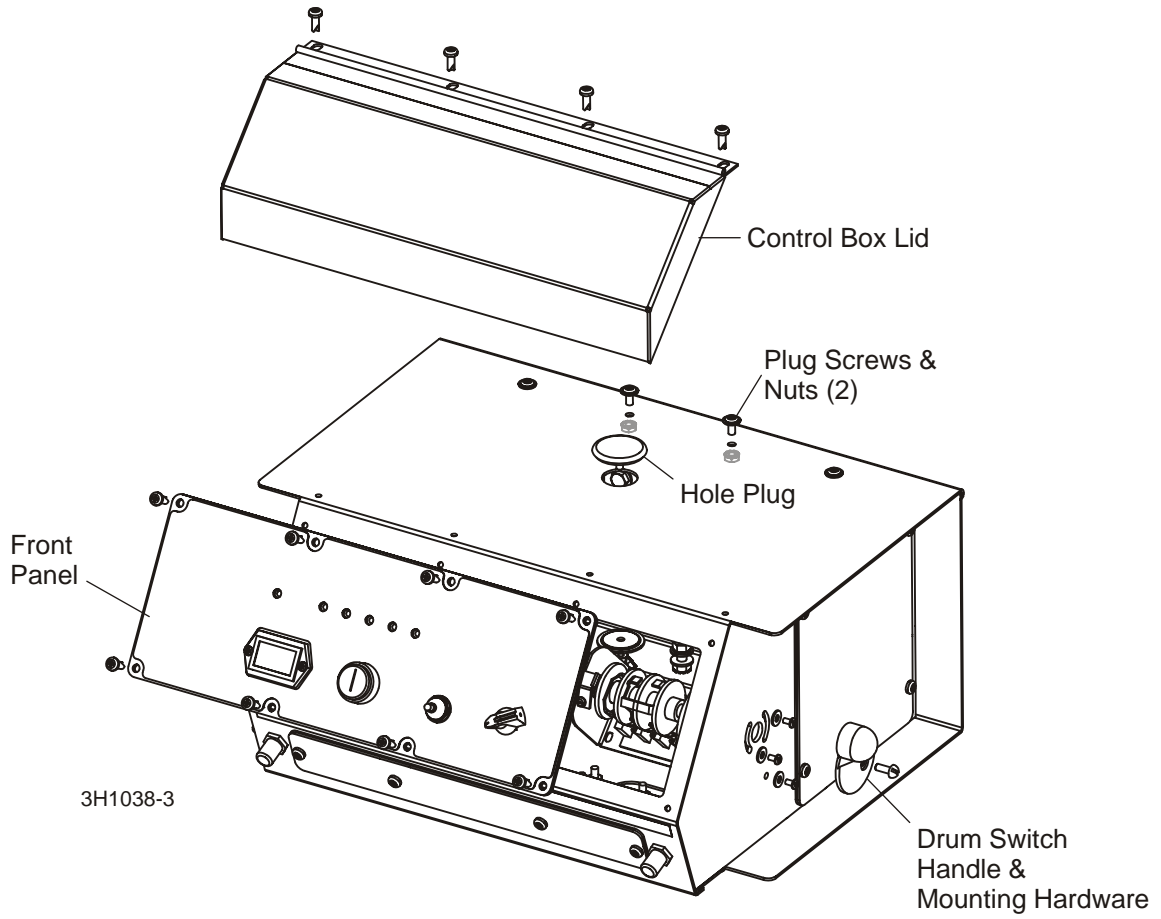

FIGURE 5

See Figure 6.

9. Place the Simple Set control on top of the sawmill control, routing the control wire harness through the hole in the top of the control box. Secure the front of the Simple Set control with the previously removed mounting screws. Replace the other two front screws to plug the empty holes. Secure the back of the box with two 1/4" slotted hex screws provided.
10. Inside the sawmill control, disconnect orange wire #14 and black wire #15 from the up/down drum switch. Keep other wires connected to the switch and replace the terminal nuts. Connect the orange wire #14 to the large yellow Simple Set wire and black wire #15 to the purple Simple Set wire using the provided screws and nuts. Wrap the connections with the provided rubber tubing and secure the tube around the wires with a wire tie.
11. Connect the black wire from the Simple Set control to the ground stud located at the bottom-rear of the sawmill control box. Connect the red wire to the up/down circuit breaker CB2 (leave existing wires connected to the breaker). Connect the small yellow wire to up/down switch terminal #4. Connect the blue wire to up/down switch terminal #5. Keep all other existing wires connected.

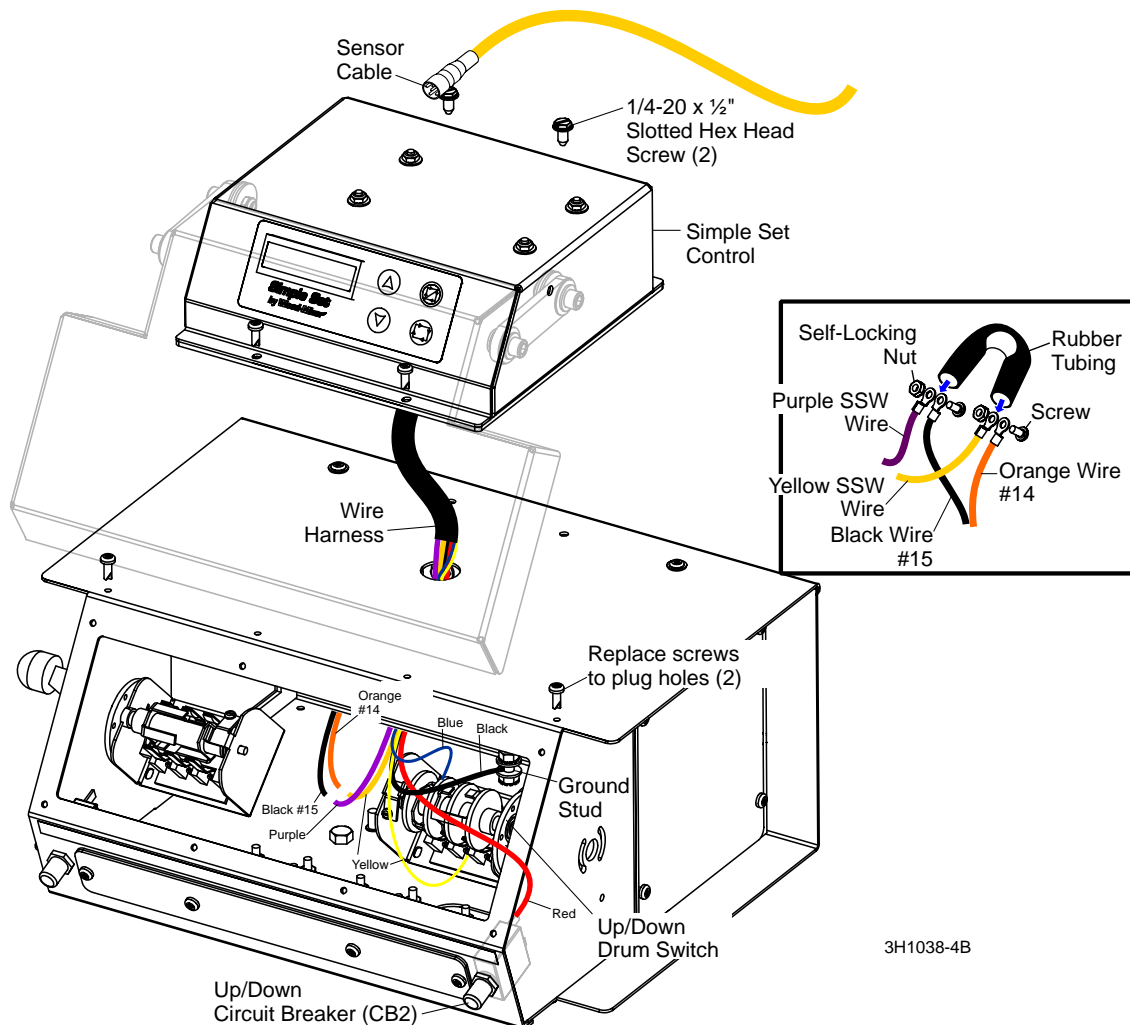

FIGURE 6

- 12.** Reinstall the up/down drum switch, handle and mounting hardware and replace the control box front panel.
- 13.** Plug the sensor cable into the port in the back of the Simple Set control box.
- 14.** Reconnect the negative battery terminal cable and replace the battery box cover.