

Safety, Operation & Parts Manual

Cross Transfer Deck (SLPCTD) rev. A1.00

Safety is our #1 concern!

June 2010

Form #1699

Models Effected:

SLPCTD3.6, Cross Transfer Deck 3.6m

SLPCTD3.6U, CROSS TRANSFER DECK, 12' (mfg in USA)

SLPCTD5.4, Cross Transfer Deck 5.4m

SLPCTD5.4U, Cross Transfer Deck 5.4m (mfg in USA)

SLPCTD7.2, Cross Transfer Deck 7.2m

SLPCTD7.2U, Cross Transfer Deck 7.2m (mfg in USA)



WARNING! Read and understand this manual before using this machine.

SECTION 1 INTRODUCTION

1.1 About This Manual.....1-1
1.2 Getting Service1-2
1.3 Customer and Equipment Identification.....1-4
1.4 Dimensions1-5
1.5 Specifications1-8

SECTION 2 SAFETY

2.1 Safety Symbols.....2-1
2.2 Safety Instructions2-2

SECTION 3 INSTALLATION & SETUP

3.1 Installation3-1
3.2 Pre-Operation Check3-8

SECTION 4 MAINTENANCE

4.1 Tensioning the Drive Chain.....4-2
4.2 Gearbox Oil4-3
4.3 Lubrication4-4

SECTION 5 REPLACEMENT PARTS

5.1 How To Use The Parts List5-1
5.2 Sample Assembly5-1
5.3 Torque Values5-2
5.4 Drive End Table5-3
5.5 Idle End Table5-5
5.6 Offload Table and Long Legs.....5-7
5.7 Extension Table Assembly5-8
5.8 Extension Table Legs5-9

INDEX

SECTION 1 INTRODUCTION

1.1 About This Manual

This manual is to replace or to be used with all previous information received on the Wood-Mizer® * Cross Transfer Deck. All future mailings will be an addition to or a revision of individual sections of this manual as we obtain new information.

The information and instructions given in this manual do not amend or extend the limited warranties for the equipment given at the time of purchase.

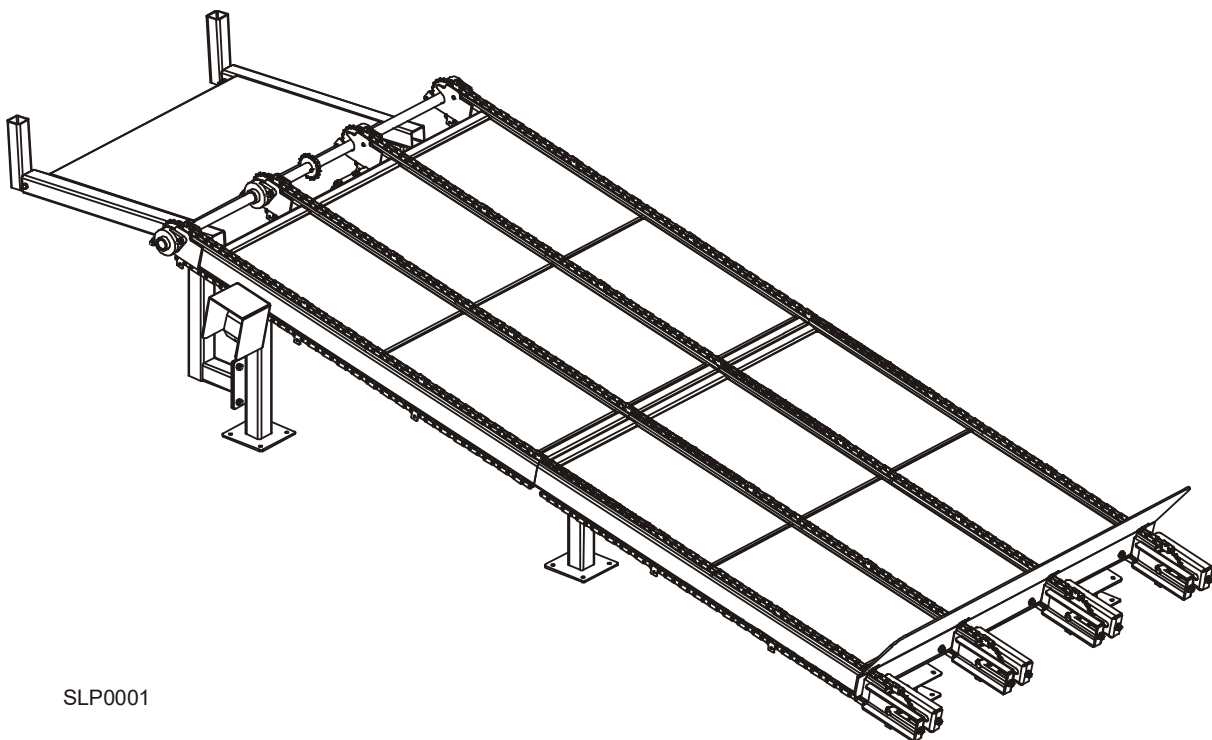

3.6M CROSS TRANSFER DECK (SLPCTD3.6) SHOWN

*Wood-Mizer® is a registered trademark of Wood-Mizer Products, Inc.

1.2 Getting Service

General Contact Information

Toll free phone numbers are listed below for the *continental* U.S. and Canada.

	United States	Canada
Sales	1-800-553-0182	1-877-866-0667
Service	1-800-525-8100	1-877-866-0667
Website	www.woodmizer.com	www.woodmizer.ca
E-mail	woodmizer@woodmizer.com	oninfo@woodmizer.com

Office Hours: All times are Eastern Standard Time.

Monday - Friday	Saturday (Indianapolis Office Only)	Sunday
8 a.m. to 5 p.m.	8 a.m. to 12 p.m.	Closed

Please have your customer and serial number ready when you call.

Wood-Mizer will accept these methods of payment:

- Visa, Mastercard, or Discover
- COD
- Prepayment
- Net 15 (with approved credit)

Shipping and handling charges based on size and quantity of order may apply. Items normally ship on the day they are ordered. Next Day or Second Day shipping is available at additional cost.

If your sawmill was purchased outside the United States or Canada, contact your distributor for service.

USA and World Headquarters	Canadian Headquarters
<p><i>Serving North & South America, Oceania, East Asia</i></p> <p style="text-align: center;">Wood-Mizer LLC 8180 West 10th Street Indianapolis, IN 46214</p> <p>Phone: 317.271.1542 or 800.553.0182 Customer Service: 800.525.8100 Fax: 317.273.1011 Email: infocenter@woodmizer.com</p>	<p><i>Serving Canada</i></p> <p style="text-align: center;">Wood-Mizer Canada 396 County Road 36, Unit B Lindsay, ON K9V 4R3</p> <p>Phone: 705.878.5255 or 877.357.3373 Fax: 705.878.5355 Email: ContactCanada@woodmizer.com</p>
Brazilian Headquarters	European, African, and Asian Headquarters
<p><i>Serving Brazil</i></p> <p style="text-align: center;">Wood-Mizer do Brasil Rua Dom Pedro 1, No: 205 Bairro: Sao Jose Ivoti/RS CEP:93.900-000</p> <p>Tel: +55 51 9894-6461/ +55 21 8030-3338/ +55 51 3563-4784 Email: info@woodmizer.com.br</p>	<p><i>Serving Europe, Africa, Western Asia</i></p> <p style="text-align: center;">Wood-Mizer Industries Sp z o.o. Nagorna 114 62-600 Kolo, Poland</p> <p>Phone: +48.63.26.26.000 Fax: +48.63.27.22.327</p>
Branches and Authorized Sales Centers	
<p>For a complete list of dealers, visit www.woodmizer.com</p>	



Introduction

Customer and Equipment Identification

1.3 Customer and Equipment Identification

An identification plate is located on the frame. The plate contains the serial number and configuration information of your machine. You will also receive a customer number when you purchase your machine.

These numbers will help expedite our service to you. Please locate them now and write them below so you have quick, easy access to them.

Identification Information (To be filled in by purchaser)

Model No. _____

Serial No. _____

Customer No. _____

1.4 Dimensions

See Figure 1-1. The overall dimensions of the 3.6M Cross Transfer Deck (SLPCTD3.6) are shown below.

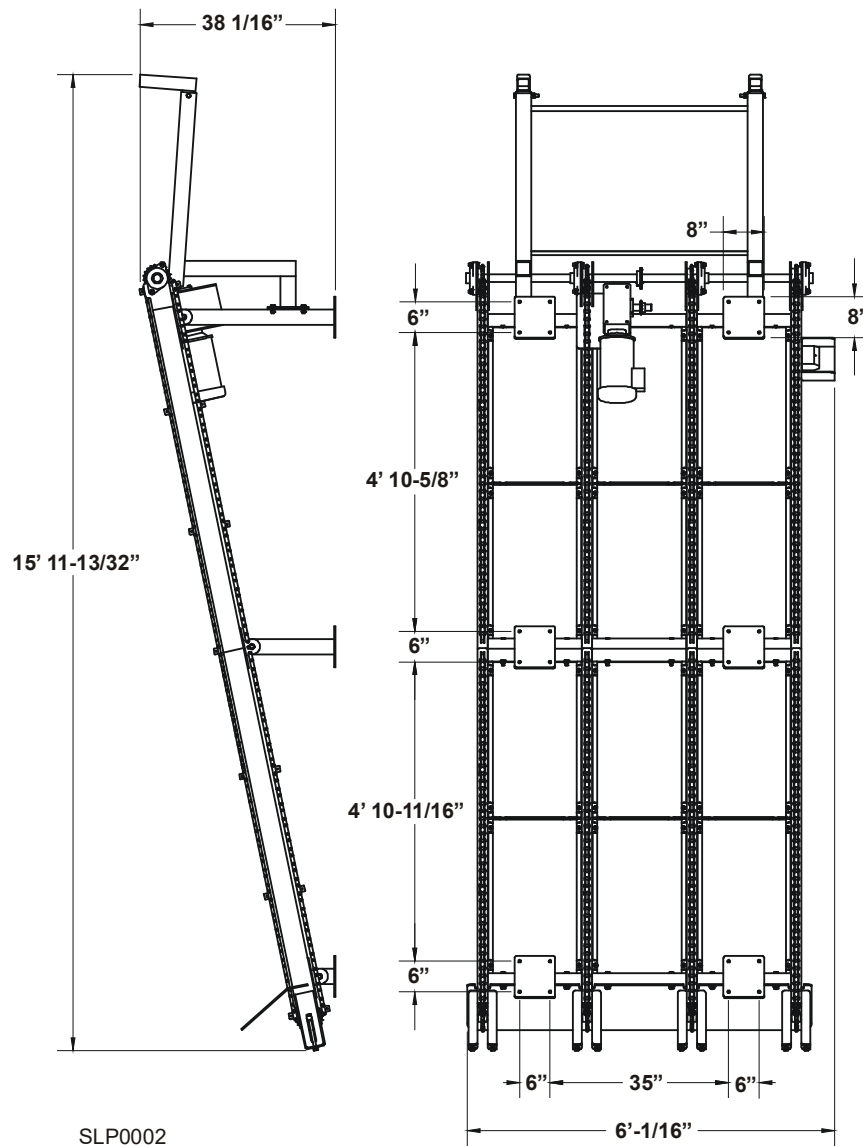

FIG. 1-1 CROSS TRANSFER DECK DIMENSIONS (SLPCTD3.6)

1 Introduction

Dimensions

See Figure 1-2. The overall dimensions of the 5.4M Cross Transfer Deck (SLPCTD5.4) are shown below.

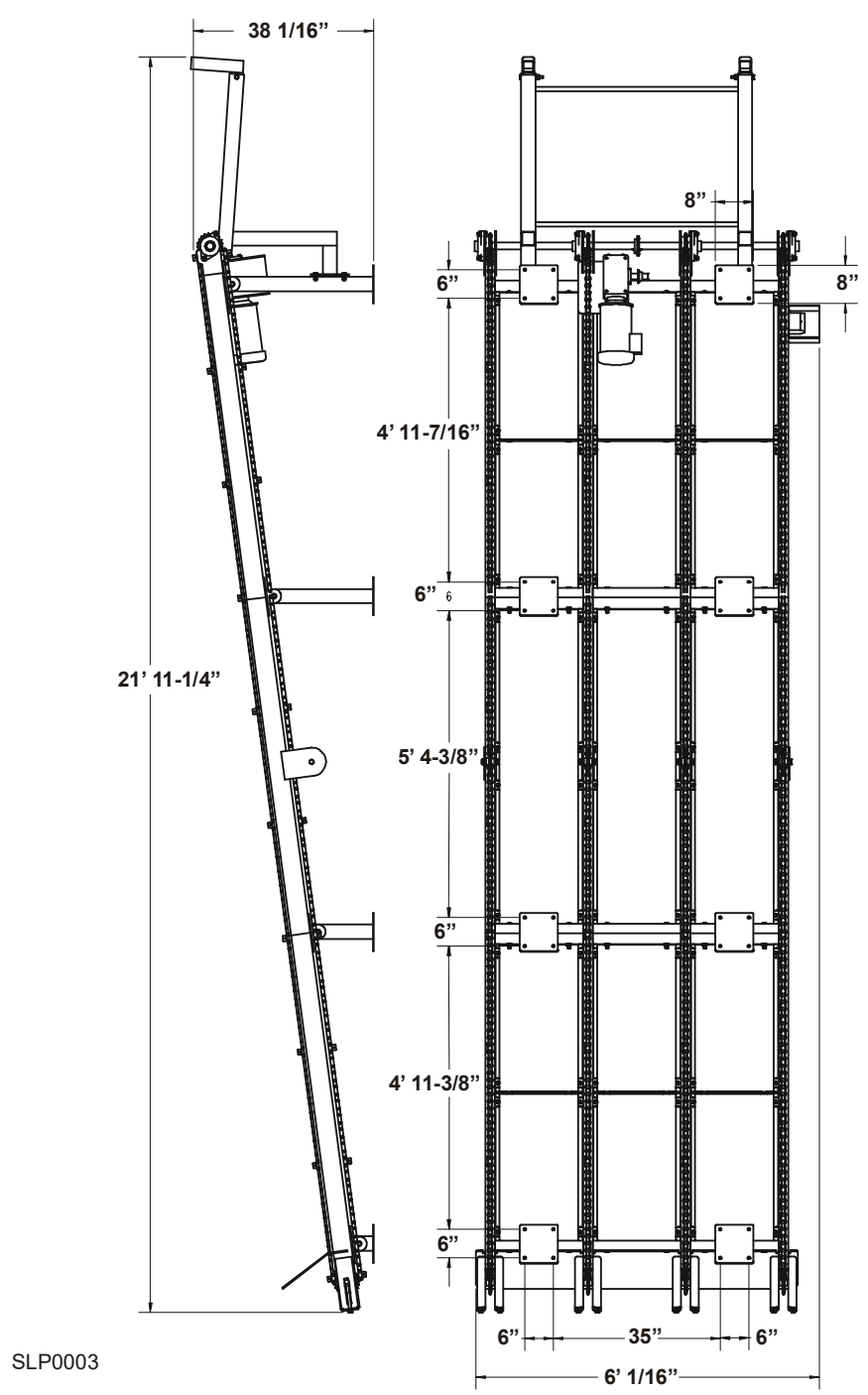

FIG. 1-2 CROSS TRANSFER DECK DIMENSIONS (SLPCTD5.4)

See Figure 1-3. The overall dimensions of the 7.2M Cross Transfer Deck (SLPCTD7.2) are shown below.

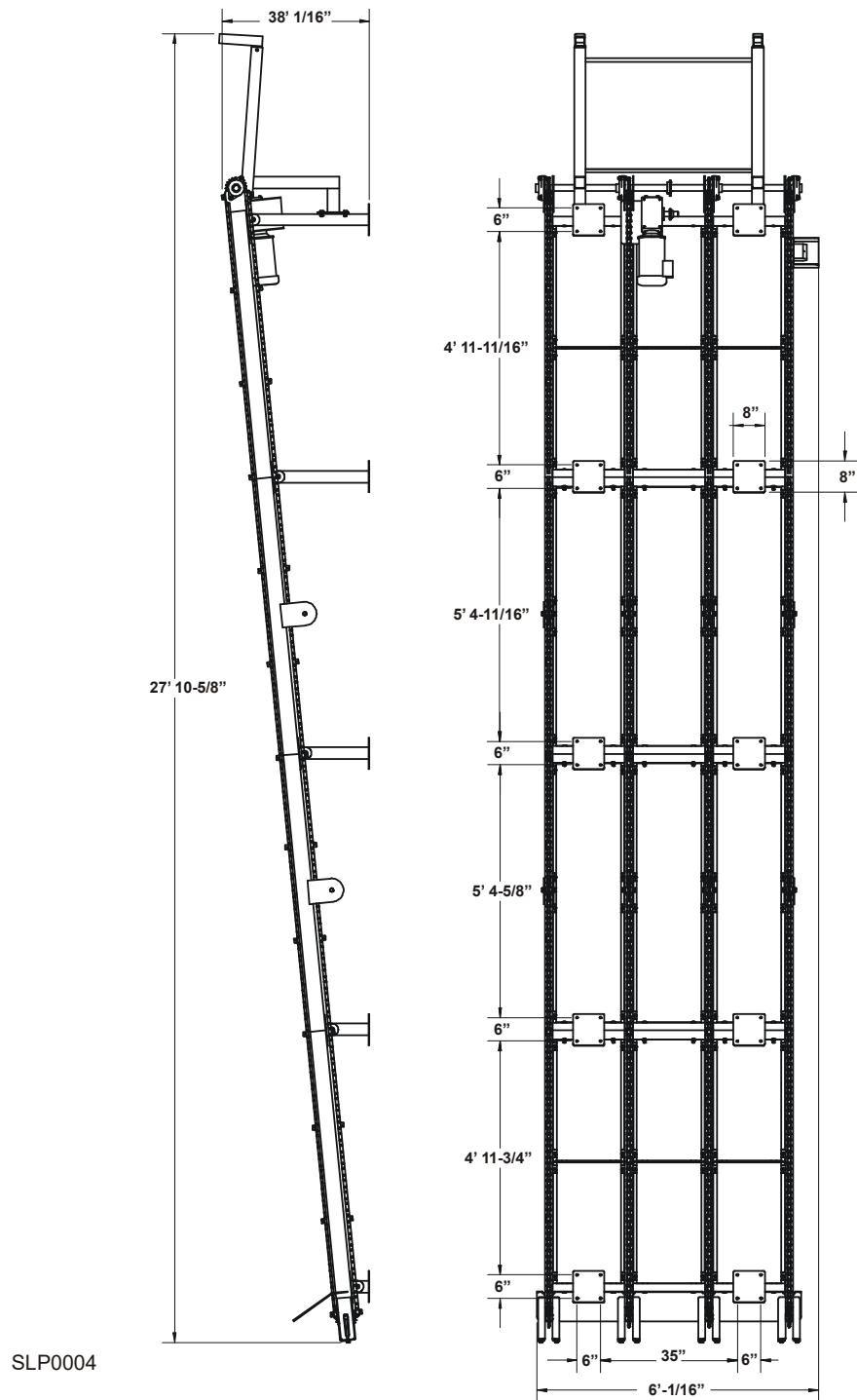

FIG. 1-3 CROSS TRANSFER DECK DIMENSIONS (SLPCTD7.2)

1.5 Specifications

Model: SLPCTD Rev. A+

Cross Transfer Deck Dimensions:

Length: 15' 11-13/32" (SLPCTD3.6)
 21' 11-1/4" (SLPCTD5.4)
 27' 10-5/8" (SLPCTD7.2)
Width: 6'-1/16"
Height: 38-1/16"
Weight: lbs (SLPCTD3.6)
 lbs (SLPCTD5.4)
 lbs (SLPCTD7.2)

Electrical Installation Requirements:

230V/460V 60Hz 3Ph: Amp

Drive System:

Minimum Chain Speed: Ft/Min
Maximum Chain Speed: Ft/Min
Drive Motor Horsepower: 1.5
Drive Motor RPM: 1140

SECTION 2 SAFETY

2.1 Safety Symbols

The following symbols and signal words call your attention to instructions concerning your personal safety. Be sure to observe and follow these instructions.



DANGER! indicates an imminently hazardous situation which, if not avoided, will result in death or serious injury.



WARNING! suggests a potentially hazardous situation which, if not avoided, could result in death or serious injury.



CAUTION! refers to potentially hazardous situations which, if not avoided, may result in minor or moderate injury or damage to equipment.



IMPORTANT! indicates vital information.

NOTE: gives helpful information.



Warning stripes are placed on areas where a single decal would be insufficient. To avoid serious injury, keep out of the path of any equipment marked with warning stripes.

2.2 Safety Instructions

NOTE: ONLY safety instructions regarding personal injury are listed in this section. Caution statements regarding only equipment damage appear where applicable throughout the manual.

OBSERVE SAFETY INSTRUCTIONS



IMPORTANT! Read the entire Owner's Manual before operating the unit. Take notice of all safety warnings throughout this manual and those posted on the machine. Keep this manual with this machine at all times, regardless of ownership.

Also read any additional manufacturer's manuals and observe any applicable safety instructions including dangers, warnings, and cautions.

Only persons who have read and understood the entire operator's manual should operate the unit. The unit is not intended for use by or around children.

IMPORTANT! It is always the owner's responsibility to comply with all applicable federal, state and local laws, rules and regulations regarding the ownership and operation of your Wood-Mizer Cross Transfer Deck. All Wood-Mizer owners are encouraged to become thoroughly familiar with these applicable laws and comply with them fully while using the deck.



WEAR SAFETY CLOTHING



WARNING! Secure all loose clothing and jewelry before operating the deck. Failure to do so may result in serious injury or death.

WARNING! Always wear eye, ear, respiration, and foot protection when operating or servicing the deck.



KEEP DECK AND AREA AROUND DECK CLEAN



DANGER! Maintain a clean and clear path for all necessary movement around the deck and lumber stacking areas. Failure to do so will result in serious injury.

DISPOSE OF SAWING BY-PRODUCTS PROPERLY



WARNING! Clean sawdust from all guards, vents, control boxes, or any area where sawdust may gather after every shift. Failure to do so may result in fire, causing death or serious injury.



IMPORTANT! Always properly dispose of all sawing by-products, including sawdust and other debris, coolant, oil, fuel, oil filters and fuel filters.

CAUTIONS FOR DECK SETUP

WARNING! Securely fasten the feet of the deck to the floor before operating the machine. Failure to do so may result in serious injury or death.

CHECK DECK BEFORE OPERATION

DANGER! Make sure all guards and covers are in place and secured before operating the deck. Failure to do so may result in serious injury.



WARNING! Do not for any reason adjust the drive chains with the machine running. Doing so may result in serious injury.

WARNING! Always check the Emergency Stop switch for proper operation prior to each use of the machine. Failure to do so may result in serious injury.

KEEP PERSONS AWAY

DANGER! Keep all persons out of the path of moving equipment and boards when operating the deck. Failure to do so will result in serious injury.

KEEP HANDS AWAY

DANGER! Moving Parts Can Crush and Cut. Keep hands clear. Make sure all guards and covers are in place and secured before operating or towing. Failure to do so may result in serious injury.

DANGER! Always be aware of and take proper protective measures against rotating shafts, pulleys, sprockets, etc. Always stay a safe distance from rotating members and make sure that loose clothing or long hair does not engage rotating members resulting in possible injury.

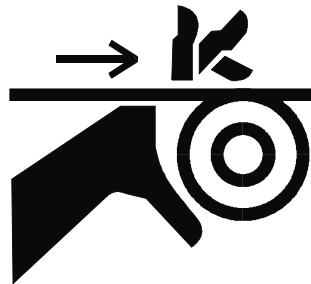

WARNING! Coastdown Required. Always shut down the deck and allow all moving parts to come to a complete stop before removing any guards or covers. Do NOT operate with any guards or covers removed.

WARNING! Kickback Hazard. Stay clear of area during operation. Follow all safety rules. Failure to do so may result in serious injury.

USE PROPER PROCEDURE WHEN CONDUCTING ELECTRICAL SAFETY CHECKS AND MAINTENANCE

DANGER! Make sure all electrical installation, service and/or maintenance work is performed by a qualified electrician and is in accordance with applicable electrical codes.

DANGER! ARC FLASH AND SHOCK HAZARD! Hazardous voltage inside the electric sawmill disconnect box, starter box, and at the motor can cause shock, burns, or death. Disconnect and lock out power supply before servicing! Keep all electrical component covers closed and securely fastened during deck operation. Wear appropriate Personal Protection Equipment.



WARNING! Consider all electrical circuits energized and dangerous.

WARNING! Never assume or take the word of another person that the power is off; check it out and lock it out.

WARNING! Do not wear rings, watches, or other jewelry while working around an open electrical circuit.

DANGER! Lockout procedures must be used during:

- Changing or adjusting blades
- Unjamming operations
- Cleaning
- Mechanical repair
- Electrical maintenance
- Retrieval of tools/parts from work area
- Activities where guards or electrical panel guard is open or removed

Maintenance hazards include:

- Blade contact
- Pinch points
- Kickbacks
- Missiles (thrown blades/wood chips)
- Electrical

Failure to lockout may result in:

- Cut
- Crush
- Blindness
- Puncture
- Serious injury and death
- Amputation
- Burn
- Shock
- Electrocution

To control maintenance dangers:

Lockout procedures must be followed (see ANSI Standard Z244.1-1982 and OSHA regulation 1910.147).

Never rely on machine stop control for maintenance safety (emergency stops, on/off buttons, interlocks).

Do not reach into moving blades or feed systems. Allow all coasting parts to come to a complete stop.

Electrical power supply and air supply must both be locked out.

Where established lockout procedures cannot be used (electrical troubleshooting or mechanical dynamic troubleshooting), alternative effective protective techniques shall be employed which may require special skills and planning.

Always follow safe operations practices in the workplace.

LOCKOUT PROCEDURE

Lockout procedures must be followed (see ANSI Standard Z244.1-1982 and OSHA regulation 1910.147).

Purpose:

This procedure establishes the minimum requirements for lockout of energy sources that could cause injury.

Responsibility:

The responsibility for seeing that this procedure is followed is binding upon all workers. All workers shall be instructed in the safety significance of the lockout procedure. It is your responsibility to ensure safe operation of the machine.

Sequence of Lockout Procedure:

1. Notify all persons that a lockout is required and the reason therefore.
2. If the deck is operating, shut it down by the normal stopping procedure.
3. Operate the switch so that the energy sources are disconnected or isolated from the deck. Stored energy such as moving blades and feed system shall be dissipated.
4. Lockout the energy isolating devices with assigned individual locks.
5. After ensuring that no persons are exposed and as a check on having disconnected the energy sources, operate the push button or other normal operating controls to make certain the deck will not operate. Caution: Return operating controls to neutral position after the test.
6. The deck is now locked out.

Restoring Equipment to Service

1. When the job is complete and the deck is ready for testing or normal service, check the deck area to see that no one is exposed.
2. When the deck is all clear, remove all locks. The energy isolating devices may be operated to restore energy to the deck.

Procedure Involving More Than One Person

In the preceding steps, if more than one individual is required to lock out the deck, each shall place his own personal lock on the energy isolating devices.

Rules for Using Lockout Procedure

The deck shall be locked out to protect against accidental or inadvertent operation when such operation could cause injury to personnel. Do not attempt to operate any switch or valve bearing a lock.

Owner's Responsibility

The procedures listed in this manual may not include all ANSI, OSHA, or locally required safety procedures. It is the owner/operator's responsibility and not Wood-Mizer Products to ensure all operators are properly trained and informed of all safety protocols. Owner/Operators are responsible for following all safety procedures when operating and performing maintenance to the deck.

KEEP SAFETY LABELS IN GOOD CONDITION



IMPORTANT! Always be sure that all safety decals are clean and readable. Replace all damaged safety decals to prevent personal injury or damage to the equipment. Contact your local distributor, or call your Customer Service Representative to order more decals.



IMPORTANT! If replacing a component which has a safety decal affixed to it, make sure the new component also has the safety decal affixed.

SECTION 3 INSTALLATION & SETUP

3.1 Installation

Prepare a firm, level area where the deck can be anchored. A cement pad with 1/2" diameter anchor bolts is recommended.



WARNING! Securely fasten the feet of the deck to the floor before operating the machine. Failure to do so may result in serious injury or death.

1. Install the provided long and middle legs to the drive end table (064720) as shown below. Use the provided hex head bolts, flat washers and nylon lock hex nuts to secure the legs in place.

See Figure 3-1.

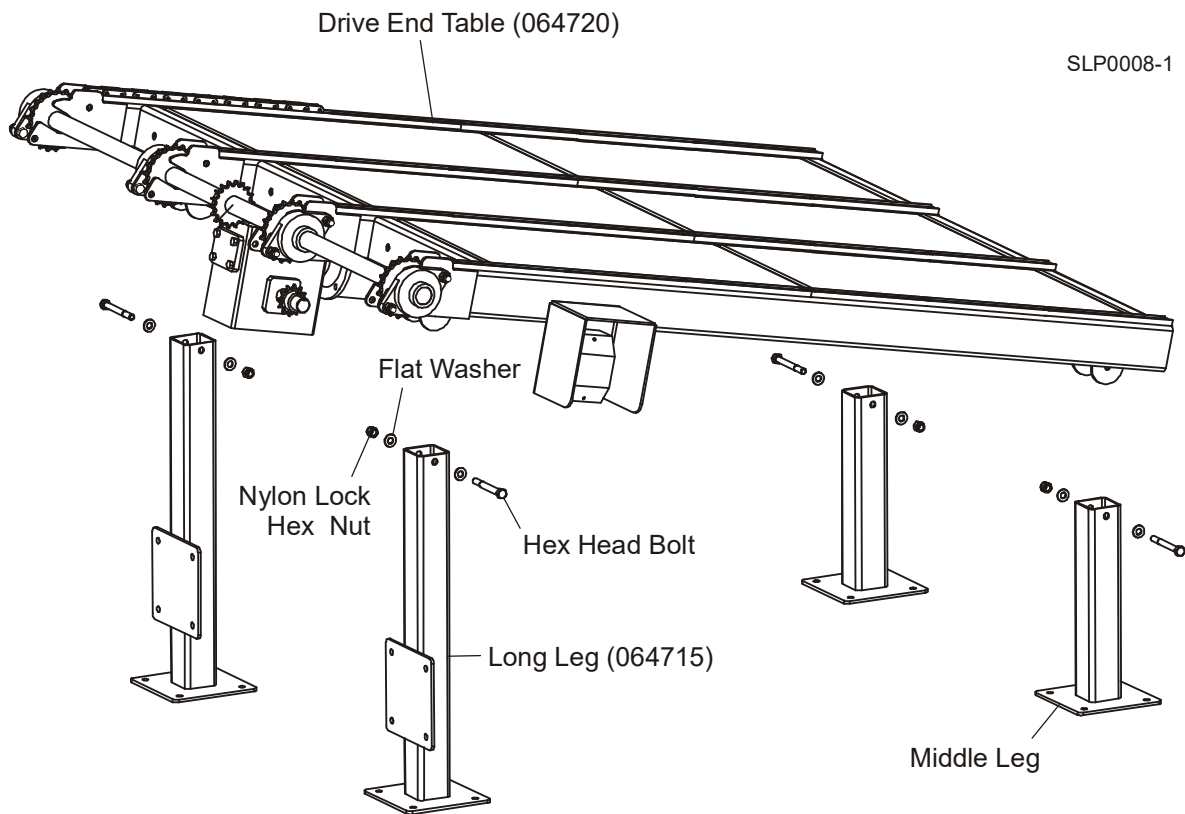

FIG. 3-1

2. Install the short legs (064713) to the idle end table (064721). Install the idle end table to the drive end table as shown below. Connect the tables with the provided fasteners as shown.

See Figure 3-2.

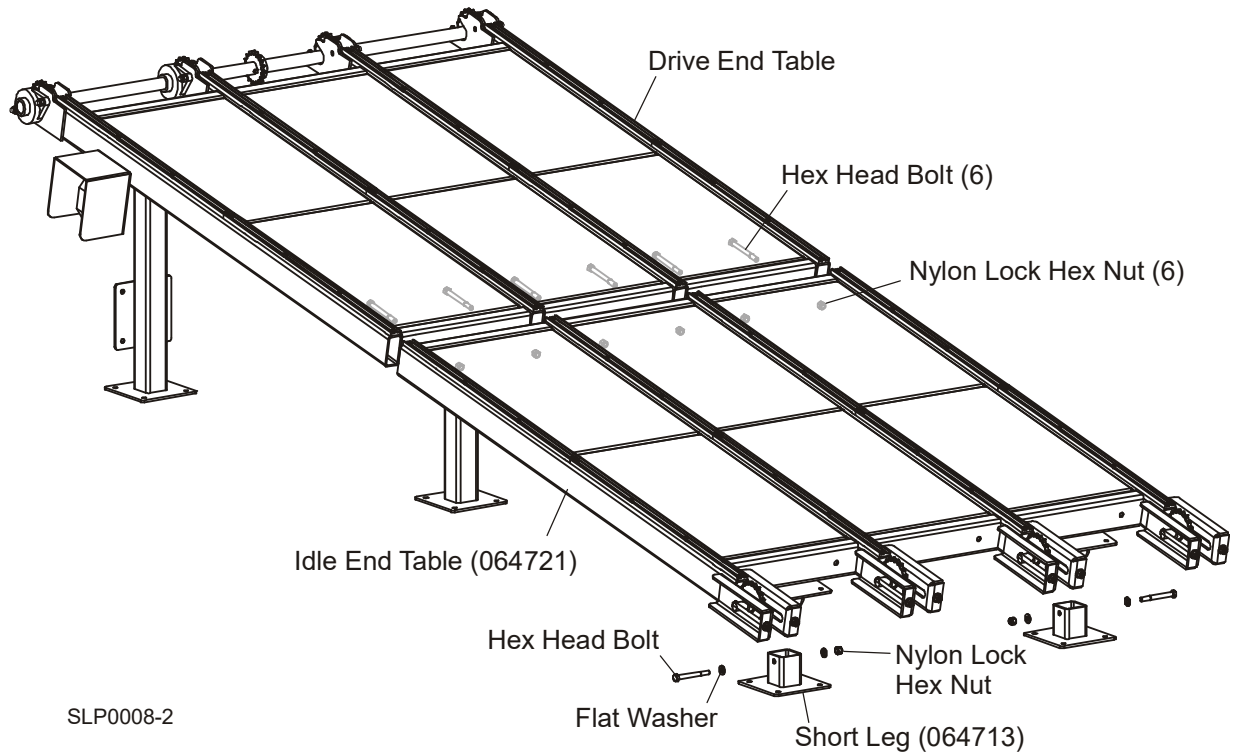

FIG. 3-2

NOTE: If the cross transfer table is provided with an additional extension table(s), install the extension table(s) with the provided legs between the drive end table and the idle end table as shown below.

3

Installation & Setup

Installation

See **Figure 3-3**. Install the extension table(s) between the drive end table and the idle end table. Install the provided additional middle legs to the extension table. (The Cross Transfer Deck (SLPCTD5.4) with one additional extension table shown below).

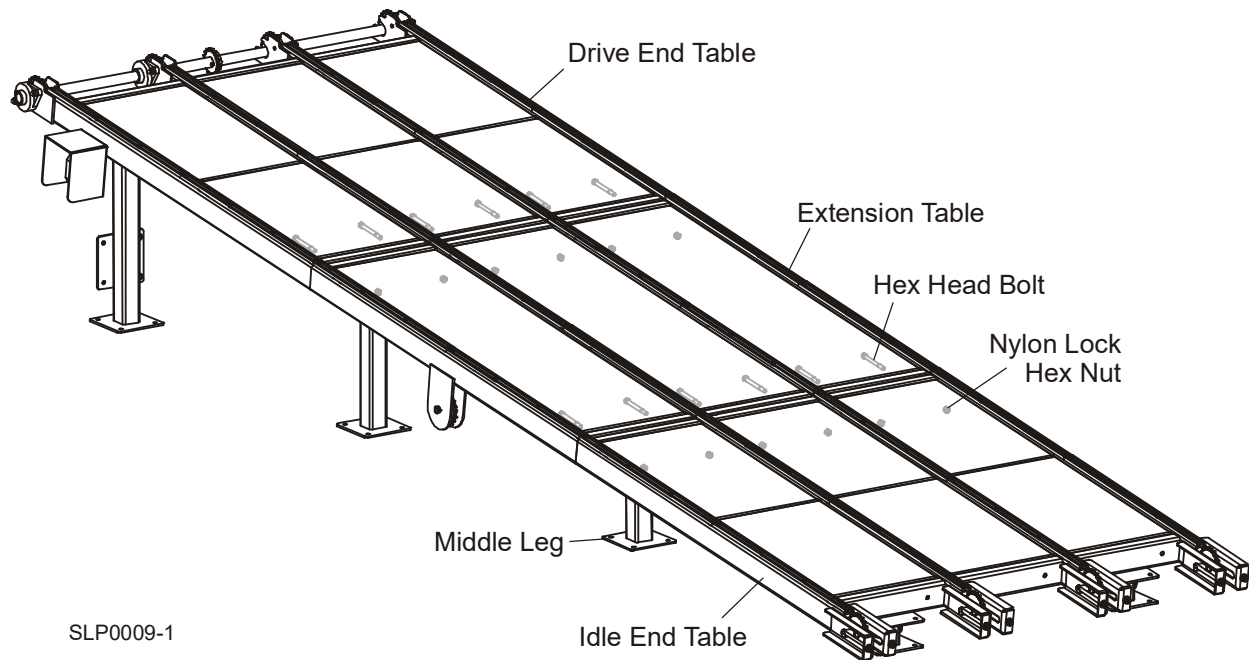

FIG. 3-3

Secure the deck to the floor with 1/2" anchor bolts. Use at least two anchors in each foot plate.

See Figure 3-4. Install the offload table (064736) to the drive end table as shown below. Use the provided hex head bolts and nylon lock hex nuts to secure the offload table in place.

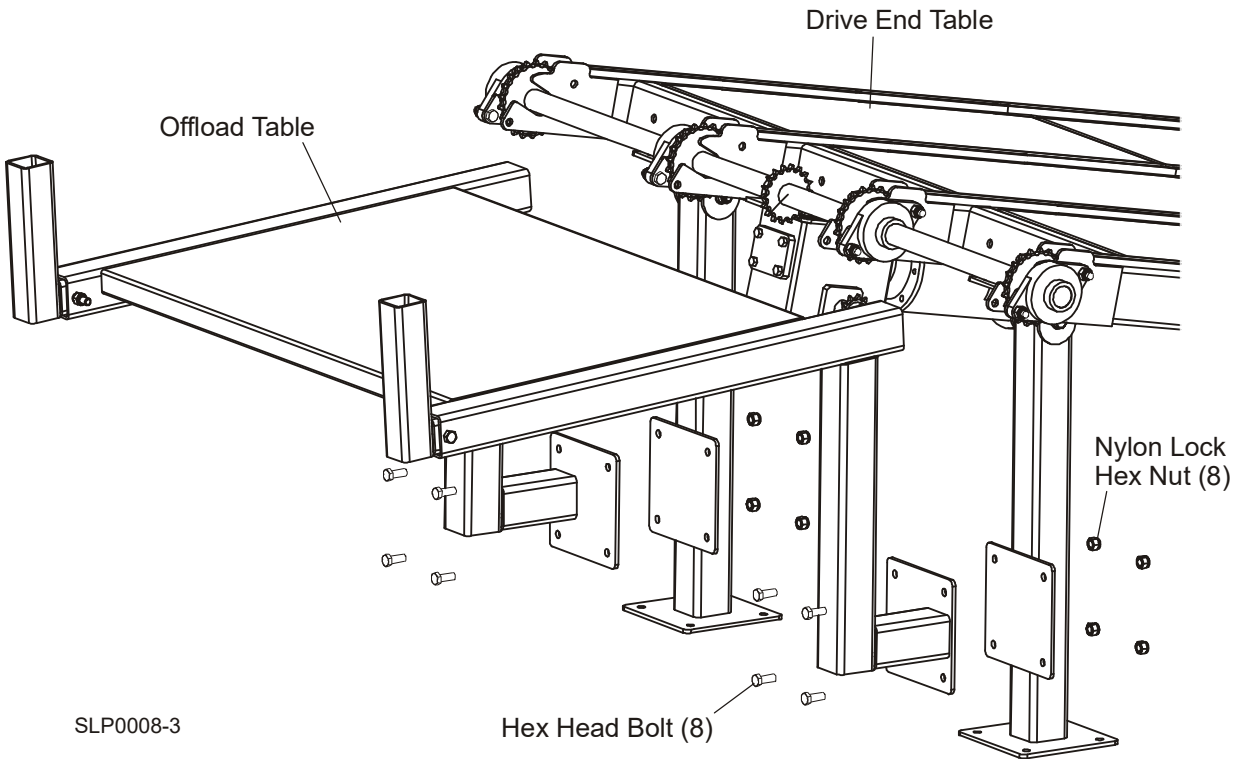

FIG. 3-4

3

Installation & Setup

Installation

See **Figure 3-5**. Install the lower ramp plate (064727) to the lower end of the idle end table as shown below. Use the provided hex head bolts, flat washers and nylon lock hex nuts to secure the lower ramp plate in place.

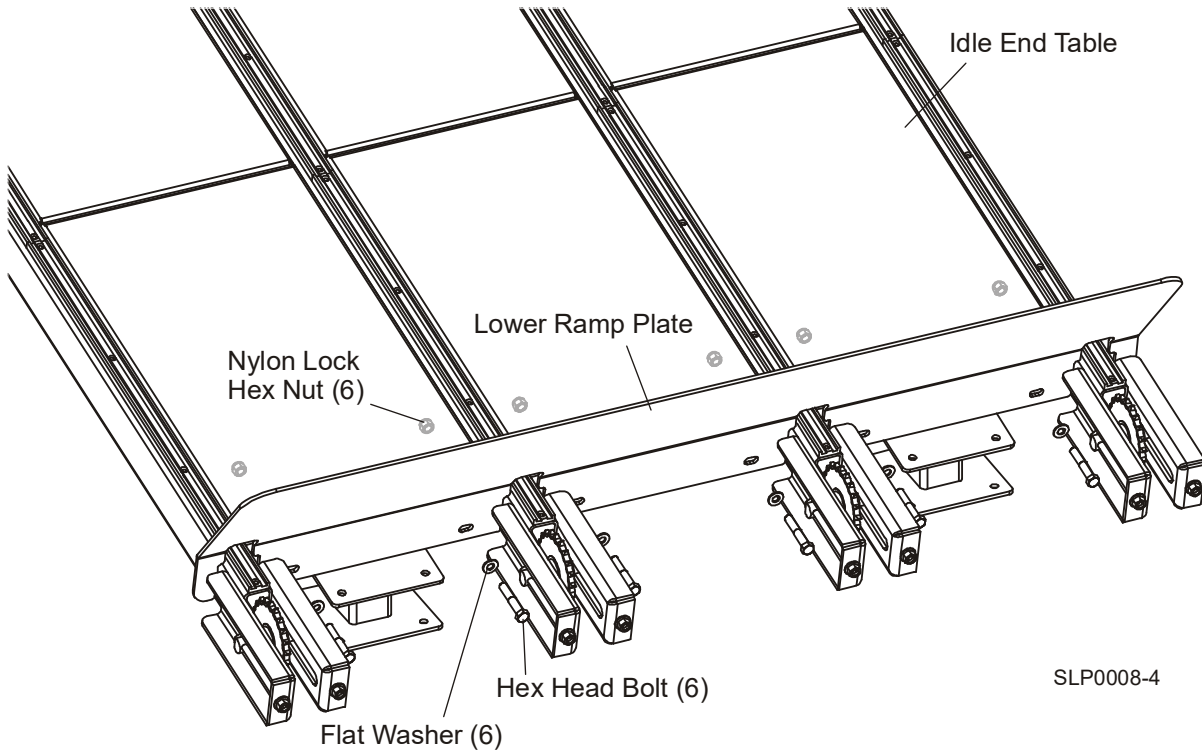

FIG. 3-5

See **Figure 3-6**. Install the provided chains to the cross transfer deck. Make sure the chains are correctly positioned on the sprockets and chain slides. Use the chain tension adjustment bolts located at the lower end of the idle end table to tension the chains properly.

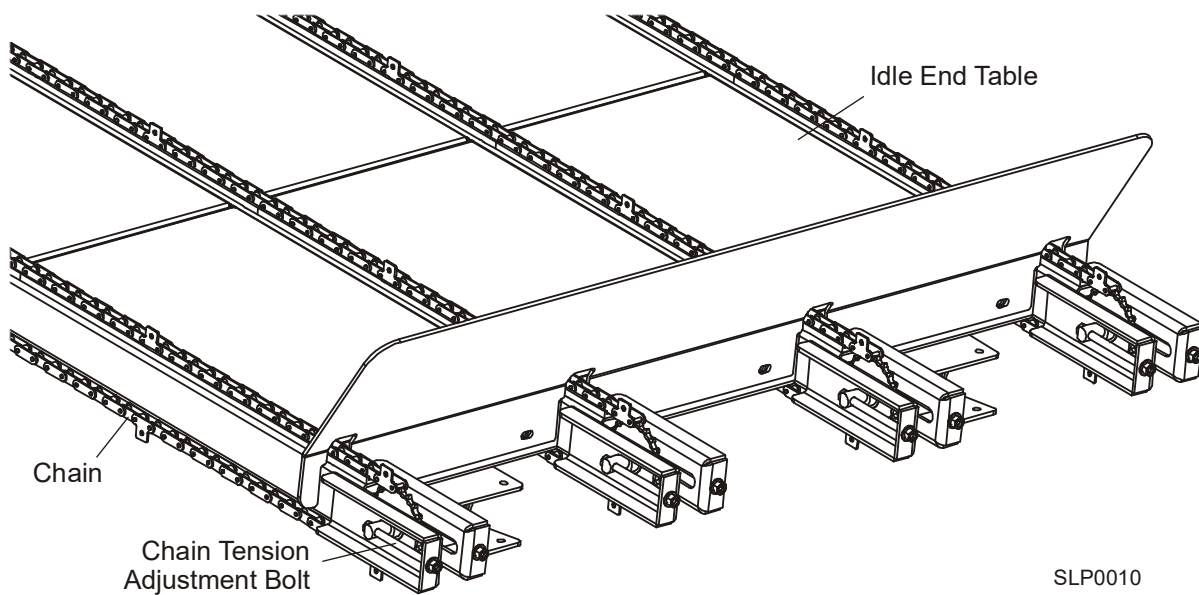

FIG. 3-6

See **Figure 3-7**. The chains are connected with any one of the many master links. These links have a high plate on them to facilitate log handling.

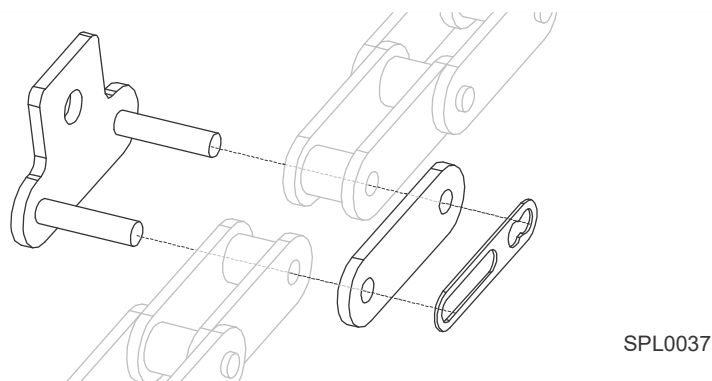

FIG. 3-7

3

Installation & Setup

Installation

NOTE: If the cross transfer deck is equipped with the extension table(s), make sure the chains are routed correctly on the sprocket under the extension table as shown below.

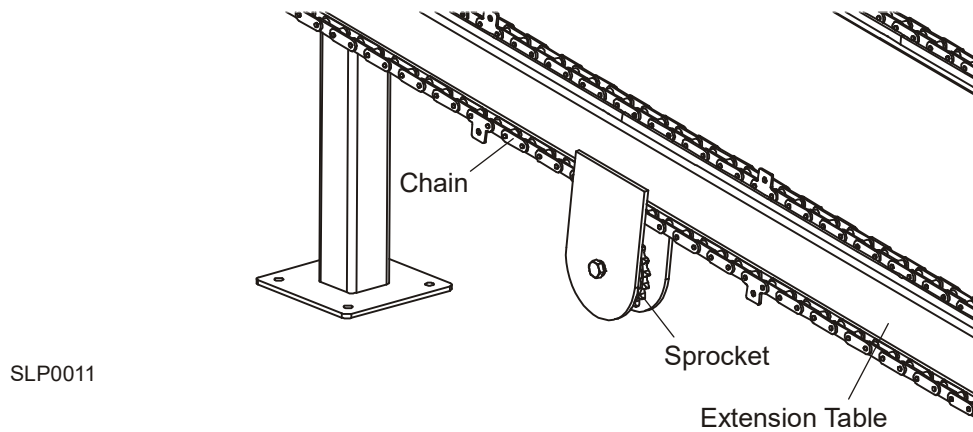

FIG. 3-7



WARNING! Keep all persons out of the path of moving equipment and boards while operating the deck. Failure to do so may result in serious injury or death.

3.2 Pre-Operation Check

Prior to operating the deck, always perform these basic checks:

1. Make sure the deck has been properly set up.
2. Make sure the motor drive chain is tensioned properly. [See Section 4.1](#) for more information.



WARNING! Do not for any reason adjust the motor drive chain with the motor running. Doing so may result in serious injury.

3. You should always turn off the motor to stop the chains whenever the deck is not in use and ensure that all parts have stopped moving before removing any covers or guards.



WARNING! Coastdown Required. Always shut off the motor and allow all moving parts to come to a complete stop before removing any guards. Do NOT operate with any guards or covers removed.

WARNING! Always shut off the motor to stop the chains whenever the deck is not in use. Failure to do so may result in serious injury.

WARNING! Always disconnect and lockout power before performing any service to the deck. Follow the lockout procedure provided in the safety section ([See Section 1.2](#)). Failure to do so may result in serious injury.

WARNING! Keep all persons out of the path of moving equipment and boards while operating the deck. Failure to do so may result in serious injury or death.

SECTION 4 MAINTENANCE



DANGER! Always be aware of and take proper protective measures against rotating shafts, pulleys, fans, etc. Always stay a safe distance from rotating members and make sure that loose clothing or long hair does not engage rotating members resulting in possible injury.

WARNING! Always wear proper and necessary safety equipment when performing service functions. Proper safety equipment includes eye protection, breathing protection, hand protection and foot protection.



This symbol identifies the interval (hours of operation) at which each maintenance procedure should be performed. "AR" signifies maintenance procedures which should be performed as required.

4.1 Tensioning the Drive Chain



Periodically check the deck drive chain tension. Adjust the drive chain tension as needed.



DANGER! Always turn off and disconnect power supply before performing any service to the unit. Failure to do so may result in serious injury or death.

To adjust the deck drive chain, follow the instructions below.

1. Loosen the four mount bolts securing the gearbox to the gearbox mount bracket.
2. Move the gearbox and motor to adjust the drive chain until the center of the chain can be deflected 1/2" (12.7mm).

See Figure 4-1.

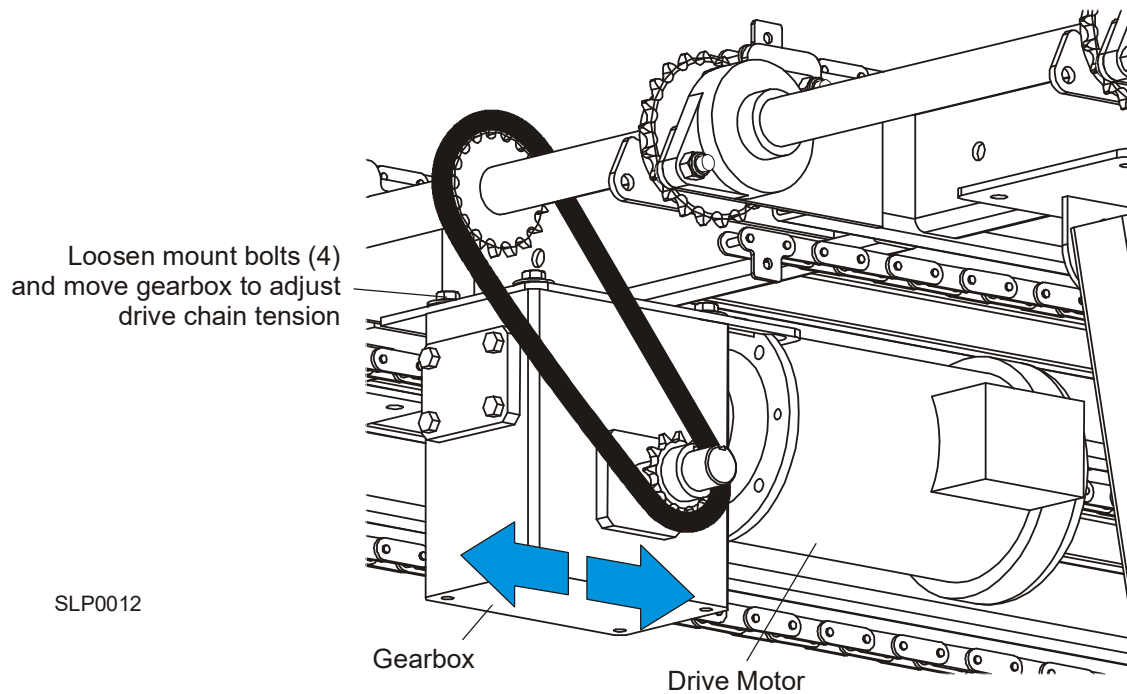

FIG. 4-1



CAUTION! Do not over-tension the drive chain. Damage to the gearbox will occur.

3. After the drive chain has been adjusted, tighten the gearbox mount bolts.

4.2 Gearbox Oil

AR

Check the gearbox oil level in the deck gearbox periodically. Add a synthetic gear oil such as Mobil Glygoyle 460 to the gearbox as needed.

6000

Drain and refill the deck gearbox every 6000 hours of operation or every 2 years, whichever comes first. Use 28 ounces (0.83L) of Mobil Glygoyle 460 oil to refill the gearbox. Change oil every time when performing maintenance that requires gearbox disassembly.

Wood-Mizer offers replacement gear oil in 8 ounce (0.24L) bottles.

4.3 Lubrication



Lubricate the roller bearings every 200 hours of operation with one to two pumps of high-quality lithium-based grease such as Shell Alvania No. 3. Do not overgrease.

SECTION 5 REPLACEMENT PARTS

5.1 How To Use The Parts List

- Use the table of contents to locate the assembly that contains the part you need.
- Go to the appropriate section and locate the part in the illustration.
- Use the number pointing to the part to locate the correct part number and description in the table.
- Parts shown indented under another part are included with that part.

To Order Parts

- From the continental US, call **1-800-525-8100** to order parts. Have your customer number, vehicle identification number, and part numbers ready when you call.
- From other international locations, contact the Wood-Mizer distributor in your area for parts.

5.2 Sample Assembly



REF	PART #	DESCRIPTION	COMMENTS	QTY.
	012345	SAMPLE ASSEMBLY, COMPLETE	INCLUDES ITEMS 1-6	1
1	F02222-22	Sample Part		1
2	F03333-33	Sample Part		2
	098765	Sample Subassembly	Includes items 3-6	1
3	S04444-44	Subassembly Sample Part		1
4	K55555	Subassembly Sample Part		1
	054321	Sample Sub-Subassembly	Includes items 5-6	2
5	022222	Sub-Subassembly Sample Part		1
6	F10234-56	Sub-Subassembly Sample Part		1

The Sample Assembly, Complete, part number 02345 (top level assembly) includes two parts (F0222-22 and F0333-33) and the 098765 subassembly.

Subassembly 098765 contains two parts(S04444-44 and K55555) and two copies of sub-subassembly 054321.

Each sub-subassembly 054321 contains two parts (022222 and F10234-56).

5.3 Torque Values

Grade		Units	SAE 5	SAE 8
Grade Mark				
Bolt Dia.	Threads Per In.	Units	SAE 5	SAE 8
6	32	in-lbs (Nm)	20 (2.3)	-
8	32	in-lbs (Nm)	24 (2.7)	30 (3.4)
10	24	in-lbs (Nm)	35 (4.0)	45 (5.1)
10	32	in-lbs (Nm)	40 (4.5)	50 (5.7)
12	24	in-lbs (Nm)	50 (5.7)	65 (7.3)
1/4	20	in-lbs (Nm)	95 (10.7)	125 (14.1)
1/4	28	in-lbs (Nm)	95 (10.7)	150 (17.0)
5/16	18	ft-lbs (Nm)	17 (22.6)	23 (31.2)
5/16	24	ft-lbs (Nm)	20 (27.1)	25 (33.8)
3/8	16	ft-lbs (Nm)	30 (40.7)	40 (54.2)
3/8	24	ft-lbs (Nm)	35 (47.5)	45 (61.0)
7/16	14	ft-lbs (Nm)	50 (67.8)	65 (88.1)
7/16	20	ft-lbs (Nm)	55 (74.6)	70 (94.9)
1/2	13	ft-lbs (Nm)	75 (101.7)	100 (135.6)
1/2	20	ft-lbs (Nm)	85 (115.3)	110 (149.2)
9/16	12	ft-lbs (Nm)	105 (142.4)	135 (183.1)
9/16	18	ft-lbs (Nm)	115 (155.9)	150 (203.4)
5/8	11	ft-lbs (Nm)	150 (203.4)	195 (264.4)
5/8	18	ft-lbs (Nm)	160 (217.0)	210 (284.8)
3/4	10	ft-lbs (Nm)	170 (230.5)	220 (298.3)
3/4	16	ft-lbs (Nm)	175 (237.3)	225 (305.1)
7/8	9	ft-lbs (Nm)	302 (409.5)	473 (640.9)
7/8	14	ft-lbs (Nm)	300 (406.8)	400 (542.4)
1	8	ft-lbs (Nm)	466 (631.8)	714 (967.4)

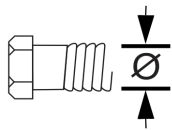

Metric Bolt Head Identification



Metric Grade 8.8



Metric Grade 10.9

Diameter & Thread Pitch	COARSE THREAD				Wrench Size
	Metric 8.8		Metric 10.9		
	N-m	lbs-ft	N-m	lbs-ft	
6 x 1.0	8	6	11	8	10 mm
8 x 1.25	20	15	27	20	13 mm
10 x 1.5	39	29	54	40	16 mm
12 x 1.75	68	50	94	70	18 mm
14 x 2.0	109	80	151	111	21 mm
16 x 2.0	169	125	234	173	24 mm
18 x 2.5	234	172	323	239	27 mm
20 x 2.5	330	244	457	337	30 mm
22 x 2.5	451	332	623	460	34 mm
24 x 3.0	571	421	790	583	36 mm
30 x 3.0	1175	867	1626	1199	46 mm

Diameter & Thread Pitch	FINE THREAD				Wrench Size
	Metric 8.8		Metric 10.9		
	N-m	lbs-ft	N-m	lbs-ft	
8 x 1.0	21	16	29	22	10 mm
10 x 1.25	41	30	57	42	13 mm
12 x 1.25	75	55	103	76	16 mm
14 x 1.5	118	87	163	120	18 mm
16 x 1.5	181	133	250	184	21 mm
18 x 1.5	263	194	363	268	24 mm
20 x 1.5	367	270	507	374	27 mm
22 x 1.5	495	365	684	505	30 mm
24 x 2.0	623	459	861	635	34 mm
30 x 2.0	1258	928	1740	1283	46 mm

5 Replacement Parts

Drive End Table

5.4 Drive End Table

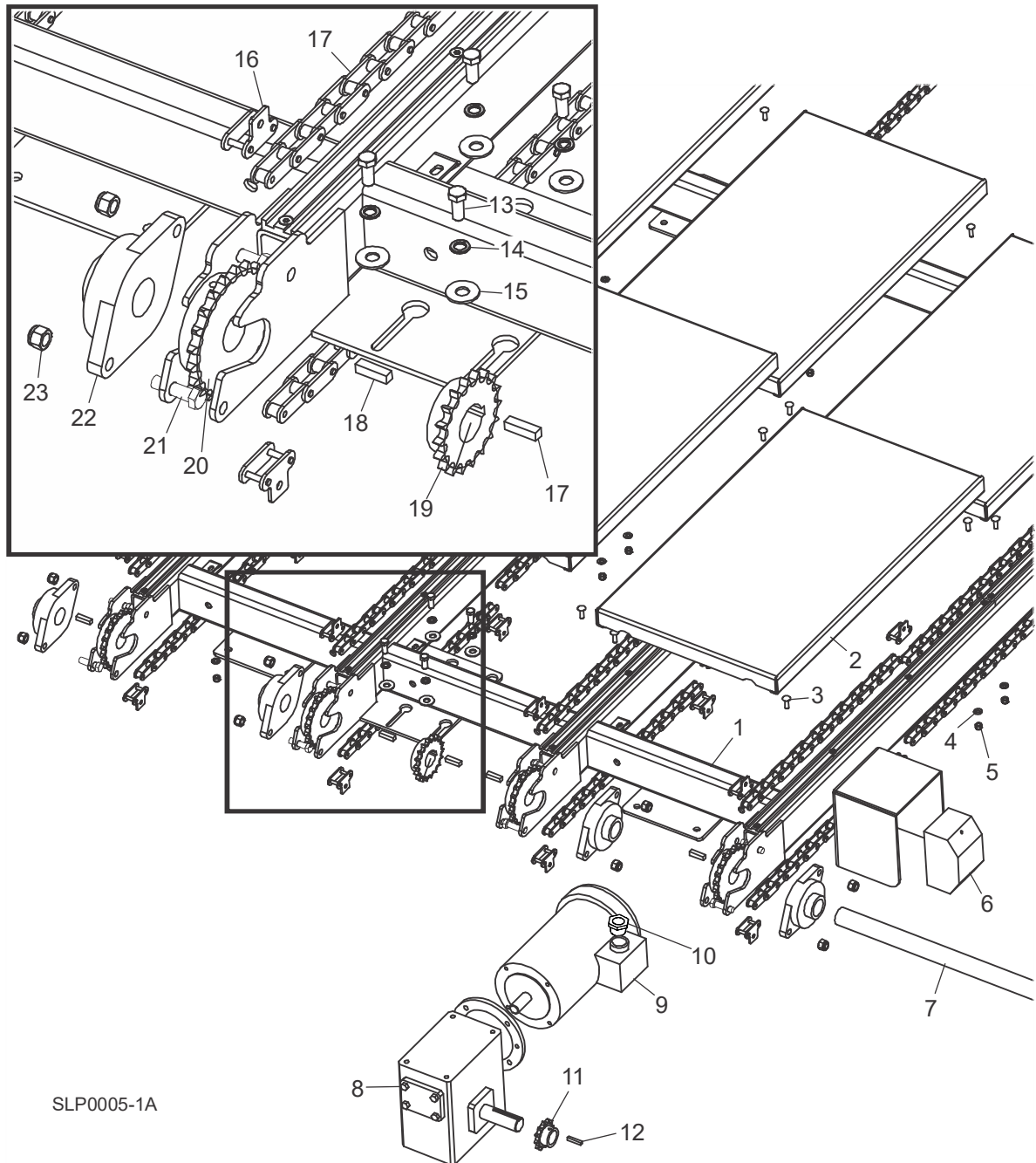

SLP0005-1A

REF	PART #	DESCRIPTION	COMMENTS	QTY.
	064720	TABLE ASSEMBLY, DRIVE END		1
1	064703	Table Weldment, Cross Trans Drive End		1
2	064724	Pan, Deck		6
3	F05006-90	Bolt, 5/16-18 x 1" Carriage Grade 5		24

REF	PART #	DESCRIPTION	COMMENTS	QTY.
4	F05011-17	Washer, 5/16" SAE Flat		24
5	F05010-58	Nut, 5/16-18 Nylok Hex		24
6	064745	Control Assembly, SLPCTD 460V Start/Stop		1
7	064718	Shaft, Drive		1
	065415	Motor/Gearbox Assembly, 1.5HP x 50:1		1
8	065414	Gearbox, 50:1 Grove GR8300261		1
9	065413	Motor, Leeson G132249.00 1.5 HP 182T		1
10	038742	Bushing, 3/4MNPT-1/2FNPT Pipe	Added after 9/8/22 per ECN 38709	1
11	064763	Sprocket, 50B12 x 1 1/4"		1
12	017832	Key, 1/4" Sq x 1 3/8"		1
13	F05007-145	Bolt, 7/16-14 x 1" Hex Head Grade 5		4
14	F05011-48	Washer, 7/16" Split Lock		4
15	F05011-35	Washer, 7/16" Standard Flat		4
16	064762	Link, C2060 w/Attachment Plate		28
17	064761	Chain, C2060 x 22 1/2" (15 pitches)		28
18	S12892	Key, 3/8" x 3/8" x 1 3/8"		5
19	101797	Sprocket, 50B18 x 1 1/2"		1
20	064716	Sprocket, 60B21 x 1 1/2"		4
21	F05008-88	Bolt, 1/2-13 x 1 3/4" Hex Head Grade 5		8
22	064719	Bearing, VF2S-224		4
23	F05010-8	Nut, 1/2-13 Nylon Hex Lock		14

5 Replacement Parts

Idle End Table

5.5 Idle End Table

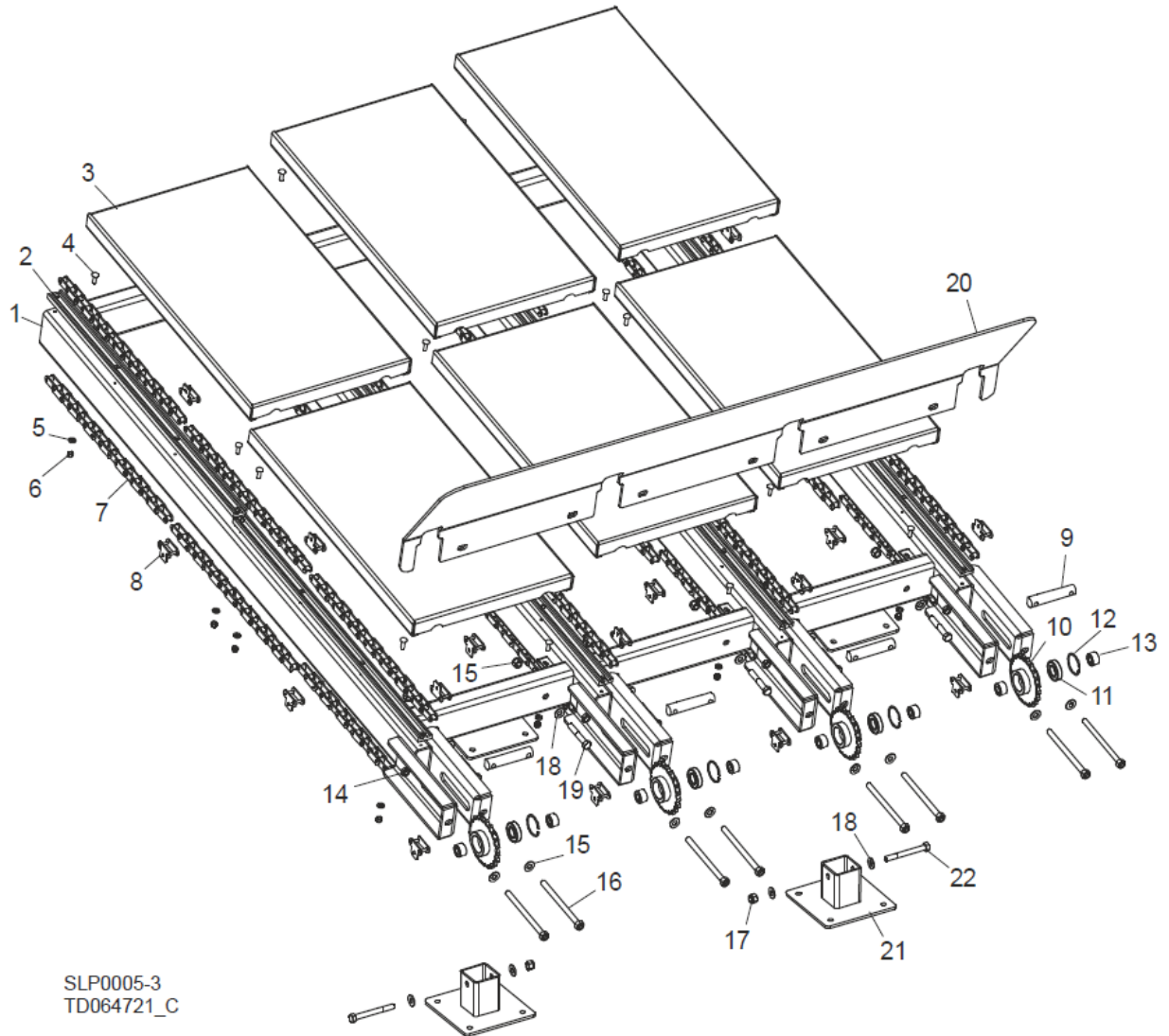

REF	PART #	DESCRIPTION	COMMENTS	QTY.
	064721	TABLE ASSEMBLY, IDLE END		1
1	064705	Table Weldment, Cross Trans Idle End		1
2	064704	Slide, Cross Trans Chain		8
3	064724	Pan, Deck		6
4	F05006-90	Bolt, 5/16-18 x 1" Carriage Grade 5		24
5	F05011-17	Washer, 5/16" SAE Flat		24
6	F05010-58	Nut, 5/16-18 Nylok Hex		24
7	064761	Chain, C2060 x 22 1/2" (15 pitches)		24
8	064762	Link, C2060 w/Attachment Plate		24
9	064735	Shaft, Idler		4

REF	PART #	DESCRIPTION	COMMENTS	QTY.
	064717	Sprocket, 6021x1 Idler		4
10	064784	Sprocket Weldment, 6021 Idler		1
11	042360	Bearing, R16 Sealed		1
12	F04254-35	Ring, 2 ID IR N5000-200 Retaining ->		1
13	130502	Sleeve, 1.02IDx1.25ODx.72Long		2
14	F05010-16	Nut, 1/2-20 Hex Jam		8
15	F05011-2	Washer, 1/2" SAE Flat		8
16	064766	Bolt Weldment, 1/2-20 x 6 3/4" Hex Head		8
17	F05010-8	NUT, 1/2-13 NYLON HEX LOCK		8
18	F05011-2	WASHER, 1/2" SAE FLAT		10
19	F05008-23	BOLT, 1/2-13 X 3" HEX HEAD GRADE 5		6
20	064727	PLATE, LOWER RAMP		1
21	064713	LEG WELDMENT, SHORT		2
22	F05008-35	BOLT, 1/2-13 X 4 1/2" HEX HEAD GRADE 5		2

5 Replacement Parts

Offload Table and Long Legs

5.6 Offload Table and Long Legs

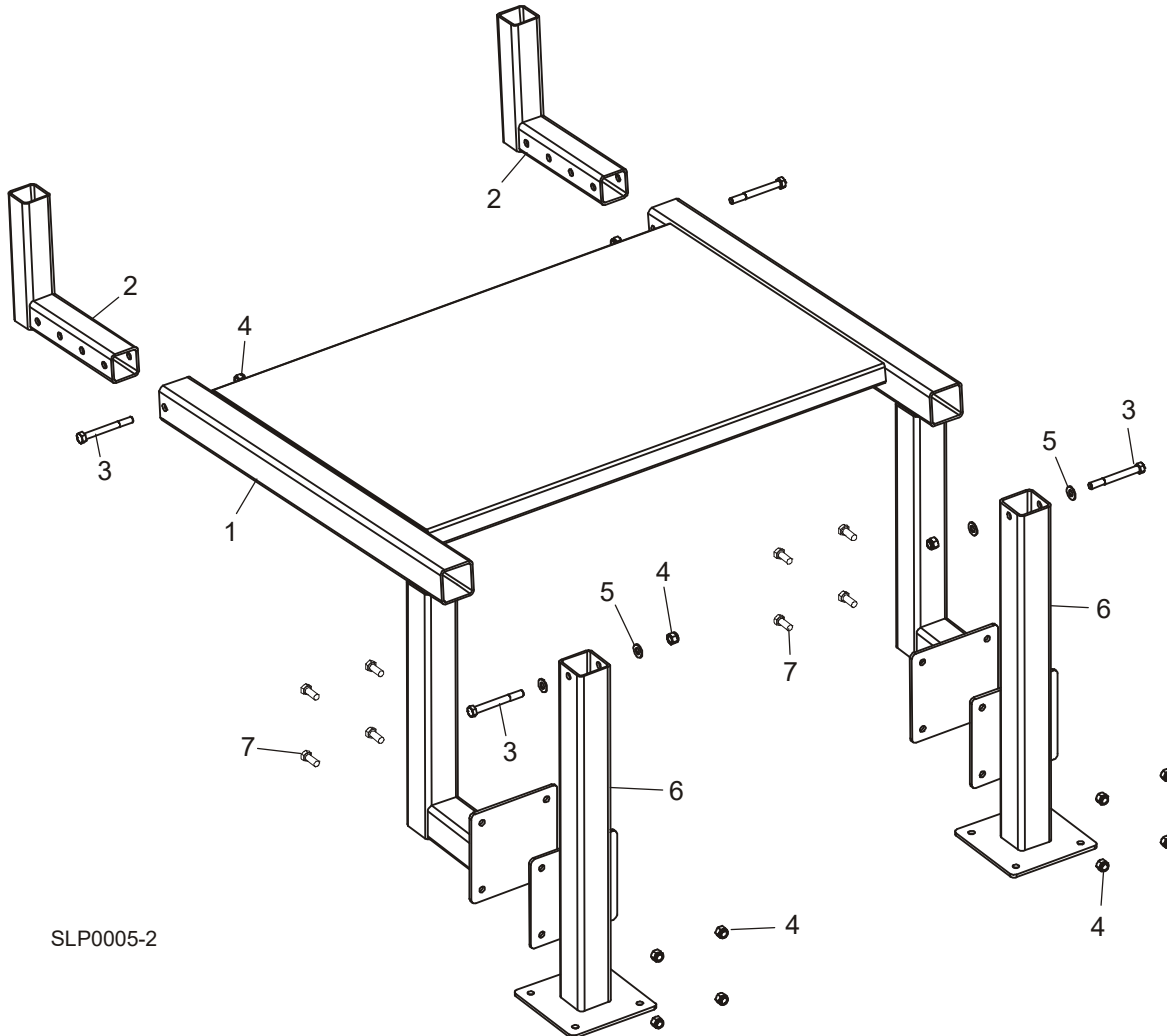

REF	PART #	DESCRIPTION	COMMENTS	QTY.
1	064736	TABLE WELDMENT, OFFLOAD		1
2	064743	TUBE WELDMENT, ADJUSTABLE STOP		2
3	F05008-35	BOLT, 1/2-13 X 4 1/2" HEX HEAD GRADE 5		4
4	F05010-8	NUT, 1/2-13 NYLON HEX LOCK		12
5	F05011-2	WASHER, 1/2" SAE FLAT		4
6	064715	LEG WELDMENT, LONG		2
7	F05008-37	BOLT, 1/2-13 X 1 1/4" HEX HEAD GRADE 5		8

5.7 Extension Table Assembly

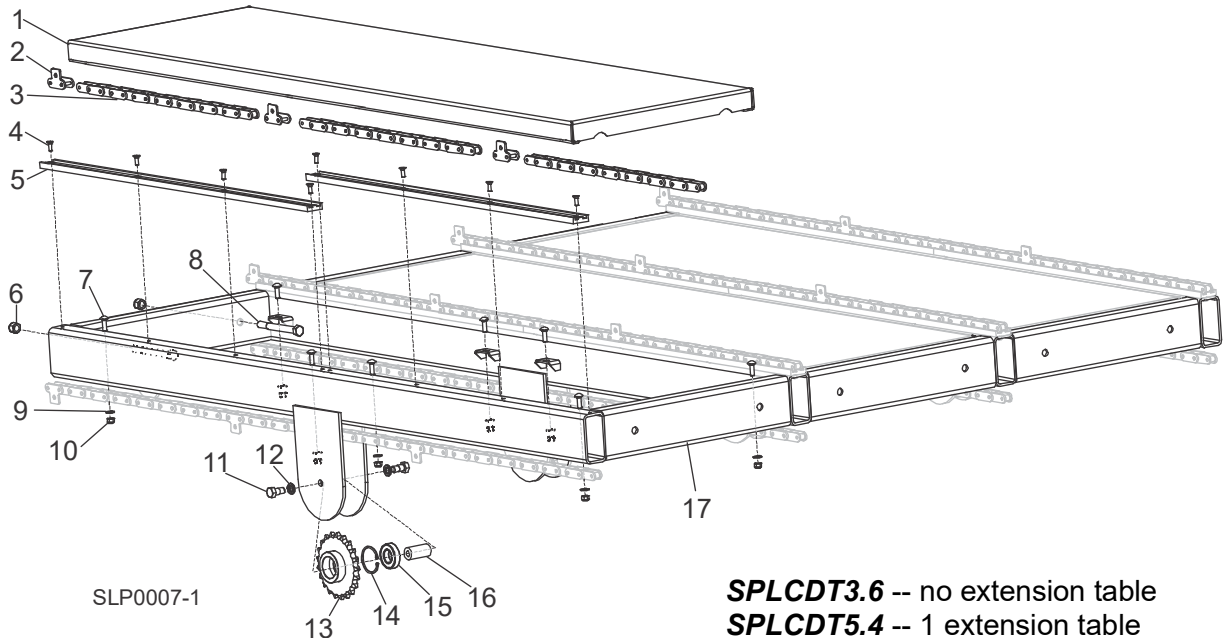

SPLCDT3.6 -- no extension table
SPLCDT5.4 -- 1 extension table
SPLCDT7.2 -- 2 extension tables

REF	PART #	DESCRIPTION	COMMENTS	QTY.
	064722	TABLE ASSEMBLY, EXTENSION		--
1	064758	Pan, Deck Middle		3
2	064762	Link, C2060 w/Attachment Plate		24
3	064761	Chain, C2060 x 22 1/2" (15 pitches)		24
4	F05005-117	Screw, 1/4-20 x 3/4" FHSB BO		32
5	064704	Slide, Cross Trans Chain		8
6	F05010-8	Nut, 1/2-13 Nylon Hex Lock		6
7	F05006-90	Bolt, 5/16-18 x 1" Carriage Grade 5		24
8	F05008-66	Bolt, 1/2-13 x 5" Hex Head Cap Grade 5		6
9	F05011-17	Washer, 5/16" SAE Flat		24
10	F05010-58	Nut, 5/16-18 Nylok Hex		24
11	F05008-50	Bolt, 1/2-13 x 1" Hex Head		8
12	F05011-9	Washer, 1/2" Split Lock		8
	064717	Sprocket, 6021 x 1" Idler		4
13	064784	Sprocket Wldmt, 6021 Idler		1
14	F04254-35	Ring, 2 ID IR N5000-200 Retaining		1
15	042360	Bearing, R16 Sealed		1
16	064760	Pin, Middle Idler		4
17	064709	Table Weldment, Cross Trans Extension		1

5 Replacement Parts

Extension Table Legs

5.8 Extension Table Legs

SLP0006

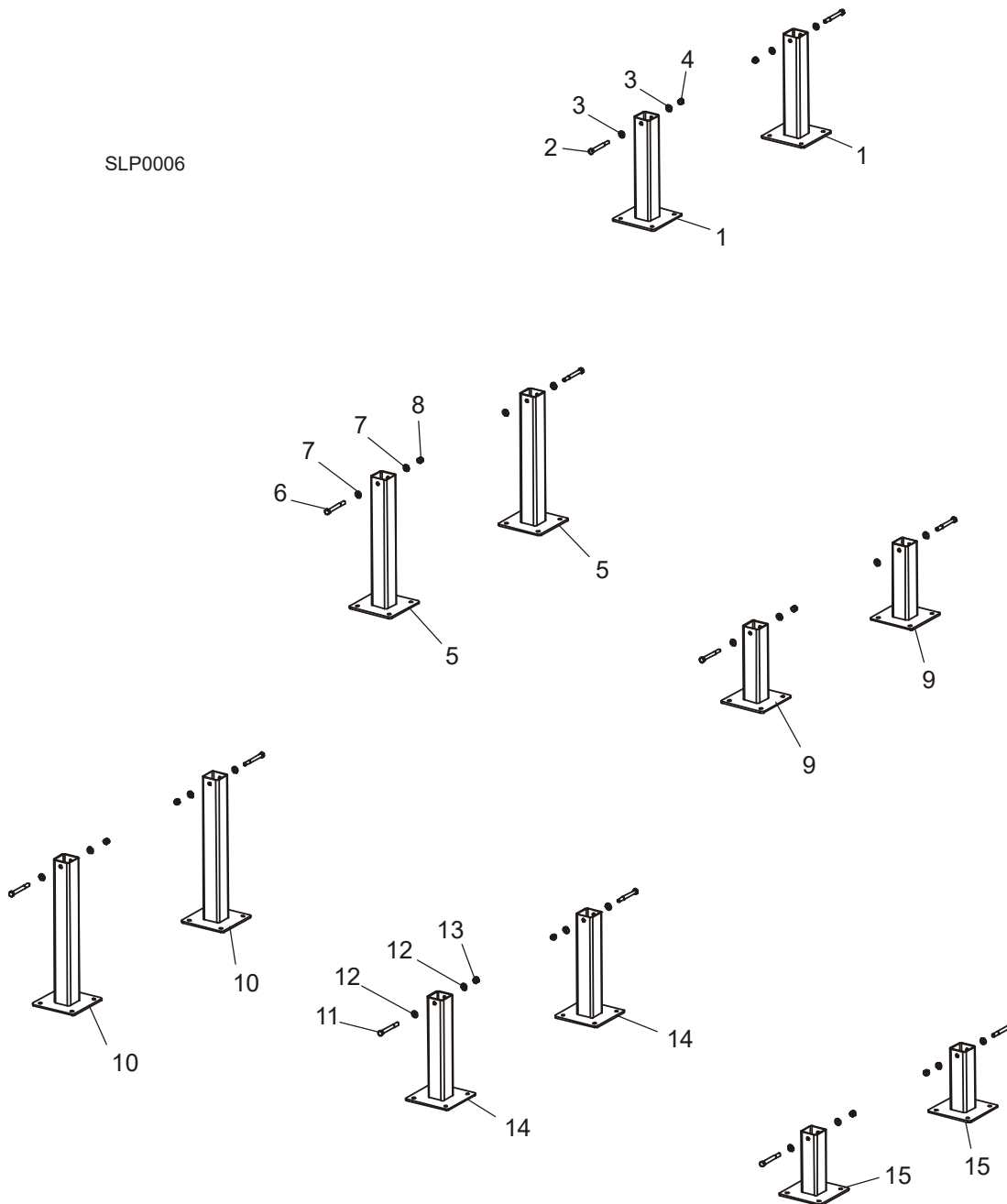

REF	PART #	DESCRIPTION	COMMENTS	QTY.
CROSS TRANSFER DECK, 12' (SLPCTD3.6) LEGS				
1	064714	Leg Weldment, Middle		2
2	F05008-35	Bolt, 1/2-13 x 4 1/2" Hex Head Grade 5		2
3	F05011-2	Washer, 1/2" SAE Flat		4

REF	PART #	DESCRIPTION	COMMENTS	QTY.
4	F05010-8	Nut, 1/2-13 Nylon Hex Lock		2
		CROSS TRANSFER DECK 5.4M (SLPCTD5.4) LEGS		
5	064750	Leg Weldment, #4		2
6	F05008-35	Bolt, 1/2-13 x 4 1/2" Hex Head Grade 5		4
7	F05011-2	Washer, 1/2" SAE Flat		8
8	F05010-8	Nut, 1/2-13 Nylon Hex Lock		4
9	064751	Leg Weldment, #5		2
		CROSS TRANSFER DECK 7.2M (SLPCTD7.2) LEGS		
10	064755	Leg Weldment, #6		2
11	F05008-35	Bolt, 1/2-13 x 4 1/2" Hex Head Grade 5		6
12	F05011-2	Washer, 1/2" SAE Flat		12
13	F05010-8	Nut, 1/2-13 Nylon Hex Lock		6
14	064714	Leg Weldment, Middle		2
15	064757	Leg Weldment, #7		2

INDEX

I

introduction
 dimensions 1-5
 specifications 1-8

M

maintenance
 gearbox oil 4-3
 lubrication 4-4
 tensioning chains 4-2

O

operation & setup
 pre-operation checks 3-8
 setup 3-1

R

replacement parts
 drive end table 5-3
 extension table 5-8
 extension table legs 5-9
 idle end table 5-5
 offload table and long legs 5-7

S

safety
 instructions 2-2
 symbols 2-1

service information
 customer & equipment ID 1-4
 general contact info 1-2