

Log Deck

Safety, Operation and Maintenance Manual

SLPLD3.6
SLPLD6.0

rev.A6.00
rev.A6.00



Safety is our #1 concern! Read and understand all safety information and instructions before operating, setting up and/or maintaining this equipment.

May 2008

Form #1013

Table of Contents

Section-Page

| | | |
|------------------|-----------------------------|------------|
| SECTION 1 | SAFETY INSTRUCTIONS | 1-1 |
| 1.1 | Safety Symbols..... | 1-1 |
| 1.2 | Safety Instructions..... | 1-2 |
| SECTION 2 | OPERATION | 2-1 |
| 2.1 | Log Deck Components..... | 2-1 |
| 2.2 | Log Deck Setup..... | 2-1 |
| 2.3 | Log Deck Operation..... | 2-3 |
| SECTION 3 | MAINTENANCE | 3-1 |
| 3.1 | Lubrication..... | 3-1 |
| 3.2 | Transfer Chain Tension..... | 3-2 |
| 3.3 | Drive Chain Tension..... | 3-3 |
| SECTION 4 | SPECIFICATIONS | 4-1 |
| 4.1 | Log Deck Dimensions..... | 4-1 |
| 4.2 | Motor Specifications..... | 4-3 |
| 4.3 | Electrical Diagram..... | 4-4 |
| 4.4 | Electrical Components..... | 4-4 |
| SECTION 5 | LOG DECK PARTS | 5-1 |
| 5.1 | Chain Guide Assembly..... | 5-1 |
| 5.2 | Drive Assembly..... | 5-3 |
| 5.3 | Guards..... | 5-5 |
| 5.4 | Legs..... | 5-6 |
| 5.5 | Control Box..... | 5-7 |
| 5.6 | Decals..... | 5-8 |
| 5.7 | Light Curtain..... | 5-9 |

Manufacturer Data:

Wood-Mizer Industries, Ltd.

Nagórna 114

62-600 Koło

Poland

Tel. +48 63 26 26 000

If You Need To Order Parts...

From Europe call our European Headquarters and Manufacturing Facility in Kolo, Poland at **+48-63-2626000**. Wood-Mizer will accept the following methods of payment:

- Visa, Mastercard, or Select Purchase
- COD
- Prepayment
- Net 15 (with approved credit)

Be aware that shipping and handling charges may apply. Handling charges are based on size and quantity of order. In most cases, items will ship on the day they are ordered. Second Day and Next Day shipping are available at additional cost.

If You Need Service...

From Europe call our European Headquarters and Manufacturing Facility in Kolo, Poland at **+48-63-2626000**. Ask to speak with a Customer Service Representative. Please have your customer number ready when you call. The Service Representative can help you with questions about alignment of your equipment. He also can schedule you for a service call.

Office Hours: All times are Eastern Standard Time.

| Country | Monday - Friday | Saturday | Sunday |
|---------|---------------------|------------------|--------|
| Poland | 8 a.m. to 4:30 p.m. | 8 a.m. to 1 p.m. | Closed |



IMPORTANT! Read the entire Operator's Manual before operating the conveyor. Take notice of all safety warnings throughout this manual and those posted on the equipment. Keep this manual with this equipment at all times, regardless of ownership.

*Wood-Mizer® is a registered trademark of Wood-Mizer Products, Inc.

SECTION 1 SAFETY INSTRUCTIONS

1.1 Safety Symbols

The following symbols and signal words call your attention to instructions concerning your personal safety. Be sure to observe and follow these instructions.



The word **DANGER** indicates an imminently hazardous situation which, if not avoided, will result in death or serious injury.



WARNING! suggests a potentially hazardous situation which, if not avoided, could result in death or serious injury.



CAUTION refers to potentially hazardous situations which, if not avoided, may result in minor or moderate injury to persons or equipment.



IMPORTANT! indicates vital information.

NOTE: gives helpful information.



Warning stripes are placed on areas where a single decal would be insufficient. To avoid serious injury, keep out of the path of any equipment marked with warning stripes.

1 Safety Instructions

Safety Instructions

1.2 Safety Instructions

NOTE: ONLY safety instructions regarding personal injury are listed in this section. Caution statements regarding only equipment damage appear where applicable throughout the manual.

Observe Safety Instructions



IMPORTANT! Read the entire Operator's Manual before operating the unit. Take notice of all safety warnings throughout this manual and those posted on the equipment. Keep this manual with this equipment at all times, regardless of ownership.

Also read any additional manufacturer's manuals and observe any applicable safety instructions including dangers, warnings, and cautions.

Only persons who have read and understood the entire operator's manual should operate this equipment. The equipment is not intended for use by or around children.



IMPORTANT! It is always the owner's responsibility to comply with all applicable federal, state and local laws, rules and regulations regarding the ownership, operation and towing of your Wood-Mizer equipment.



Wear Safety Clothing



WARNING! Secure all loose clothing and jewelry before operating this equipment. Failure to do so may result in serious injury or death.

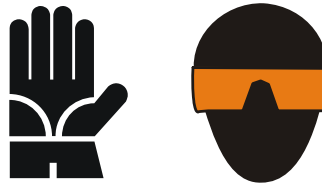

WARNING! Always wear eye, ear, respiration and foot protection as well as safety clothing when operating or servicing the equipment.



Keep the Equipment and Area Around Clean



DANGER! Maintain a clean and clear path for all necessary movement around the equipment and lumber stacking areas. Failure to do so may result in serious injury.

Dispose Of Sawing By-Products Properly



IMPORTANT! Always properly dispose of all sawing by-products, including sawdust and other debris.

Check the Equipment Before Operation

DANGER! Make sure all guards and covers are in place and secured before operating the equipment. Failure to do so may result in serious injury.

**Keep Persons Away**

DANGER! Keep all persons out of the path of moving equipment and lumber when operating the equipment. Failure to do so may result in serious injury.



DANGER! Be sure that all persons are away from the equipment before starting it. Failure to do so may result in serious injury.

Keep Hands Away

DANGER! Always keep hands away from moving chain. Failure to do so may result in serious injury.



DANGER! Always be aware of and take proper protective measures against rotating shafts, pulleys, fans, etc. Always stay a safe distance from rotating members and make sure that loose clothing or long hair does not engage rotating members resulting in possible injury.

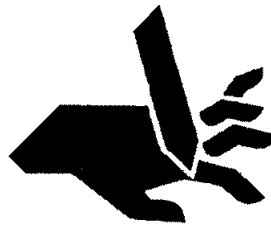

Use Proper Maintenance Procedures



DANGER! Make sure all electrical installation, service and/or maintenance work is performed by a qualified electrician and is in accordance with applicable electrical codes.



DANGER! Hazardous voltage inside the electric box and at the motor can cause shock, burns, or death. Disconnect and lock out power supply before servicing! Keep all electrical component covers closed and securely fastened during equipment operation.



WARNING! Consider all electrical circuits energized and dangerous.



WARNING! Disconnect and lock out power supply before servicing! Failure to do so may result in serious injury.



WARNING! Never assume or take the word of another person that the power is off; check it out and lock it out.



WARNING! Do not wear rings, watches, or other jewelry while working around an open electrical circuit.





CAUTION! The conveyor's work-stand should be equipped with a 4 kg or bigger dry powder extinguisher.

1 Safety Instructions

Keep Safety Labels In Good Condition

Keep Safety Labels In Good Condition

 **IMPORTANT!** Always be sure that all safety decals are clean and readable. Replace all damaged safety decals to prevent personal injury or damage to the equipment. Contact your local distributor, or call your Customer Service Representative to order more decals.

 **IMPORTANT!** If replacing a component which has a safety decal affixed to it, make sure the new component also has the safety decal affixed.

Safety Labels Description

See Table 1-1. Pictographic safety labels are shown in the table below.

TABELA 1-1





| Decal View | Decal No. | Description |
|---|-----------|---|
|  | 096317 | Read thoroughly the operator's manual before operating the equipment. Observe instructions and safety rules when operating. |
|  | 099220 | Close all guards and covers prior to starting the equipment. |

TABELA 1-1

| | | |
|---|---------------|--|
|  <p>099221</p> | <p>099221</p> | <p>Keep all persons a safe distance away from work area when operating the unit.</p> |
|  <p>096314</p> | <p>096314</p> | <p>Keep all persons a safe distance away from work area when operating the unit.</p> |
|  <p>096316</p> | <p>096316</p> | <p>Do not open or close the electric box when the switch is not in the "0" position.</p> |

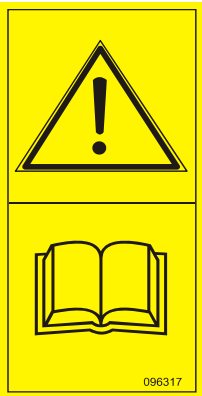
1 Safety Instructions

Safety Labels Description

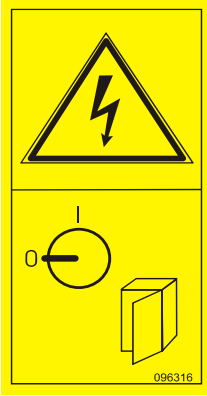
TABELA 1-1







| | | |
|---|---------------|--|
|  | <p>096319</p> | <p>Disconnect power supply before opening the box.</p> |
|  | <p>098177</p> | <p>Disconnect power supply before servicing.</p> |
|  | <p>099540</p> | <p>CAUTION! Gear danger – keep a safe distance away!</p> |

TABELA 1-1

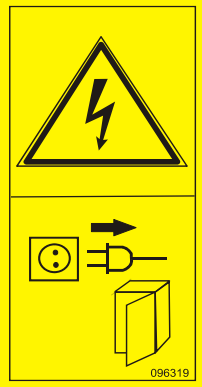
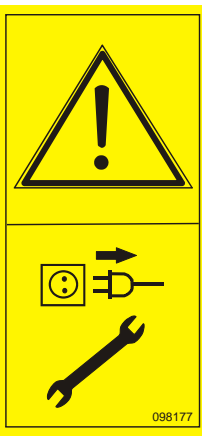
| | | |
|---|----------------|---|
|  | <p>S12004G</p> | <p>Always wear safety goggles when operating the equipment.</p> |
|  | <p>S12005G</p> | <p>Always wear protective ear muffs when operating the equipment.</p> |
|  | <p>P85070</p> | <p>CE safety certification</p> |
|  | <p>099780</p> | <p>Caution! Slabs falling off the deck!</p> |

SECTION 2 OPERATION

2.1 Log Deck Components

 **WARNING!** Always stay a safe distance from moving equipment and logs when operating the Log Deck. Failure to do so may result in serious injury or death.

The major components of the Log Deck are identified below.

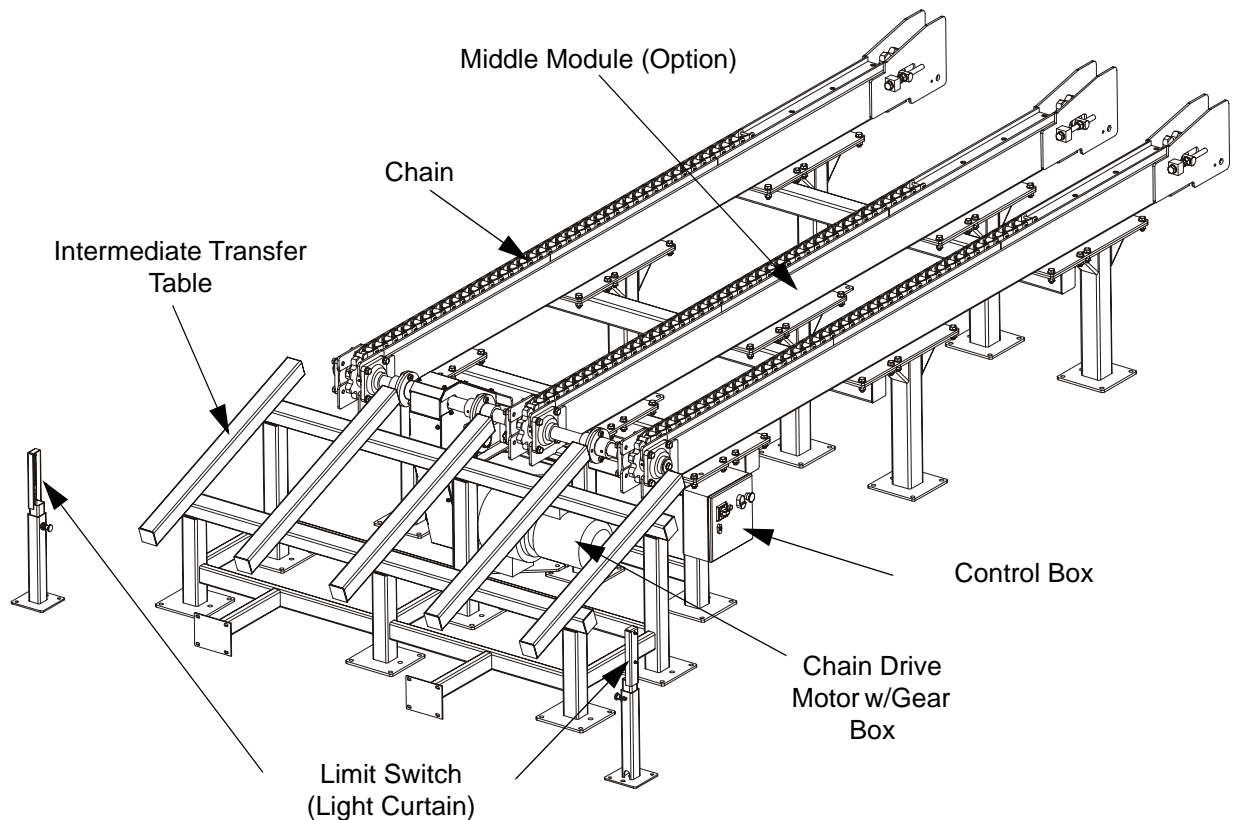



FIG. 2-1 LOG DECK

2.2 Log Deck Setup

 **IMPORTANT!** Before starting to use the Log Deck you have to meet the following conditions.

- Set up the deck on firm and level ground. Fasten the unit to the ground.
- The Log Deck can be operated in temperature range from -20° C to 40° C only.

- The operator's position is shown in the figure below.
- Setup and connect the light curtain posts according to figure 4-1 and electric diagram.

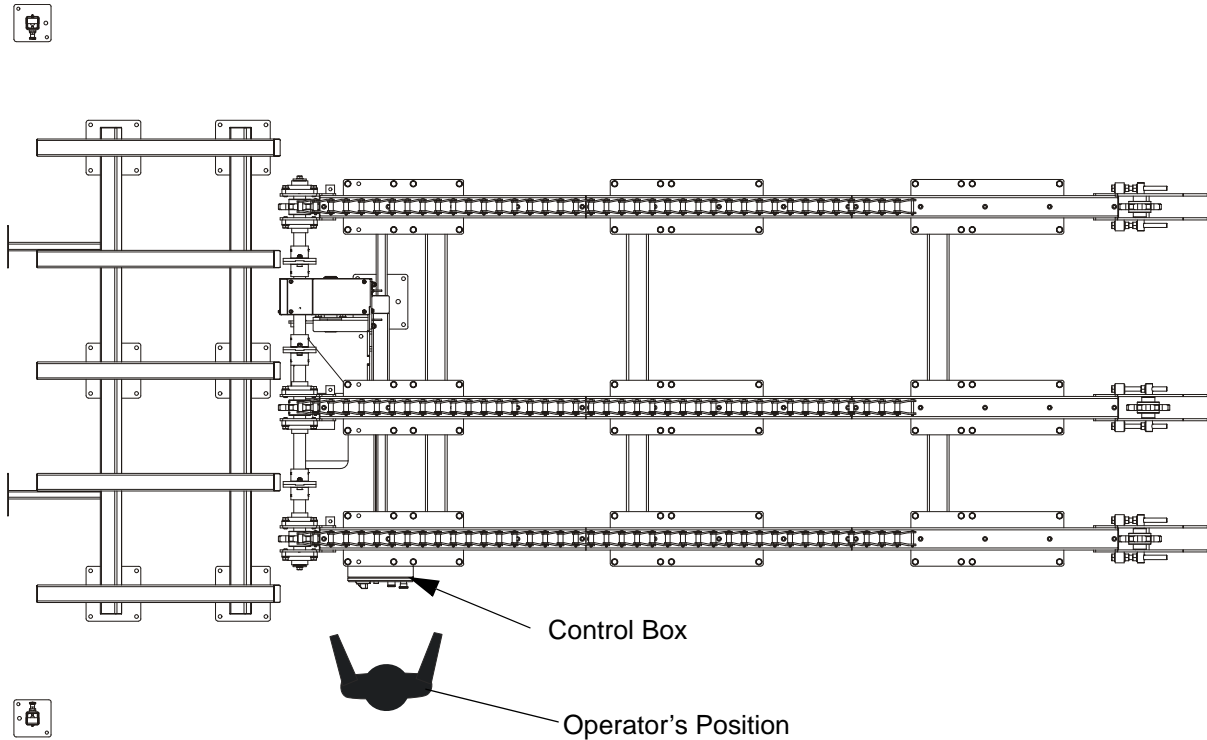

- Have a qualified electrician install the power supply (according to EN 60204 Standard). The power supply must meet the specifications given in the table below.

| 3-Phase Volts | Fuse Disconnect | Recommended Wire Size |
|---------------|-----------------|-----------------------|
| 400 VAC | 4 Amp | 1.5 mm ² |

TABLE 2-1



IMPORTANT! When starting the unit for the first time, check that the chain rotation direction is correct. If it is incorrect, invert the phases in the phase inverter located in the power socket (in the electric box).

2 Operation

Log Deck Operation



IMPORTANT! When starting the equipment for the first time, let it run for the first 1-2 hours without load.

2.3 Log Deck Operation

To start or stop the Log Deck, use the START/STOP switch located on the control box.

In case of any danger to persons or equipment, push the emergency stop button. This stops the Log Deck. To release the stop, turn the emergency stop button clockwise. The deck will not restart until the emergency stop is released.

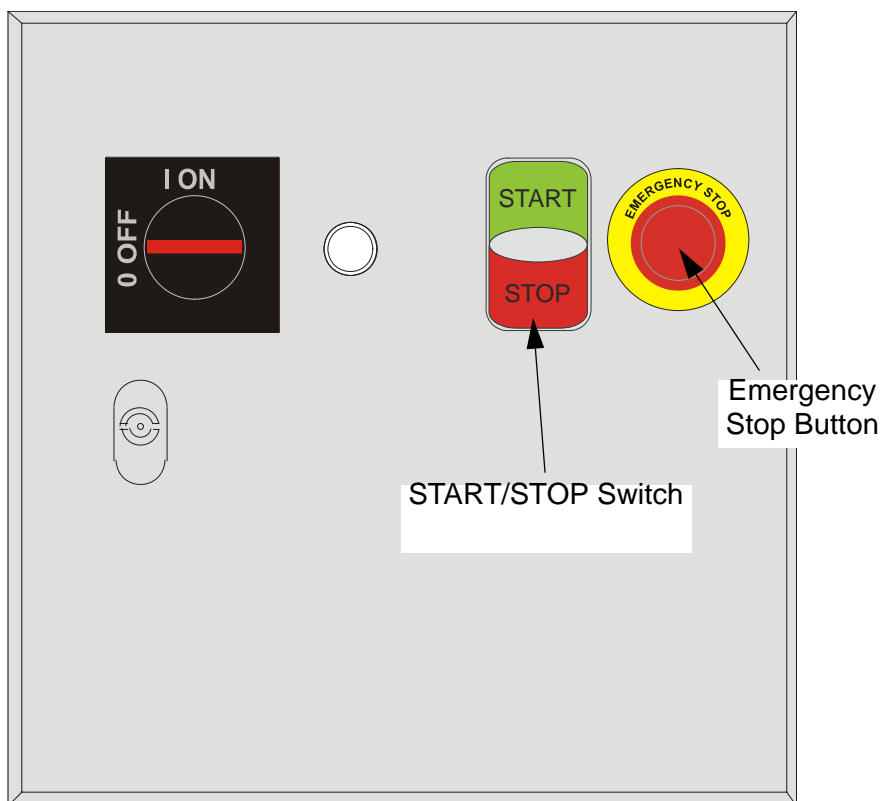

FIG. 2-1



CAUTION! If at any time you need to immediately stop the chain drive motor, press the emergency stop button located on the electric box.

After engaging the Log Deck chain, the logs placed on the deck are fed onto the Incline Log Deck .



CAUTION! If the log to be cut is short, place it on the

middle module beam and on the beam located at the control box. Failure to do so may result in serious injury. A Log of at least 700mm length can be transferred on the Log Deck.



CAUTION! If the Log Deck is not equipped with the middle module, the minimum length of a log that can be transferred on the deck is 1600 mm.



WARNING! Before operating the Log Deck, fasten its legs to the ground. Failure to do so may result in serious injury or death.



CAUTION! Never load logs on the Log Deck from a height of above 20cm. Damage to the deck may result.

SECTION 3 MAINTENANCE

This section lists the maintenance procedures that need to be performed.



This symbol indicates the interval (hours of operation) at which each maintenance procedure should be performed.

3.1 Lubrication



CAUTION! Never apply grease to the transfer chain. It causes sawdust buildup in chain links.



1. Using the grease fittings, lubricate the drive shaft bearings every 50 hours of operation.

See Figure 3-1.

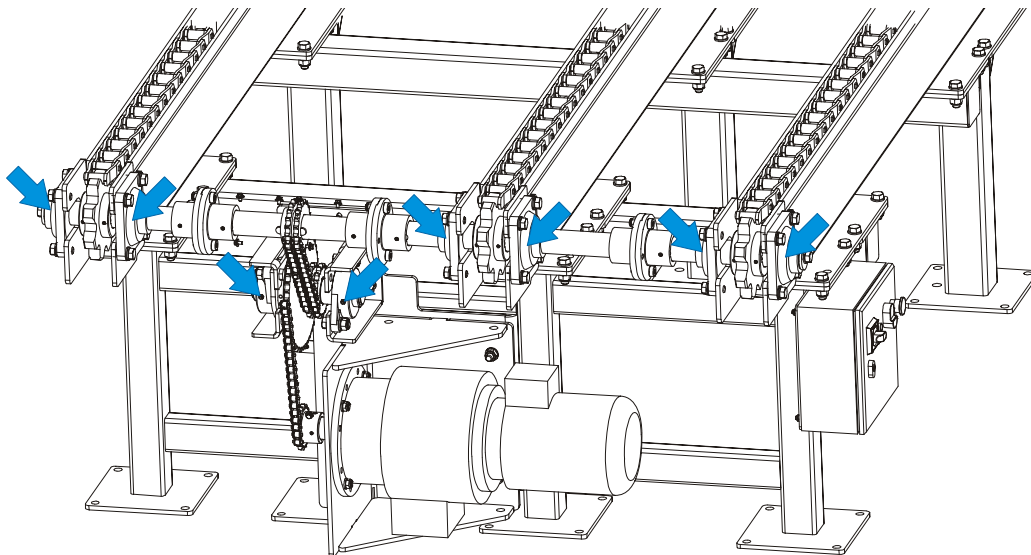

FIG. 3-1

2. Make sure all safety decals are readable. Remove sawdust and dirt. Replace any damaged or unreadable decals immediately. Order decals from your Wood-Mizer Customer Service Representative.

3.2 Transfer Chain Tension



CAUTION! Do not overtension the chains of TVS, log decks and transfer decks. Overtensioning may lead to premature failure of the gears, the bearings, the rollers and the chains.

See **Figure 3-2**. Use the adjustment bolts shown below to adjust the transfer chain tension.

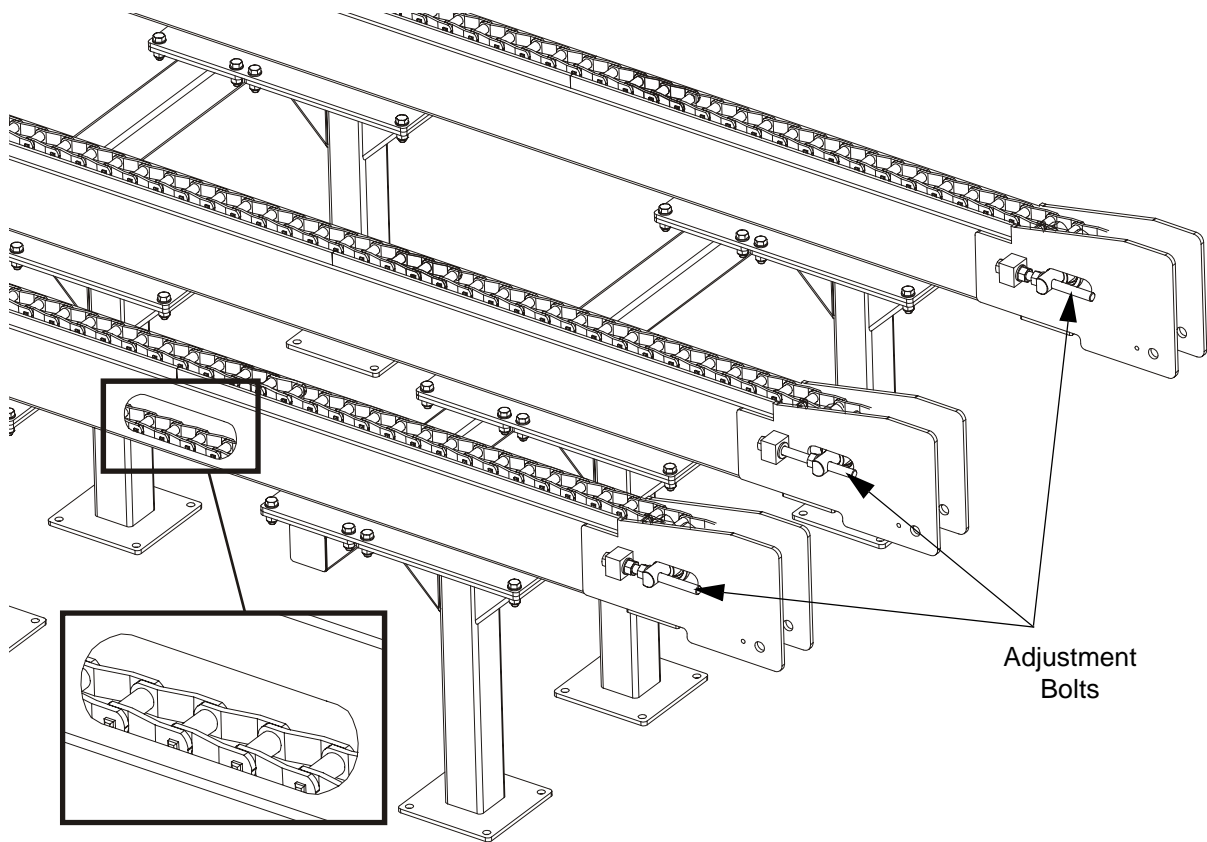

FIG. 3-2



CAUTION! The part of the transfer chain located inside the frame tube should not rub against the bottom of the tube.

3.3 Drive Chain Tension

Check tensions of the drive chains every 40 hours of operation and adjust as necessary. The chains should have approximately 1,5 cm of slack.

See Figure 3-3. Loosen the mounting bolts and move the motor along with the mounting plate in the direction indicated by the arrows.

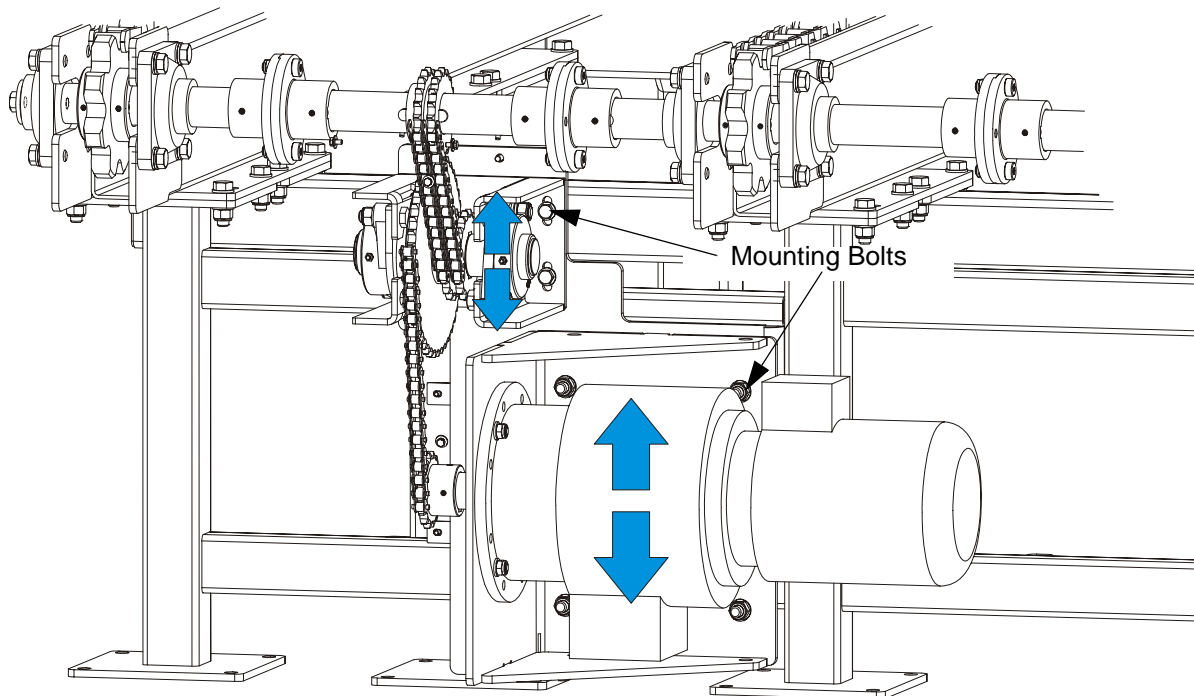

FIG. 3-3

SECTION 4 SPECIFICATIONS

4.1 Log Deck Dimensions

See Figure 4-1. The overall dimensions of the SLPLD3.6 Log Deck are shown below (all dimensions are in millimeters).

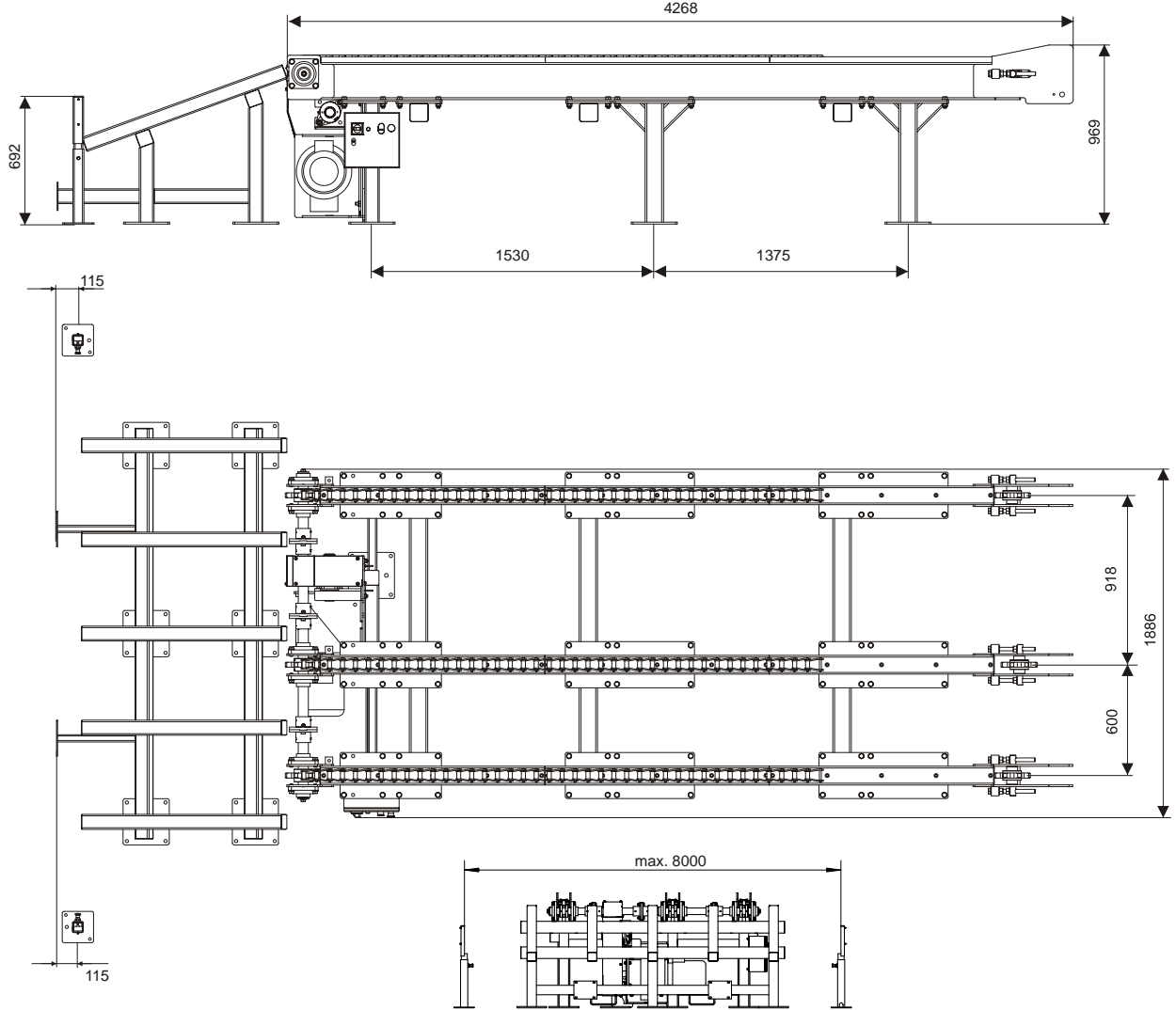

FIG. 4-1 SLPLD3.6

See Figure 4-2. The overall dimensions of the SLPLD6.0 Log Deck are shown below

4 SPECIFICATIONS

Log Deck Dimensions

(all dimensions are in millimeters).

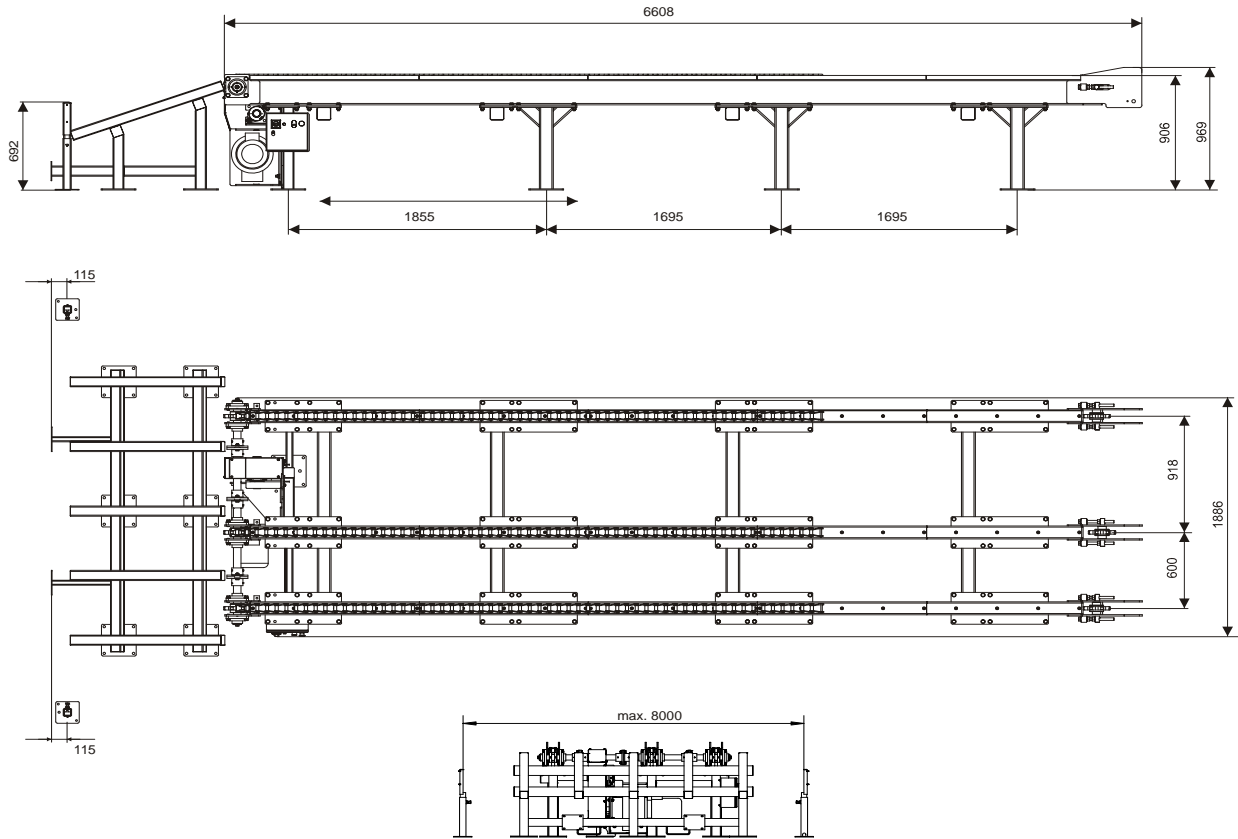

FIG. 4-2 SLPLD6.0

See Figure 4-3. The figure below shows anchor locations of the Log Deck feet.

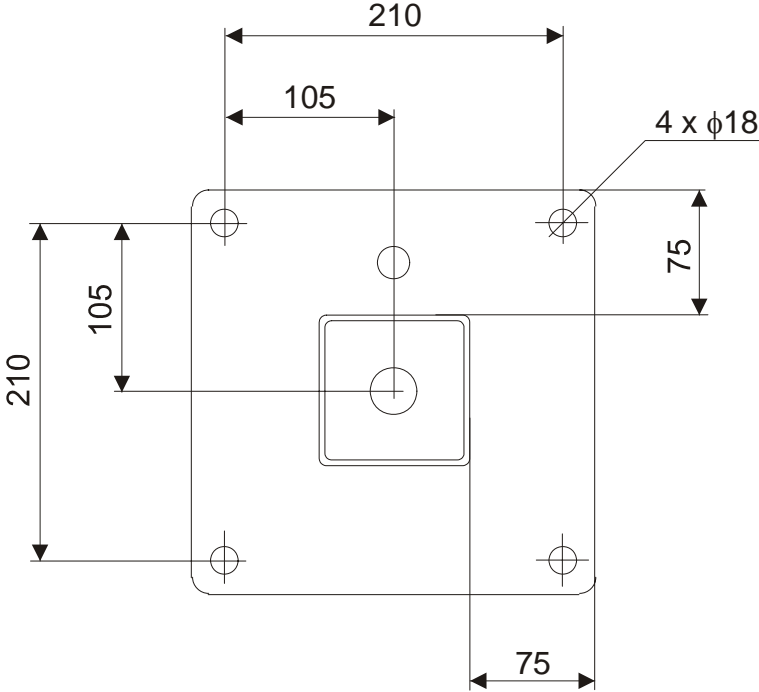

FIG. 4-3

See Table 4-1. See the table below for the weight of your Log Deck.

| Type | Weight |
|----------|---------|
| SLPLD3.6 | 1100 kg |
| SLPLD6.0 | 1300 kg |

TABLE 4-1

4.2 Motor Specifications

See Table 4-2. The specifications of the Log Deck motor are listed below.

| Motor Type | Manufacturer | Power | Other Data |
|-------------|--------------|-------|---------------------------------|
| AG-AL112-4M | AG MOTORS | 4 kW | 1430 r.p.m. 3x230/400V, 50Hz |

TABLE 4-2

4 SPECIFICATIONS

Electrical Diagram

4.3 Electrical Diagram

See Figure 4-4. Log Deck electrical diagram is shown below.

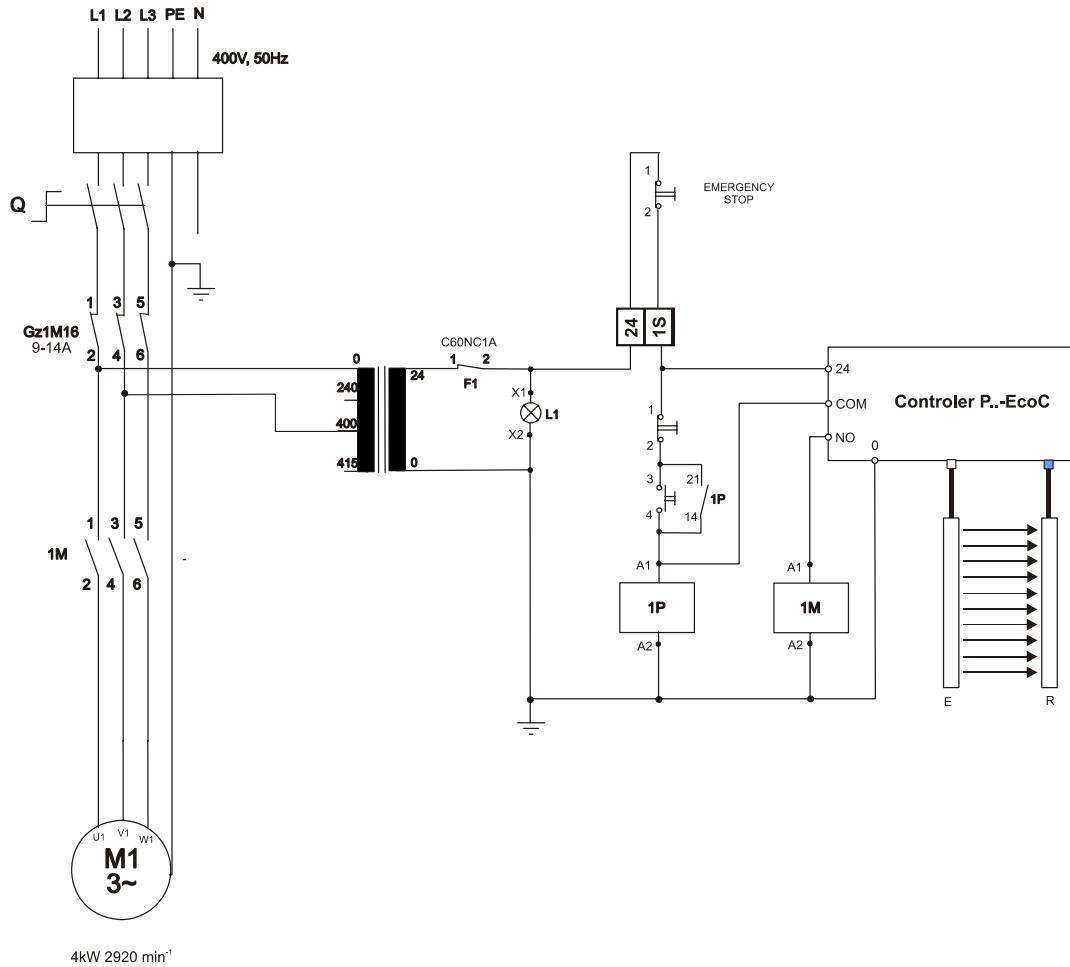

FIG. 4-4

4.4 Electrical Components

See Table 4-3. Log Deck electrical components are listed below.

| Symbol | Wood-Mizer Part No. | Description |
|--------|---------------------|-------------------------|
| Q | 089801 | Switch, ABB OT16E3 |
| 1M | 084451 | Contactora, LC1K12B7 |
| Gz | 084454 | Switch, C60N 1P C1 |
| L1 | 090448 | Control Lamp, White M22 |

TABLE 4-3

SECTION 5 LOG DECK PARTS

5.1 Chain Guide Assembly

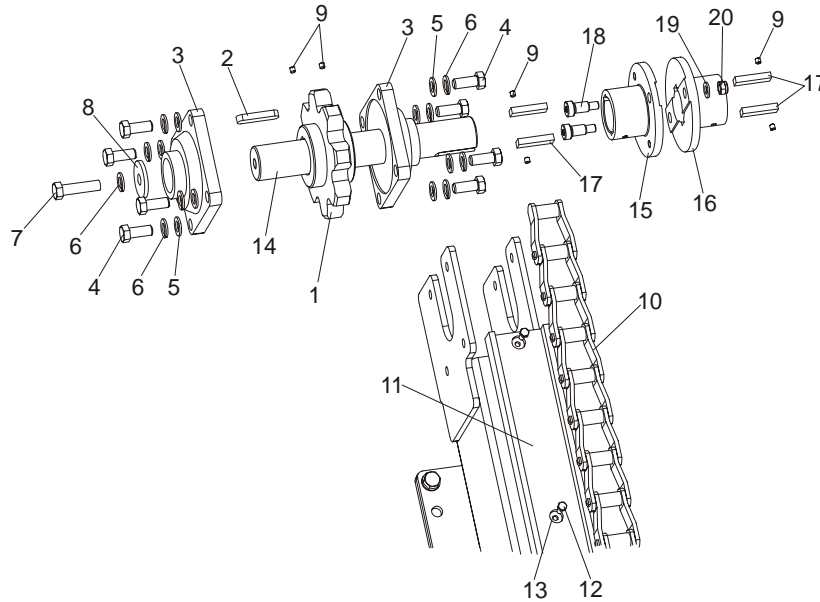

TVS_116

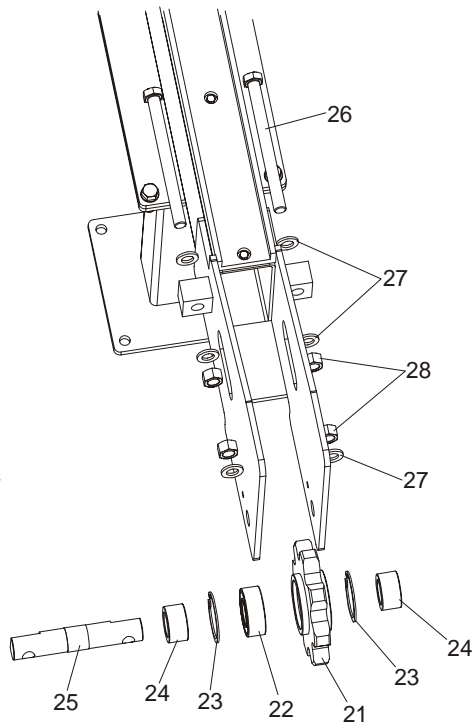

| REF | DESCRIPTION (◆ Indicates Parts Available In Assemblies Only) | PART # | QTY. |
|-----|--|----------|------|
| 1 | SPROCKET, Z8 OXIDIZED | 089888-1 | 1 |
| 2 | KEY, A16X10X70 PARALLEL | 098029 | 1 |
| 3 | BEARING, UCF 211 W/HOUSING (FOR 55 DIA. SHAFT) | 089889 | 2 |

5

LOG DECK PARTS

Chain Guide Assembly

| | | | | |
|----|--|-----------|----|--|
| 4 | BOLT, M16X40-8.8 HEX HEAD FULL THREAD ZINC | F81006-13 | 8 | |
| 5 | WASHER, 17 FLAT ZINC | F81058-1 | 8 | |
| 6 | WASHER, 16.3 SPLIT LOCK ZINC | F81058-2 | 8 | |
| 7 | BOLT, M16X65-8.8-B HEX HEAD FULL THREAD ZINC | F81006-1 | 1 | |
| 8 | WASHER, SPECIAL | 098012-1 | 1 | |
| 9 | SCREW, M8X8 45H GEOMET HEX SOCKET SET FLAT POINT | F81014-1 | 6 | |
| 10 | CHAIN, LOG DECK 8290MM 125 LINKS (SLPLD3.6) | 504581 | 1 | |
| | CHAIN, LOG DECK 12930MM 195 LINKS (SLPLD6.0) | 504583 | 1 | |
| 11 | CHANNEL, UHMW CONVEYOR | 033722 | 3 | |
| 12 | BOLT, M8X20-5.8 HEX HEAD FULL THREAD ZINC | F81002-1 | 15 | |
| 13 | WASHER, 6.5 SPECIAL FLAT ZINC | F81053-11 | 15 | |
| 14 | SHAFT, SLPLD END PART | 099233 | 1 | |
| 15 | BUSHING, FLANGED W/LOCK | 099232-1 | 1 | |
| 16 | BUSHING, FLANGED | 099236-1 | 1 | |
| 17 | KEY, A16X10X60 PARALLEL | 099238 | 4 | |
| 18 | BOLT, 16/M12X25 12.9 ISO 7379 SHOULDER | F81004-56 | 2 | |
| 19 | WASHER, 13 FLAT ZINC | F81056-1 | 2 | |
| 20 | NUT, M12-8 HEX NYLON ZINC LOCK | F81034-2 | 2 | |
| 21 | SPROCKET, Z8 REAR OXIDIZED | 089919-1 | 1 | |
| 22 | BEARING, 3208B.2RSR.TVH FAG | 088449 | 1 | |
| 23 | RING, W80 INSIDE RETAINING | F81090-25 | 2 | |
| 24 | BUSHING, SPROCKET ZINC-PLATED SPACER | 089916-1 | 2 | |
| 25 | AXLE, CHAIN TENSION SPROCKET ZINC-PLATED | 089915-1 | 1 | |
| 26 | BOLT, M20X240-8.8 HEX HEAD FULL THREAD ZINC | F81007-1 | 2 | |
| 27 | WASHER, 21 FLAT ZINC | F81059-2 | 6 | |
| 28 | NUT, M20-8 HEX ZINC | F81037-1 | 4 | |

| | | | | |
|----|---|-----------|----|--|
| 19 | CHAIN, 12B-1-65 (1.25 R.M.) | 099248 | 1 | |
| 20 | LINK, 12B-1PZ | 090713 | 1 | |
| 21 | SPROCKET, 12B Z16 OXIDIZED | 090303-1 | 1 | |
| 22 | BRACKET, LOG DECK MOTOR MOUNT | 089897-1 | 1 | |
| 23 | MOTOREDUCER, SBCM 180/112M-4/32 | 089892 | 1 | |
| 24 | BOLT, M12x45-8.8 HEX HEAD ZINC | F81004-32 | 4 | |
| 25 | WASHER, 13 FLAT ZINC | F81056-1 | 8 | |
| 26 | NUT, M12-8 HEX NYLON ZINC LOCK | F81034-2 | 4 | |
| 27 | BOLT, M16x50-8.8 HEX HEAD FULL THREAD ZINC | F81006-7 | 4 | |
| 28 | WASHER, 17 FLAT ZINC | F81058-1 | 8 | |
| 29 | NUT, M16-8 HEX NYLON ZINC LOCK | F81036-2 | 4 | |
| 30 | BOLT, M12X40-8.8 HEX HEAD ZINC | F81004-1 | 2 | |
| 31 | SHAFT, SLPLD MIDDLE PART | 099237 | 1 | |
| 32 | WASHER, 13 FLAT ZINC | F81056-1 | 14 | |
| 33 | NUT, M12-8-B HEX ZINC | F81034-1 | 10 | |
| 34 | BUSHING, FLANGED W/LOCK | 099232-1 | 3 | |
| 35 | BUSHING, FLANGED | 099236-1 | 3 | |
| 36 | KEY, A16X10X60 PARALLEL | 099238 | 12 | |
| 37 | BOLT, 16/M12X25 12.9 ISO 7379(BOSSARD) SHOULDER | F81004-56 | 6 | |

5.3 Guards

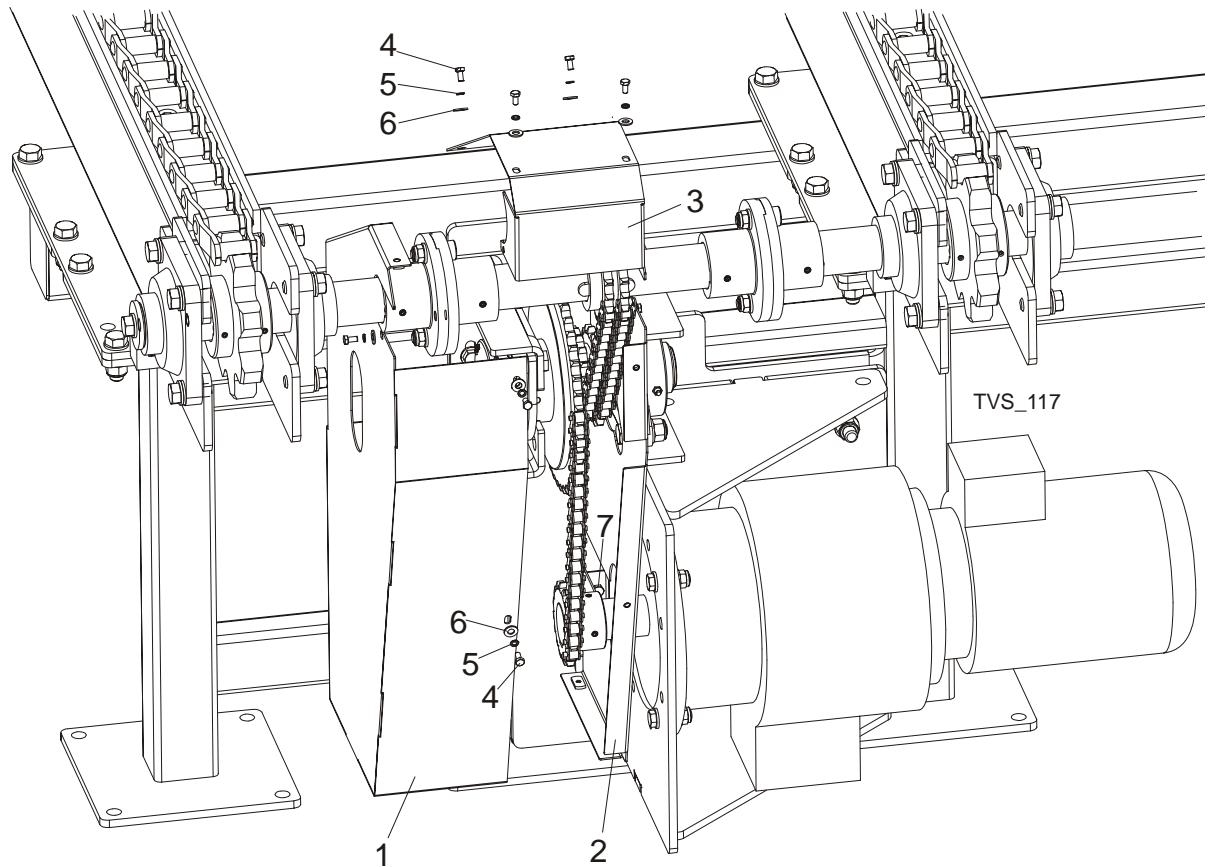

| REF | DESCRIPTION (◆ Indicates Parts Available In Assemblies Only) | PART # | QTY. | |
|-----|--|----------|------|--|
| 1 | GUARD, LEFT SIDE | 098857-1 | 1 | |
| 2 | GUARD, RIGHT SIDE | 098858-1 | 1 | |
| 3 | GUARD, TOP | 098859-1 | 1 | |
| 4 | BOLT, M6x12-8.8 HEX HEAD FULL THREAD ZINC | F81001-7 | 10 | |
| 5 | WASHER, Z 6.1 SPLIT LOCK ZINC | F81053-3 | 10 | |
| 6 | WASHER, 8.4 FLAT ZINC | F81054-1 | 12 | |
| 7 | NUT, M8-8-B HEX NYLON ZINC LOCK | F81032-2 | 2 | |

5.4 Legs

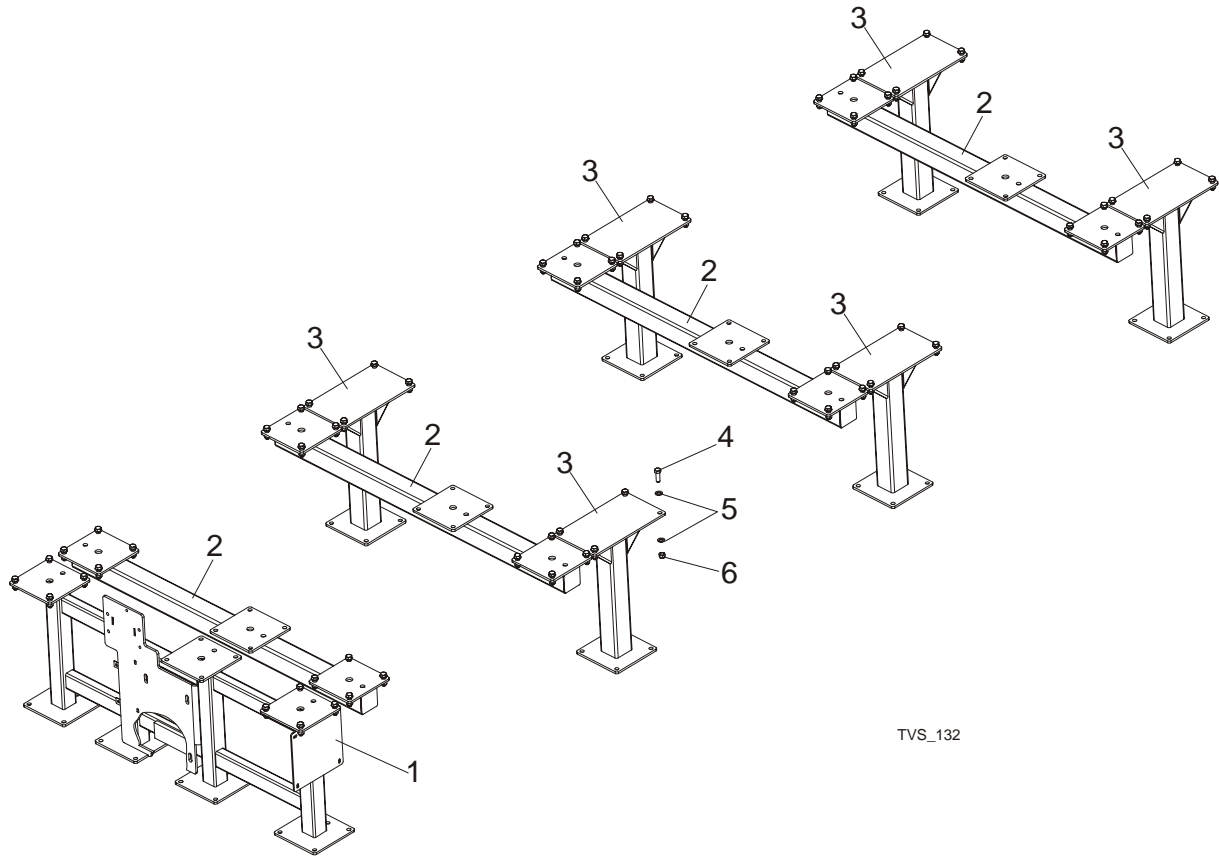

TVS_132

| REF | DESCRIPTION (◆ Indicates Parts Available In Assemblies Only) | PART # | QTY. | |
|-----|--|----------|------------------|--|
| 1 | LINK, SLPLD MIDDLE | 098848-1 | 1 | |
| 2 | CROSSBEAM, SLPLD | 089880-1 | 4 | |
| 3 | LEG, SLPLD HORIZONTAL H=500MM | 098923-1 | 6/9 ¹ | |
| 4 | BOLT, M16 X 50-8.8 HEX HEAD | F81006-7 | 64/96 | |
| 5 | WASHER, 17 FLAT ZINC | F81058-1 | 128/212 | |
| 6 | NUT, M16,HEX, NYLON ZINC LOCK | F81036-2 | 64/96 | |

¹ Version with middle module.

5.5 Control Box

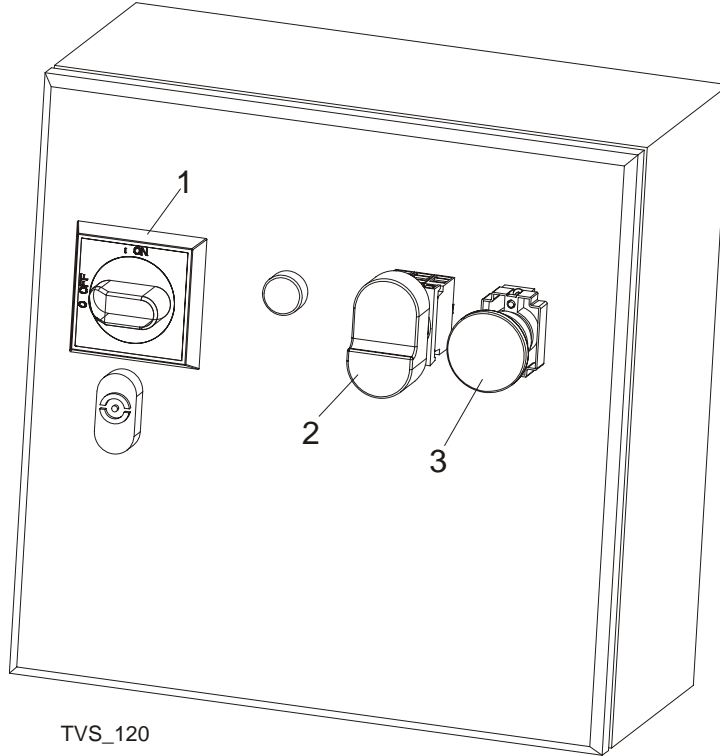

| REF | DESCRIPTION (◆ Indicates Parts Available In Assemblies Only) | PART # | QTY. | |
|-----|--|-----------------|------|--|
| | ELECTRIC BOX W/LIGHT CURTAIN | 099862 | 1 | |
| 1 | KNOB, OHB2AJ ABB SWITCH | 088265-1 | 1 | |
| 2 | SWITCH, 24V START/STOP ILLUMINATED | 090452 | 1 | |
| 3 | BUTTON, XB4 BS542 EMERGENCY STOP | 086556 | 1 | |

5.6 Decals

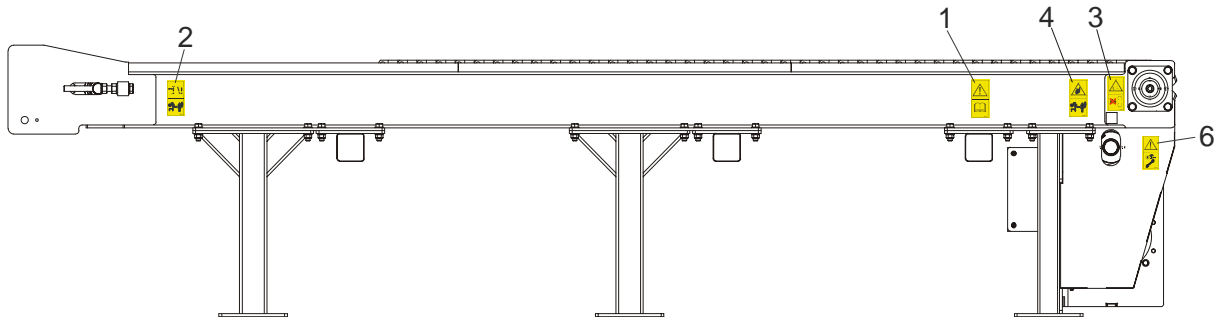
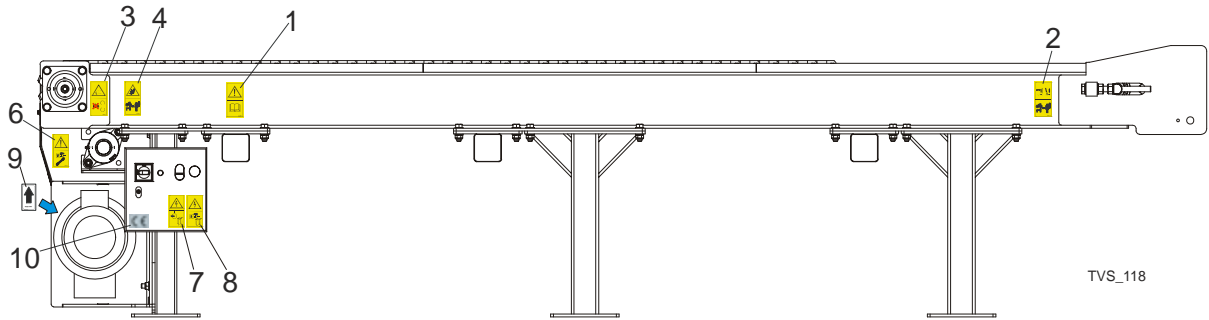

| REF | DESCRIPTION (◆ Indicates Parts Available In Assemblies Only) | PART # | QTY. |
|-----|--|---------------|------|
| | DECAL KIT, SLPLD PICTOGRAPHIC | 100598 | 1 |
| 1 | Decal, Read the operator's manual | 096317 | 2 |
| 2 | Decal, Keep away warning | 096314 | 2 |
| 3 | Decal, Gear caution | 099540 | 2 |
| 4 | Decal, Keep a safe distance away | 099221 | 2 |
| 5 | Decal, Sawmill covers caution | 099220 | 1 |
| 6 | Decal, Disconnect power supply before servicing | 098177 | 1 |
| 7 | Decal, Hazardous voltage inside the electric box | 096316 | 1 |
| 8 | Decal, Remove the plug before opening the electric box | 096319 | 1 |
| 9 | Decal, 1400 RPM Motor Direction | S20097H | 1 |
| 10 | DECAL, CE CERTIFIED SAWMILL | P85070 | 1 |

5.7 Light Curtain

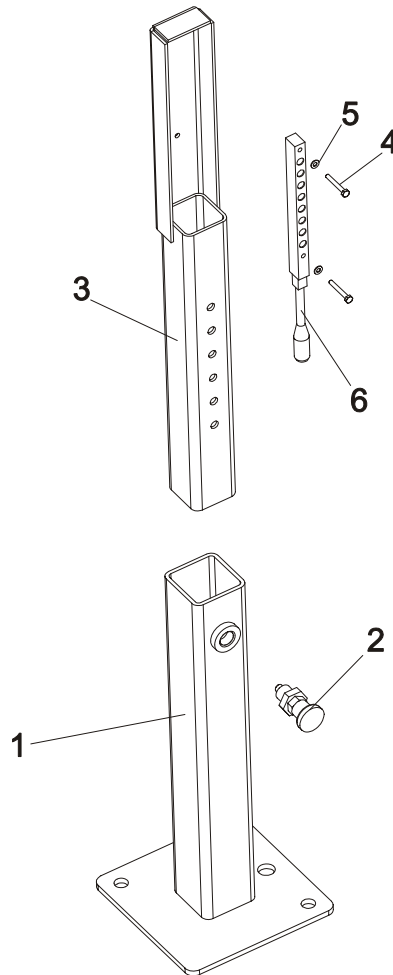

| REF | DESCRIPTION (◆ Indicates Parts Available In Assemblies Only) | PART # | QTY. |
|-----|--|---------------|------|
| | POST, LIGHT CURTAIN MOUNT - COMPLETE | 099153 | 2 |
| 1 | POST, LIGHT CURTAIN MOUNT - BASE | 099150-1 | 1 |
| 2 | PIN, DETENT | 090197 | 1 |
| 3 | POST, LIGHT CURTAIN MOUNT - ADJUSTABLE PART | 099152-1 | 1 |
| 4 | BOLT, M4x30 8.8 HEX HEAD FULL THREAD ZINC | F81011-5 | 2 |
| 5 | WASHER, 4.3 FLAT ZINC | F81051-2 | 2 |
| 6 | CURTAIN, MO433(8-ELEM.-170MM) LIGHT | 099154 | 2 |

EC declaration of conformity according to EC Machinery Directive 2006/42/EC

We herewith declare,

Wood-Mizer Industries sp. Z O.O.
114 Nagorna street, 62-600 Kolo; Poland.

That the following described machine in our delivered version complies with the appropriate basic safety and health requirements of the EC Machinery Directive 2006/42/EC based on its design and type, as brought into circulation by us. In case of alteration of the machine, not agreed by us, this declaration is no longer valid.

Designation of the machine:

Log Incline Deck

TYPE:

SLPILD

No. of manufacturer:

.....

Applicable EC Directives:

EC Machinery Directive 2006/42/EC
EC Low-Voltage Directive 73/23/EEC
EC Electromagnetic Compatibility Directive
2004/108/EC

Responsible for Technical Documentation:

Roman Frontczak / R&D Director

Date/Authorized Signature:

29. 12. 2009



Title :

R&D Director