

G38S ELECTRICAL INFORMATION

**LT40HD Super
LT50HD**

**Rev. J9.01 - K2.00
Rev. A1.01 - A4.00**

Component List				
Item	Mfg. Part No.	Mfg.	Wood-Mizer Part No.	Description
A1	023695	Wood-Mizer	023695	Alternator, 140 Amp
CB1	70-1648-009	Mech. Prod.	015527	Breaker, 70 Amp Man.Reset Panel Mount, Pwr Feed
CB2	1648-009-050-006	Mech. Prod.	021256	Breaker, 50 Amp Manual Reset Panel Mount, Up/Down
CB3	123A15A2	Richard's Elec	E20430	Breaker, 15 Amp Manual Reset, Blade Guide
CB4	123A15A2	Richard's Elec	E20430	Breaker, 15 Amp Manual Reset, Accessory
CB5	123A15A2	Richard's Elec	E20430	Breaker, 15 Amp Manual Reset, Ignition
CB6	123A15A2	Richard's Elec	E20430	Breaker, 15 Amp Manual Reset, Start
CB7	123A15A2	Richard's Elec	E20430	Breaker, 15 Amp Manual Reset, Board Return
D1, D4 - D5, D8 - D10¹	015426	Wood-Mizer	015426	Diode Assembly, Solenoid Coil Chassis
D7	024123	Wood-Mizer	024123	Diode Assembly, Inductive Kick Protection
F1 - F2¹, F3	RL-225	Gould	P11550	Fuse Link, 225 Amp, 250 Volt For Hydraulic + 12 Volt Circuit
F8	ATO-004	Little Fuse	024150-4 ²	Fuse, 4 Amp ATO Blade Pink
G1	8A31DTM	Deka	025841 ³	Battery, 12 Volt (See Battery Specifications)
H1	732-0004	Redington Counters	015401 ⁴	Hour Meter, 12 Volt DC
KS1	121801	General	P04350	Key Switch, 4-position (Accessory, Off, Ignition, Start)
L6	586-902	Stancor	016371	Solenoid Kit, 200A 12V SPST
M1	108677.00	Leeson	024169	Motor, 3/4HP 12VDC TEFC Power Feed w/o Base
M2	108678.00	Leeson	015174	Motor, 3/4HP 12VDC TEFC Up/Down w/Base
M3	P09698-1	Klauber	A10365	Motor, 12 Volt Blade Guide Arm 53:1 Gear
M4	P09698-1	Klauber	A10365	Motor, 12 Volt Board Return 53:1 Gear
M5, M6¹	08174	Monarch	052807	Motor, 12 Volt Hydraulic Pump
PCB2	015409	ICS	015409	Board, LED Circuit
PNL4	051887	Wood-Mizer	051887 ⁵	Module Assembly, Power Feed
RS1	024260	Wood-Mizer	024260	Wire Assembly, Accessory Solenoid Voltage Drop
RS2¹	024451	Wood-Mizer	024451	Wire Assembly, Hydraulic Solenoid Voltage Drop
S1	2601-AF2-S11	Square D	E20439	Drum Switch, Power Feed Fwd/Reverse Motor
S2	2601-AF2-S12	Square D	E20440	Drum Switch, Up/Down Motor
S3	34-591Q	Pollak	024200	Toggle Switch, Blade Guide In/Out Motor
S4	34-591Q	Pollak	024200	Toggle Switch, Board Return Motor
S5¹	024198	Wood-Mizer	024198	Switch, Hydraulic Pump Levers
S6	52-099-09-S	Kohler		Switch, Oil Pressure Sensor
SOL4-SOL5	586-911	Stancor	016370	Solenoid Kit, 200A 12V DPST
SOL8 - SOL9, SOL10¹	586-902	Stancor	016371	Solenoid Kit, 200A 12V SPST Hydraulic Pump Motor
V1	G51190145	Parker	016280	Valve, Waterlube Solenoid
VR1	024450-1	Wood-Mizer	024450-1	Potentiometer, Variable Resistance Power Feed

¹ Component applies to hydraulic models only.

² 4A fuse 024150-4 replaces 2A fuse 024150-2 to eliminate nuisance tripping (11/07).

³ Battery 025841 replaced 12 Volt Battery (015475) supplied prior to LT40 Super Rev. J7.09, LT40HD Super Rev. K3.08 and LT50 Rev. A5.08.

⁴ Was ENM Corp. #T14BH517BC9 (2/09).

⁵ Power Feed Module 051887 discontinued 12/10. If sawmill not equipped with Accuset or Accuset 2 option, use kit 069460 to retrofit power feed with dual-axis motor control module. Use kit 052972 if sawmill equipped with original Accuset to retrofit to Accuset 2. Once sawmill upgraded to Accuset 2, use kit 069459 to retrofit for dual-axis control of power feed motor. If Accuset 2 is older than Rev. B.00 with original part 052974 single-axis control module (No MOT2A or MOT2B terminal studs), a new dual-axis module 057821LS-FR is required in addition to kit 069459.

Battery Specifications							
Group No.	Type No.	Performance Level		Approx. Weight (Wet)	Maximum Overall Dimensions		
		Cranking Performance	Reserve Capacity		Length	Width	Height
31	8A31DTM ¹	1000	185	59 lb. (26 Kg)	13" (330 mm)	6 3/4" (171 mm)	9 1/2" (241 mm)

¹ Battery 8A31DTM replaced battery 1131XPMF supplied prior to LT40 Super Rev. J7.09, LT40HD Super Rev. K3.08 and LT50 Rev. A5.08.

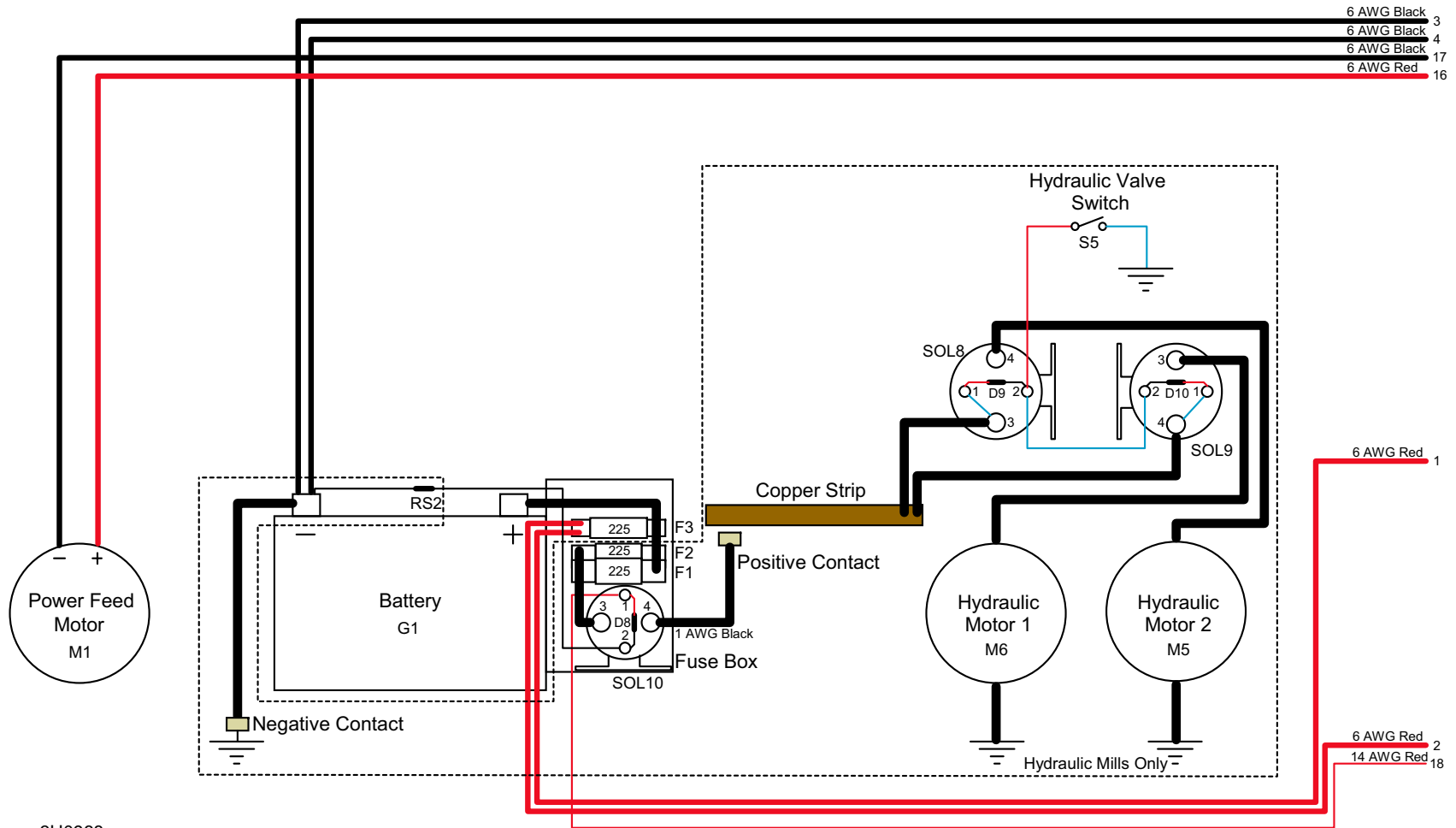

3H0968

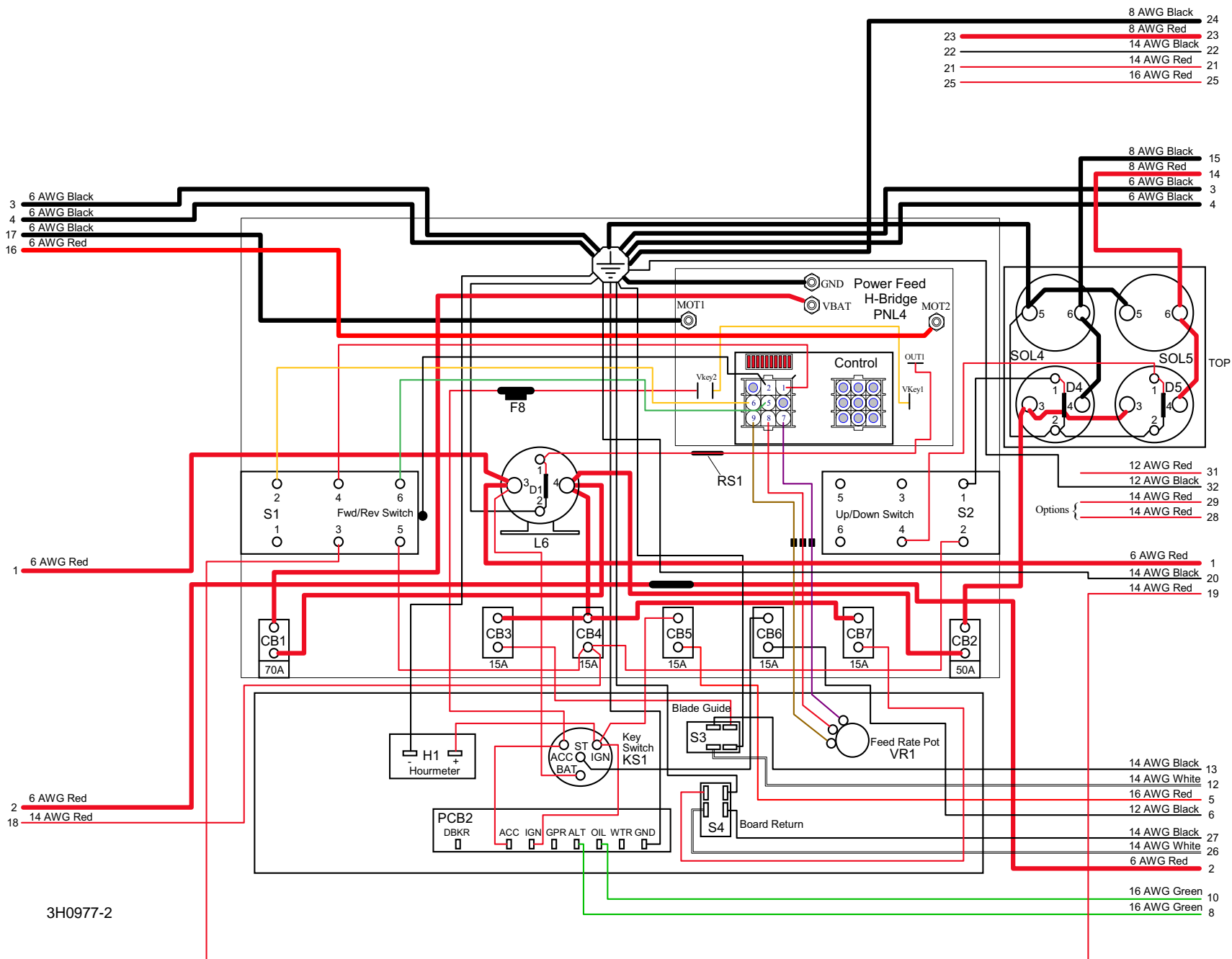

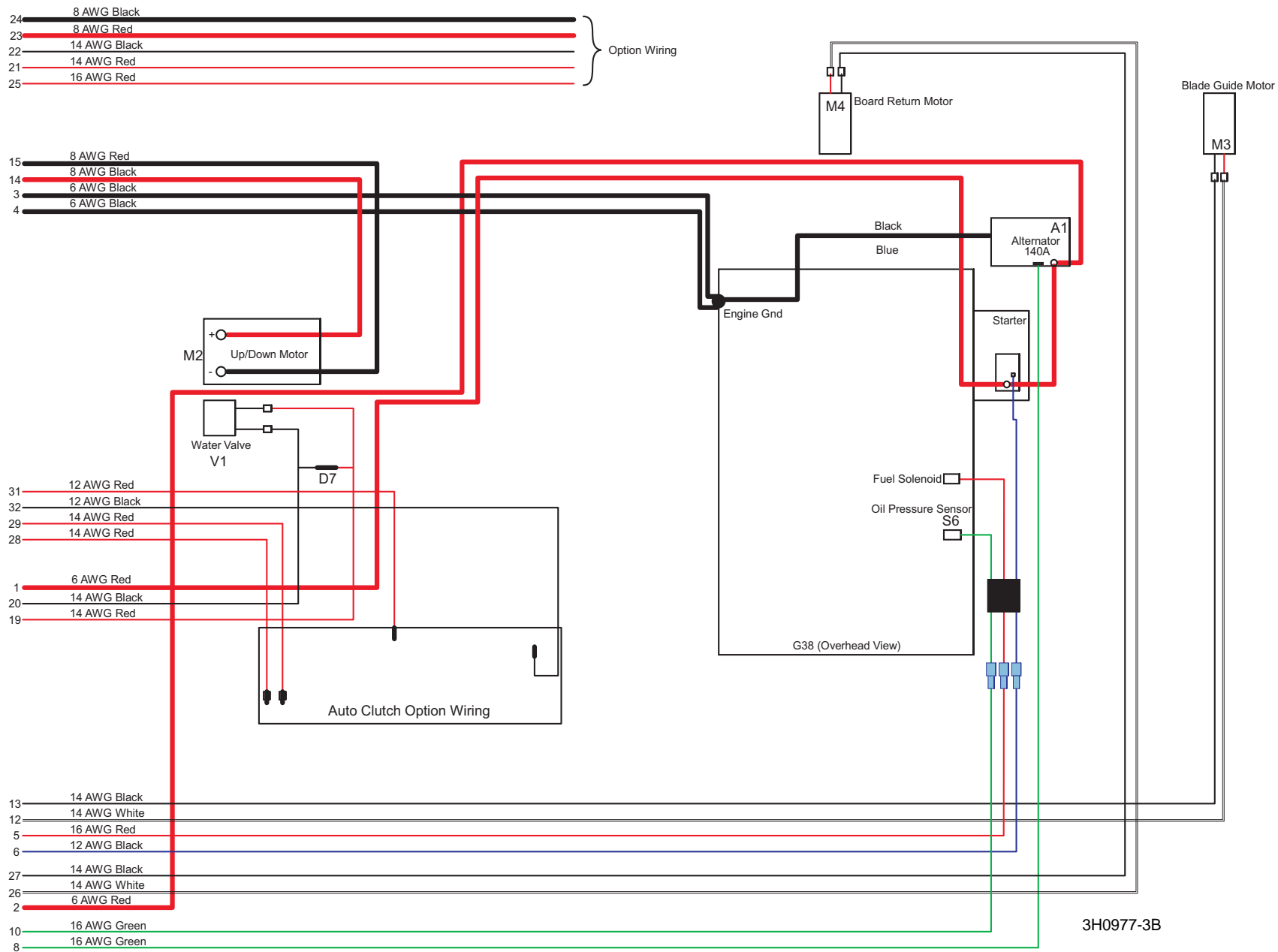

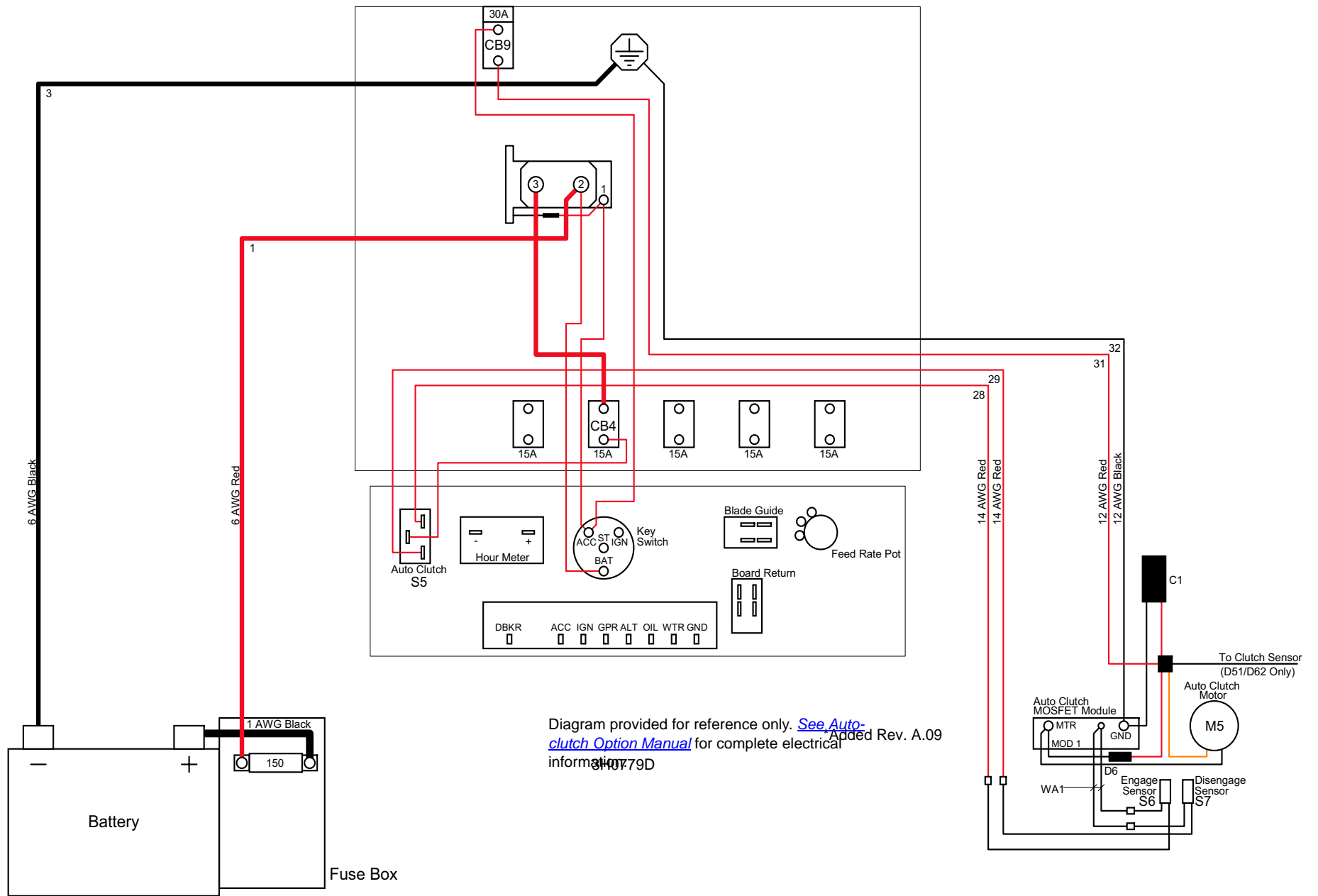

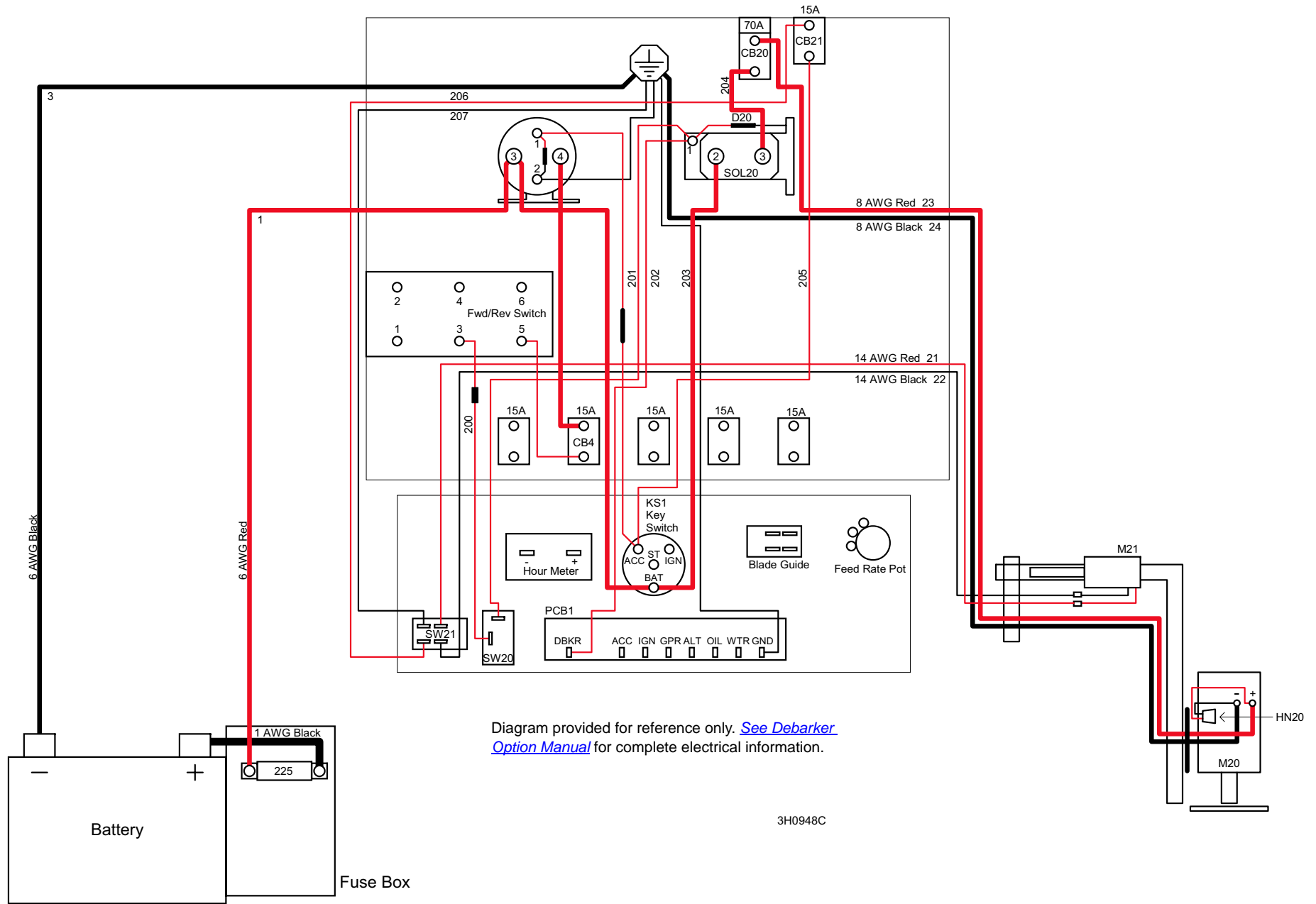

Diagram provided for reference only. [See Debarker Option Manual](#) for complete electrical information.

3H0948C

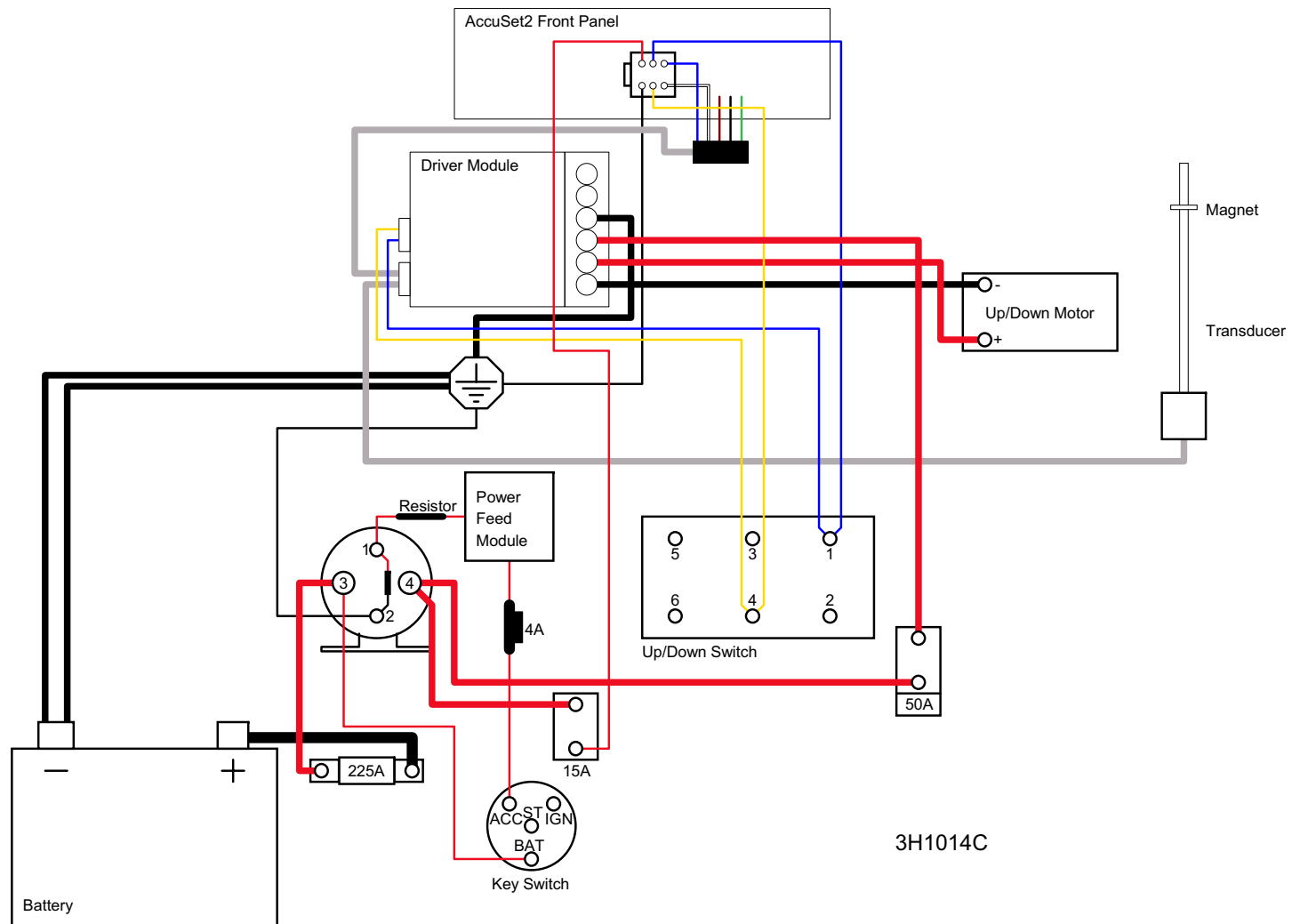

Diagram provided for reference only. [See Accuset 2 Option Manual](#) for complete electrical information.

G38S ELECTRICAL INFORMATION

LT40HD Super
LT50HD

Rev. K3.00 - K3.02
Rev. A5.00 - A5.02

Component List				
Item	Mfg. Part No.	Mfg.	Wood-Mizer Part No.	Description
A1	023695	Wood-Mizer	023695	Alternator, 140 Amp
BR1	K01134D300	Klauber	069519 ¹	Brake, Up/Down
CB1	70-1648-009	Mech. Prod.	015527	Breaker, 70 Amp Man.Reset Panel Mount, Pwr Feed
CB2	1648-009-050-006	Mech. Prod.	021256	Breaker, 50 Amp Manual Reset Panel Mount, Up/Down
CB3	123A15A2	Richard's Elec	E20430	Breaker, 15 Amp Manual Reset, Blade Guide
CB4	123A15A2	Richard's Elec	E20430	Breaker, 15 Amp Manual Reset, Accessory
CB5	123A15A2	Richard's Elec	E20430	Breaker, 15 Amp Manual Reset, Ignition
CB6	123A15A2	Richard's Elec	E20430	Breaker, 15 Amp Manual Reset, Start
CB7	123A15A2	Richard's Elec	E20430	Breaker, 15 Amp Manual Reset, Board Return
D1, D4 - D5, D8 - D10	015426	Wood-Mizer	015426	Diode Assembly, Solenoid Coil Chassis
D7	024123	Wood-Mizer	024123	Diode Assembly, Inductive Kick Protection
D11	069678	Wood-Mizer	069678 ²	Diode OR Assembly, Up/Down Brake
F1	LIT0298450	Littlefuse	053340	Fuse, 450A 32V Mega
F2	LIT0MEG225.X	Littlefuse	053339	Fuse, 225A 32V Mega
F8	ATO-004	Little Fuse	024150-4	Fuse, 4 Amp ATO Blade Pink
G1	8A31DTM	Deka	025841 ³	Battery, 12 Volt (See Battery Specifications)
H1	732-0004	Redington Counters	015401	Hour Meter, 12 Volt DC
KS1	121801	General	P04350	Key Switch, 4-position (Accessory, Off, Ignition, Start)
L6	586-902	Stancor	016371	Solenoid Kit, 200A 12V SPST
M1	108677.00	Leeson	024169	Motor, 3/4HP 12VDC TEFC Power Feed w/o Base
M2	108678.00	Leeson	015174	Motor, 3/4HP 12VDC TEFC Up/Down w/Base
M3	P09698-1	Klauber	A10365	Motor, 12 Volt Blade Guide Arm 53:1 Gear
M4	P09698-1	Klauber	A10365	Motor, 12 Volt Board Return 53:1 Gear
M5, M6	08174	Monarch	052807	Motor, 12 Volt Hydraulic Pump
PCB2	015409	ICS	015409	Board, LED Circuit
PNL4	051887	Wood-Mizer	051887 ⁴	Module Assembly, Power Feed
RS1	024260	Wood-Mizer	024260	Wire Assembly, Accessory Solenoid Voltage Drop
RS2	024451	Wood-Mizer	024451	Wire Assembly, Hydraulic Solenoid Voltage Drop
S1	2601-AF2-S11	Square D	E20439	Drum Switch, Power Feed Fwd/Reverse Motor
S2	2601-AF2-S12	Square D	E20440	Drum Switch, Up/Down Motor
S3	34-591Q	Pollak	024200	Toggle Switch, Blade Guide In/Out Motor
S4	34-591Q	Pollak	024200	Toggle Switch, Board Return Motor
S5	024198	Wood-Mizer	024198	Switch, Hydraulic Pump Levers
S6	52-099-09-S	Kohler		Switch, Oil Pressure Sensor
SOL4-SOL5	586-911	Stancor	016370	Solenoid Kit, 200A 12V DPST
SOL8 - SOL9, SOL10	586-902	Stancor	016371	Solenoid Kit, 200A 12V SPST Hydraulic Pump Motor
V1	G51190145	Parker	016280	Valve, Waterlube Solenoid
VR1	024450-1	Wood-Mizer	024450-1	Potentiometer, Variable Resistance Power Feed

¹ Brake added LT40 Super Rev. J7.06, LT40HD Super Rev. K3.05 & LT50HD Rev. A5.05 to prevent saw head from drifting during sawing. Use retrofit kit 062570 to retrofit previous revisions.

² Up/Down Brake Diode OR Assembly 069678 added LT40 Super Rev. J7.12, LT40HD Super Rev. K3.11 & LT50HD Rev. A5.11 to prevent the brake from de-energizing while moving the saw head slowly. Use retrofit kit 069678-FR to retrofit previous revisions.

³ Battery 025841 replaced 12 Volt Battery (015475) supplied prior to LT40 Super Rev. J7.09, LT40HD Super Rev. K3.08 and LT50 Rev. A5.08.

⁴ Power Feed Module 051887 discontinued 12/10. If sawmill not equipped with Accuset or Accuset 2 option, use kit 069460 to retrofit power feed with dual-axis motor control module. Use kit 052972 if sawmill equipped with original Accuset to retrofit to Accuset 2. Once sawmill upgraded to Accuset 2, use kit 069459 to retrofit for dual-axis control of power feed motor. If Accuset 2 is older than Rev. B.00 with original part 052974 single-axis control module (No MOT2A or MOT2B terminal studs), a new dual-axis module 057821LS-FR is required in addition to kit 069459.

Battery Specifications							
Group No.	Type No.	Performance Level		Approx. Weight (Wet)	Maximum Overall Dimensions		
		Cranking Performance	Reserve Capacity		Length	Width	Height
31	8A31DTM ¹	1000	185	59 lb. (26 Kg)	13" (330 mm)	6 3/4" (171 mm)	9 1/2" (241 mm)

¹ Battery 8A31DTM replaced battery 1131XPMF supplied prior to LT40 Super Rev. J7.09, LT40HD Super Rev. K3.08 and LT50 Rev. A5.08.

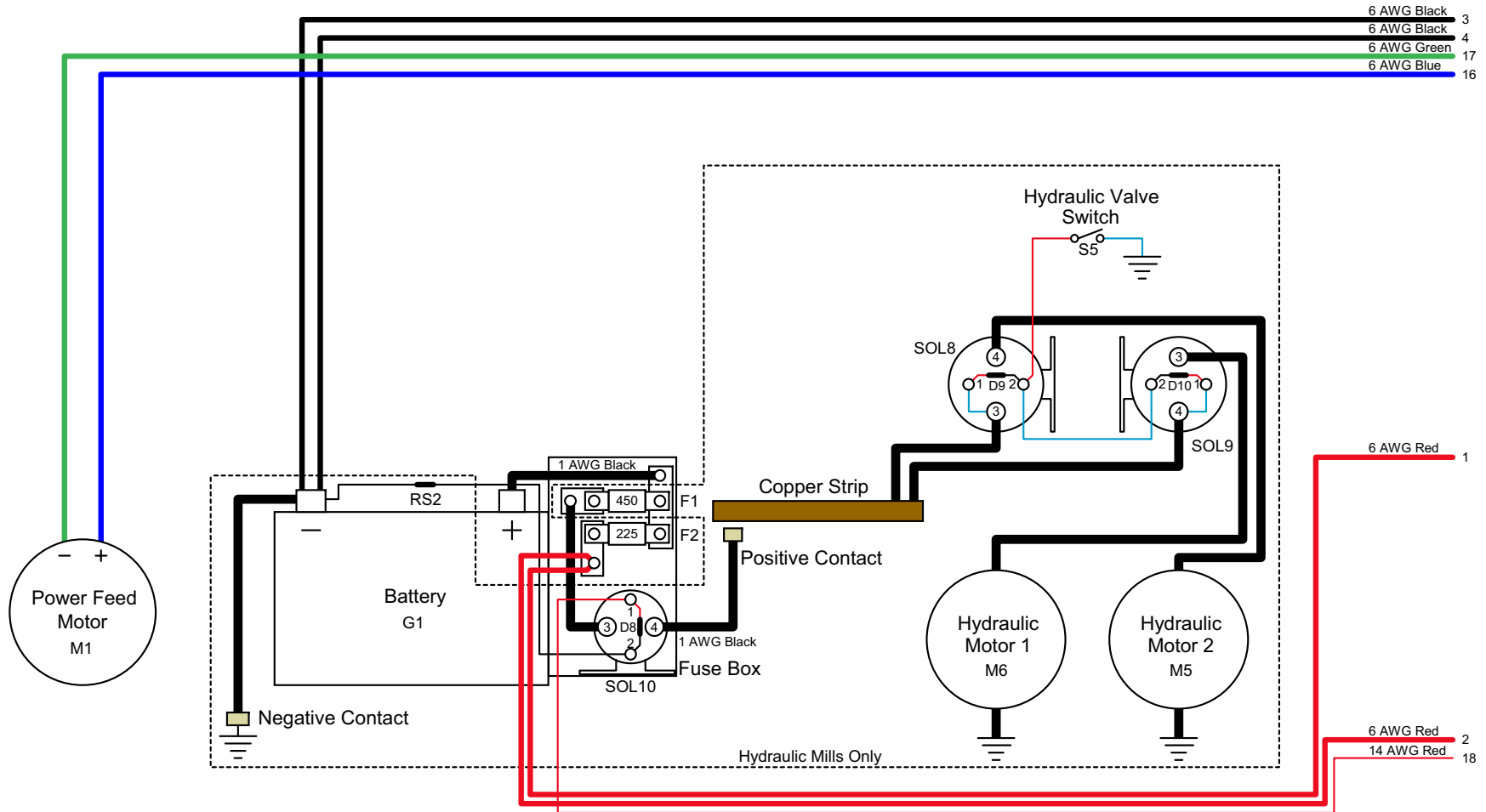

3H1025-1

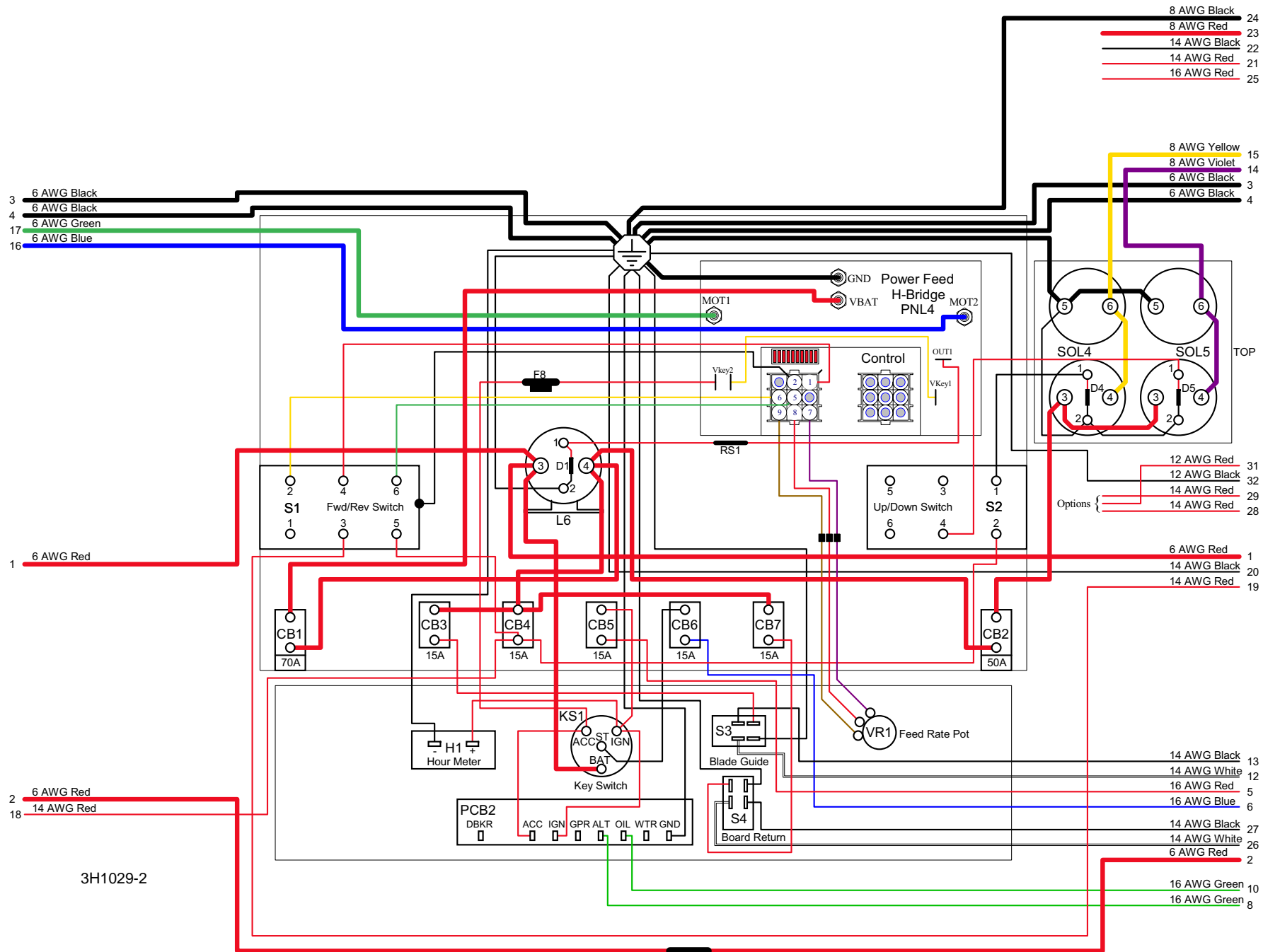

3H1029-2

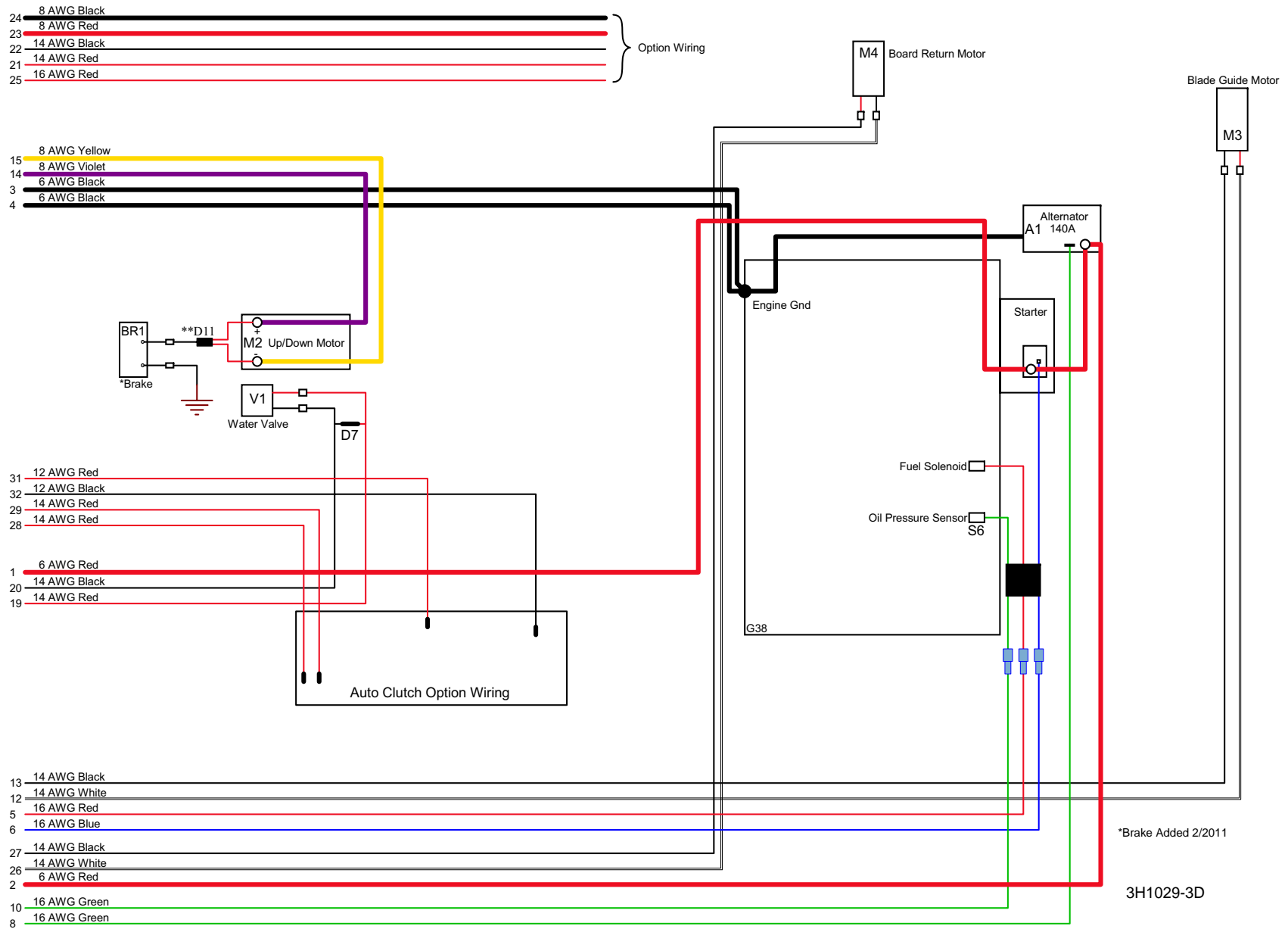

*Brake Added 2/2011
 **Diode Wire Assembly Added 09/2012

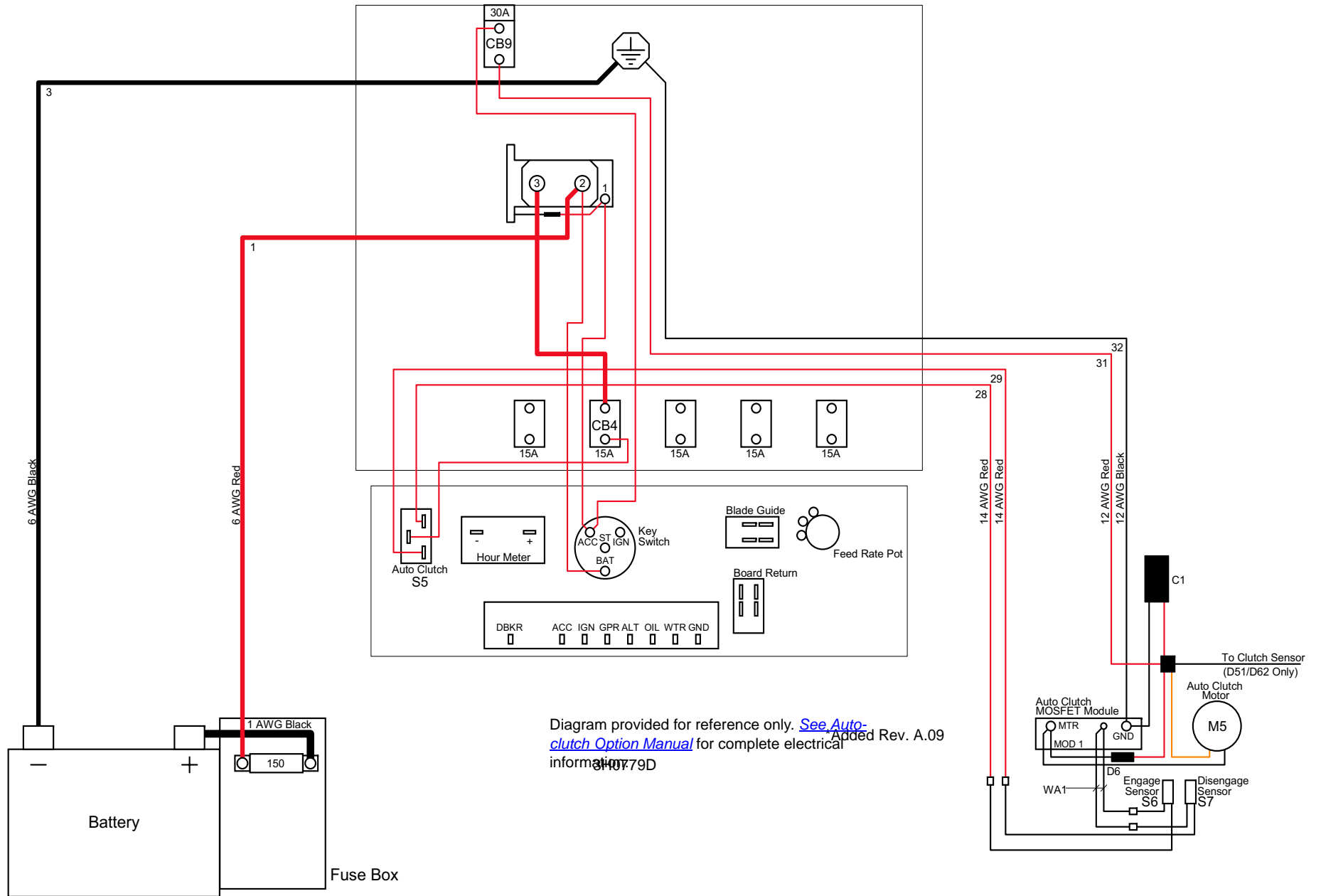

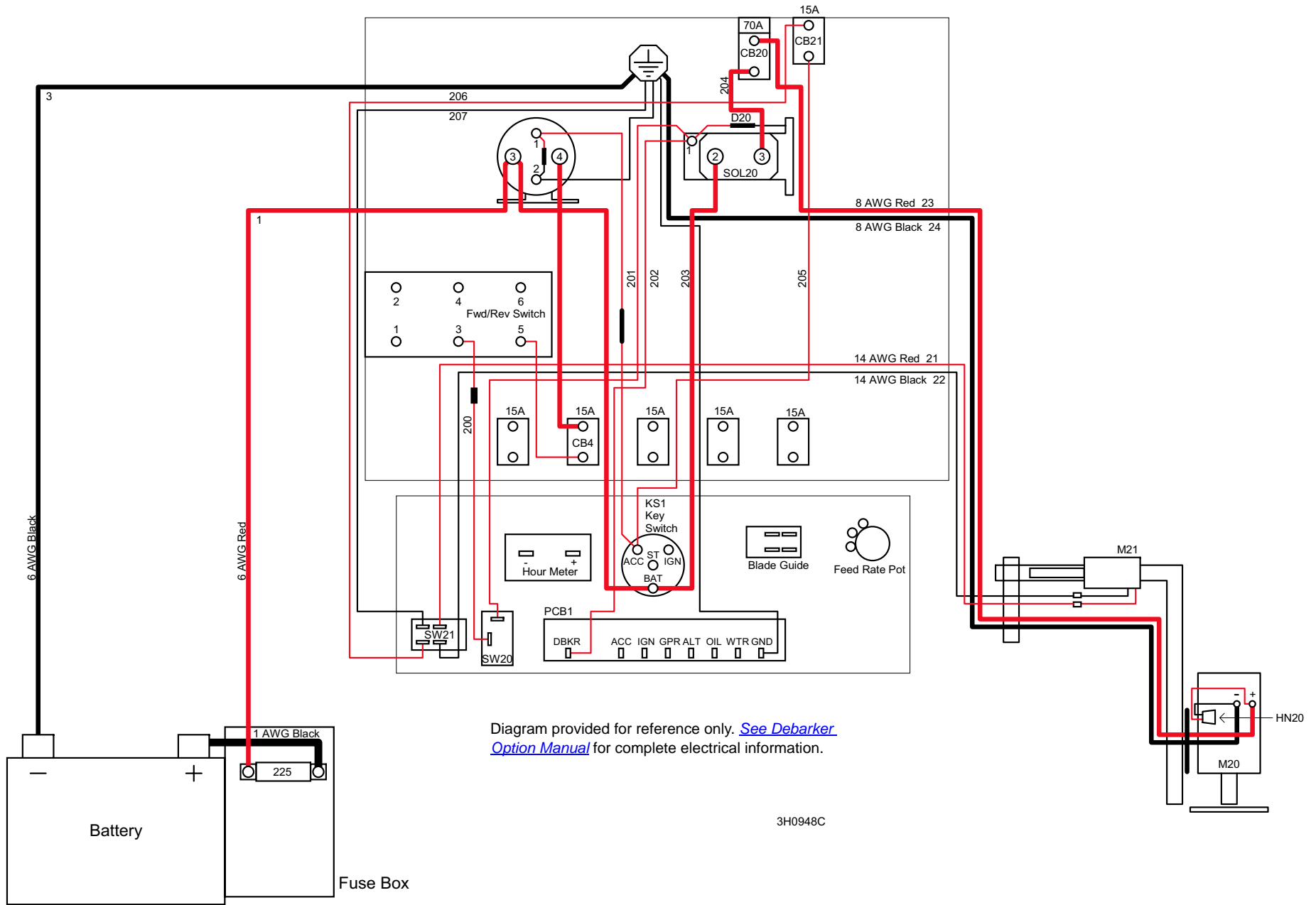
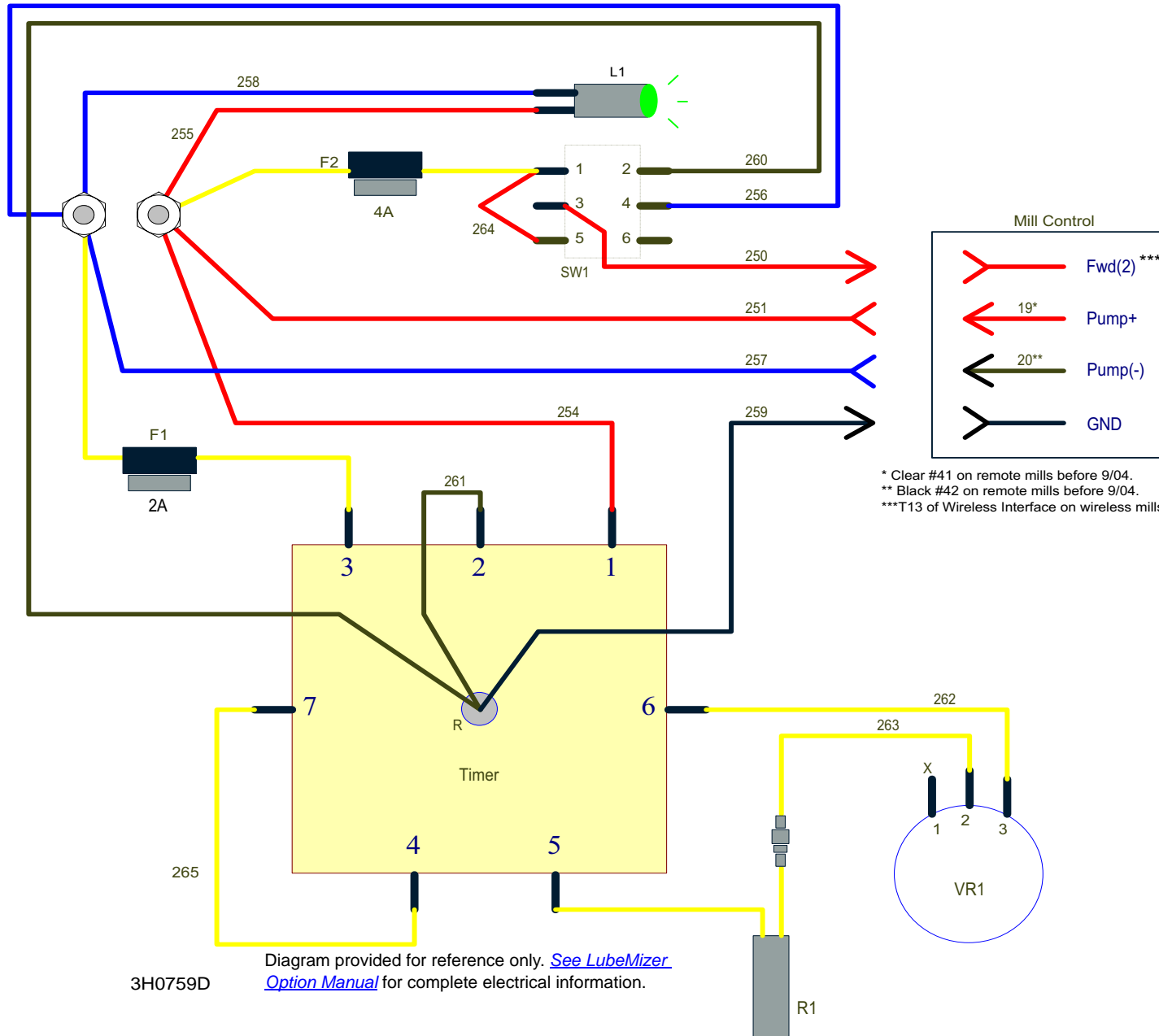

Diagram provided for reference only. [See Debarker Option Manual](#) for complete electrical information.

3H0948C



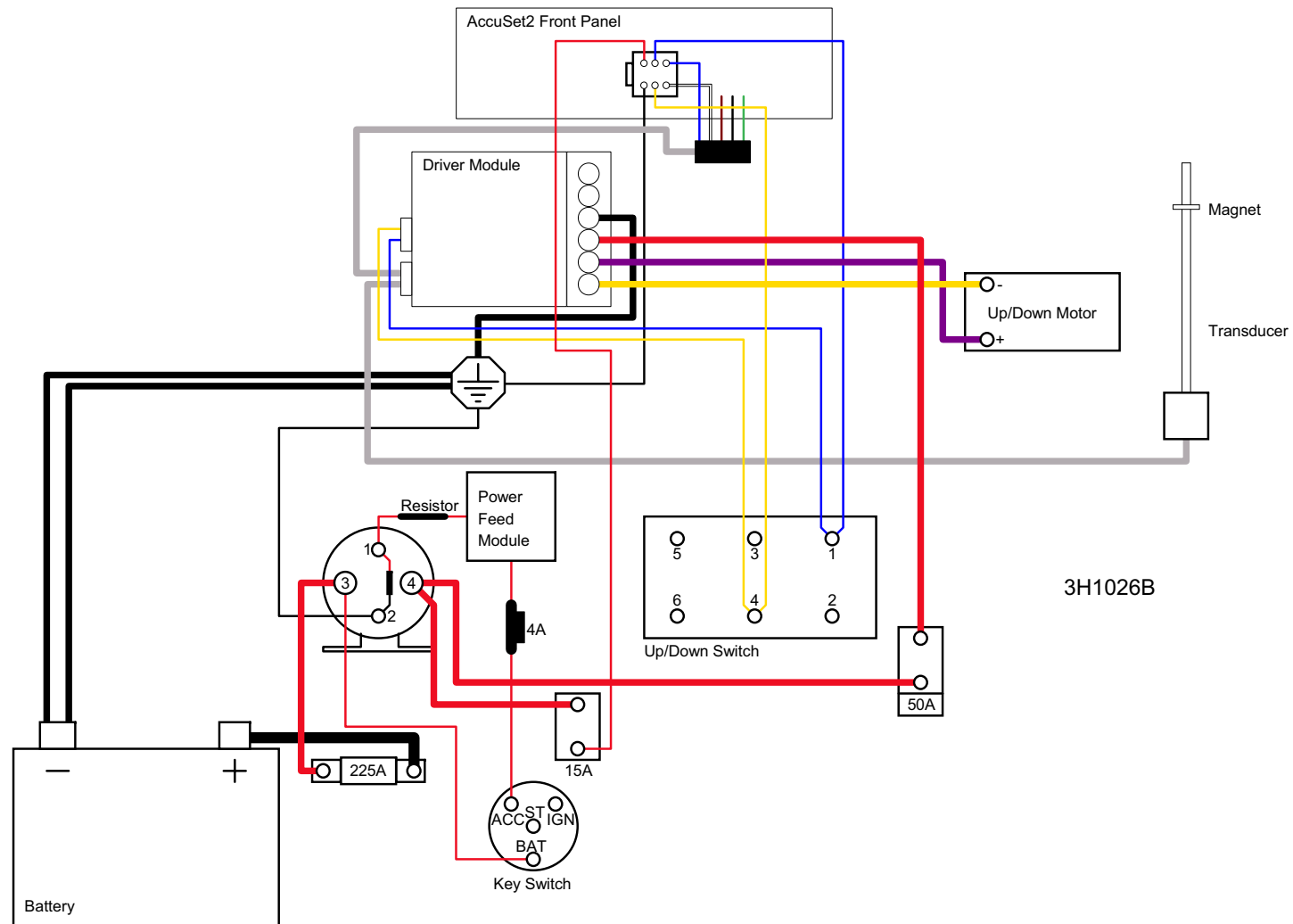

Diagram provided for reference only. [See Accuset 2 Option Manual](#) for complete electrical information.



G38S ELECTRICAL INFORMATION

LT40HD Super
LT50HD

Rev. K3.03
Rev. A5.03

Component List		
Item	Wood-Mizer Part No.	Description
A1	023695	Alternator, 140 Amp
BR1	069519 ¹	Brake, Up/Down
CB1	015527	Breaker, 70 Amp Man.Reset Panel Mount, Pwr Feed
CB2	015527	Breaker, 70 Amp Manual Reset Panel Mount, Up/Down
CB3	E20430	Breaker, 15 Amp Manual Reset, Blade Guide
CB4	E20430	Breaker, 15 Amp Manual Reset, Accessory
CB5	E20430	Breaker, 15 Amp Manual Reset, Ignition
CB6	E20430	Breaker, 15 Amp Manual Reset, Start
CB7	E20430	Breaker, 15 Amp Manual Reset, Board Return
D1, D4 - D5, D8 - D10	015426	Diode Assembly, Solenoid Coil Chassis
D7	024123	Diode Assembly, Inductive Kick Protection
D11	069678 ²	Diode OR Assembly, Up/Down Brake
F1	053340	Fuse, 450A 32V Mega
F2	053339	Fuse, 225A 32V Mega
F8	024150-4	Fuse, 4 Amp ATO Blade Pink
G1	025841 ³	Battery, 12 Volt (See Battery Specifications)
H1	015401	Hour Meter, 12 Volt DC
KS1	P04350	Key Switch, 4-position (Accessory, Off, Ignition, Start)
L6	016371	Solenoid Kit, 200A 12V SPST
M1	024169	Motor, 3/4HP 12VDC TEFC Power Feed w/o Base
M2	053682	Motor, 1HP 12VDC Up/Down
M3	A10365	Motor, 12 Volt Blade Guide Arm 53:1 Gear
M4	A10365	Motor, 12 Volt Board Return 53:1 Gear
M5, M6	052807	Motor, 12 Volt Hydraulic Pump
PCB2	015409	Board, LED Circuit
PNL4	051887 ⁴	Module Assembly, Power Feed
RS1	024260	Wire Assembly, Accessory Solenoid Voltage Drop
RS2	024451	Wire Assembly, Hydraulic Solenoid Voltage Drop
S1	E20439	Drum Switch, Power Feed Fwd/Reverse Motor
S2	E20440	Drum Switch, Up/Down Motor
S3	024200	Toggle Switch, Blade Guide In/Out Motor
S4	024200	Toggle Switch, Board Return Motor
S5	024198	Switch, Hydraulic Pump Levers
S6		Switch, Oil Pressure Sensor
SOL4-SOL5	016370	Solenoid Kit, 200A 12V DPST
SOL8 - SOL9, SOL10	016371	Solenoid Kit, 200A 12V SPST Hydraulic Pump Motor
V1	016280	Valve, Waterlube Solenoid
VR1	024450-1	Potentiometer, Variable Resistance Power Feed

¹ Brake added LT40 Super Rev. J7.06, LT40HD Super Rev. K3.05 & LT50HD Rev. A5.05 to prevent saw head from drifting during sawing. Use retrofit kit 062570 to retrofit previous revisions.

² Up/Down Brake Diode OR Assembly 069678 added LT40 Super Rev. J7.12, LT40HD Super Rev. K3.11 & LT50HD Rev. A5.11 to prevent the brake from de-energizing while moving the saw head slowly. Use retrofit kit 069678-FR to retrofit previous revisions.

³ Battery 025841 replaced 12 Volt Battery (015475) supplied prior to LT40 Super Rev. J7.09, LT40HD Super Rev. K3.08 and LT50 Rev. A5.08.

⁴ Power Feed Module 051887 discontinued 12/10. If sawmill not equipped with Accuset or Accuset 2 option, use kit 069460 to retrofit power feed with dual-axis motor control module. Use kit 052972 if sawmill equipped with original Accuset to retrofit to Accuset 2. Once sawmill upgraded to Accuset 2, use kit 069459 to retrofit for dual-axis control of power feed motor. If Accuset 2 is older than Rev. B.00 with original part 052974 single-axis control module (No MOT2A or MOT2B terminal studs), a new dual-axis module 057821LS-FR is required in addition to kit 069459.

Battery Specifications							
Group No.	Type No.	Performance Level		Approx. Weight (Wet)	Maximum Overall Dimensions		
		Cranking Performance	Reserve Capacity		Length	Width	Height
31	8A31DTM ¹	1000	185	59 lb. (26 Kg)	13" (330 mm)	6 3/4" (171 mm)	9 1/2" (241 mm)

¹ Battery 8A31DTM replaced battery 1131XPMF supplied prior to LT40 Super Rev. J7.09, LT40HD Super Rev. K3.08 and LT50 Rev. A5.08.

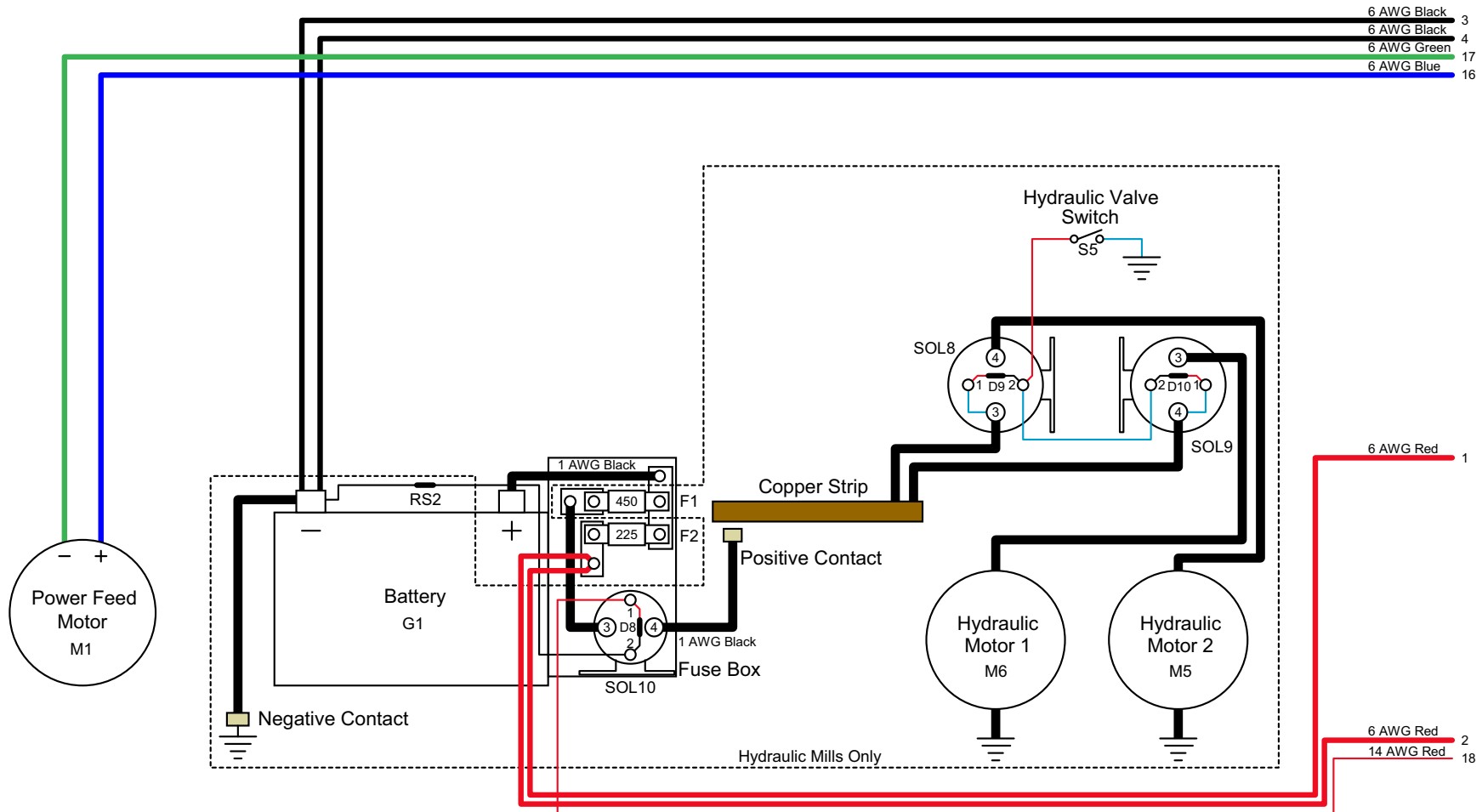

3H1025-1

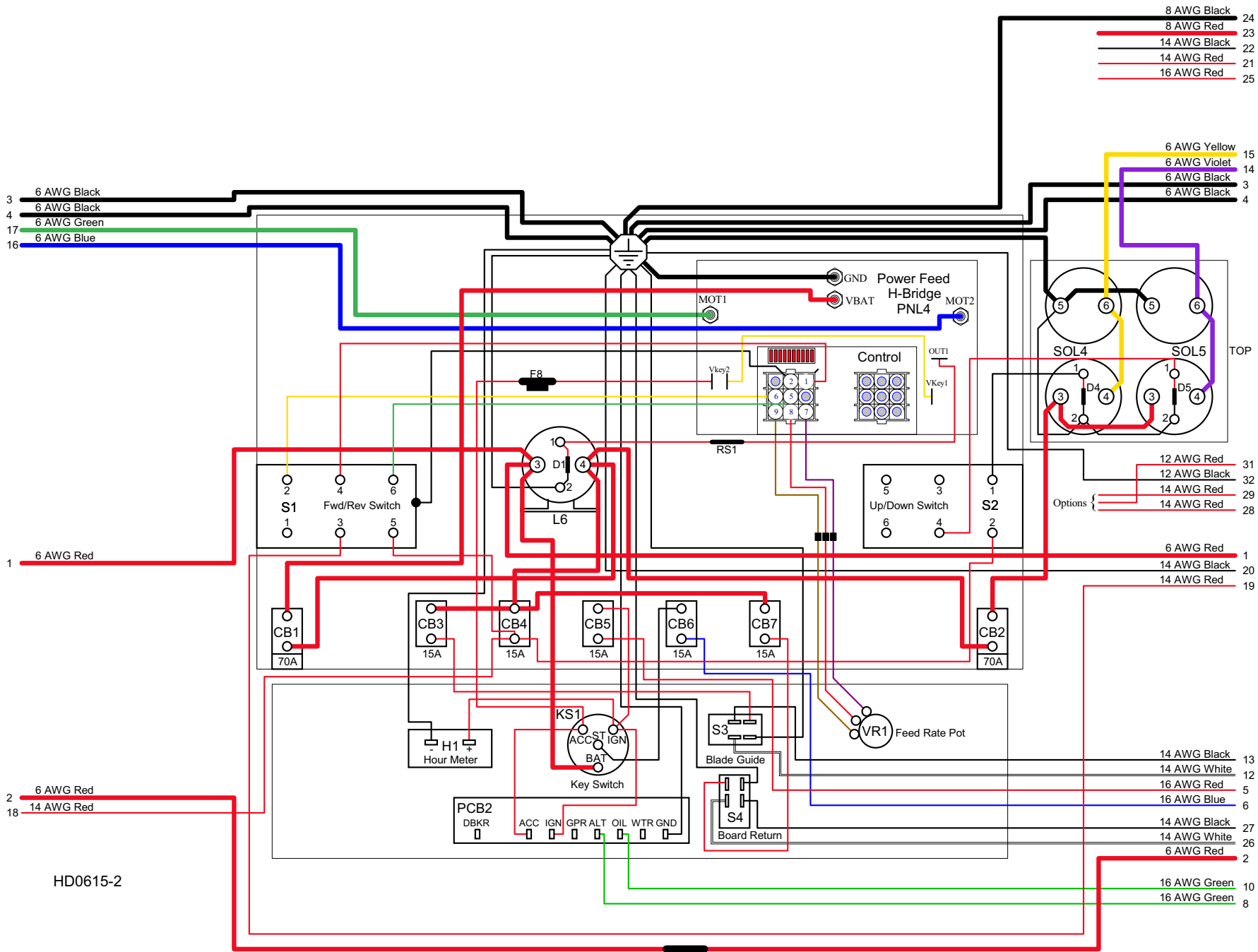

HD0615-2

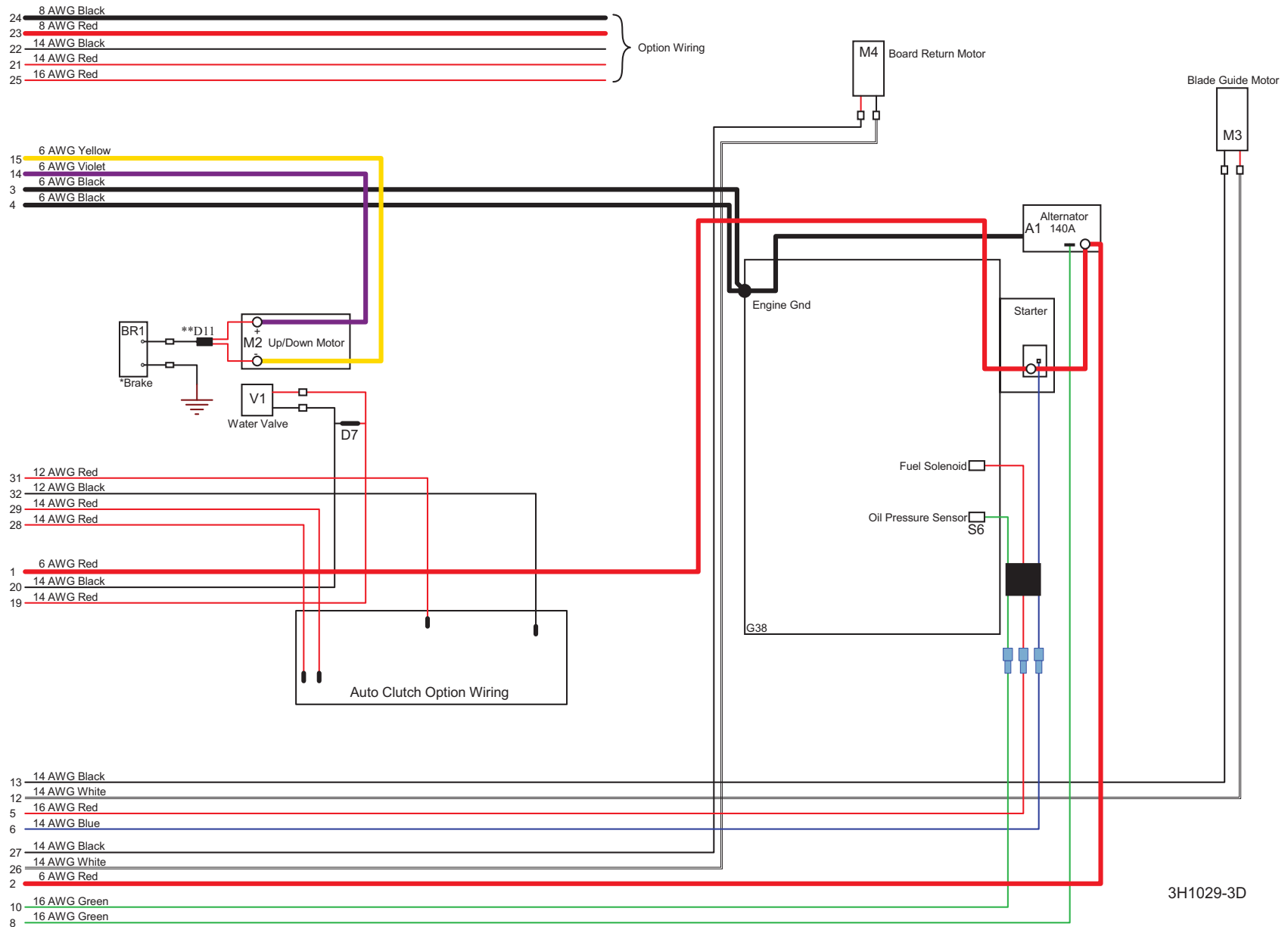

*Brake Added 2/2011
 **Diode Wire Assembly Added 09/2012

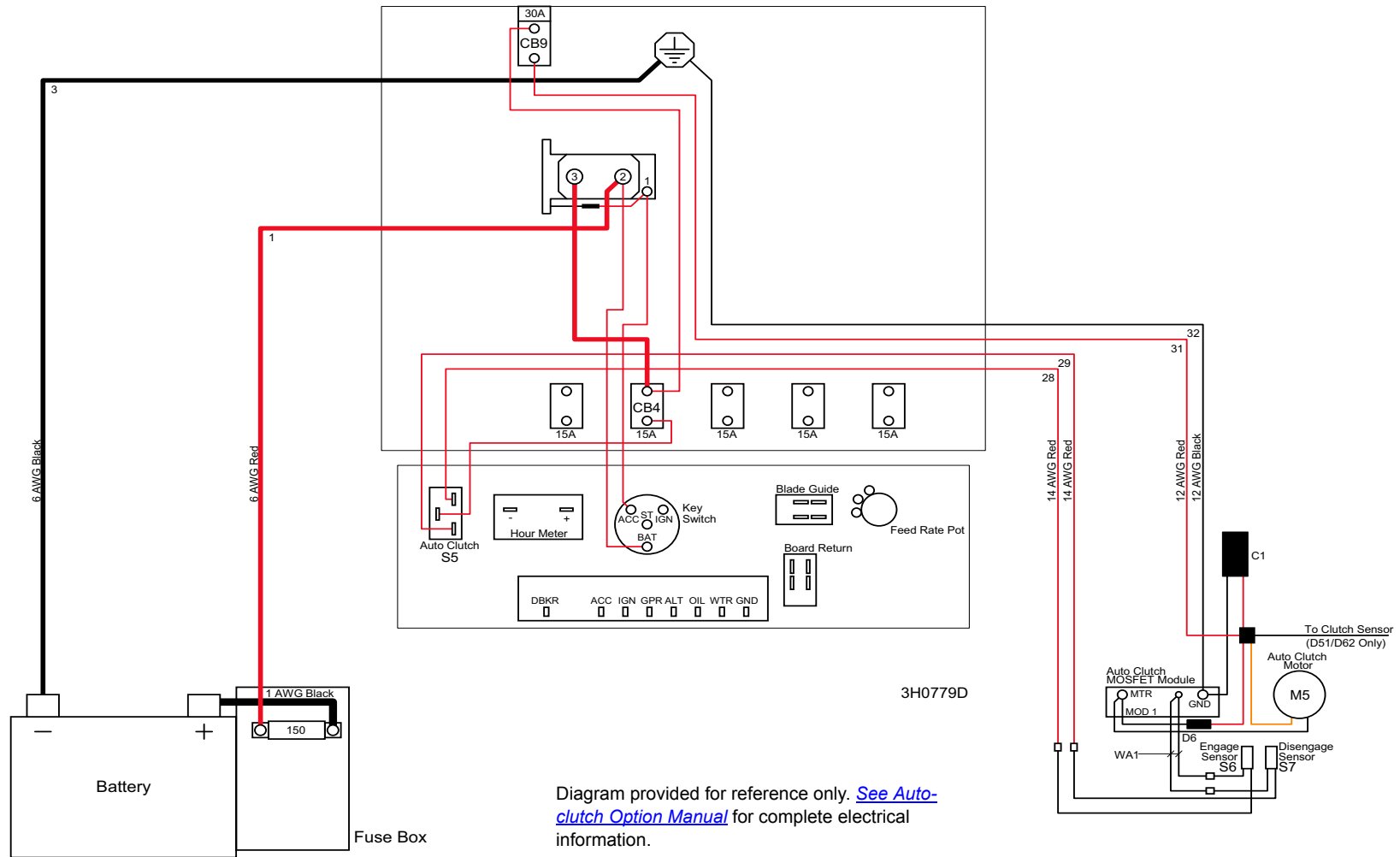

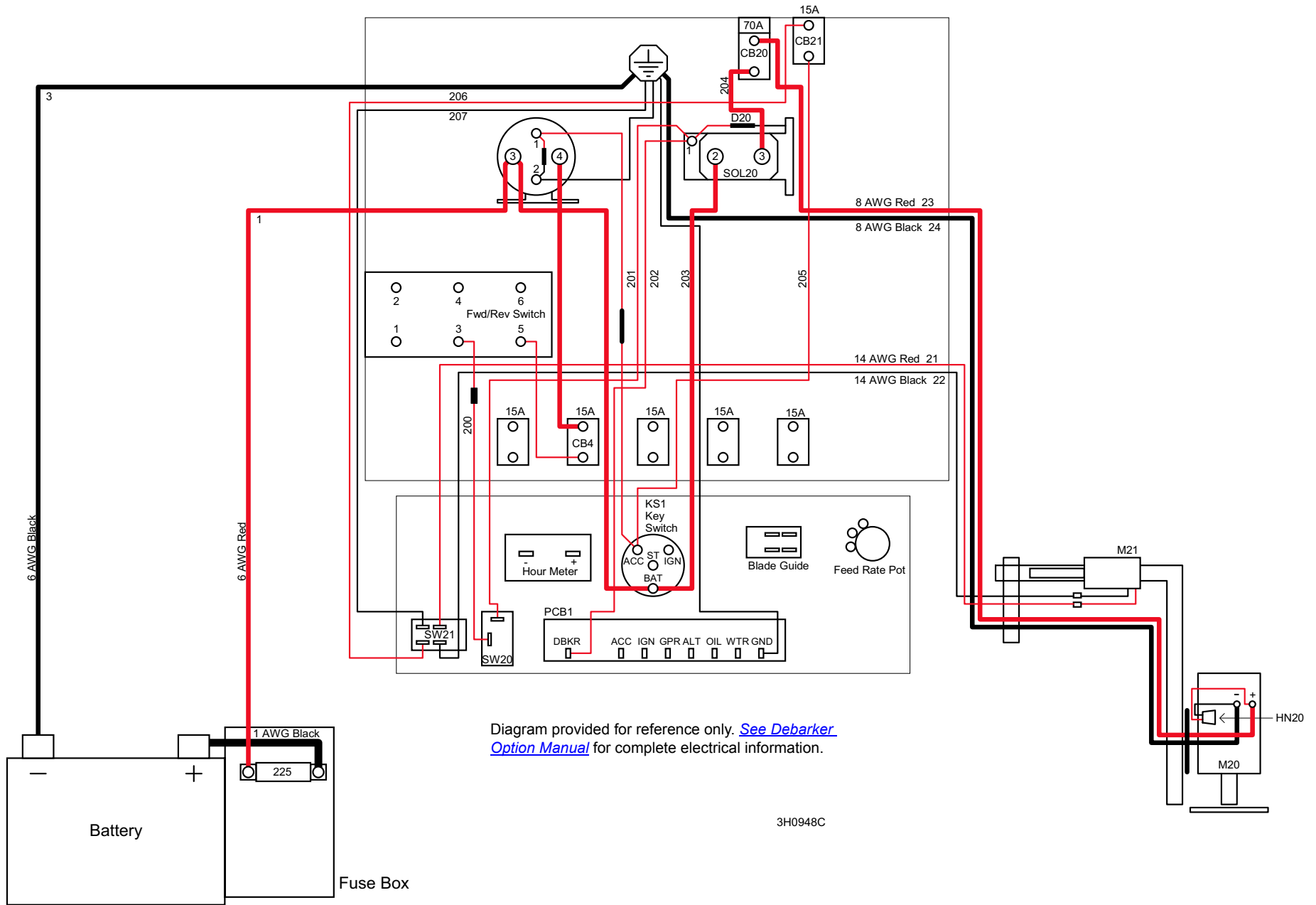
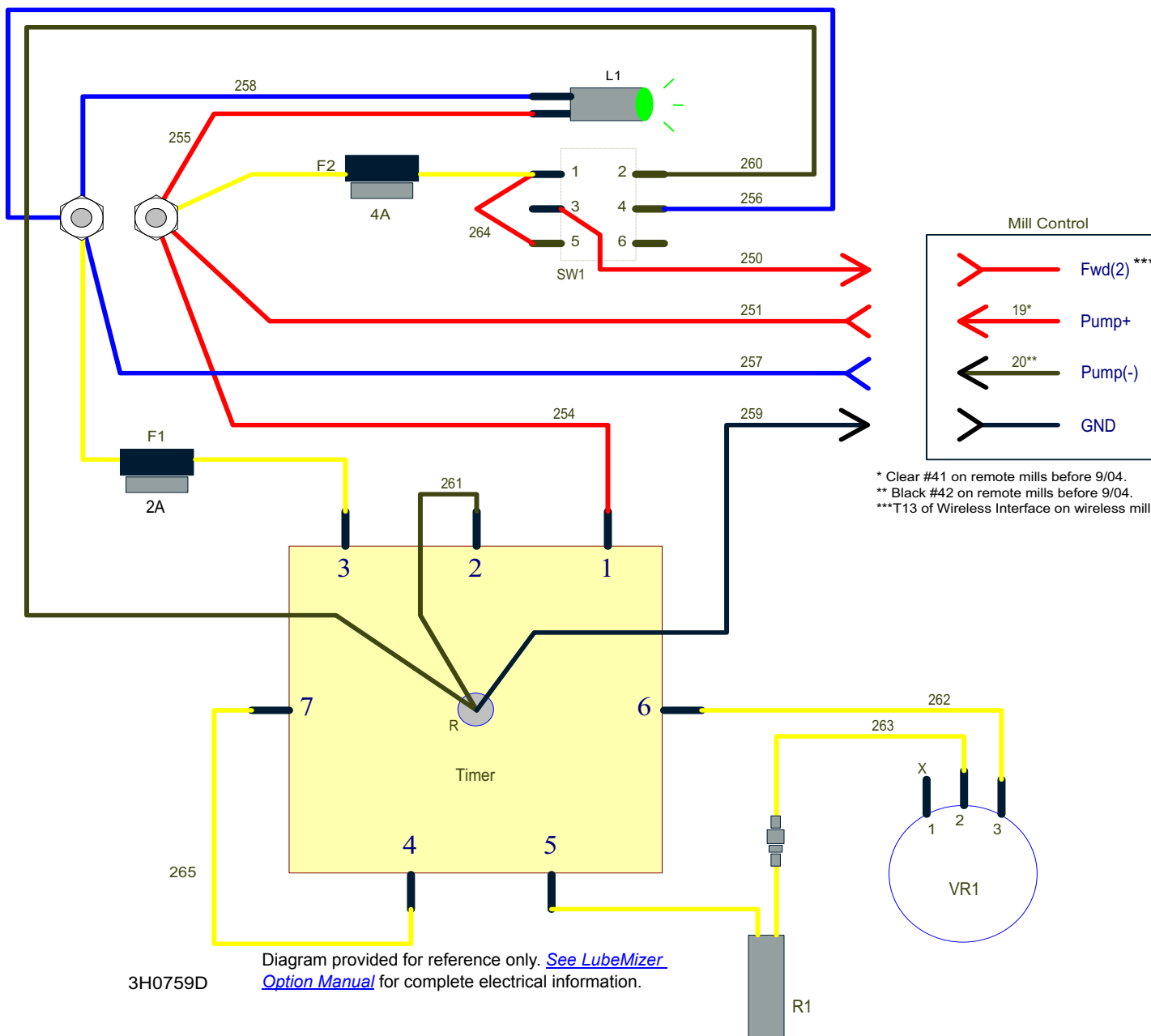

Diagram provided for reference only. [See Debarker Option Manual](#) for complete electrical information.

3H0948C



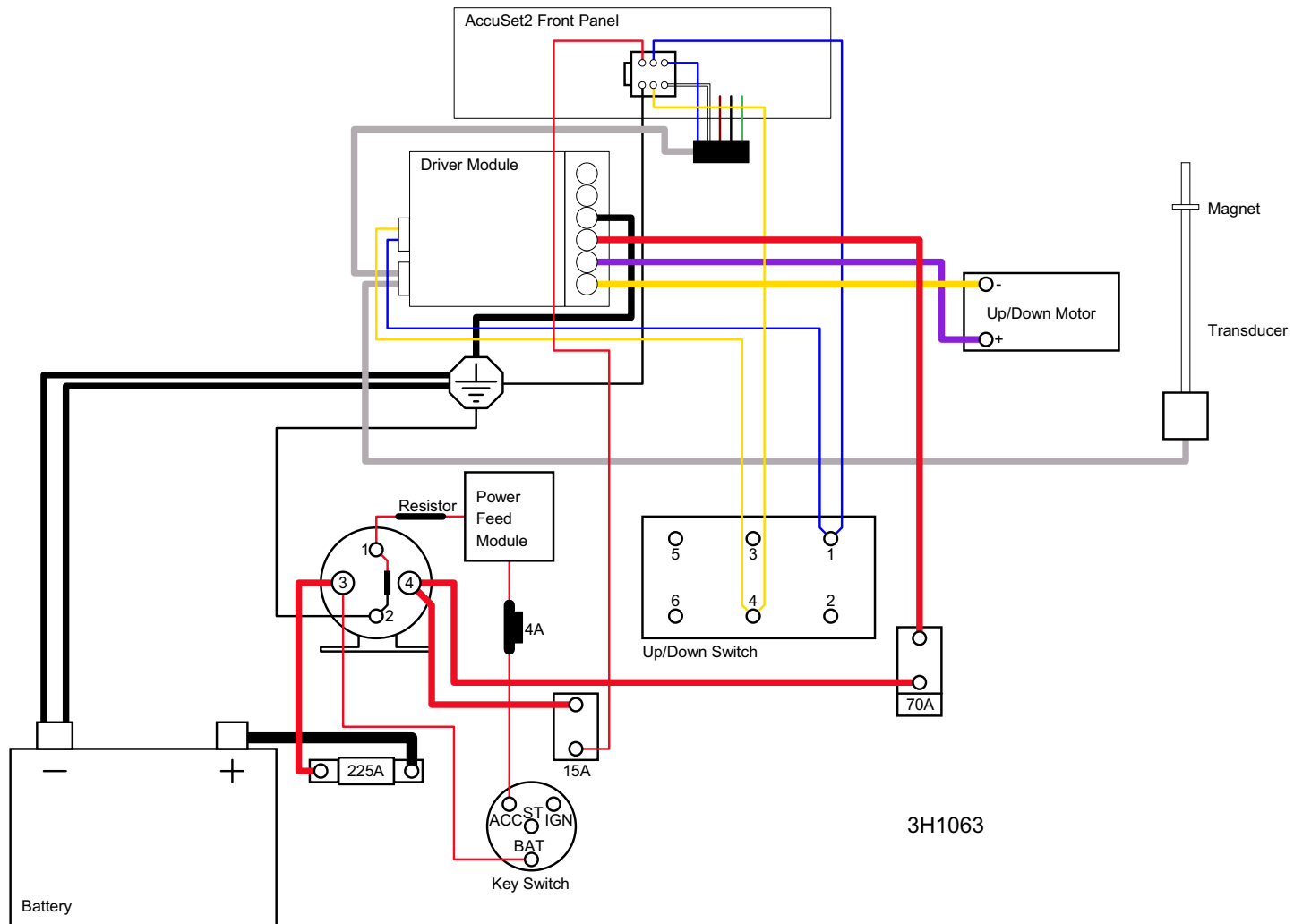

Diagram provided for reference only. [See Accuset 2 Option Manual](#) for complete electrical information.

G35S ELECTRICAL INFORMATION

**LT40HD Super
LT50HD**

**Rev. K3.04+ Rev.
A5.04 - A5.23 (OBS)**

Component List		
Item	Wood-Mizer Part No.	Description
A1	023695	Alternator, 140 Amp
BR1	069519 ¹	Brake, Up/Down
CB1	015527	Breaker, 70 Amp Man.Reset Panel Mount, Up/Dn & Pwr Feed
CB3	E20430	Breaker, 15 Amp Manual Reset, Blade Guide
CB4	E20430	Breaker, 15 Amp Manual Reset, Accessory
CB5	E20430	Breaker, 15 Amp Manual Reset, Ignition
CB6	E20430	Breaker, 15 Amp Manual Reset, Start
CB7	E20430	Breaker, 15 Amp Manual Reset, Board Return
D1, D8 - D10	015426	Diode Assembly, Solenoid Coil Chassis
D7	024123	Diode Assembly, Inductive Kick Protection
D11	069678 ²	Diode OR Assembly, Up/Down Brake
F1	053340	Fuse, 450A 32V Mega
F2	053339	Fuse, 225A 32V Mega
G1	025841 ³	Battery, 12 Volt (See Battery Specifications)
H1	015401	Hour Meter, 12 Volt DC
HARN3	053355	Harness Assembly, Dual-Axis Motor Control
KS1	P04350	Key Switch, 4-position (Accessory, Off, Ignition, Start)
L6	016371	Solenoid Kit, 200A 12V SPST
M1	024169	Motor, 3/4HP 12VDC TEFC Power Feed w/o Base
M2	053682	Motor, 1HP 12VDC Up/Down
M3	A10365	Motor, 12 Volt Blade Guide Arm 53:1 Gear
M4	A10365	Motor, 12 Volt Board Return 53:1 Gear
M5, M6	052807	Motor, 12 Volt Hydraulic Pump
PCB2	015409	Board, LED Circuit
PNL2	057821LS-FR	Drive Assembly, Super NR Dual-Axis
RS2	024451	Wire Assembly, Hydraulic Solenoid Voltage Drop
S1	E20439	Drum Switch, Power Feed Fwd/Reverse Motor
S2	E20440	Drum Switch, Up/Down Motor
S3	024200	Toggle Switch, Blade Guide In/Out Motor
S4	024200	Toggle Switch, Board Return Motor
S5	024198	Switch, Hydraulic Pump Levers
S6		Switch, Oil Pressure Sensor
SOL8 - SOL9, SOL10	016371	Solenoid Kit, 200A 12V SPST Hydraulic Pump Motor
V1	016280	Valve, Waterlube Solenoid
VR1	024450-1	Potentiometer, Variable Resistance Power Feed

¹ Brake added LT40 Super Rev. J7.06, LT40HD Super Rev. K3.05 & LT50HD Rev. A5.05 to prevent saw head from drifting during sawing. Use retrofit kit 062570 to retrofit previous revisions.

² Up/Down Brake Diode OR Assembly 069678 added LT40 Super Rev. J7.12, LT40HD Super Rev. K3.11 & LT50HD Rev. A5.11 to prevent the brake from de-energizing while moving the saw head slowly. Use retrofit kit 069678-FR to retrofit previous revisions.

³ Battery 025841 replaced 12 Volt Battery (015475) supplied prior to LT40 Super Rev. J7.09, LT40HD Super Rev. K3.08 and LT50 Rev. A5.08.

Battery Specifications							
Group No.	Type No.	Performance Level		Approx. Weight (Wet)	Maximum Overall Dimensions		
		Cranking Performance	Reserve Capacity		Length	Width	Height
31	8A31DTM ¹	1000	185	59 lb. (26 Kg)	13" (330 mm)	6 3/4" (171 mm)	9 1/2" (241 mm)

¹ Battery 8A31DTM replaced battery 1131XPMF supplied prior to LT40 Super Rev. J7.09, LT40HD Super Rev. K3.08 and LT50 Rev. A5.08.

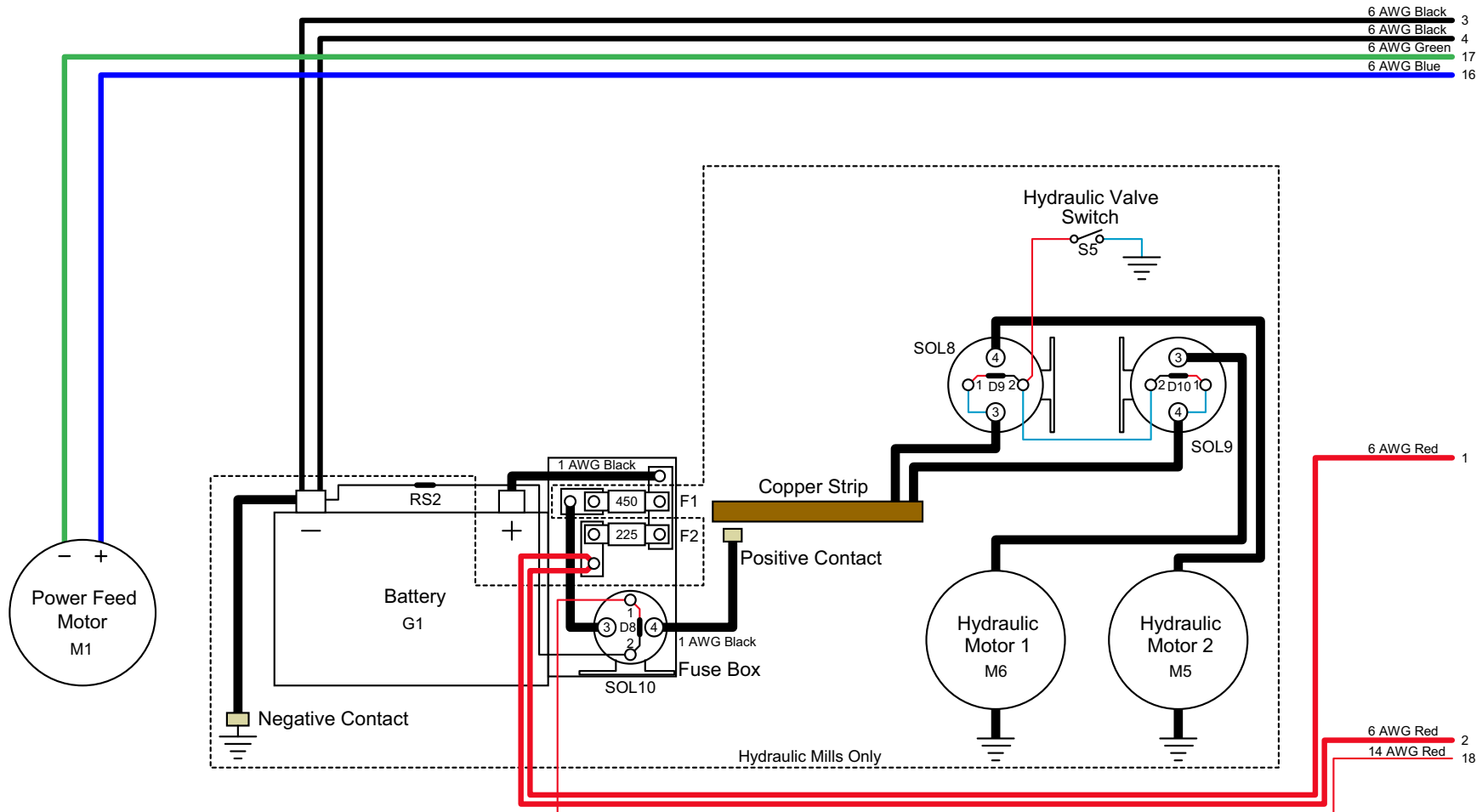

3H1025-1

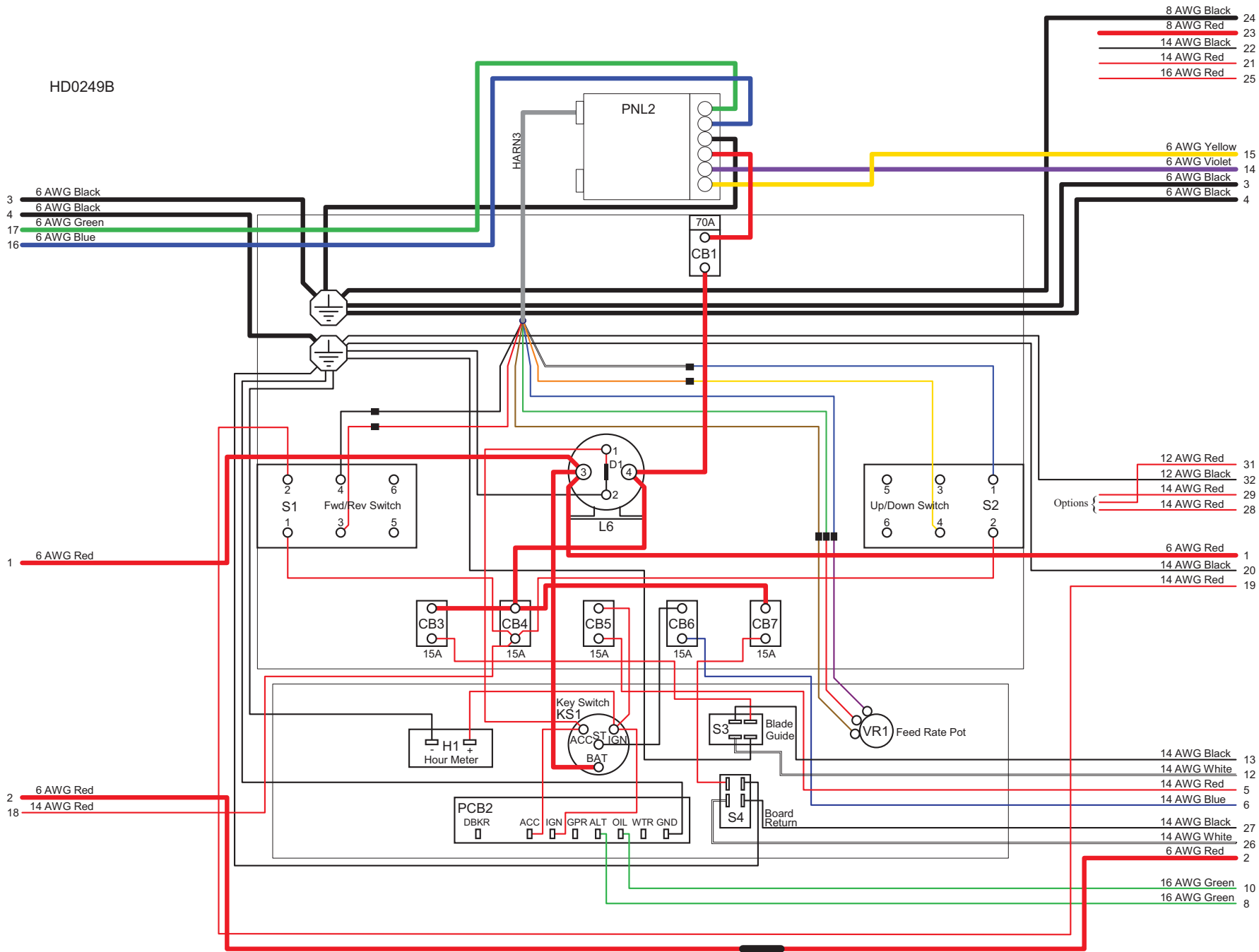

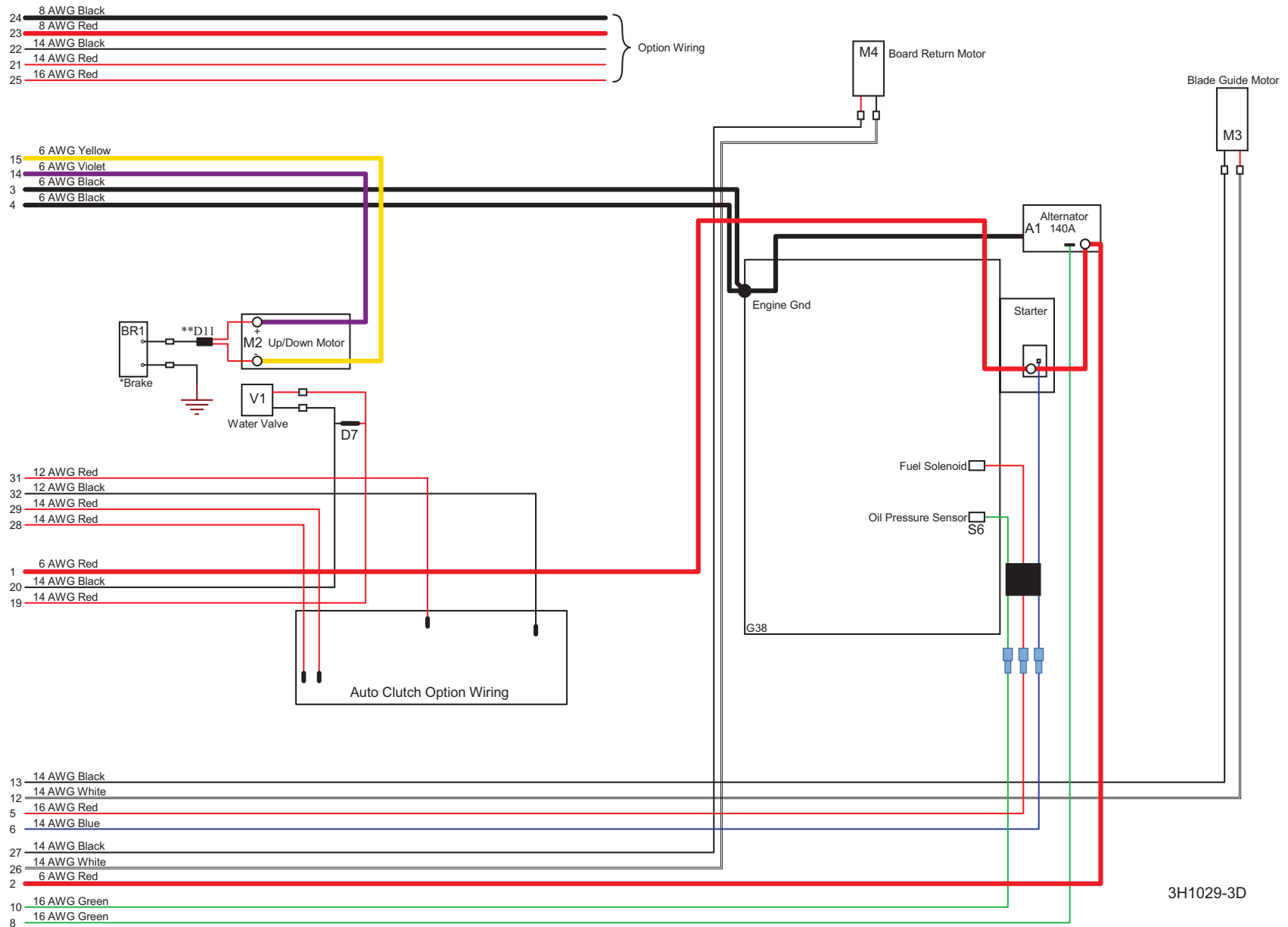

*Brake Added 2/2011
 **Diode Wire Assembly Added 09/2012

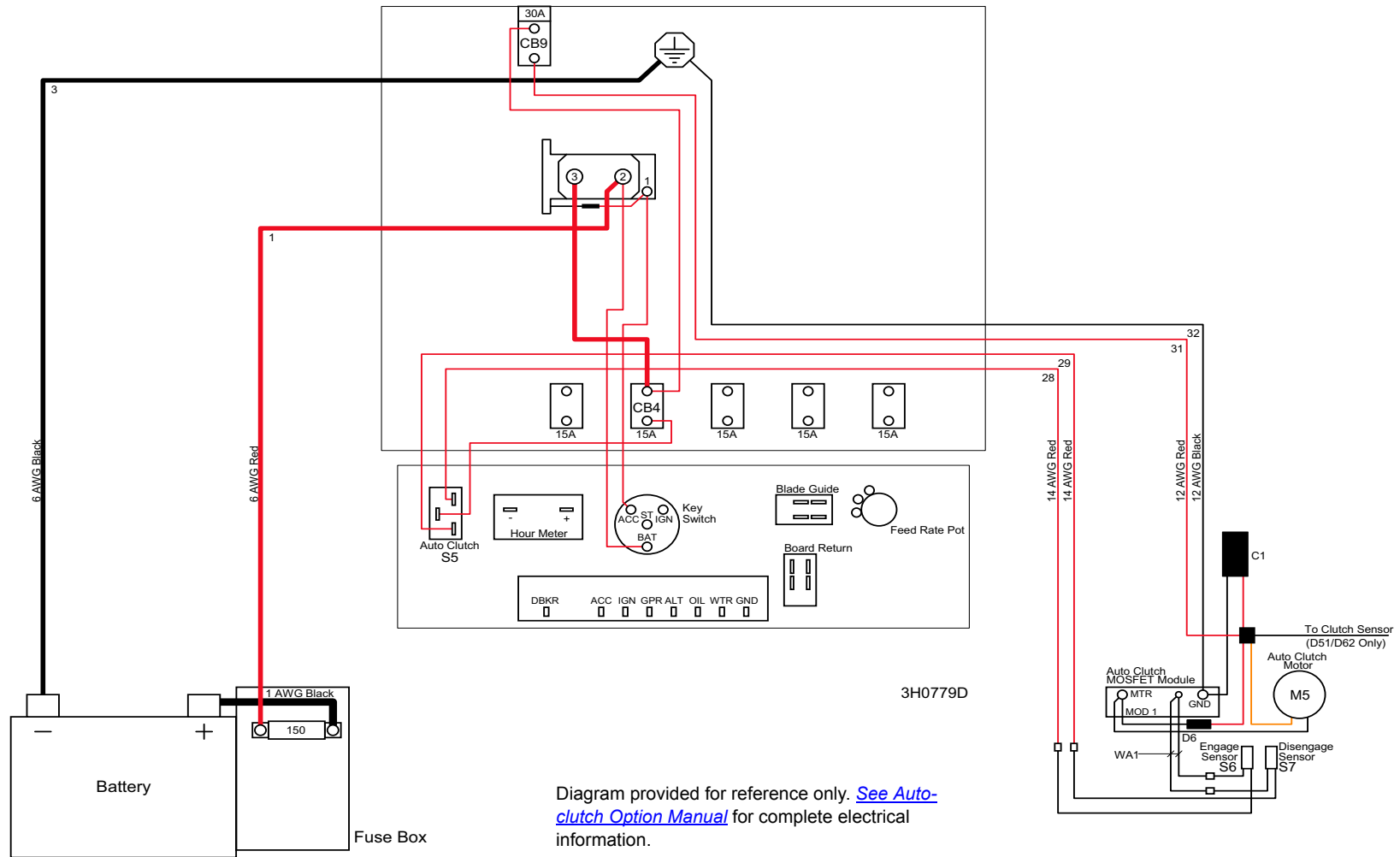

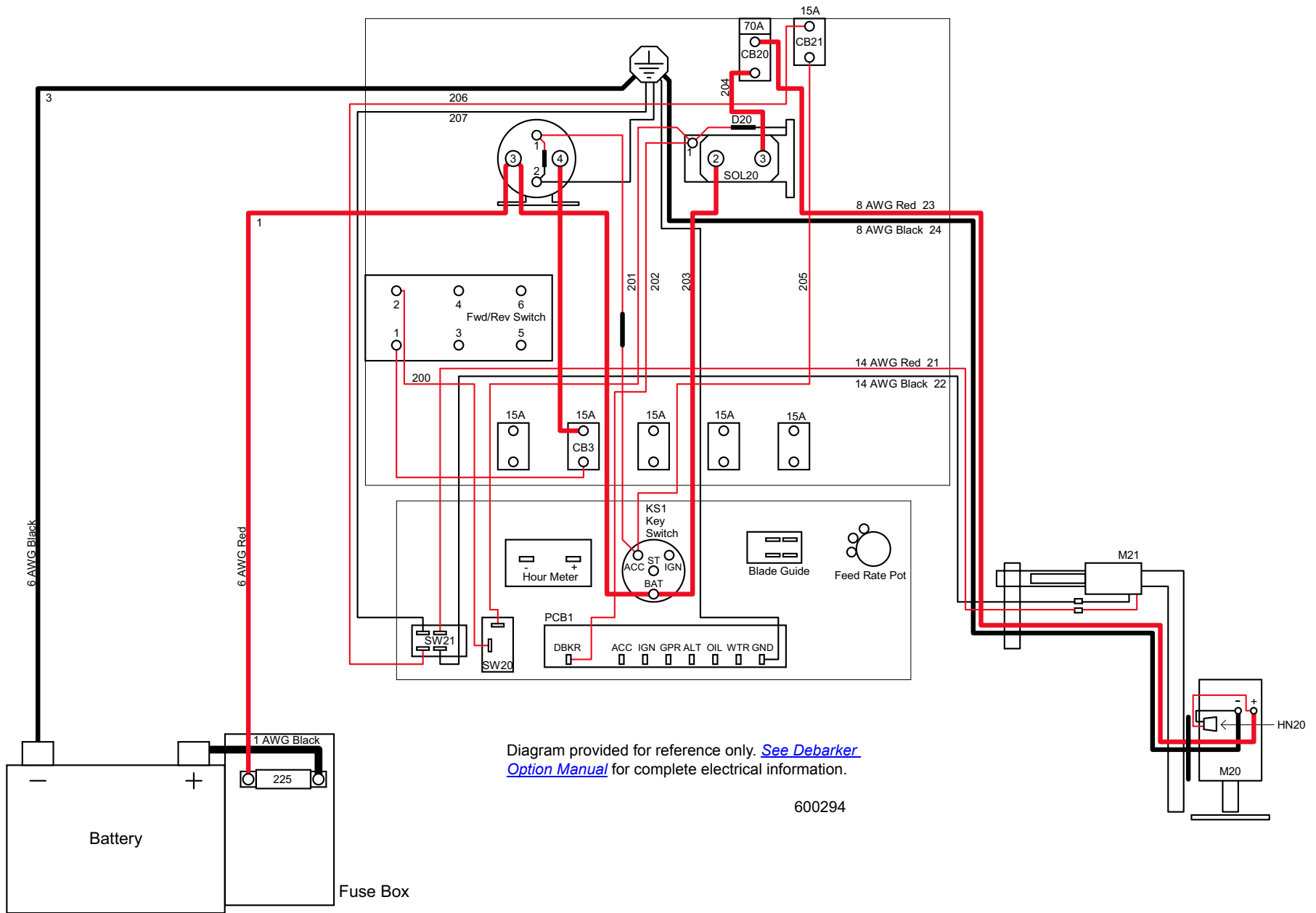
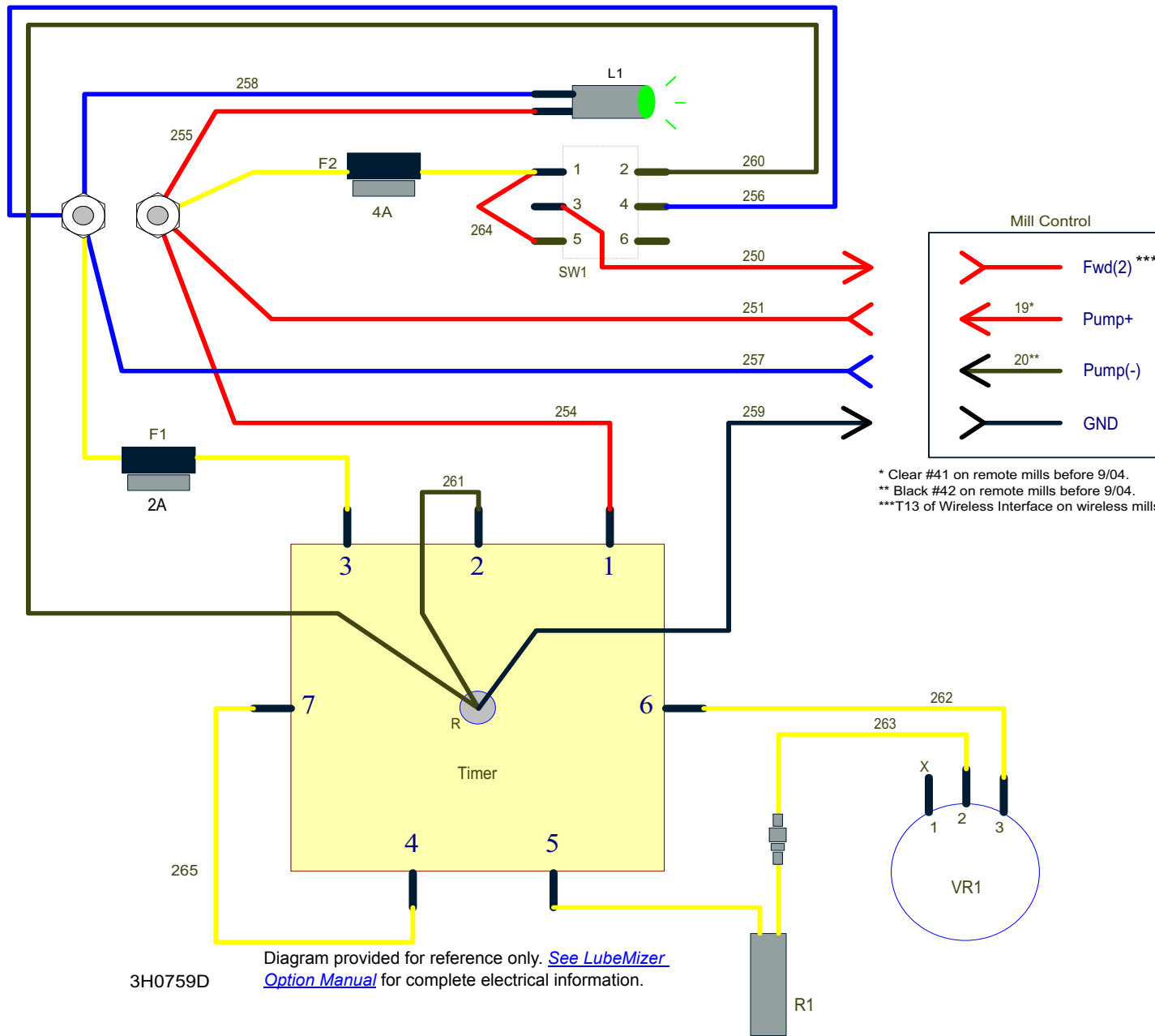

Diagram provided for reference only. [See Debarker Option Manual](#) for complete electrical information.

600294



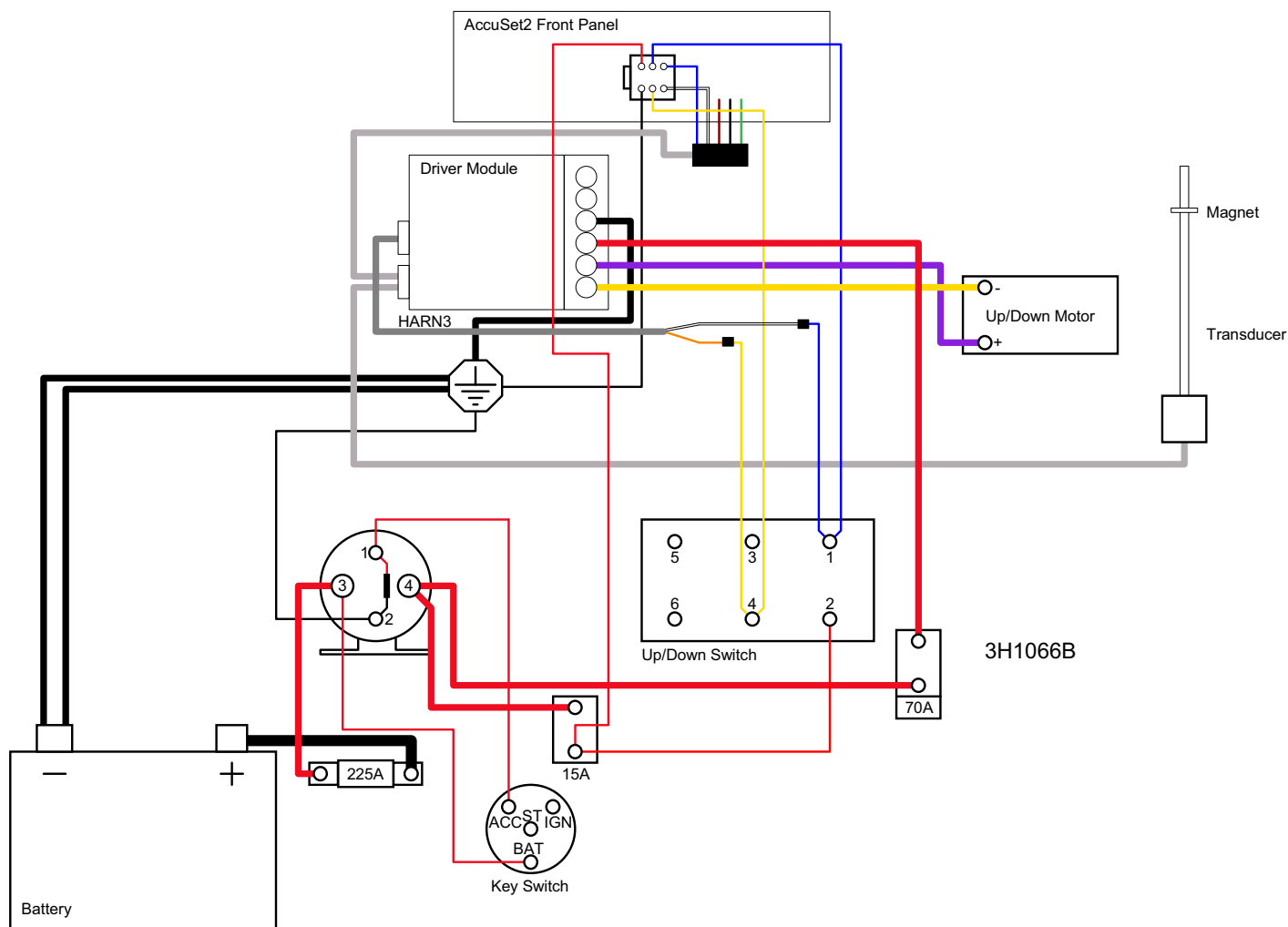

Diagram provided for reference only. [See Accuset 2 Option Manual](#) for complete electrical information.