

APPENDIX A D34 ELECTRICAL INFORMATION

LT30

Rev. J7.02 - K1.00

LT40

Rev. J8.02 - K2.00

LT30HD

Rev. J8.02 - K2.00

LT40HD

Rev. J9.02 - K4.00

Component List		
Item	Wood-Mizer Part No.	Description
A1	023695	Alternator, 140 Amp
B1	P12315	Battery, 12 Volt (See Battery Specifications)
C101	051571	Capacitor Assembly, Power Feed Filter
CB1	051981	Breaker, 40 Amp Manual Reset Panel Mount, Fwd/Rev
CB2	051981	Breaker, 40 Amp Manual Reset Panel Mount, Up/Down
CB3	E20430 ¹	Breaker, 15 Amp Manual Reset, Accessory
CB4	E20430 ¹	Breaker, 15 Amp Manual Reset, Accessory
CB5	E20430 ¹	Breaker, 15 Amp Manual Reset, Accessory
CB6	E20430 ¹	Breaker, 15 Amp Manual Reset, Accessory
CB7	E20430 ¹	Breaker, 15 Amp Manual Reset, Accessory
CB8	E20430 ¹	Breaker, 15 Amp Manual Reset, Relay
CB9	024246	Breaker, 30A Manual Reset Panel Mount (Diesel Solenoid)
D101	052363	Diode Assembly, Power Feed Replacement
D2 - D3 ²	015426 ³	Diode Assembly, Solenoid Coil Chassis
F1 ²	P11550	Fuse Link, 225 Amp, 250 Volt For Hydraulic + 12 Volt Circuit
F2	023361	Fuse Link, 150 Amp, 250 Volt For Main + 12 Volt Starter, Alt
F4	024597	Fuse Link, 50 Amp Kubota Glow Plug
F7	024150-4	Fuse, 4 Amp ATO Blade Pink
GP1-GP3	046076	Glow Plug
H1	015401 ⁴	Hour Meter, 12 Volt DC
KS1	P04350	Key Switch, 4-position (Accessory, Off, Ignition, Start)
M1	006747 ⁵	Motor, 12 Volt Power Feed
M2	006747 ⁶	Motor, 12 Volt Up/Down
M3	A10365	Motor, 12 Volt Blade Guide Arm 53:1 Gear
M4 ²	052807 ⁷	Motor, 12 Volt Hydraulic Pump
MM1	024387	Mosfet Module, Power Feed SMT
L9	046072 ⁸	Solenoid, Fuel Shutoff
L10	045848	Solenoid, Throttle Actuator
L11	051335	Solenoid, Throttle Relay
L12	051335	Solenoid, Starter Relay
PCB1	024458	Circuit Board, Control Box Power Feed
PCB2	015409	Board, LED Circuit (Diesel)
PFM1	024396-1	Control Module, Power Feed SMT
R1	023359	Relay, Glow Plug
	052827	Socket Kit, Cat Glow Plug Relay
RS2 ²	024451	Wire Assembly, Hydraulic Solenoid Voltage Drop
RS4	051336	Resistor Assembly, Caterpillar Voltage Drop
RS5	052663 ⁹	Resistor Kit, Caterpillar Glow Plug
S1	E20439	Drum Switch, Power Feed Fwd/Reverse Motor
S2	E20440	Drum Switch, Up/Down Motor
S3	024200	Toggle Switch, Blade Guide In/Out Motor
S4 ²	024198	Switch, Hydraulic Pump Levers
S6	051436	Sensor Assembly, Proximity Magnetic
S8	046077	Switch, Oil Pressure Sensor
S9	046078 ⁸	Switch, Water Temp Sensor

Component List		
Item	Wood-Mizer Part No.	Description
SD1 ¹⁰	052294	Suppressor Assembly, Power Feed Diode
SOL2, SOL3 ²	016371 ¹¹	Solenoid Kit, 200A 12V SPST Hydraulic Pump Motor
VR1	024450-1	Potentiometer, Variable Resistance Power Feed

¹ Circuit Breaker Changed from Cole-Hersee #CH30407-15 to Richard's Electric #123A15A2 to improve durability and reduce cost (11/06).

² Component applies to hydraulic models only.

³ All Solenoid Kits include Diode Wire Assembly 015426 (8/04).

⁴ Was ENM Corp. #T14BH517BC9 (2/09).

⁵ Motor 006747 replaced 014359 supplied until LT30 Rev. K1.01, LT40 Rev. K2.01, LT30HD Rev. K2.01 and LT40HD Rev. K4.01.

⁶ Motor 006747 replaced P04140 and Service Kit A07974 supplied until LT30 Rev. K2.02, LT40 Rev. K3.02, LT30HD Rev. K3.02 and LT40HD Rev. Rev. K5.02 (Replacement requires new Mount Bracket 014073).

⁷ Bosch motor P09955 replaced by vendor with Iskra motor 1/06. Brush kit P09585 no longer available to service Bosch motor. Replace motor using kit 052807 ([See Form #1578](#) for applicable discount information). Use Brush Kit 038682 to service Iskra motor.

⁸ Use Adapter Cable 052267 to connect Fuel Shutoff Solenoid, Oil Pressure Switch or Temperature Switch to sawmills prior to LT30 Rev. J7.04, LT40 Rev. J8.04, LT30HD Rev. J8.04 and LT40HD Rev. J9.04.

⁹ Glow Plug Resistor added to shutoff glow plugs after 20 seconds to prevent damage (LT30 Rev. J8.01, LT40 Rev. J9.01, LT30HD Rev. J9.01 and LT40HD Rev. K1.01). Use kit 052663 to retrofit previous revisions.

¹⁰ Suppressor Assembly 052294 added LT30 Rev. J7.05, LT40 Rev. J8.05, LT30HD Rev. J8.06 and LT40HD Rev. J9.06 to protect feed circuit.

¹¹ All Solenoid Kits include Diode Wire Assembly 015426 (8/04).

Battery Specifications							
Group No.	Type No.	Performance Level		Approximate Weight	Maximum Overall Dimensions		
		Cranking Performance	Reserve Capacity	Wet	Length	Width	Height
24	24M-7	875CC	120	45.0 lb. (20.41 kg)	10.75 in. (273 mm)	6.75 in. (171 mm)	9.875 in. (251 mm)

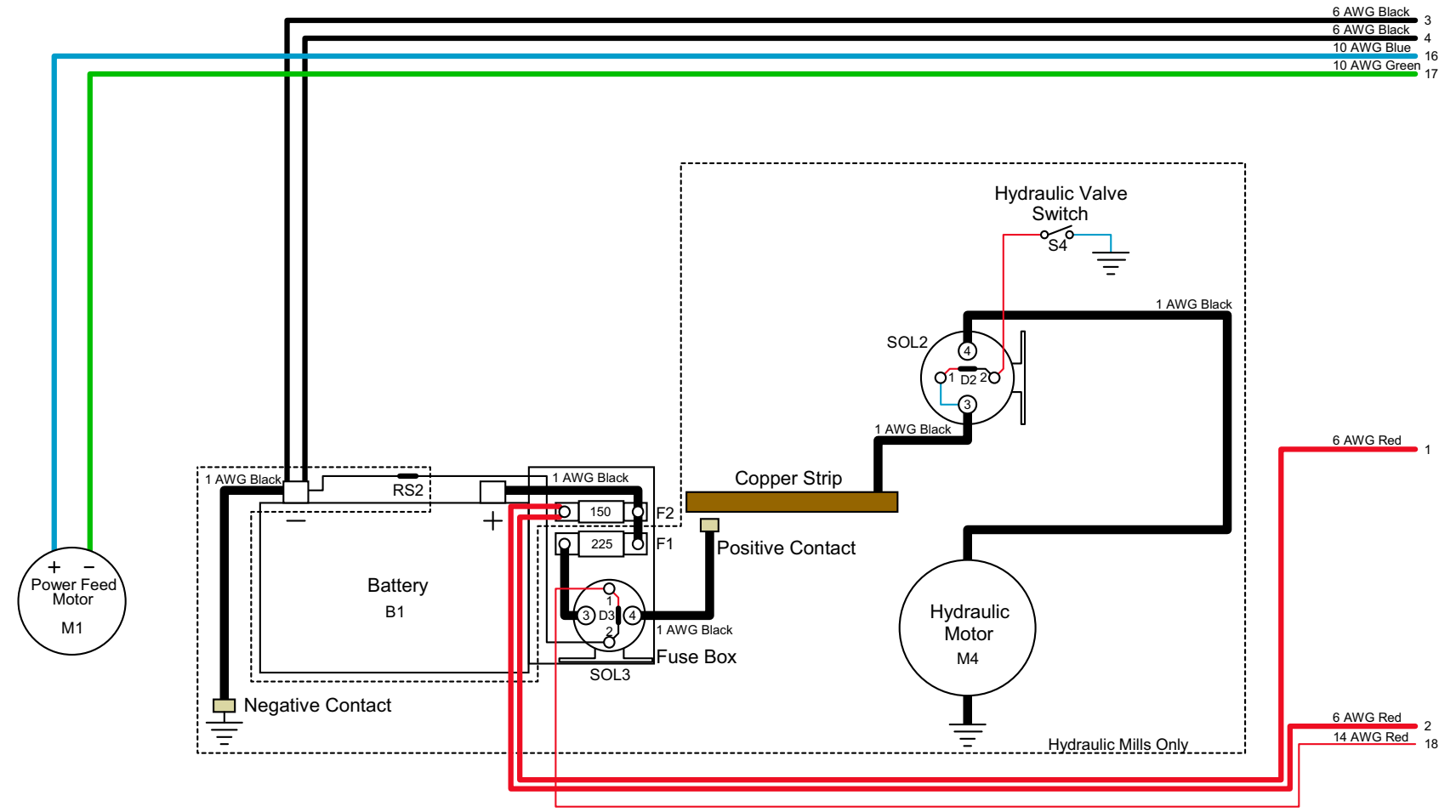

3H1011-1

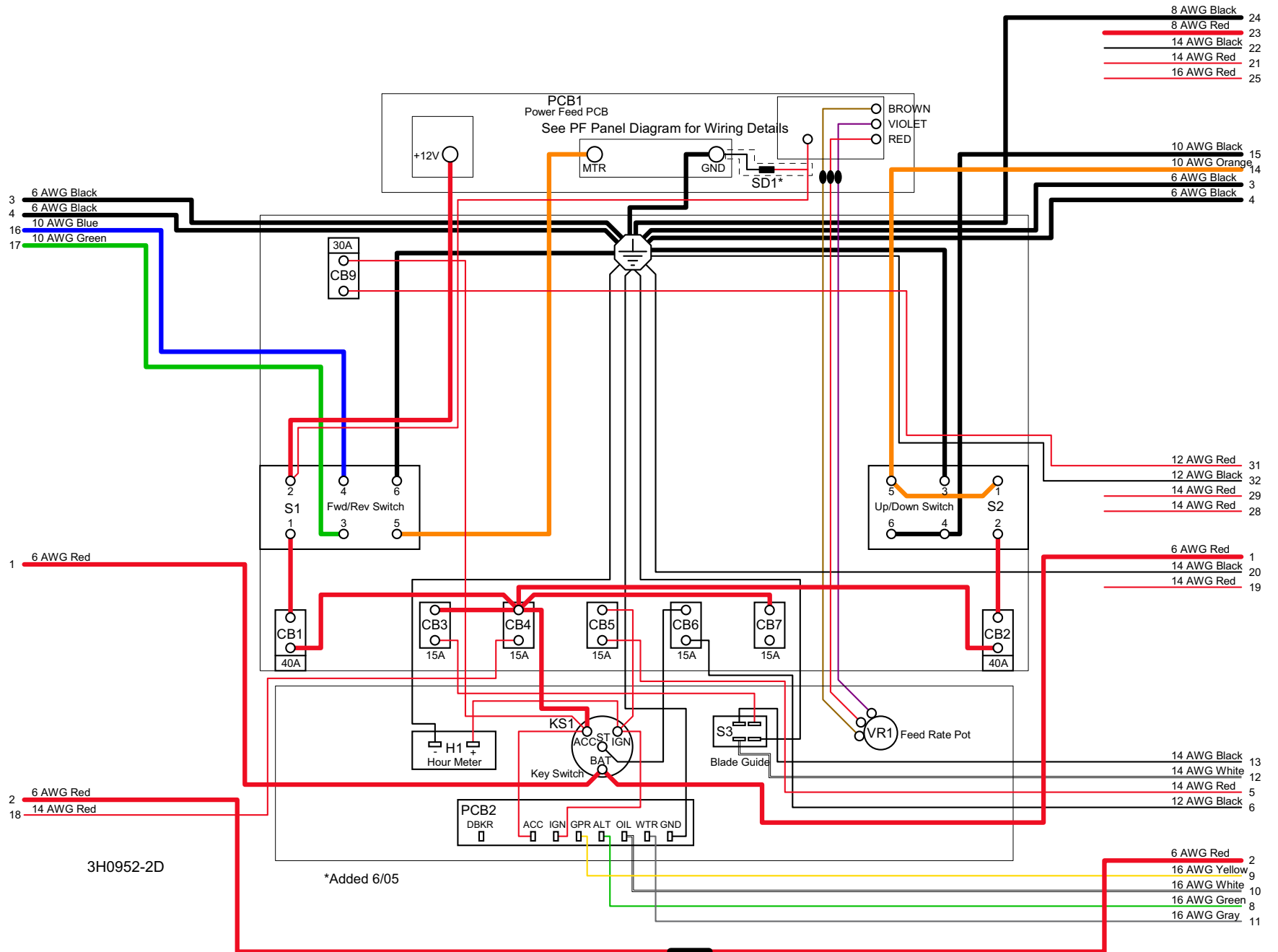

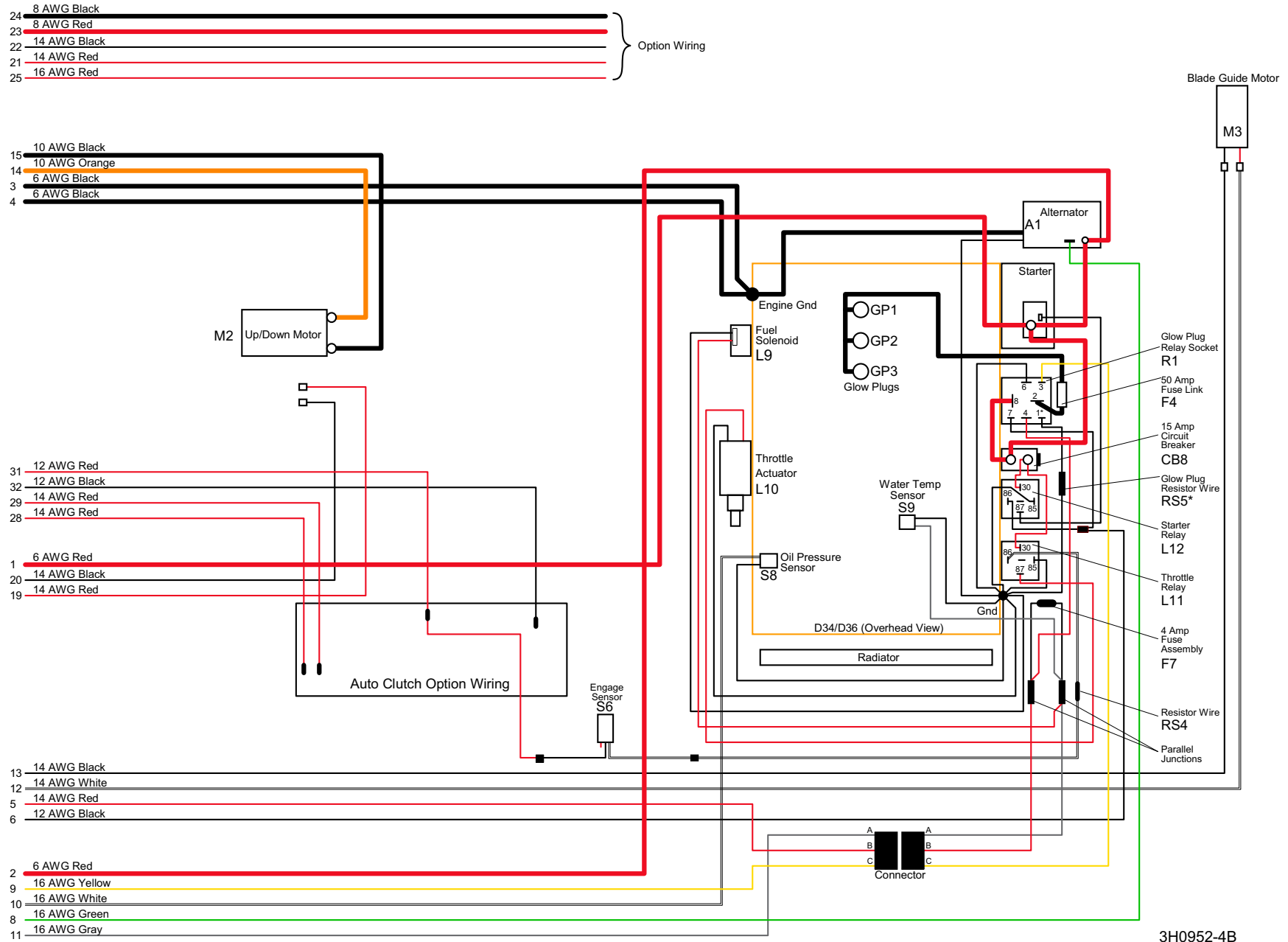

* Resistor wire added 12/05

3H0952-4B

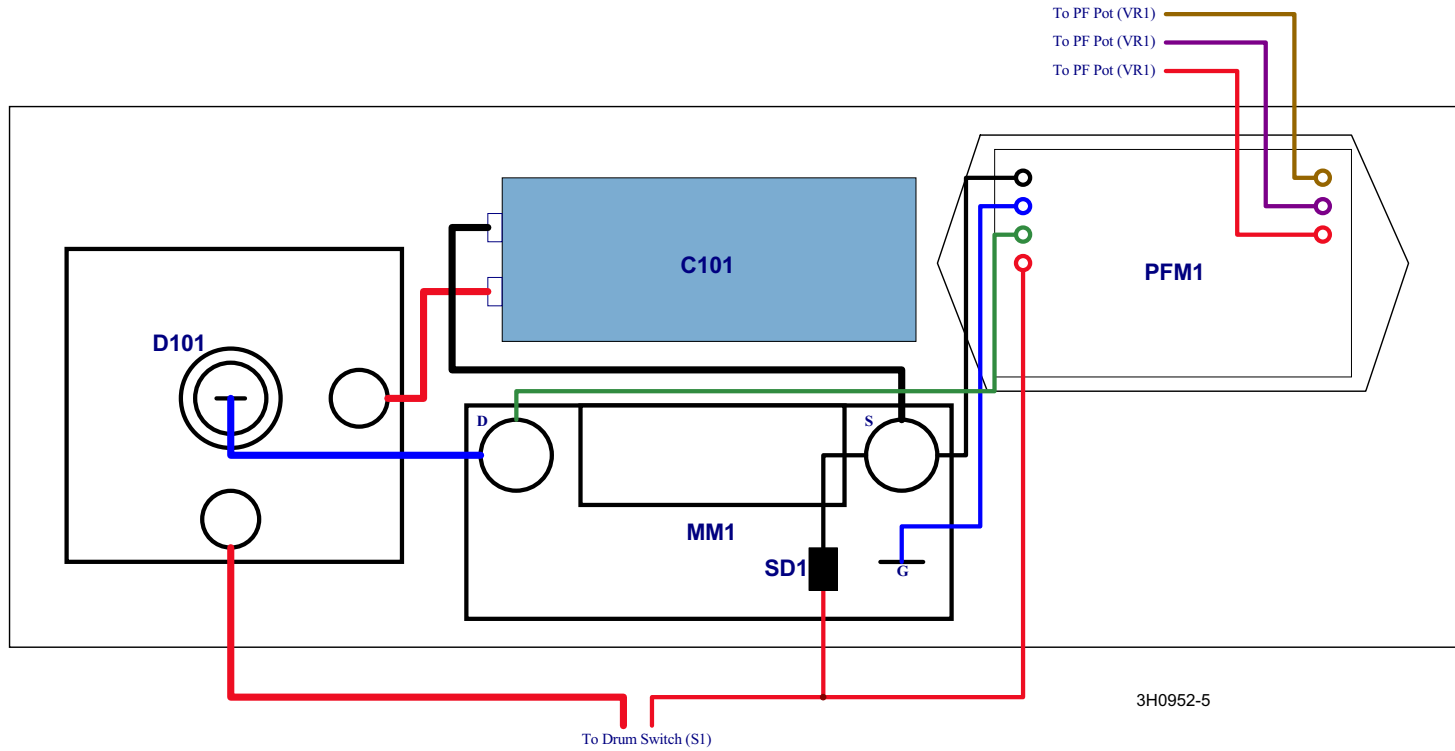

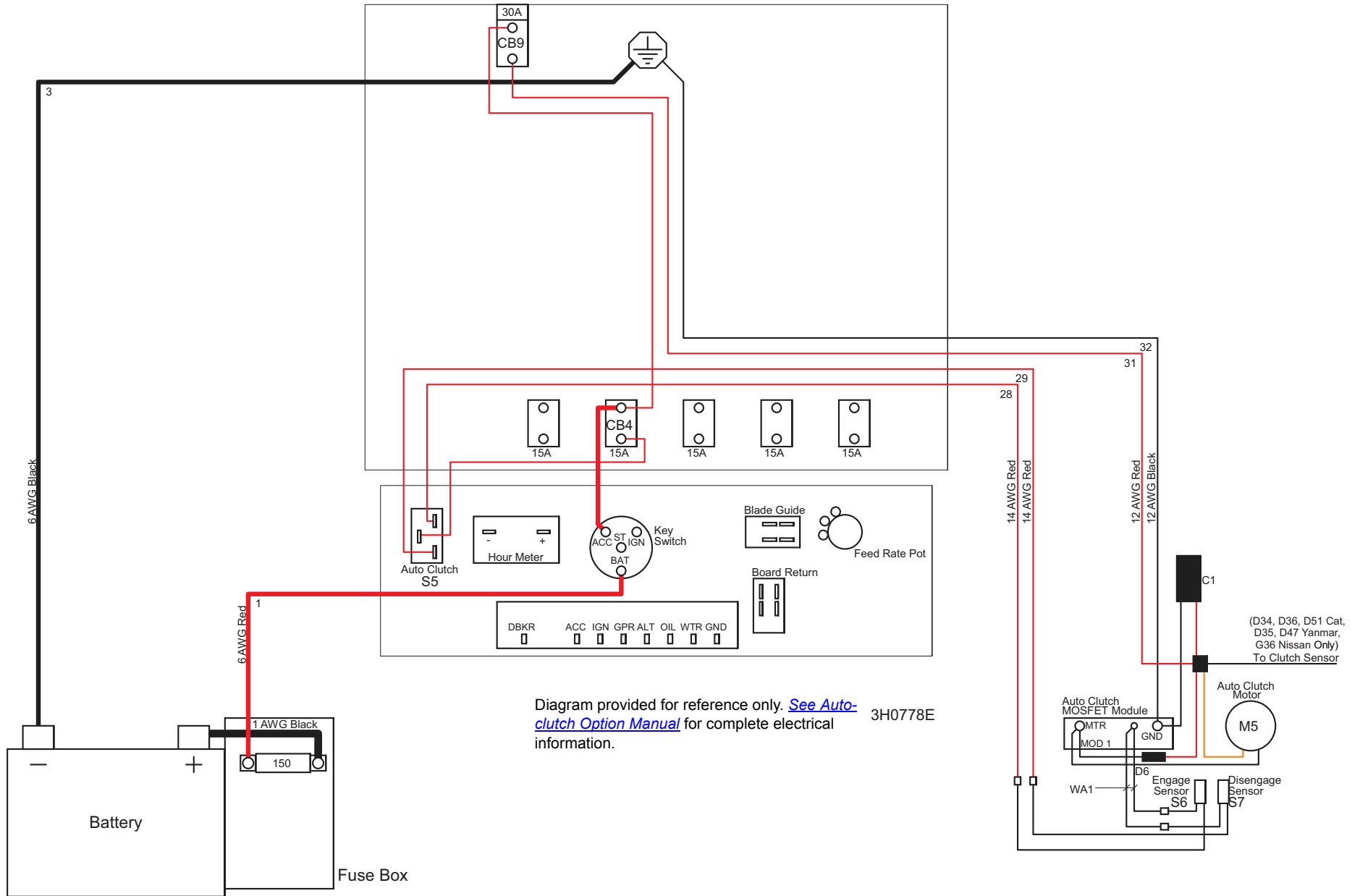

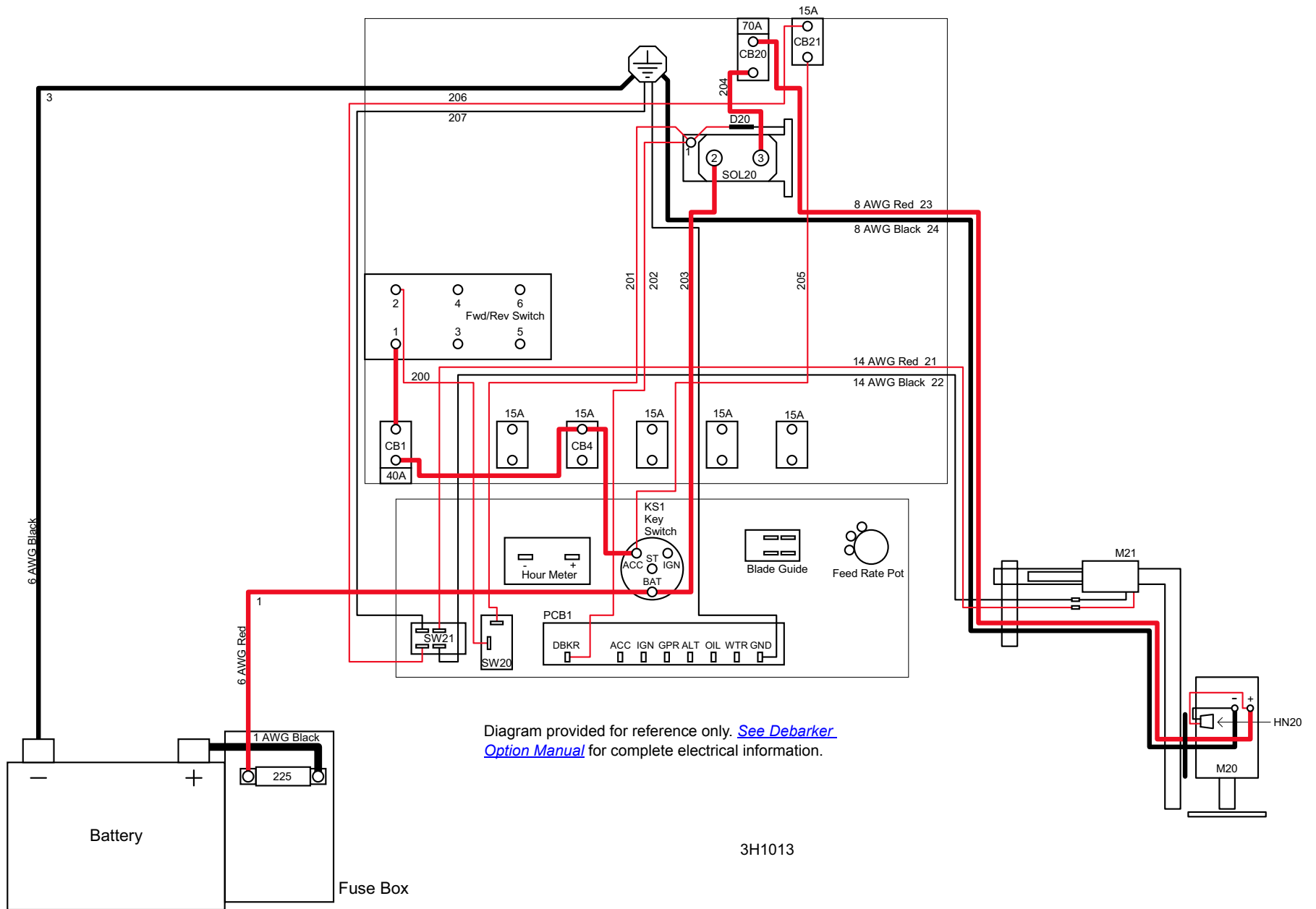

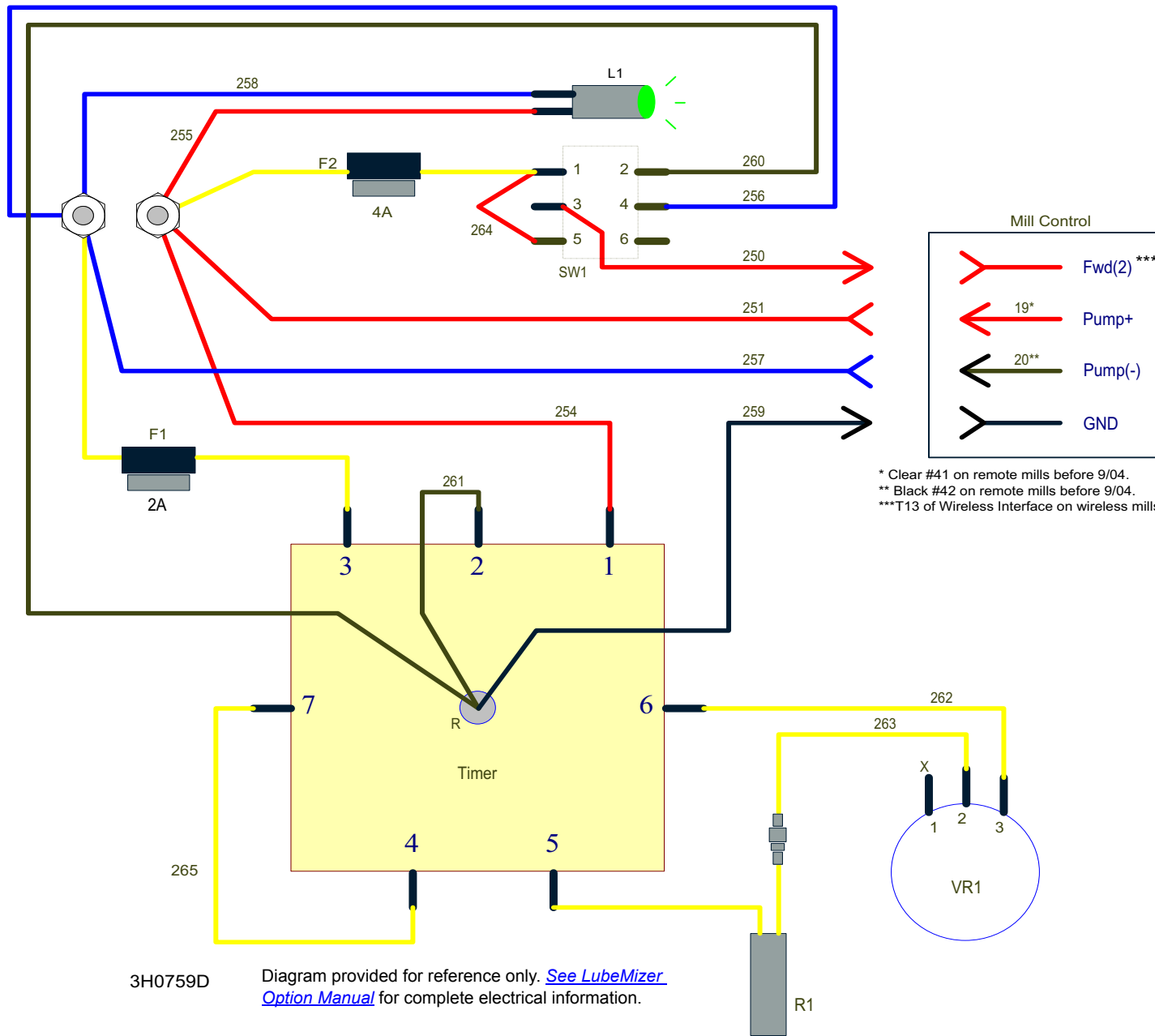

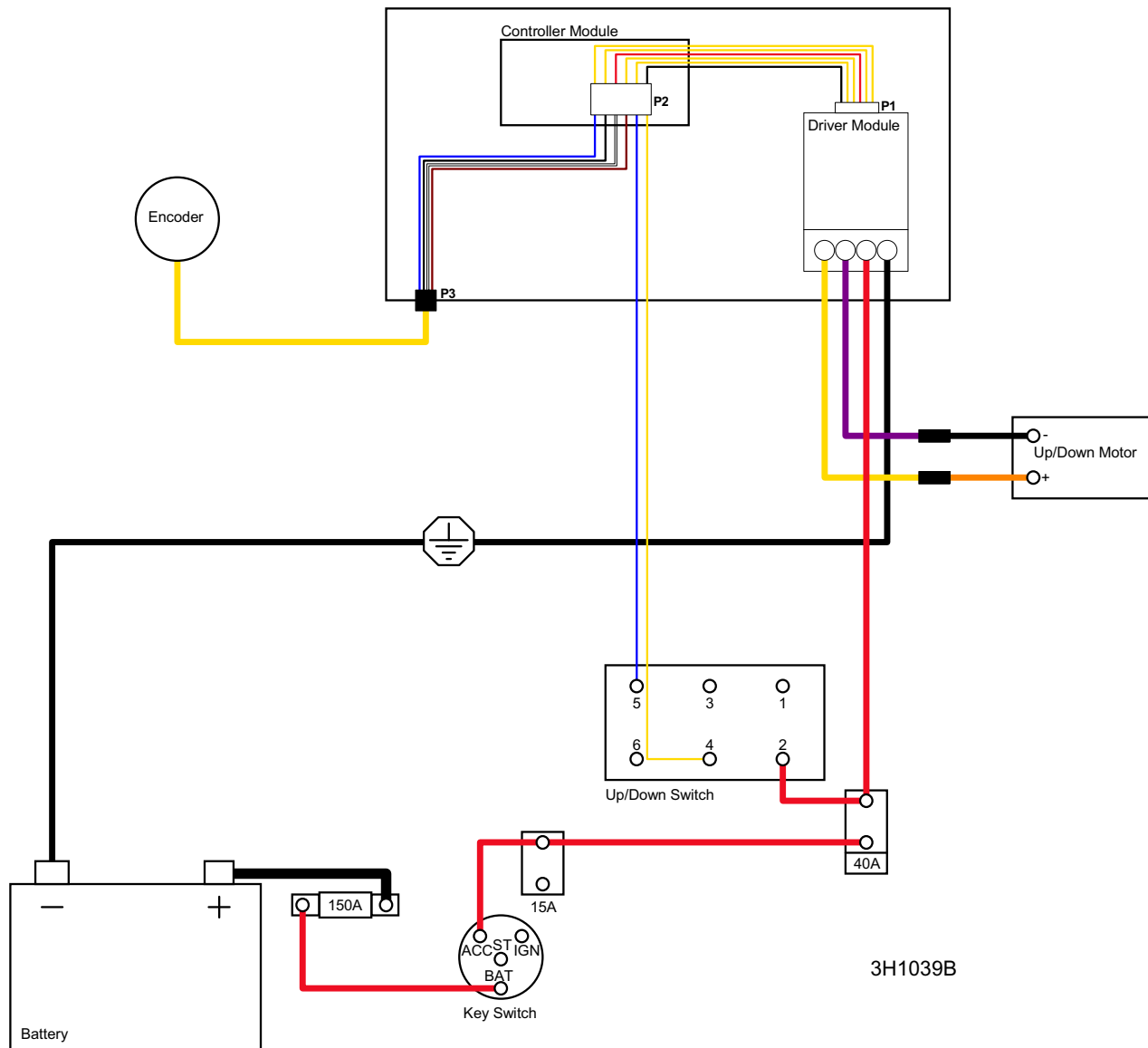

Diagram provided for reference only. [See SimpleSet Option Manual](#) for complete electrical information.

