

FORM 2393 - EG100 CLUTCH RETRO-FIT KIT

Part #	Description	Qty.
T00660-1	BLOCK, TENSIONER	2
T00659-1	PLATE, ENGINE TRAY	2
T00657-1	GUARD, ENGINE DRIVE	1
T00656-1	WASHER, CLUTCH ZINC	1
T00655-1	PULLEY, 2X15,4X108	1
T00346	BELT, DAYCO 7188 15,2 x	2
F81055-1	WASHER, 10.5 FLAT ZINC	4
F81033-3	NUT, M10-8-B HEX ZINC	
F81033-1	NUT, M10-8-B NYLON LOCK	
F81013-1	SCREW M6-8 PAN HEAD	
F81003-4	BOLT, M10x55 FULL THREAD	
F81003-140	SCREW M10X60-8.8-Fe	
F05007-143	BOLT, 3/8-24x1 1/2 HH Gr8	

All dimensions in millimeters.

1. Dismantling

1. Remove the engine drive cover.

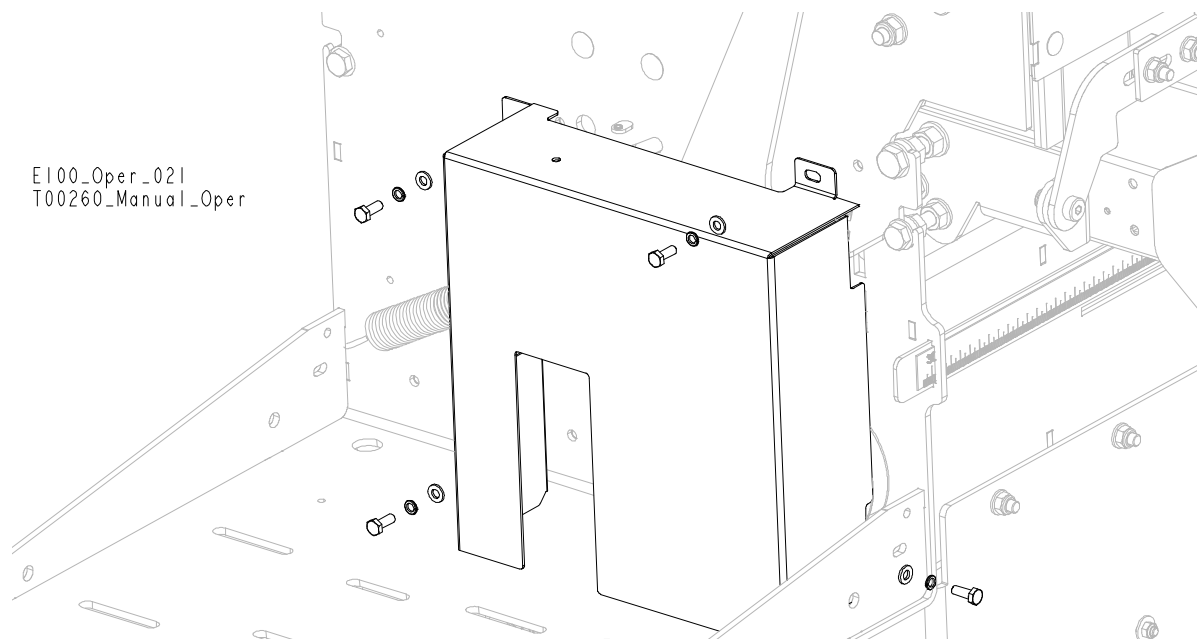

2. Move the engine by loosening the engine mounting screws to get better access to the parts..

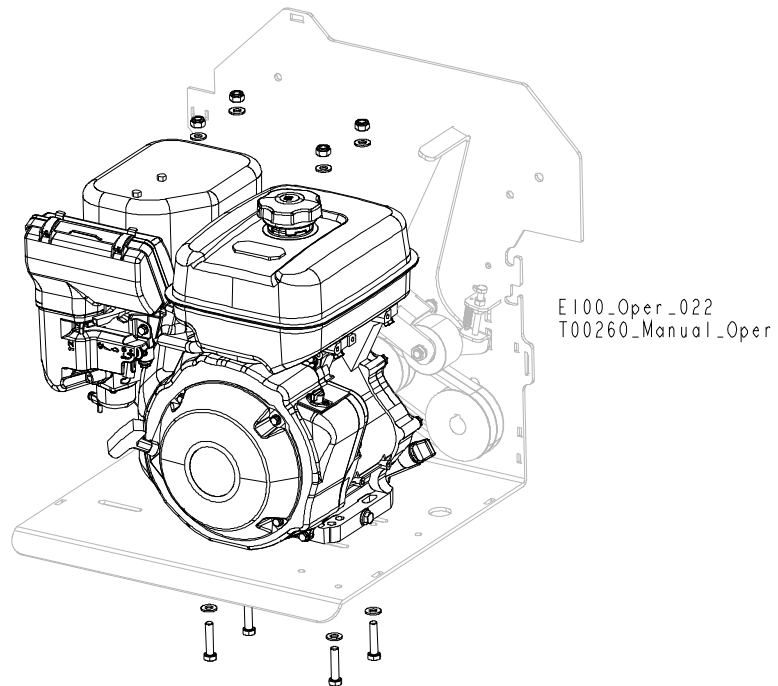

3. Remove the pulleys (A) by using the mounting screws (B).

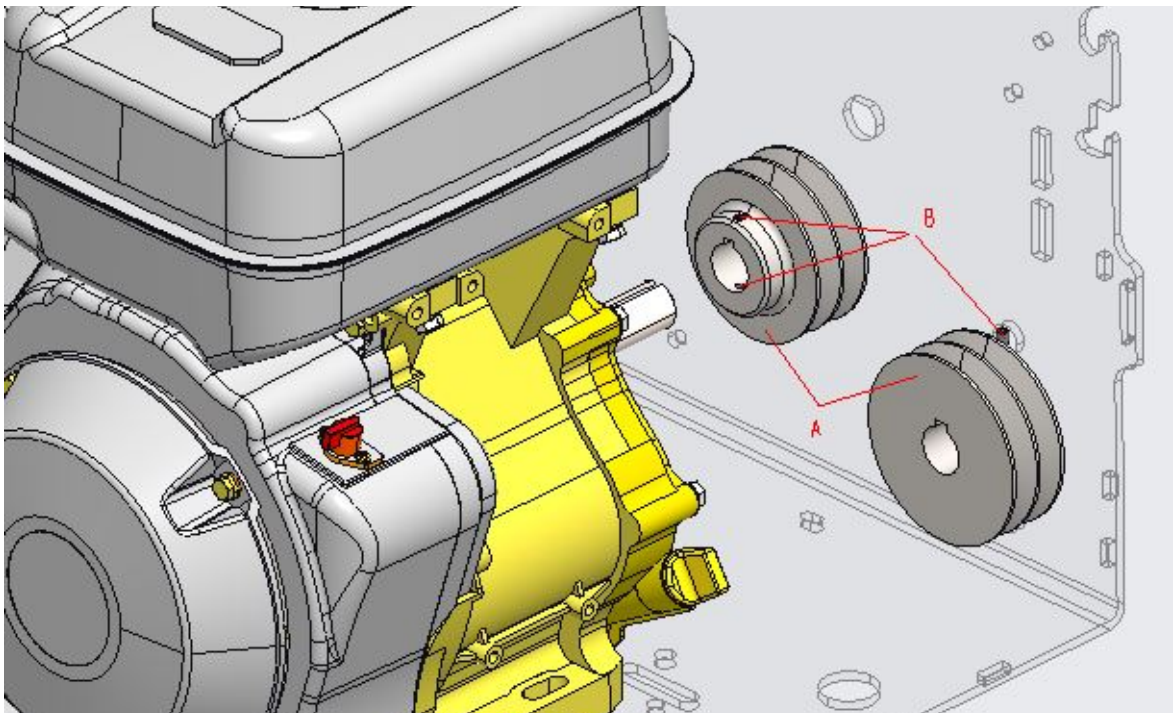

4. Remove the tensioner (A): remove the fasteners (B), then remove the spring (C).

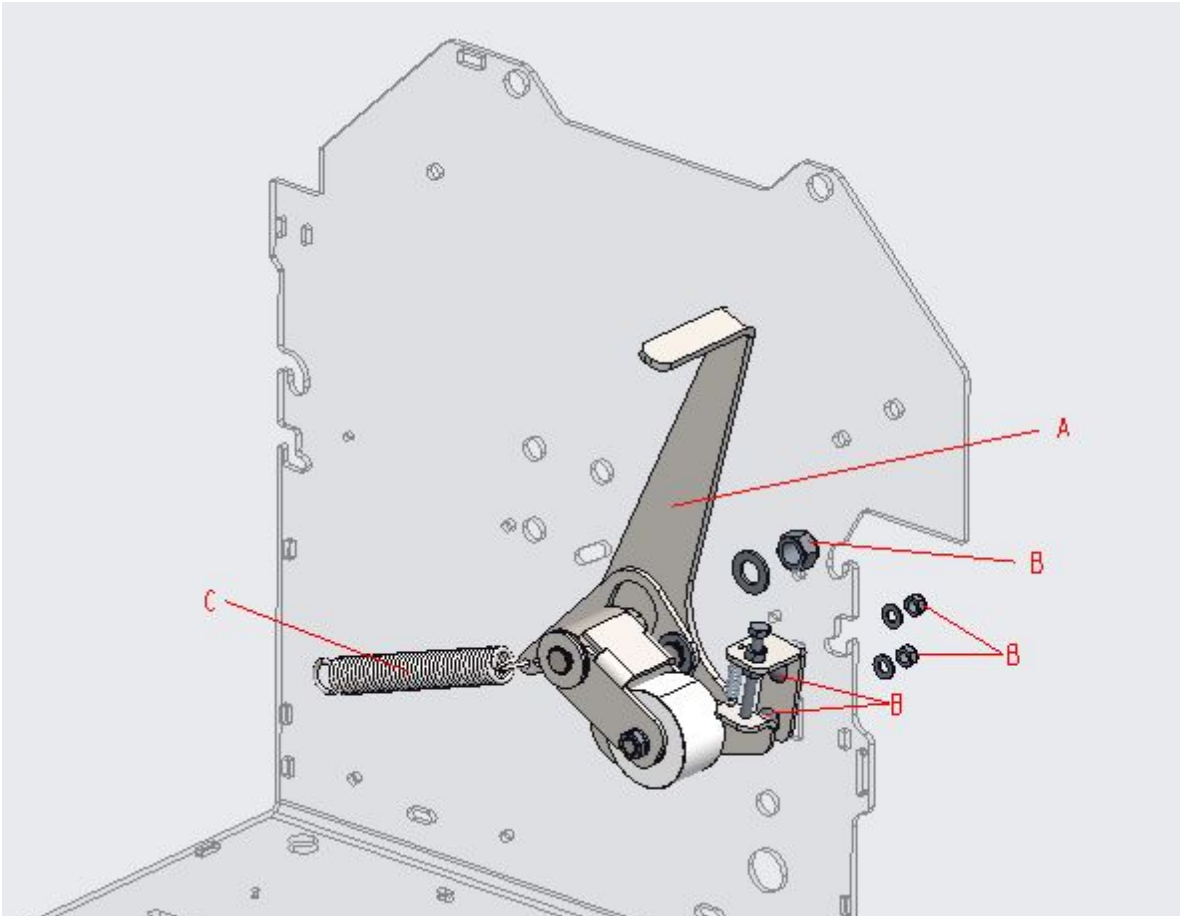

5. Drill 4 holes as shown in the figure below. It will be needed for later installation of tightening bars.

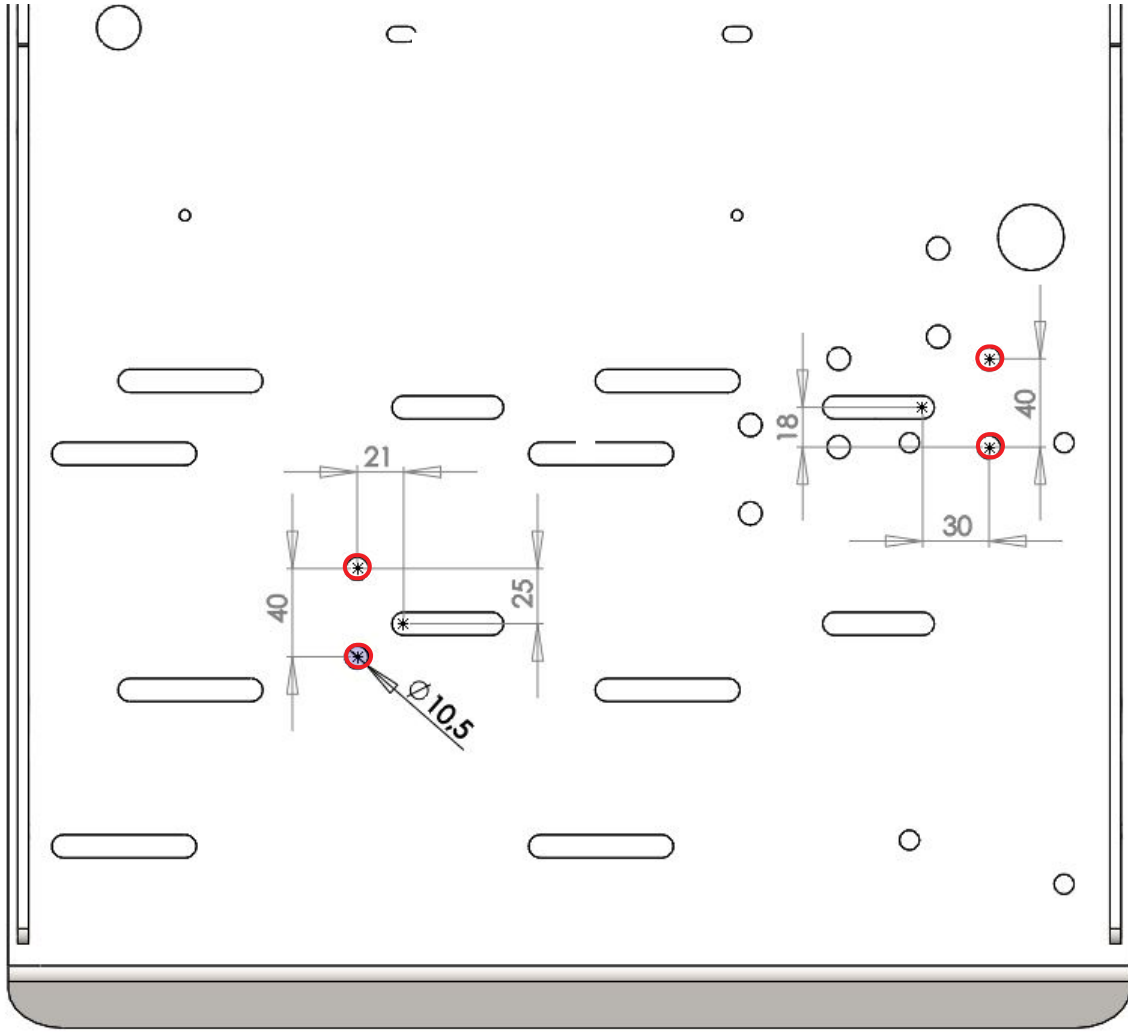

2. Mounting new parts

1. Slide the supplied clutch onto the motor shaft. Remember to reinstall the key.

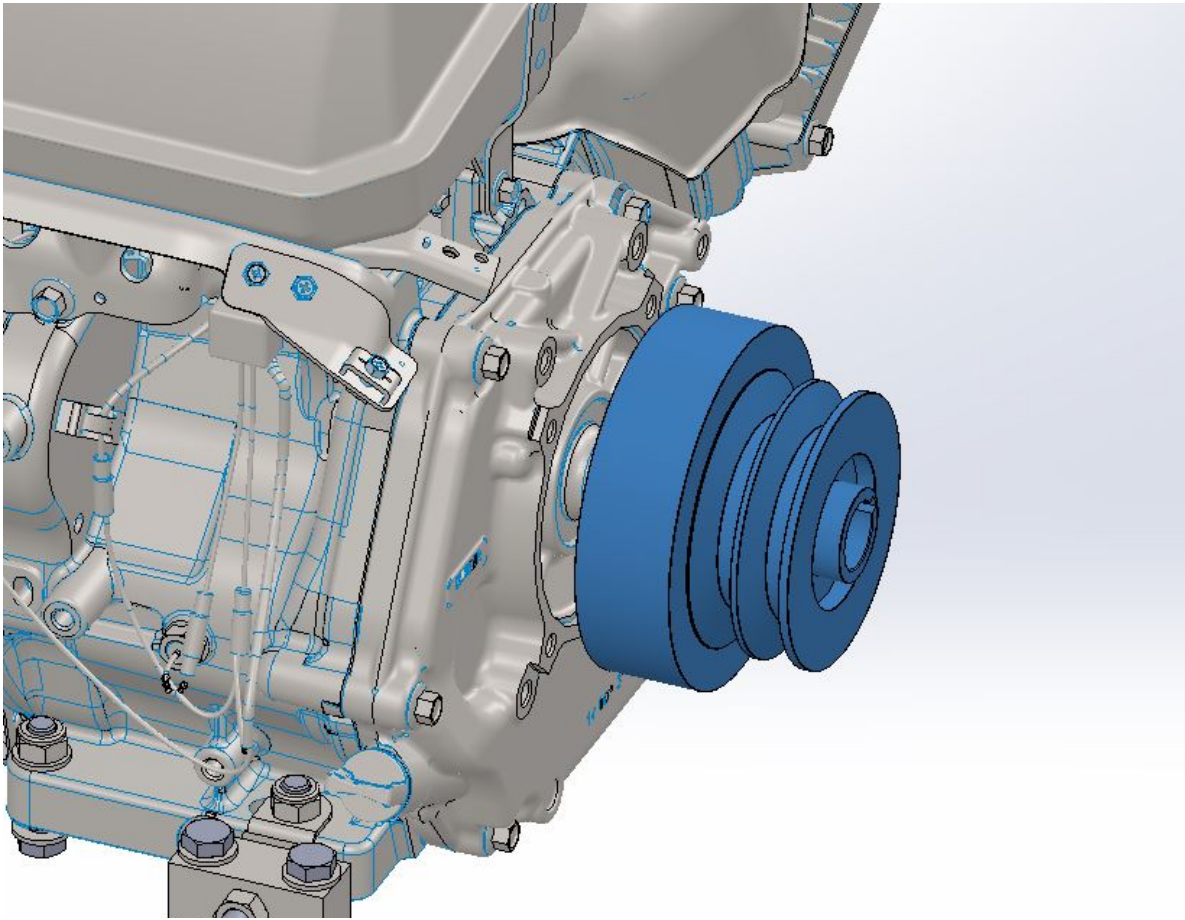

2. Mount the bushing.

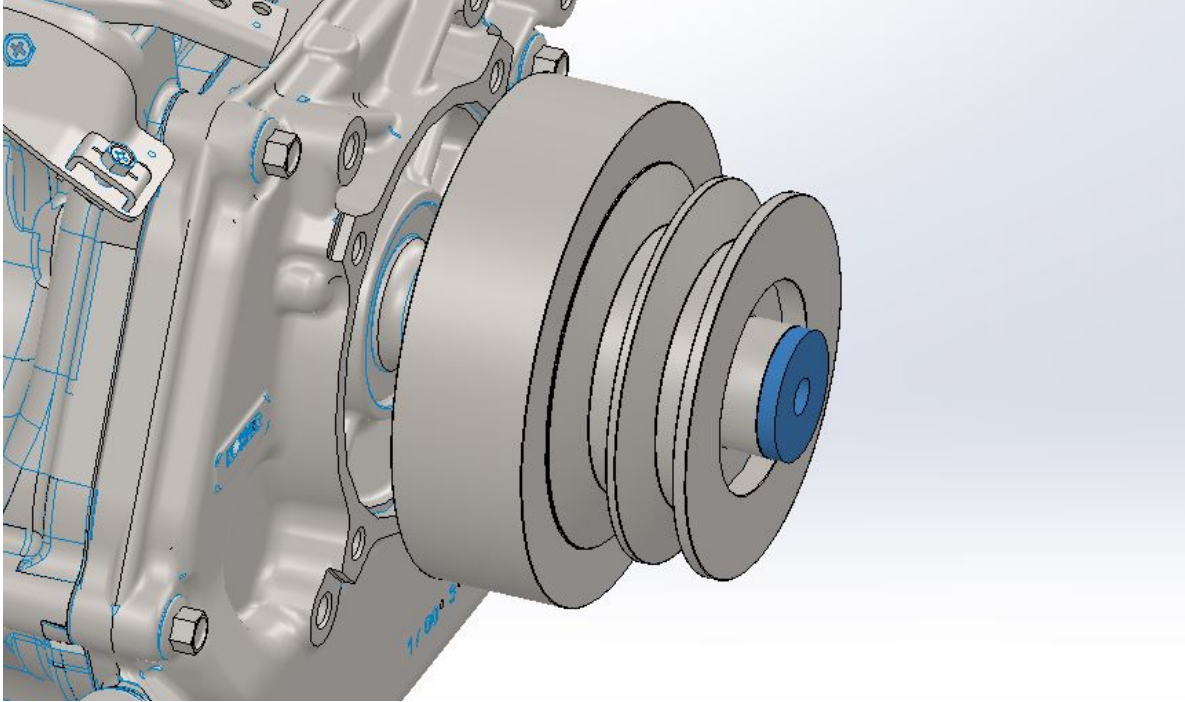

3. Tighten the clutch mounting bolt.

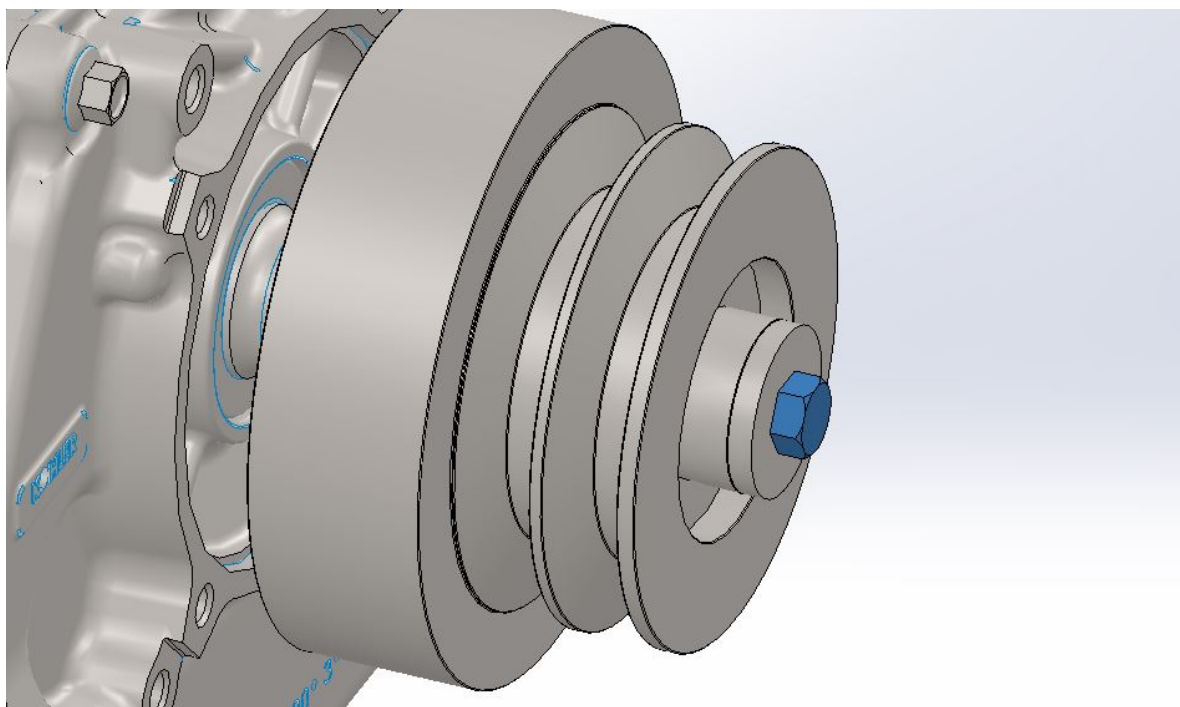

4. Install the belts on the clutch pulley, loosely install the engine.

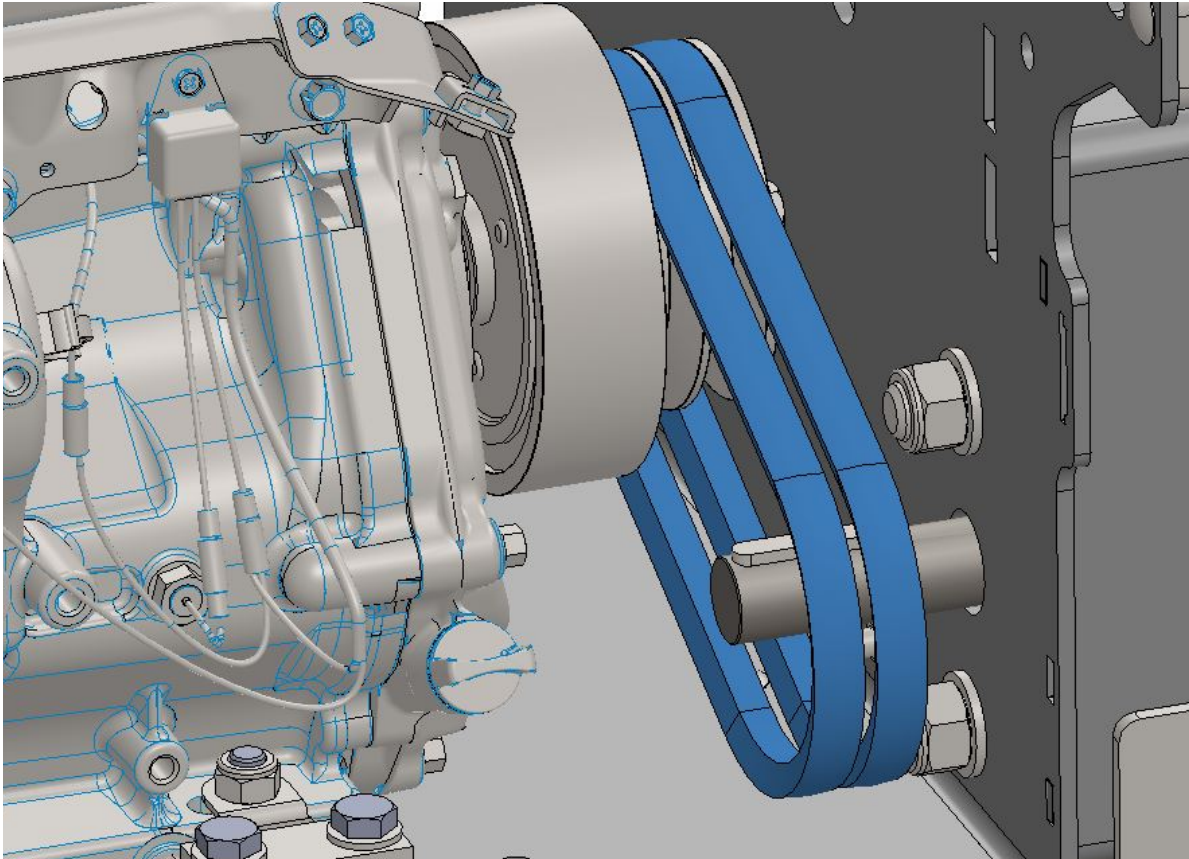

5. Loosely install the new pulley (T00655-1) on the blade drive shaft (make sure to reinstall the key).

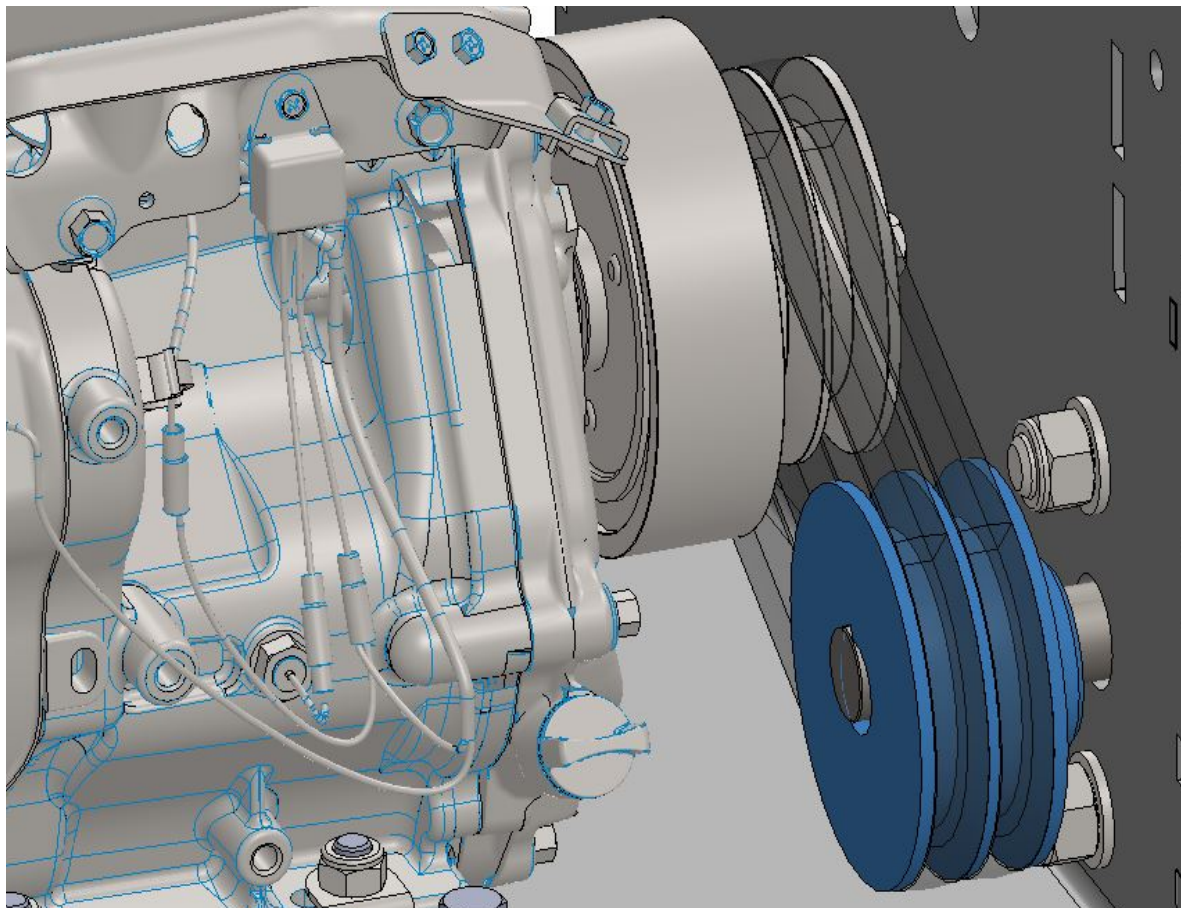

6. Install the belts on the blade drive shaft pulley.

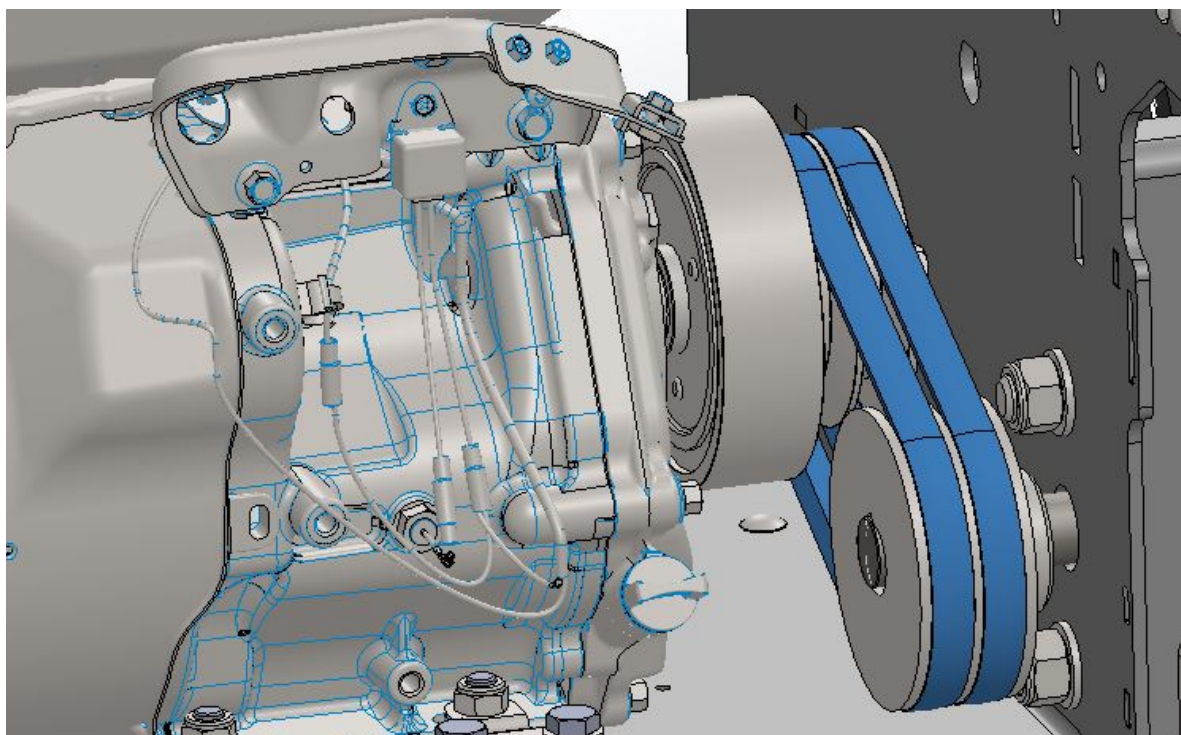

7. Slide the pulley on the blade drive shaft so that it is aligned with the pulley on the clutch. After aligning the pulleys tighten the screw to secure the pulley on the blade drive shaft.

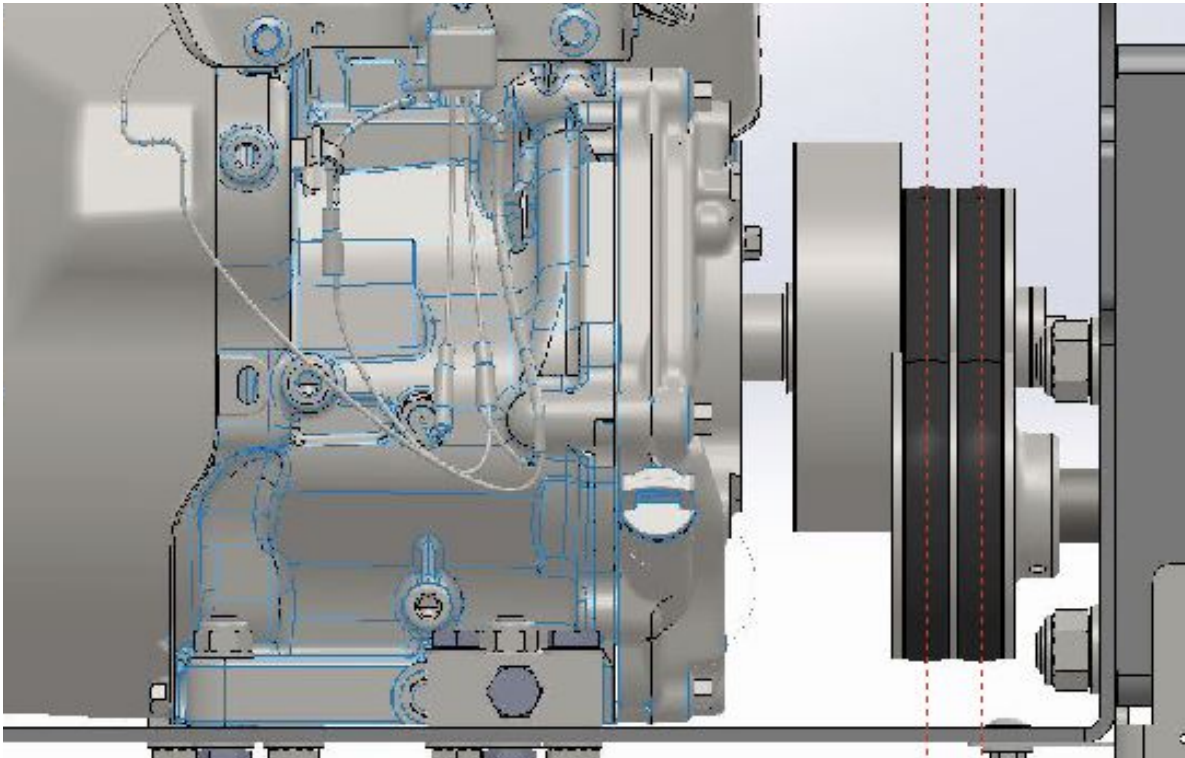

8. Mount the protective plates, as shown below.

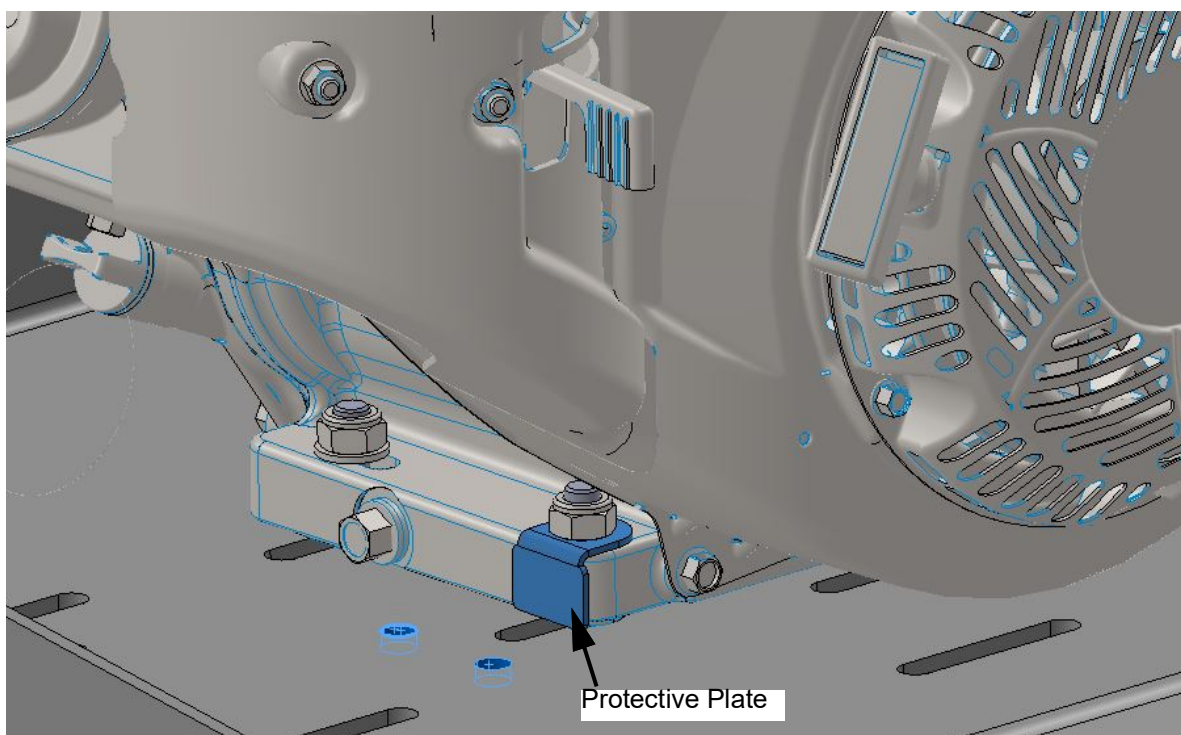
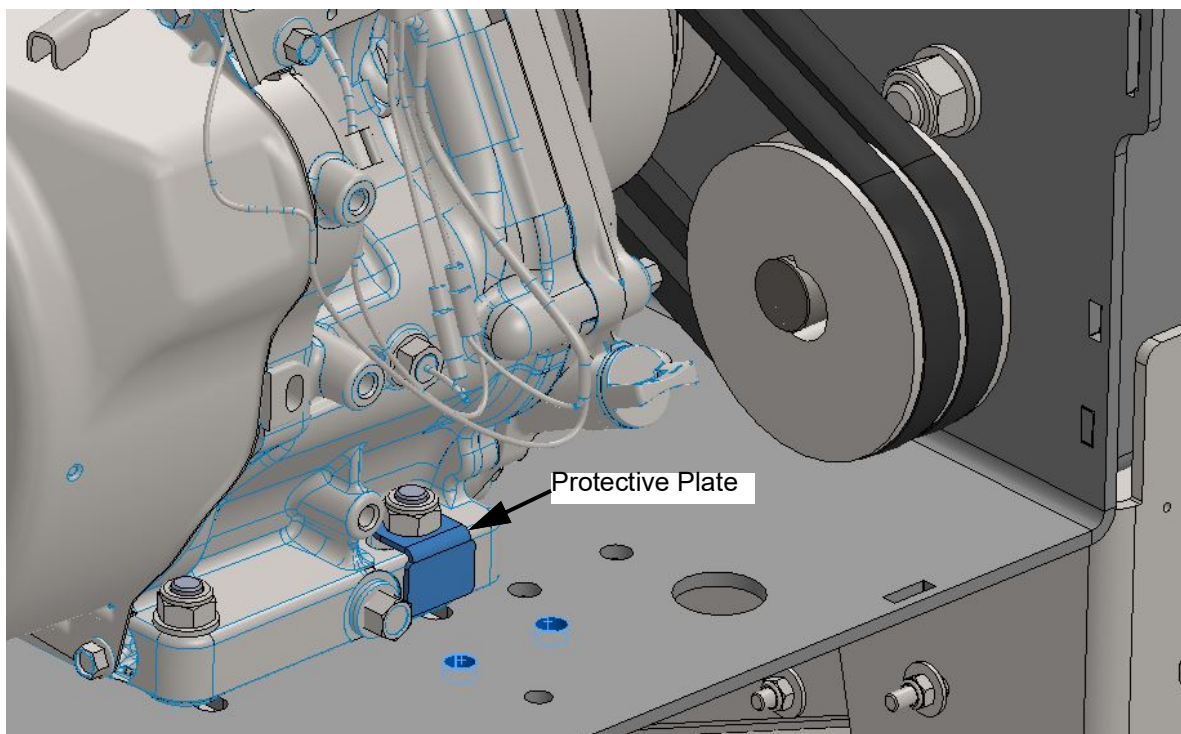

9. Mount the tightening bars using the drilled holes.

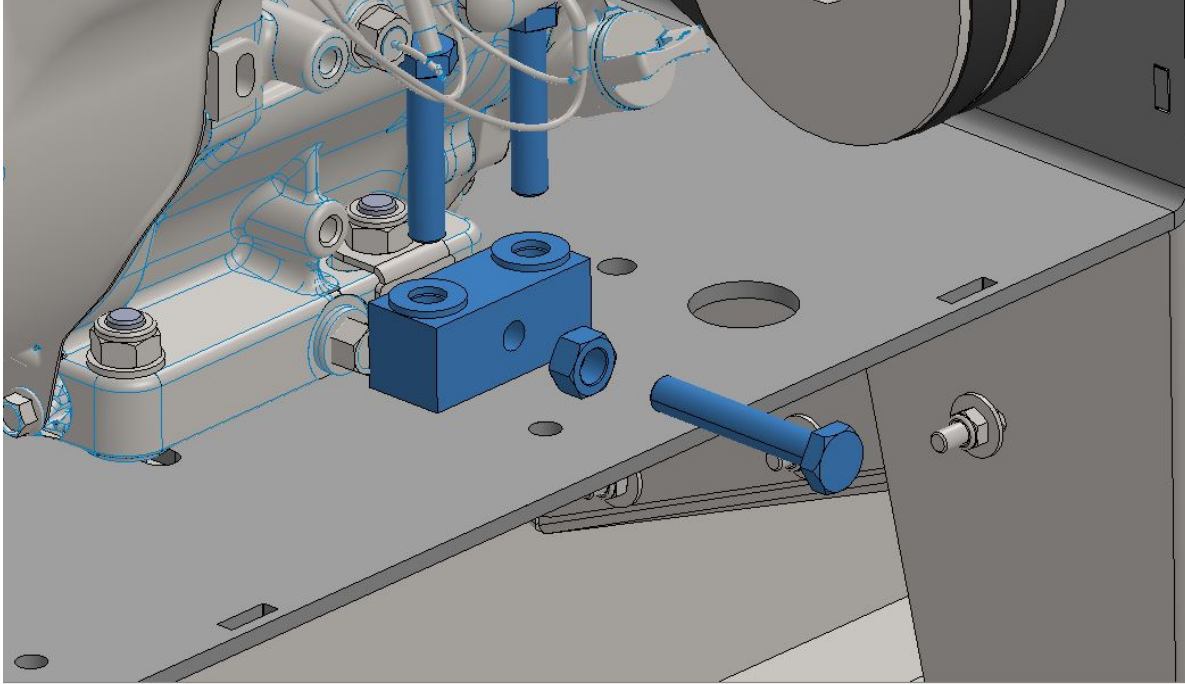

10. Tension the belts with the adjusting bolts.

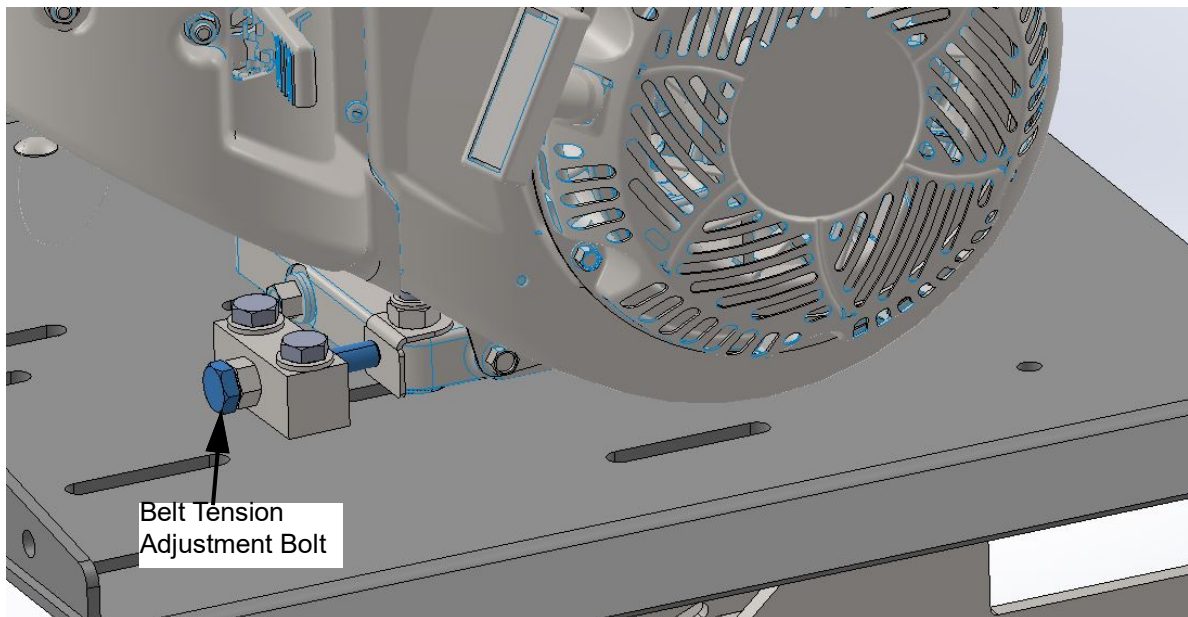
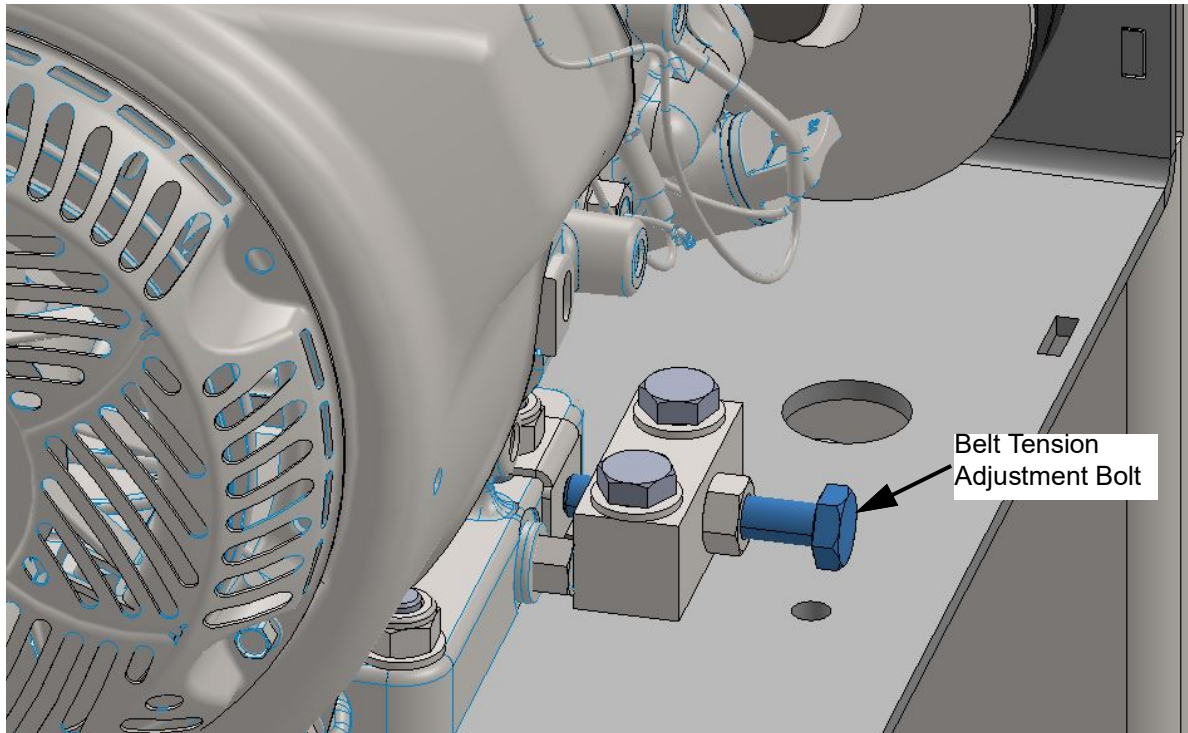

11. Make sure the pulleys with the belts are aligned. If not, use the belt tension adjustment bolts to adjust them.

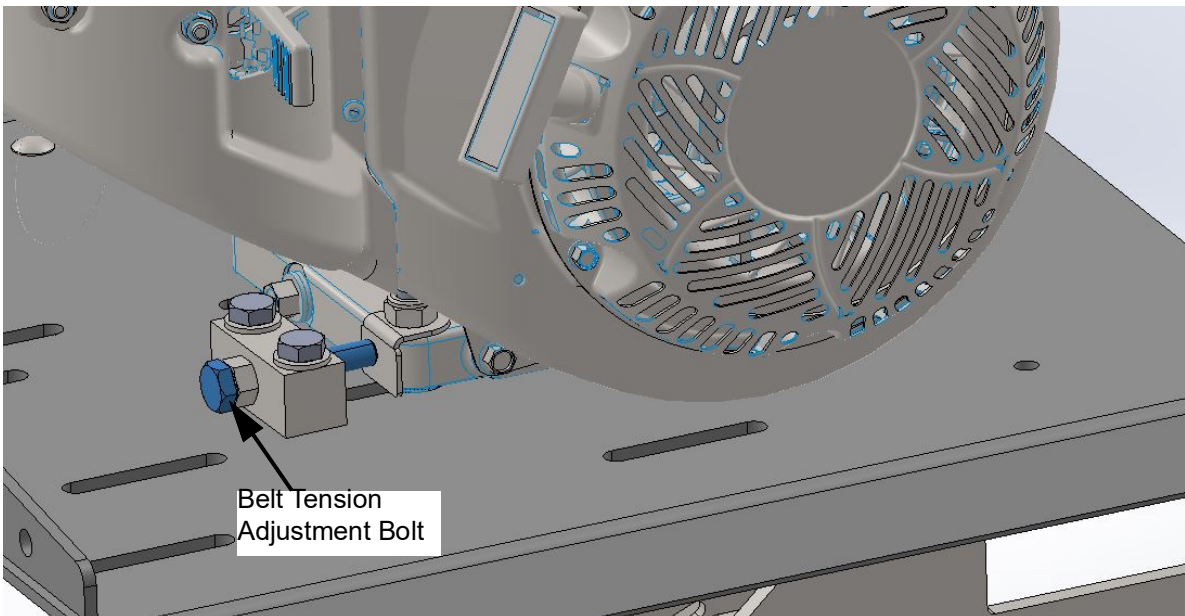
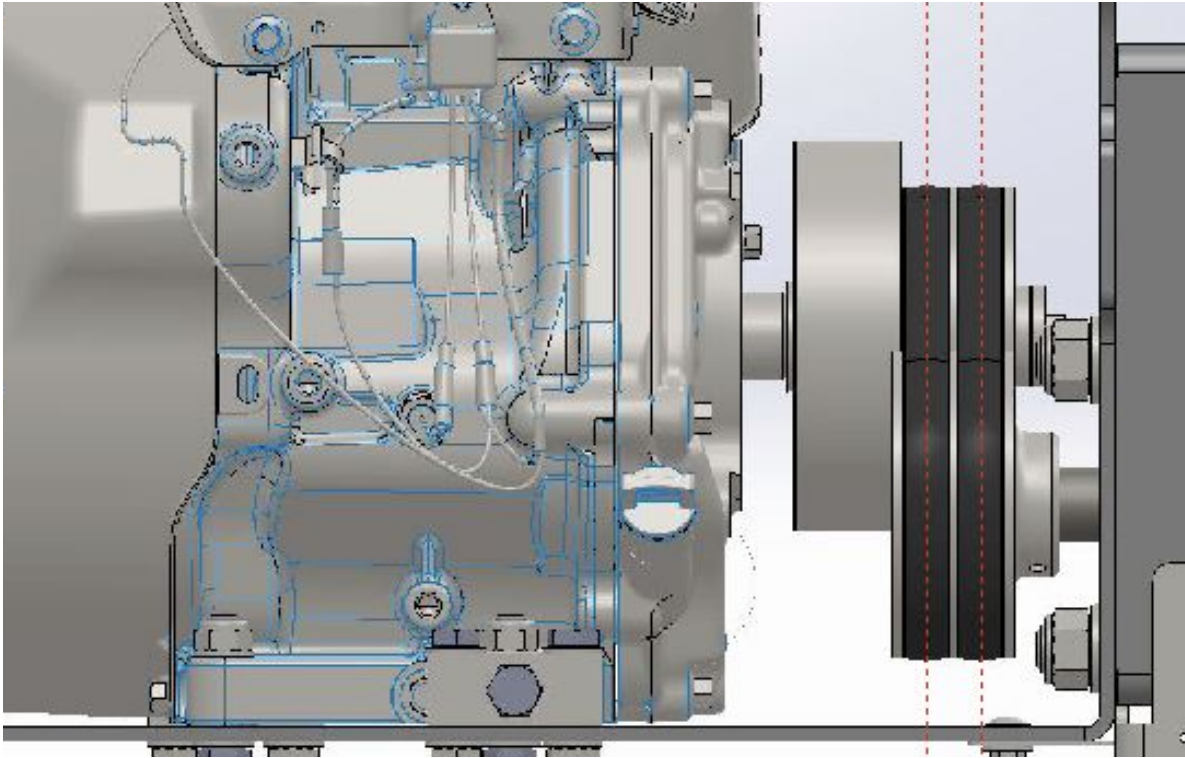

12. After tensioning the belts, secure the adjustment bolt with lock nuts. Tighten the engine mounting bolts

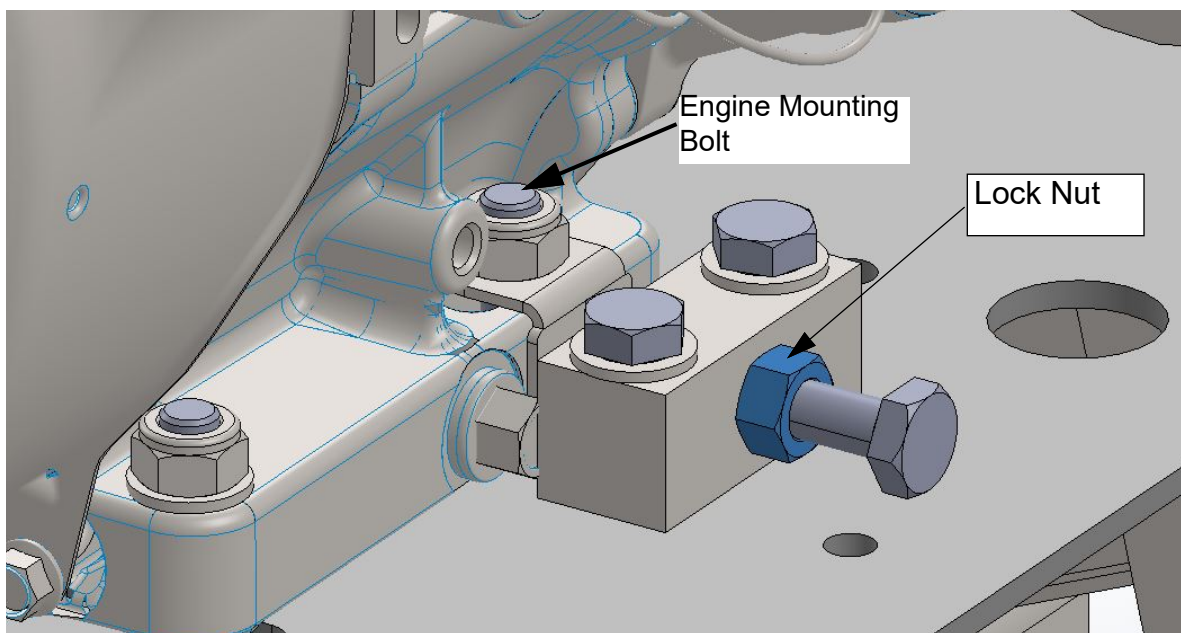
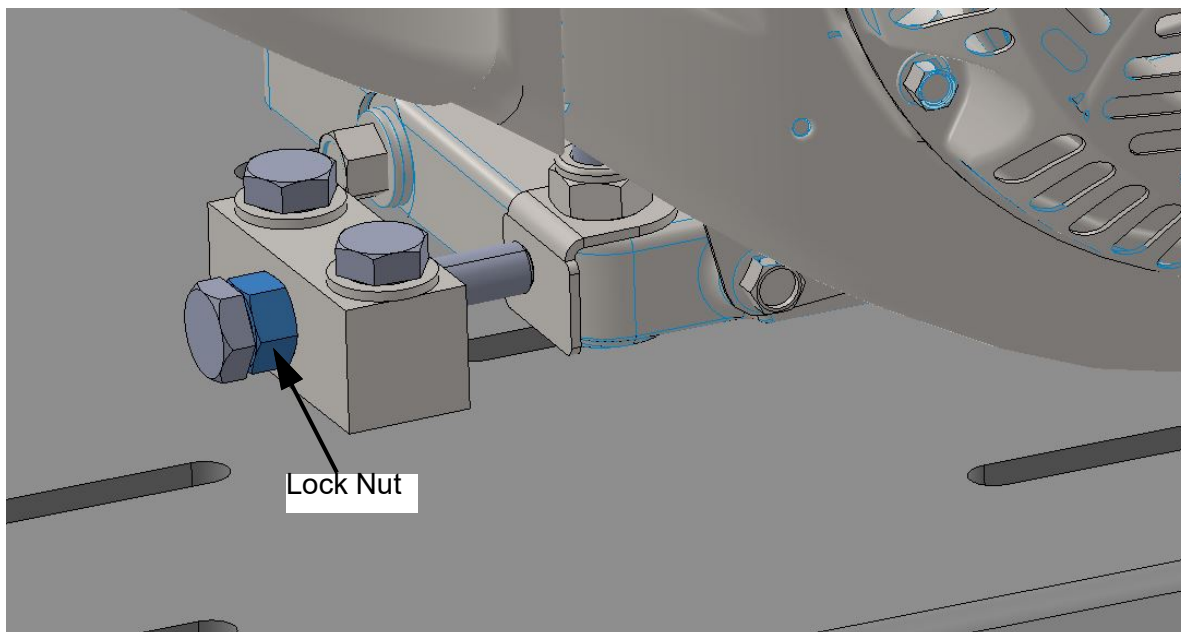

13. Mount the new cover (T00657-1).

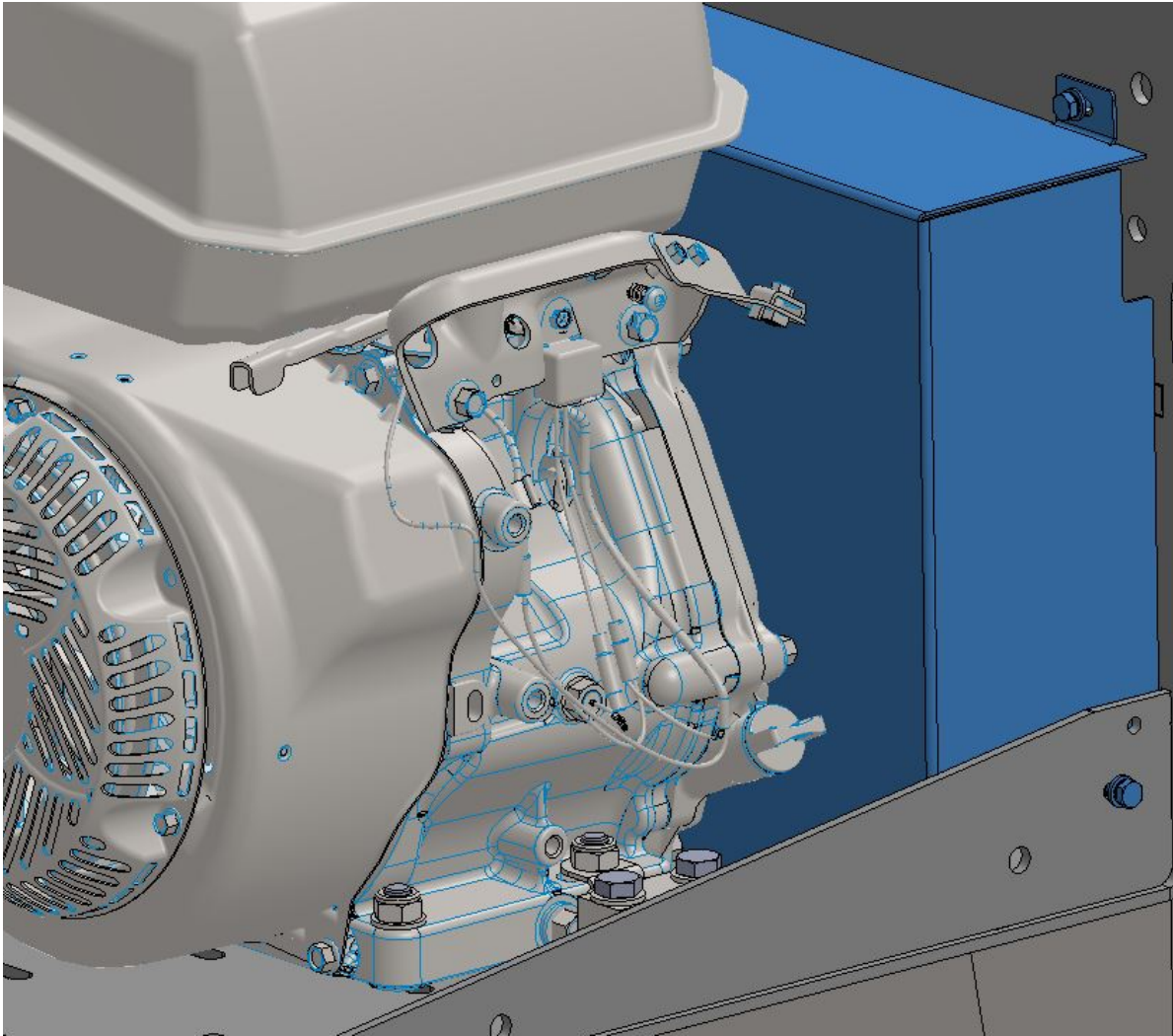

3. Test Run

1. First test: Start the engine. At idle rpm, the blades may not start working. If the blades start working, lower the engine idle rpm (nominal engine idle speed is 1800 rpm).
2. Second test: When the edger is working, lower the engine rpm. Blades should stop working. If not, lower the engine idle rpm (nominal engine idle speed is 1800 rpm).

4. Parts List

4.1 EG100G14S, EG100G14, G14U Engine Kits

E100_060
EG100G14S

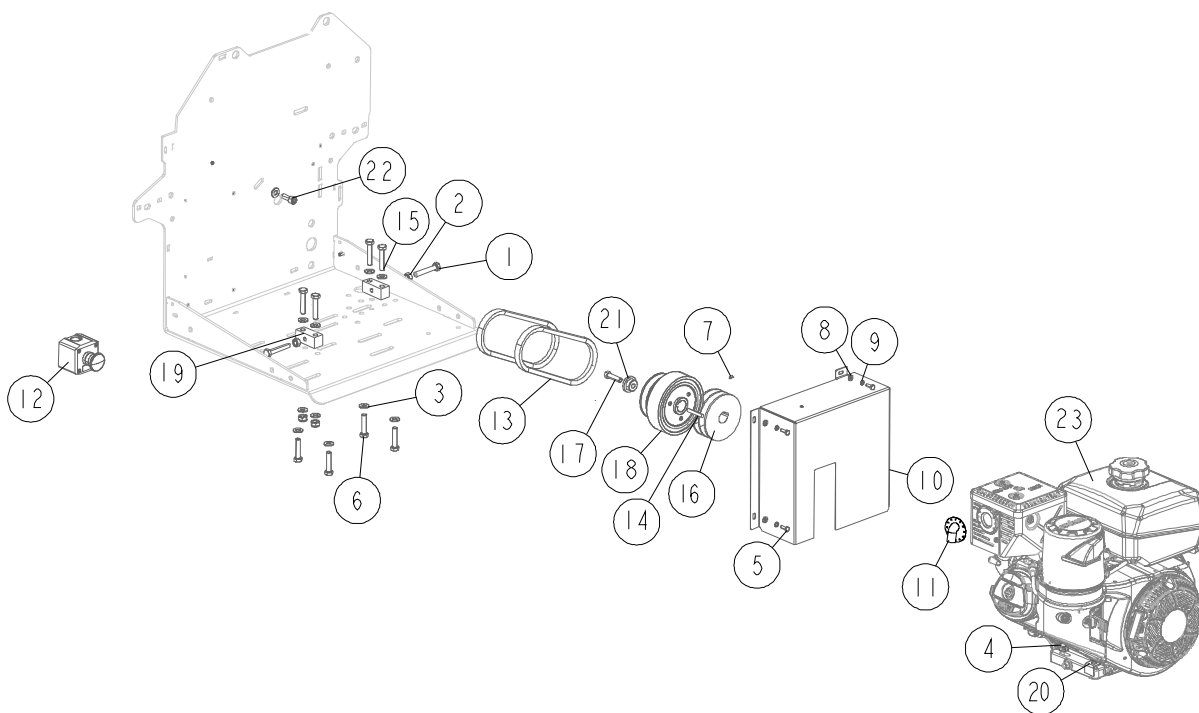

REF.	DESCRIPTION (◆ Indicates Parts Available in Assemblies Only)	PART#	QTY
	ENGINE KIT, EG100 G14S	T00661	1
	ENGINE KIT, EG100 G14, G14U	T00661-3	1
	ENGINE KIT, EG100GU	T00661-3U	1
1	BOLT, M10X60-8.8 HEX HEAD FULL THREAD ZINC	F81003-140	2
2	NUT, M10-8-B-HEX ZINC	F81033-3	1
3	WASHER, 10,5 FLAT ZINC	F81055-1	16
4	NUT, M10-8-B HEX NYLON ZINC LOCK	F81033-1	9
5	BOLT, M6x16 8.8 HEX HEAD FULL THREAD ZINC	F81001-15	4
6	BOLT, M10x45-8.8-HEX HEAD FULL THREAD ZINC	F81003-3	4
7	SCREW, M6x8 45H GEOMET HEX SOCKET SET W/FLAT POINT	F81013-1	2
8	WASHER, 6,4 FLAT ZINC	F81053-1	8

REF.	DESCRIPTION (◆ Indicates Parts Available in Assemblies Only)	PART#	QTY
9	WASHER, Z 6,1 SPLIT LOCK ZINC	F81053-3	4
10	GUARD, ENGINE DRIVE	T00657-1	1
11	DEFLECTOR, KOHLER14HP EXHAUST	110187	1
12	BUTTON, XALK 178 EMERGENCY STOP	E22703-P	2
13	BELT, DAYCO 7188 15,2 x 596 Le DRIVE	T00346	2
14	KEY, 6,35 x 6,36 x 40	092601	1
15	BOLT, M10x50-8.8-HEX HEAD FULL THREAD ZINC	F81003-4	4
16	PULLEY, 2X15,4X108	T00655-1	1
17	BOLT, 3/8-24X1 1/2 HH Gr8 Yzc	F05007-143	1
18	CLUTCH, NORAM 180009 CENTRIFUGAL	T00654	1
	SPRING	T00665	3
	LINING, CLUTCH	T00666	3
	HUB ASSEMBLY	T00667	1
	PULLEY, W/DRUM	T00668	1
	BUSHING, 6007-2RS	096955	2
	RING, W62 RETAINING	F81090-1	1
	RING, Z35 RETAINING	F81090-36	1
19	BLOCK, TENSIONER THREADED	T00660-1	2
20	PLATE, ENGINE TRAY SECURING	T00659-1	2
21	WASHER, CLUTCH ZINC	T00656-1	1
22	SCREW, M10x25 8.8 HEX SOCKET HEAD CAP ZINC	F81003-32	1
23	ENGINE, KOHLER G14 (CH440-3149)	X200-1201	1