

FORM 2379 LX150 SIMPLE SET RETROFIT INSTRUCTIONS

Part No. SSW-LX150-A

DESCRIPTION (↗ Indicates Parts Available in Assemblies Only)	PART #	QTY.
SIMPLESET, FIELD INSTALLED	SSW-LX150-A	1
Control Assy, LX150 SimpleSet	073694	1
Sensor Assy, Magnetic Position	053369	1
Guard, LX150 Up/Dn, SSW	110701	1

Installation Instructions

1. Turn the key switch to the OFF (0) position and remove the key.

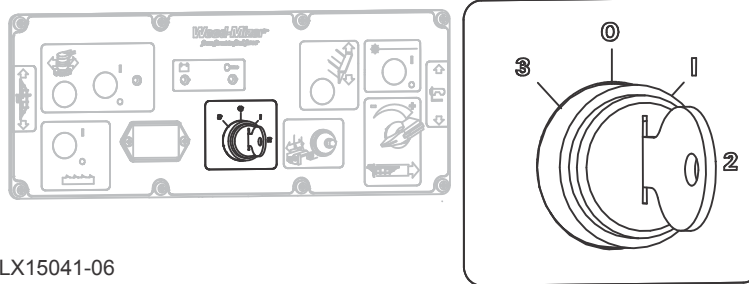



FIGURE 1

2. Remove the battery box cover and disconnect the negative battery terminal.

 **WARNING!** Disconnect the negative battery terminal cable before performing any service to the 12-volt electrical system. Failure to do so may cause injury or electrical system damage.

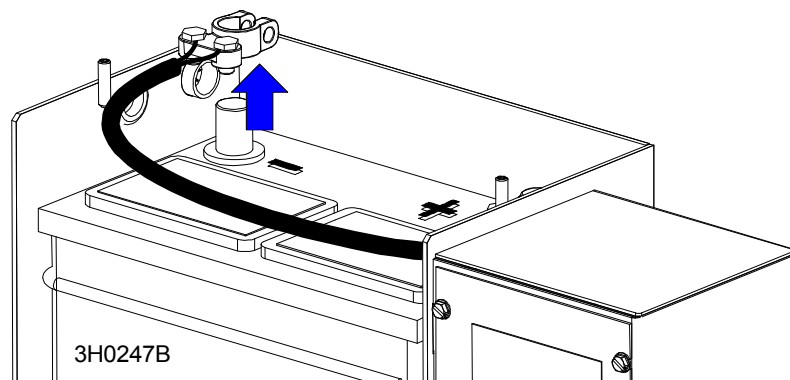

FIGURE 2

Rewire the control box

1. Remove the sawmill control box lid, front panel, up/down drum switch handle and switch mounting screw (releasing the drum switch for easier access), two screws with nuts (at the top rear center of the control box), and top panel. (See FIG. 3.)
2. Retain the front panel, up/down drum switch handle, and their mounting hardware for reinstallation.

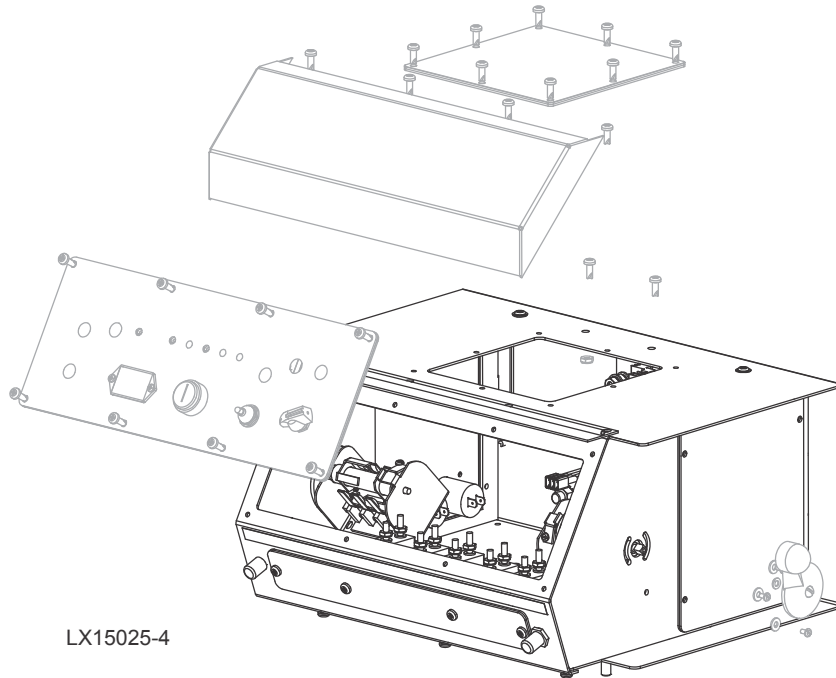

FIGURE 3



IMPORTANT! Only remove the wires specifically called out. Leave all other wires connected as is.

Refer to the before/after wiring diagrams at the end of these instructions for reference.

3. Remove the white wire from drum switch S2, terminal #4 and reconnect it to drum switch S2, terminal #2. (See FIG. 4.)

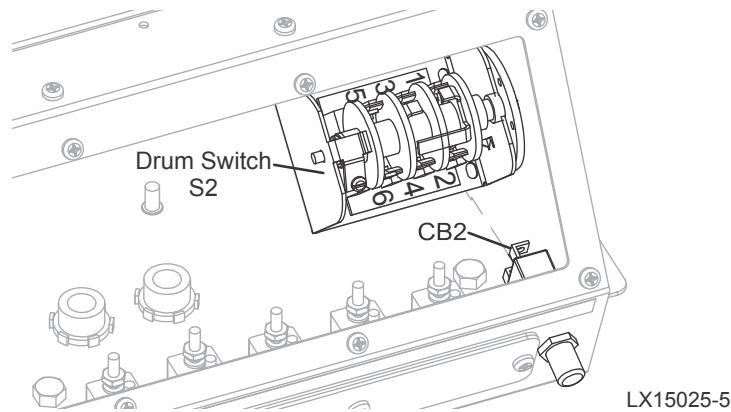

FIGURE 4

4. Disconnect the brown wire coming from the low-limit switch S4 (from outside the control box) at the red jumper wire at solenoid SOL5, terminal #1 and reconnect it to the brown input wire of the diode D1. (See FIG. 5 and 6.)

NOTE: The diode D1 appears as a black shrink-wrapped bulge at the end of a white wire coming from the drum switch S2 terminal #1 with two unattached wires (one brown, one red) in the control box.

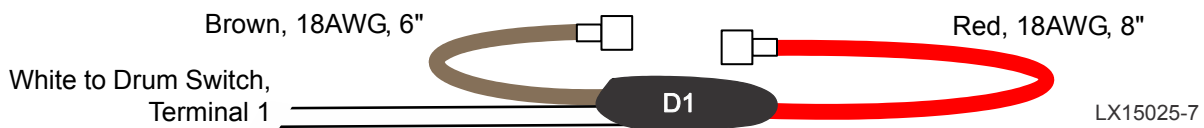

FIGURE 5

5. Disconnect the brown wire coming from the up-limit switch S6 (from outside the control box) at the jumper wire at solenoid SOL4, terminal #1 and reconnect it to the blue pigtail coming off of drum switch 2 terminal #5. (See FIG. 5 and 6.)

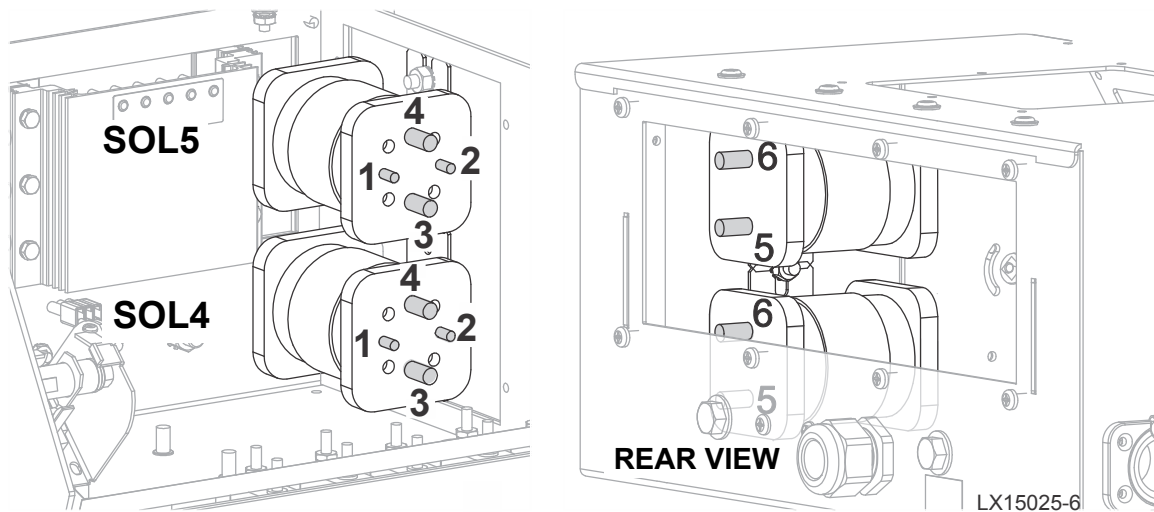

FIGURE 6

6. Connect the diode D1 output (red) wire to the jumper wire at solenoid SOL5, terminal #1. (See FIGs. 4 and 5.)

NOTE: Even though the wires in step 7 and 8 are no longer used, keep them in the control box for reconnection in case of reverting back to manual use.

7. Disconnect the red wire at circuit breaker CB2 coming from the solenoid SOL4 terminal #3. Seal the unused end with part of the neoprene included in the kit. (See FIGs. 4 and 6.)
8. Disconnect the black jumper wire at solenoid SOL4, terminal #5 coming from solenoid SOL5, terminal #5. Loop the wire back to the solenoid SOL4, terminal #5 and reconnect it. (See FIG. 6.)

Mount the encoder

1. Remove the up/dn drive belt cover; discard the cover but retain the hardware (3 flat washers, 3 lock washers, and 3 bolts).
2. Place the shaft extension over the gearbox shaft and tighten with the setscrew. (See FIG. 7.)

- Place the small encoder mounting bracket on the gearbox housing and tighten the screws. (See FIG. 7.)

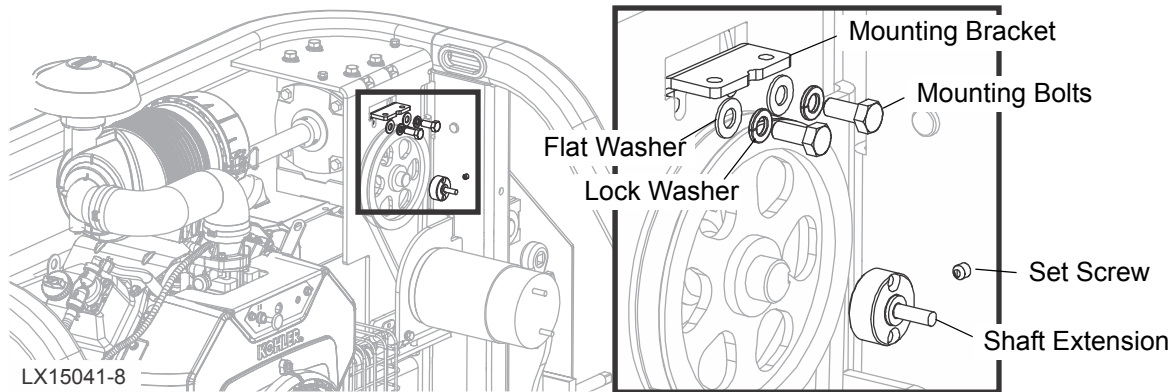

FIGURE 7

- Secure the encoder on the shaft extension. (See FIG. 8.)
- Secure the new drive belt cover with the hardware retained in step 1. (See FIG. 8.)

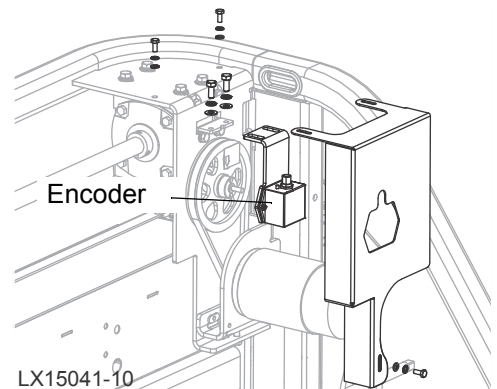

FIGURE 8

The yellow encoder cable is pre-routed from the factory on all LX150 mills.

- Retrieve the yellow encoder cable from the mast. (See FIG. 9.)
- Plug in the keyed connector of the encoder cable to the encoder. (See FIG. 9.)

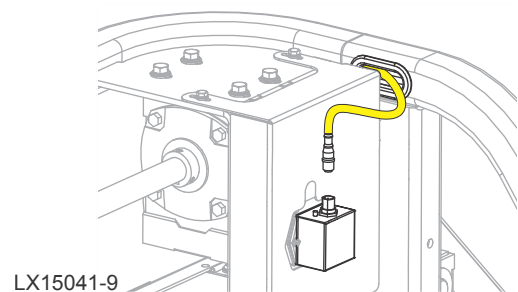

FIGURE 9

Mount Simple Set

- Place the Simple Set control on top of the sawmill control, routing the control wire harness through the hole in the top of the control box. (See FIG. 10.)
- Secure the front of the Simple Set control with the previously removed mounting screws. (See FIG. 10.)

3. Replace the other two front screws to plug the empty holes.
4. Secure the back of the box with two 1/4" slotted hex screws provided.

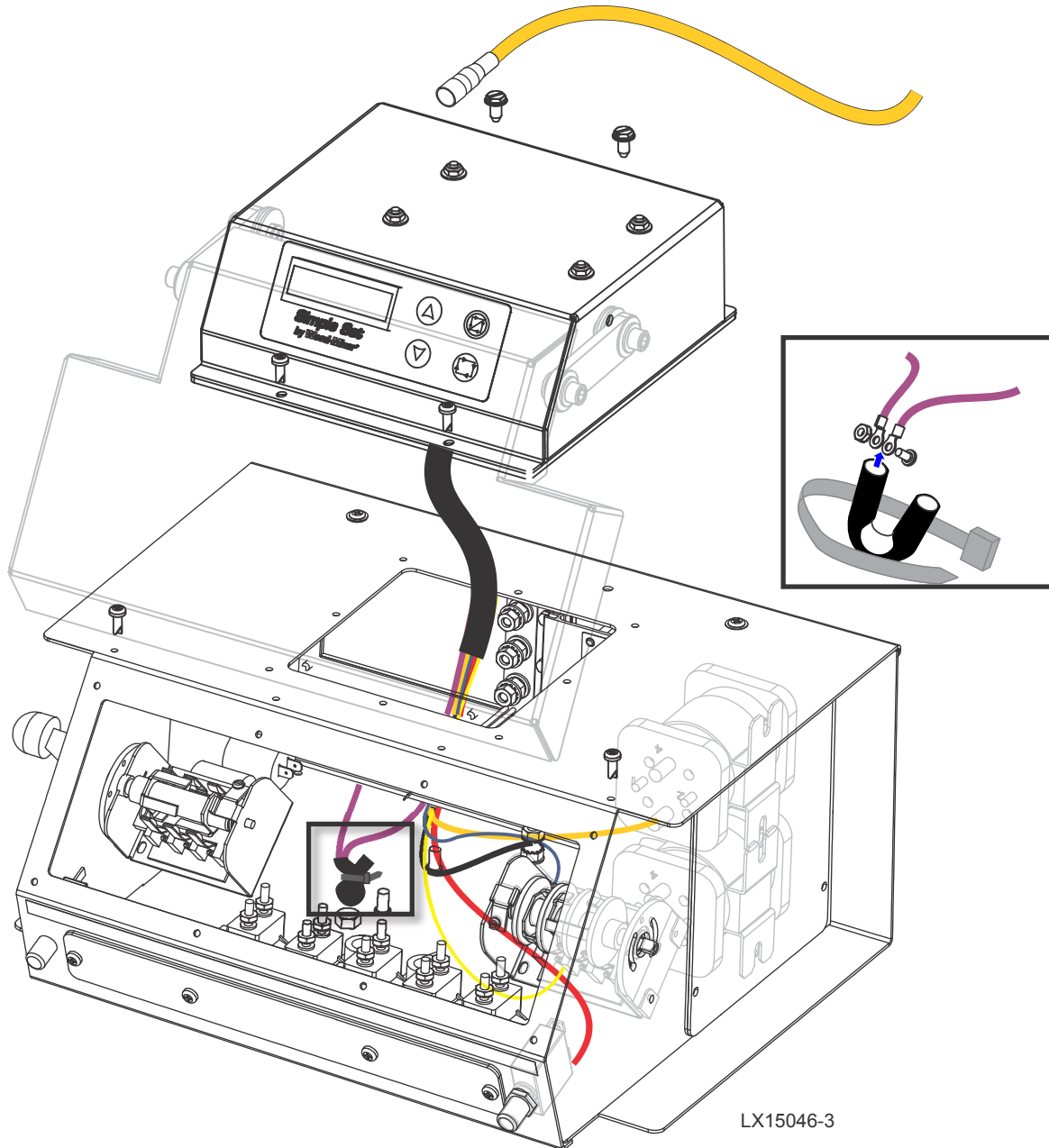

FIGURE 10

5. Disconnect violet motor wire from solenoid SOL5 terminal 6 and yellow motor wire from solenoid SOL4 terminal 6. Refer to FIG. 6 for solenoid terminal locations.

6. Connect the violet motor wire to the violet Simple Set wire using the provided screws and nuts. Refer to the inset on FIG. 10.
7. Wrap the connection with the provided neoprene tubing and secure the tube around the wires with a wire tie. (See FIG. 10.)
8. Connect the yellow motor wire to the solenoid SOL5 terminal 4.
9. Connect the black wire from the Simple Set control to the ground stud located at the bottom-rear of the sawmill control box. (See FIG. 10.)
10. Connect the red Simple Set wire to empty (bottom) terminal of the up/down circuit breaker CB2. (See FIG. 10.)
11. Connect the smaller (20 ga) yellow Simple Set wire to drum switch S2, terminal #4. (See FIG. 10.)
12. Connect the blue Simple Set wire to drum switch S2, terminal #5. (See FIG. 10.)
13. Keep all other existing wires connected.
14. Reinstall the up/down drum switch S2 handle and mounting hardware.
15. Replace the control box front panel.
16. Locate the yellow encoder under the control box mount, and plug the keyed cable connector into the port in the back of the Simple Set control box.
17. Reconnect the negative battery terminal cable and replace the battery box cover.

APPENDIX A - BEFORE INSTALLATION

Without SimpleSet Option

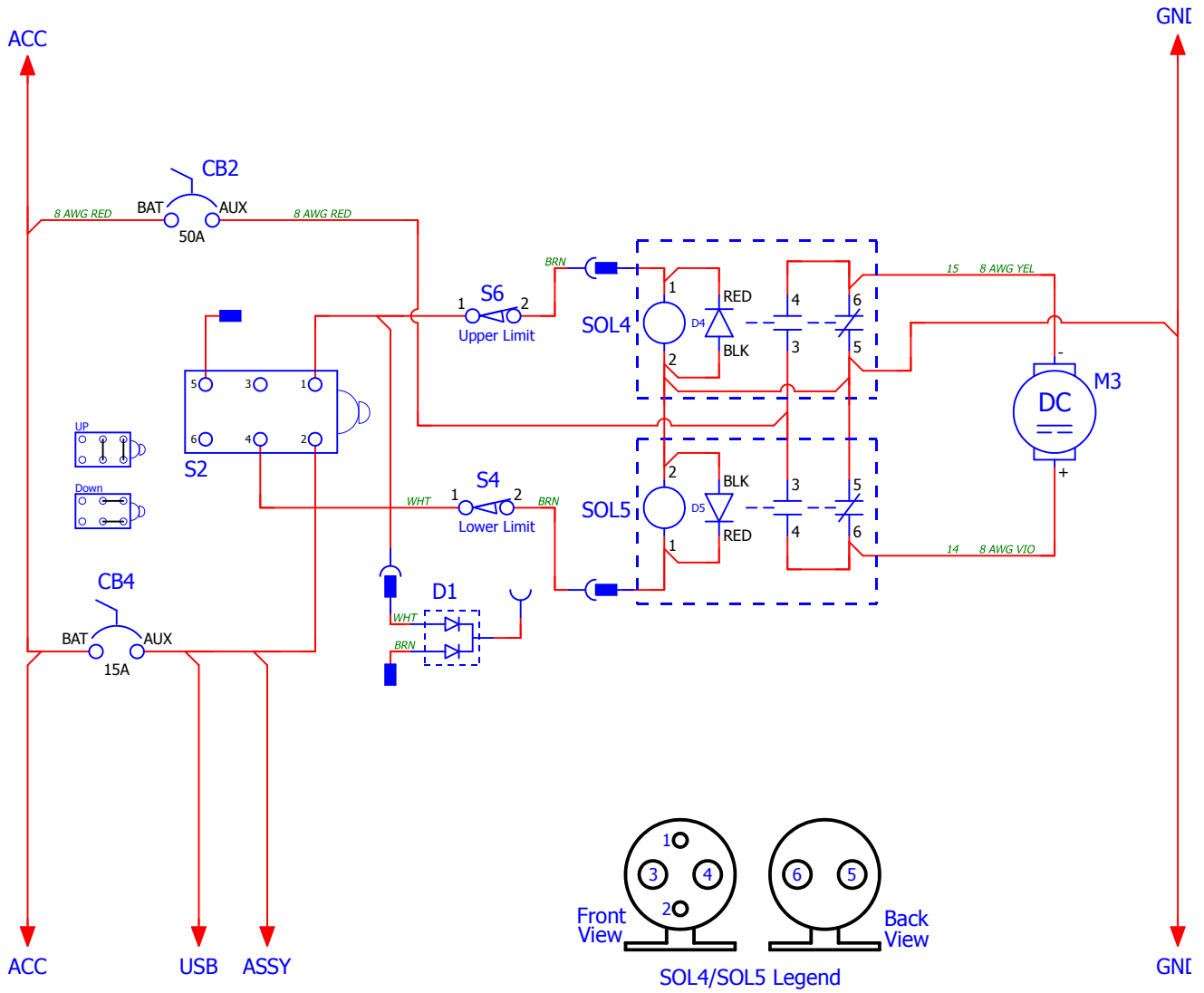

APPENDIX B -- AFTER INSTALLATION

Equipped with SimpleSet

