

FORM 2072 WM4000 LOG LOADER HYDRAULIC STOP INSTALLATION

The enclosed parts include mounting hardware necessary to install the log loader hydraulic stop kit to the WM4000 sawmill Rev. A1.00 and later.

Part No. 074672

ITEM	DESCRIPTION	PART NO.	QTY
1	Stop Kit, WM4000 Log Loader Hydraulic	074672	1
2	Clamp Weldment, Top	075780	2
3	Arm, Log Loader Extension	074659	2
4	Hose Kit, WM4000 Pop Up Stop Hydraulic	074673	1
5	Tee Assembly, Pop Up Stop Hose	074679	2
6	Mount Assembly, Selector Valve/Control	074668	1
7	Nut, 3/4-10 Nylon Lock	F05010-103	6
8	Bolt, 3/4-10 x 2 1/2" Hex Head Grade 5	F05009-44	6
9	Washer, 3/4" SAE Flat	F05011-62	6
10	Bolt, 1/2" x 5-1/2" Concrete Wedge Anchor	F05008-131	8
11	Instruction Sheet, WM400 Log Loader Hydraulic Stop	074672-2072	1

Installation Instructions



WARNING! Before performing service near moving parts such as blades, pulleys, motors, belts and chains, first turn the machine off and perform the lockout procedure. If the machine is turned on and moving parts activated, serious injury may result.

1. Install the two provided pop up stop assemblies to the sawmill bed as shown below.

See Figure 1.

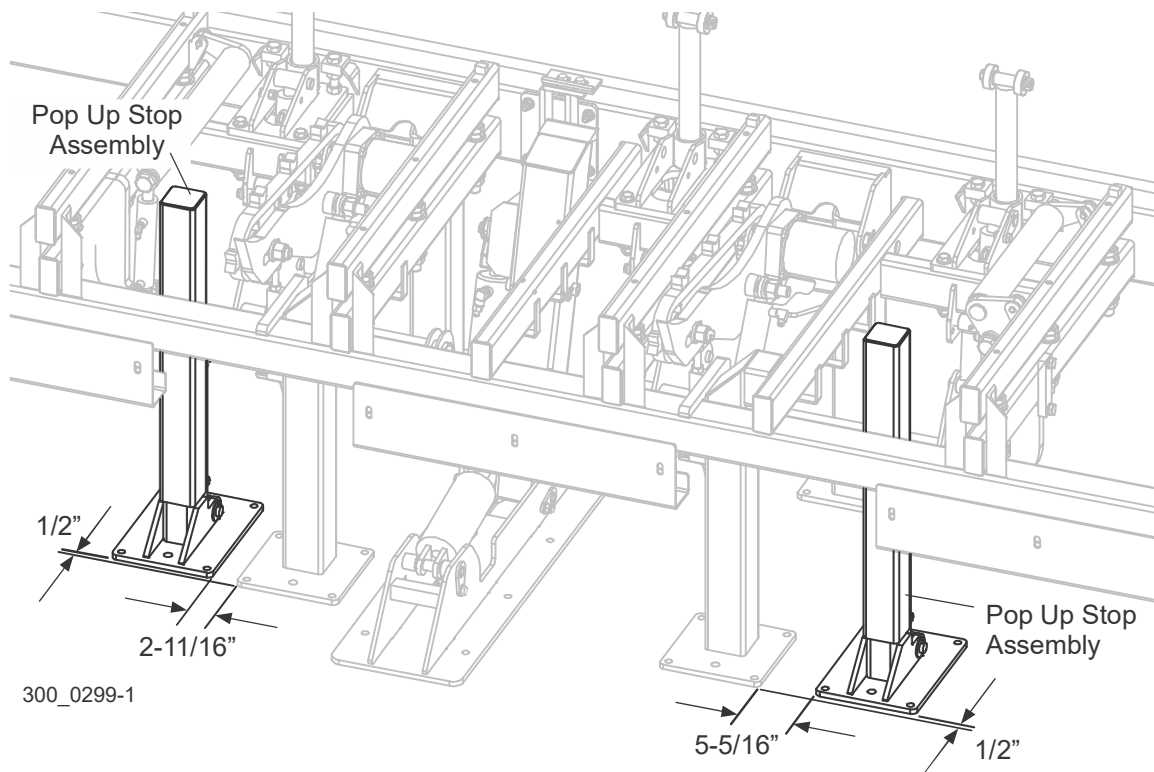

FIG. 1

2. Install the provided selector valve/control mount assembly to the frame of the operator station. Use the existing fasteners to secure the mount assembly to the frame.

See Figure 2.

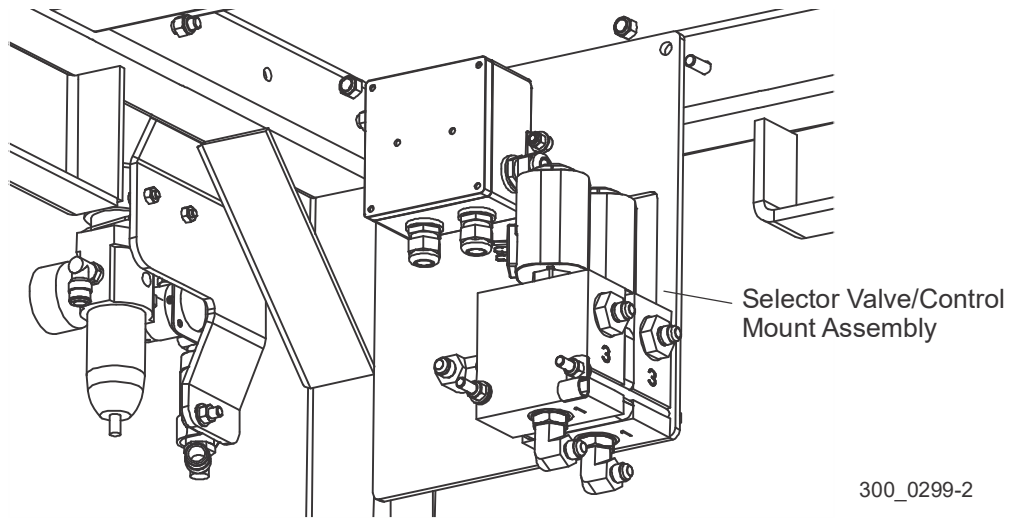

FIG. 2

3. Place the log deck on the right side of the sawmill bed as shown below.

See Figure 3.

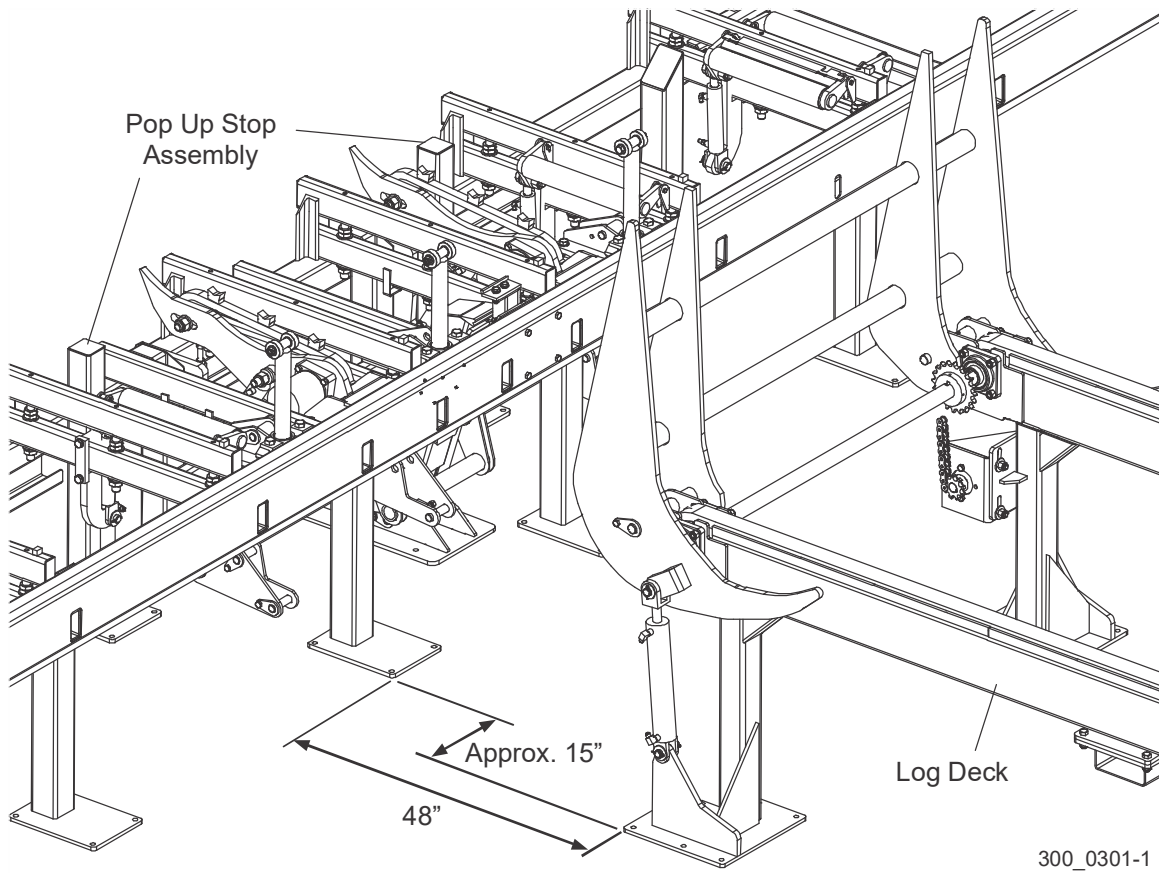

FIG. 3

4. Lower the log deck arms and use the log loader arm extension arms as template to drill three holes. **IMPORTANT!** Make sure the extension arms rest on the bed tube and do not contact the bed main rail.

See Figure 4.

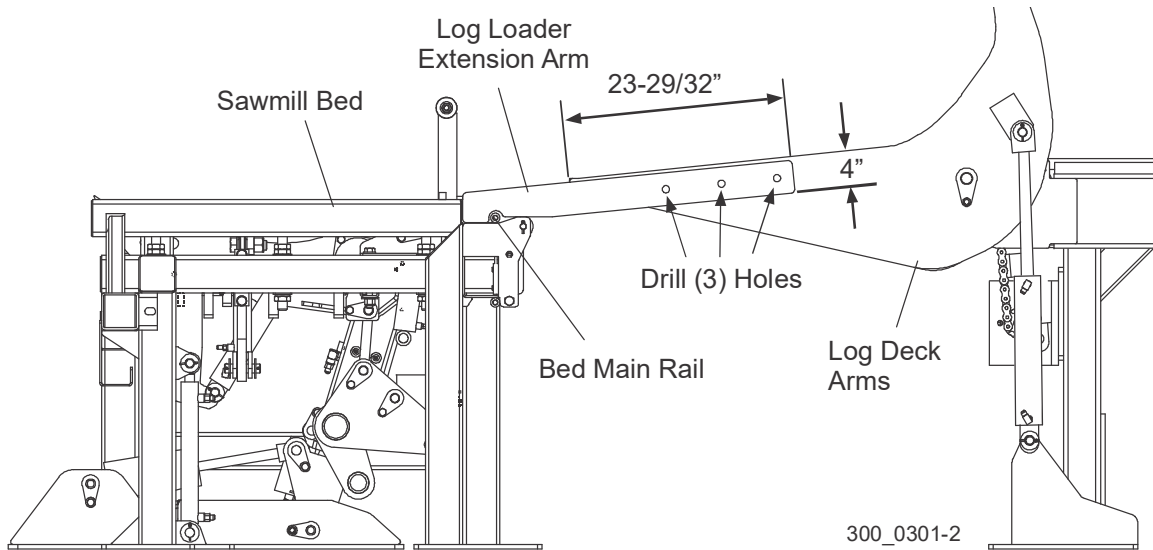

FIG. 4

5. Install the log loader extension arms to the log loader arms using the provided fasteners.

See Figure 5.

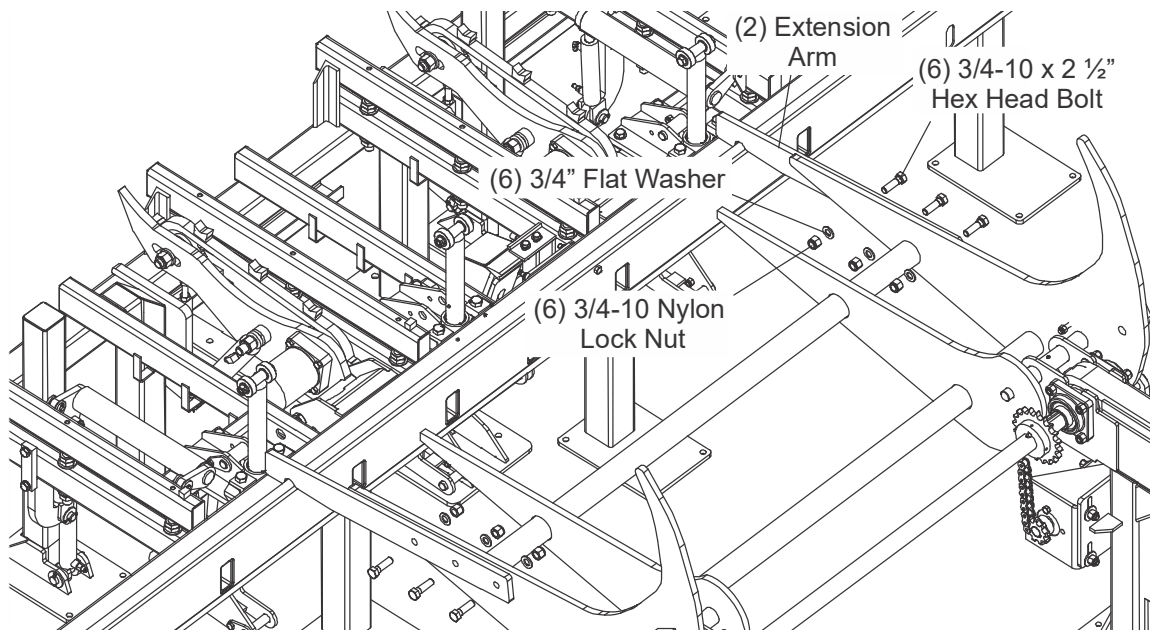

FIG. 5

6. Connect the provided hydraulic hoses as shown below.

See Figure 6.

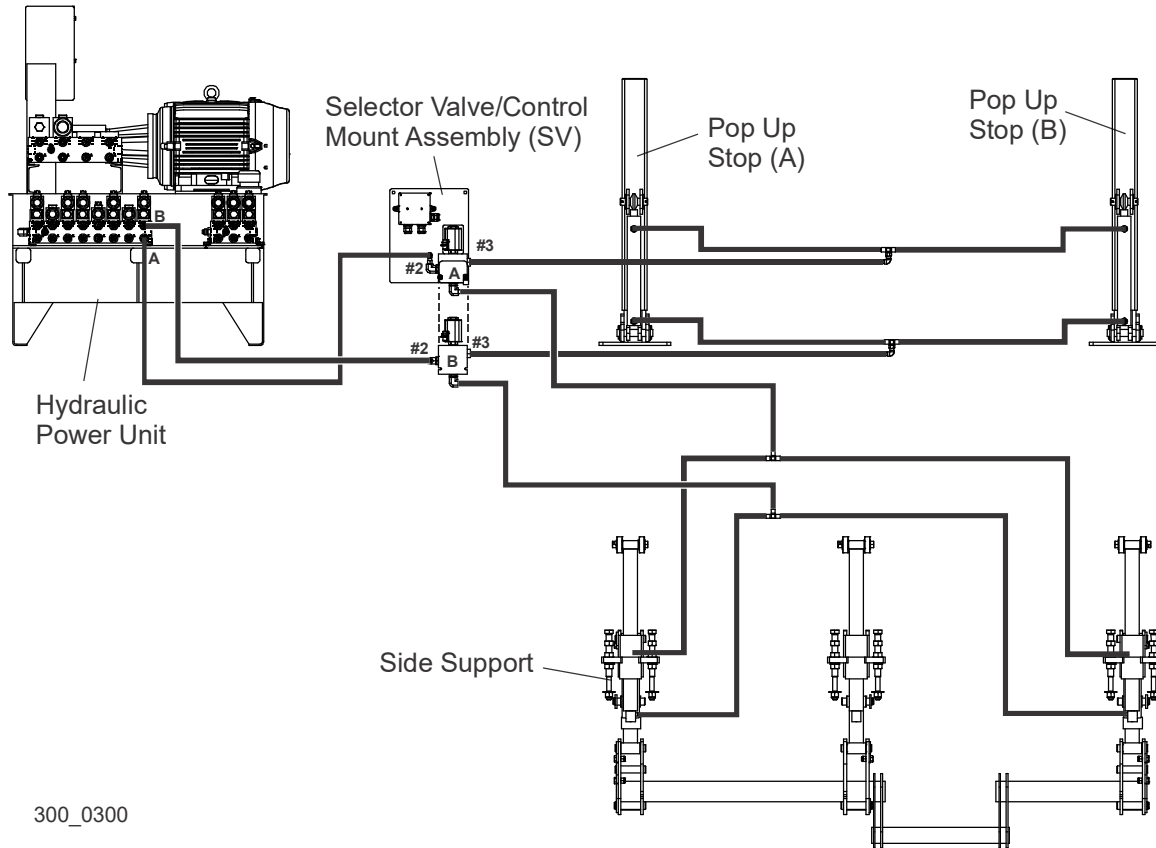

FIG. 6

WM4000 Pop Up Stop Hose Lengths

ID	COLOR CODE	LENGTH	APPLICATION	PART #
	Black	48"	3/8" Side Support Valve A to SV A Port #2	042828
	Purple	48"	3/8" Side Support Valve B to SV B Port #2	
	Black	224"	3/8" SV A Port #3 To Pop Up Stop T	
	Purple	224"	3/8" SV B Port #3 To Pop Up Stop T	
	Black	48"	3/8" Pop Up Stop T To Cylinder A Top	
	Black	48"	3/8" Pop Up Stop T To Cylinder B Top	
	Purple	48"	3/8" Pop Up Stop T To Cylinder A Bottom	
	Purple	48"	3/8" Pop Up Stop T To Cylinder B Bottom	

TABLE 6-1

Electrical Installation Instructions



WARNING! Before performing service near moving parts such as blades, pulleys, motors, belts and chains, first turn the machine off and perform the lockout procedure. If the machine is turned on and moving parts activated, serious injury may result.

1. Open the selector valve/control mount box and disconnect the foot pedal cable (if necessary). **IMPORTANT:** Note the cable wire connections and terminals to be able to reconnect them later. Place the foot pedal on the floor inside the operation station and use one of the holes in the floor to route the foot pedal cable back to the selector valve/control mount box. Reconnect the foot pedal cable wires to the terminals inside the selector valve/control mount box and close the box.
2. Route the cable from the selector valve/control mount box under the operator station to the operator junction control box next to the operator station door.

See Figure 7.

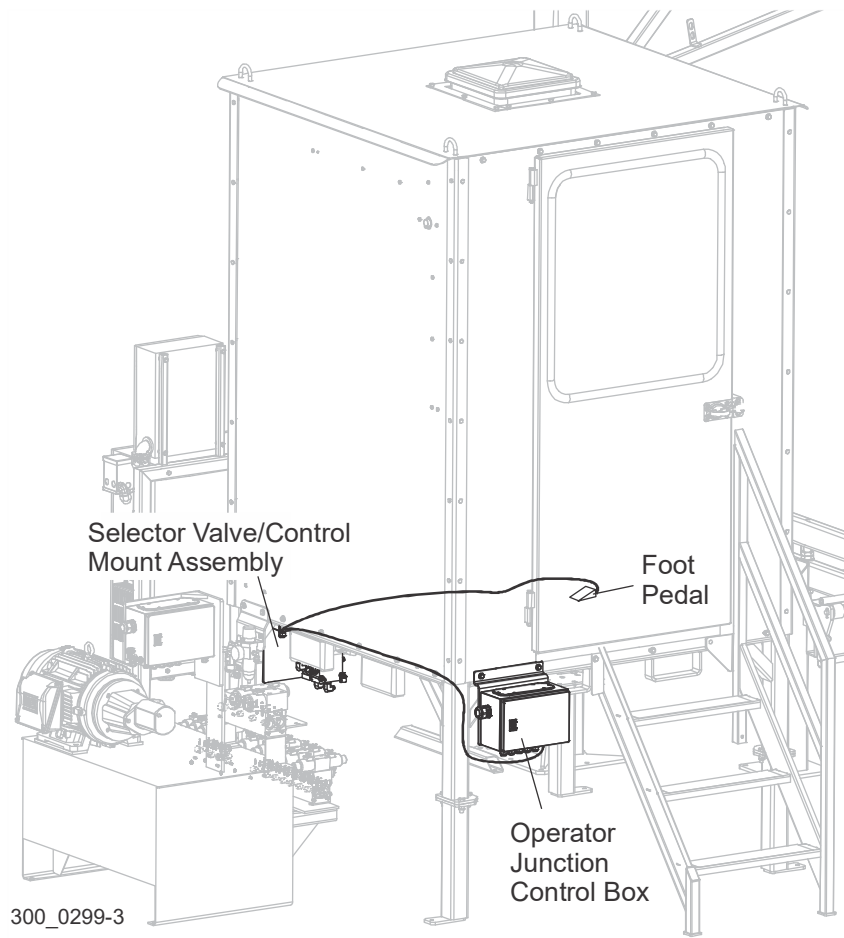

FIG. 7

3. Open the operator junction control box and connect the cable wires. At block X5, connect the black wire to terminal 32.2 (Level 1), connect the white wire to terminal 31.2 (Level1) and connect the green wire to terminal 31.2 (Level 2).

See Figure 8.

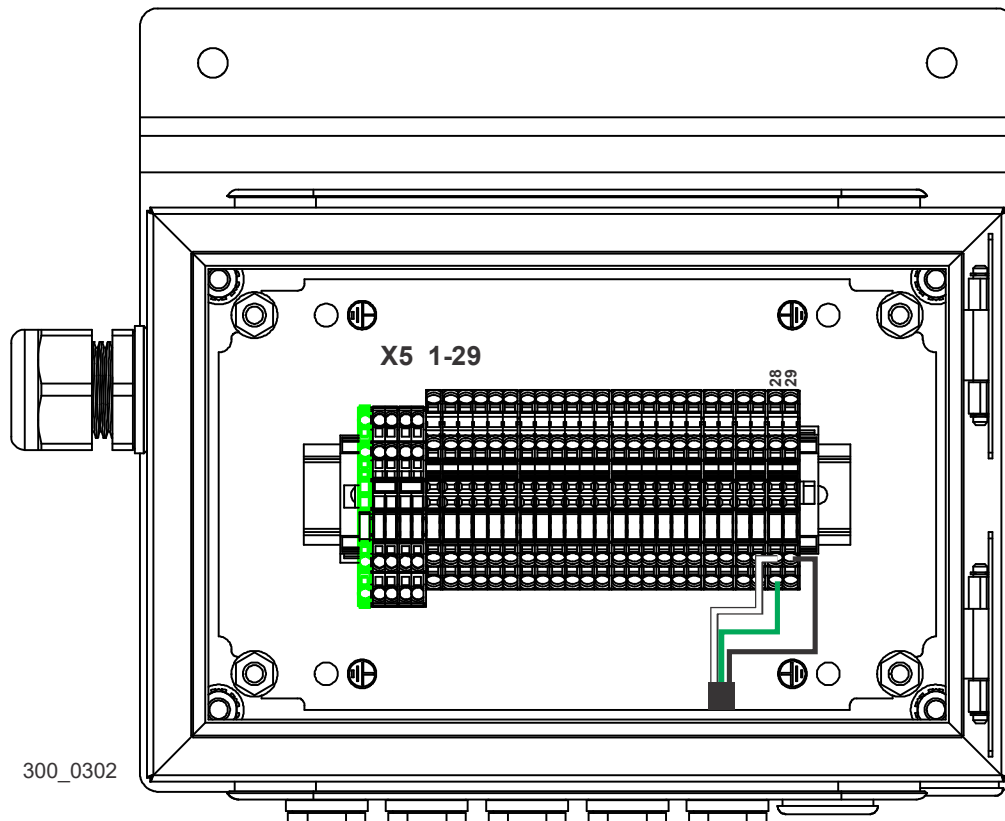

FIG. 8

4. Close the operator junction control box.
5. Secure the cables to the operator station frame.

Pop Up Stops Operation

To operate the pop up stops, press the additional foot pedal. This activates the diverter valves and diverts the flow from the original side supports to the secondary set on the loading side of the mill. Use the joystick control for the pop up stops the same way as the original side supports. **NOTE:** Always use the foot pedal to change which set of the side supports to operate.

See Figure 8-1. In BED mode, press the additional foot pedal and push the right joystick forward to lower the pop up stops. The further the joystick is pushed, the faster the pop up stops move down. Pull the joystick backward to raise the pop up stops.

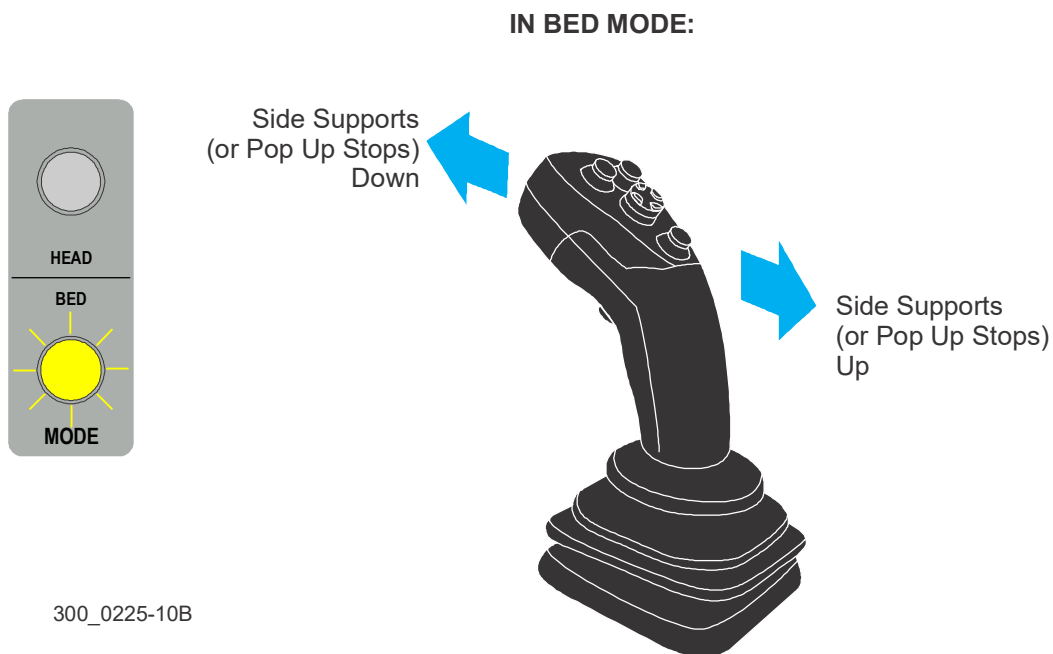
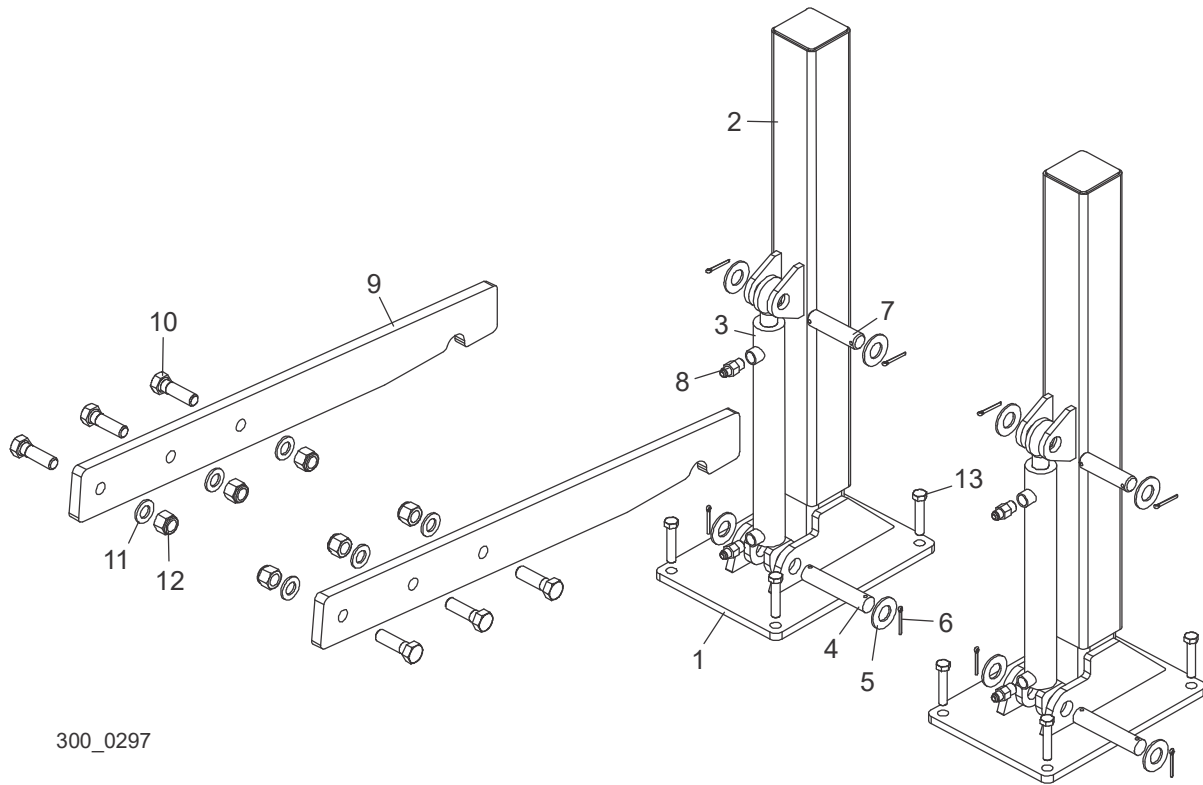

FIG. 8-1

Pop Up Stop & Log Loader Extension Replacement Parts



300_0297

REF	DESCRIPTION (◆ Indicates Parts Available In Assemblies Only)	PART #	QTY.
	STOP ASSEMBLY, POP UP	075780	2
1	Tube Weldment, Stop Lower	074654	1
2	Tube Weldment, Stop Top	074655	1
3	Cylinder, 1 1/2x12 Hydraulic	075728	1
4	Pin, 1x5	074661	1
5	Washer, 1 ID SAE Flat	F05011-28	4
6	Pin, 3/16x1 1/2 Cotter	F05012-23	4
7	Pin, 1x3.88	S09251	1
8	Fitting, 3/8NPT-3/8JIC Male Connector	016819	2
	Fitting, 3/8JIC Cap	016816	4
9	ARM, LOG LOADER EXTENSION	074659	2
10	BOLT, 3/4-10 X 2 1/2" HEX HEAD GRADE 5	F05009-44	6
11	WASHER, 3/4" SAE FLAT	F05011-62	6
12	NUT, 3/4-10 NYLON LOCK	F05010-10	6
13	BOLT, 1/2 X 5-1/2" CONCRETE WEDGE ANCHOR	F05008-13	8

Selector Valve/Control Mount & Hose Tee Replacement Parts

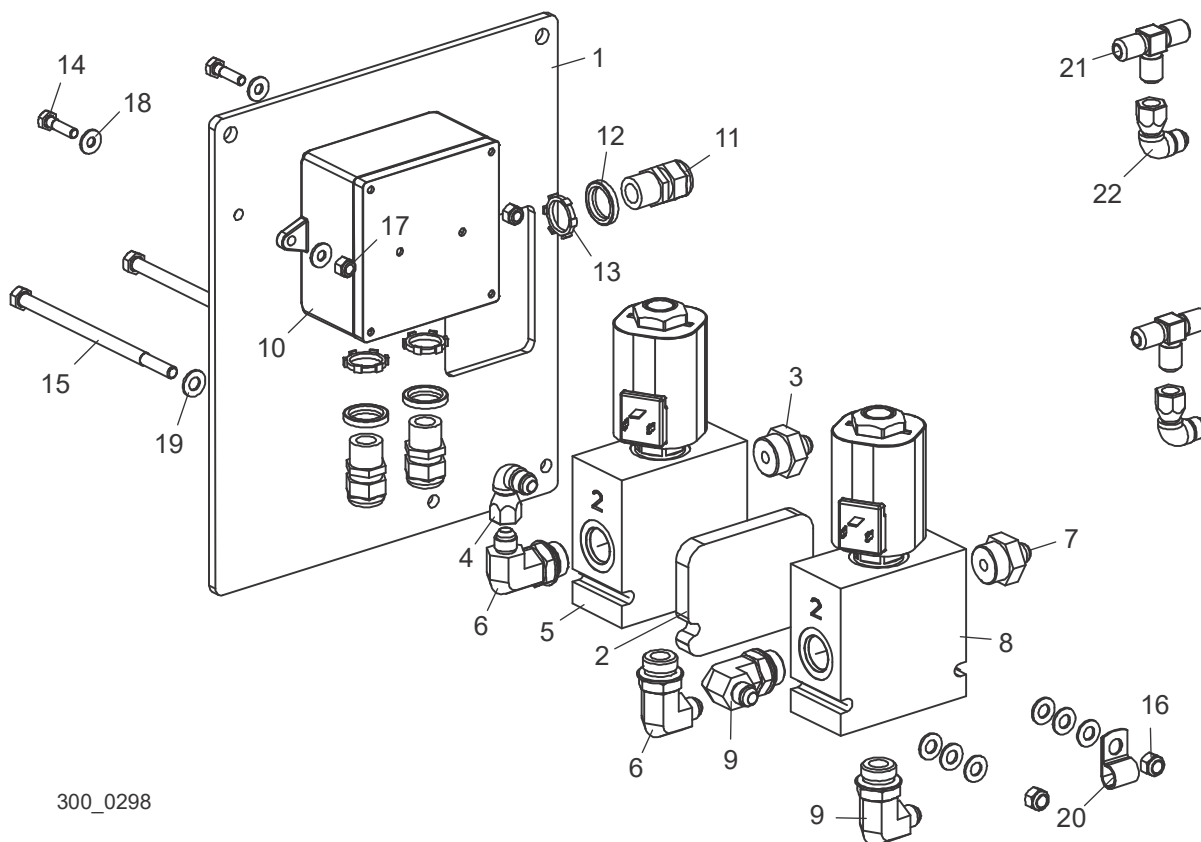

300_0298

REF	DESCRIPTION	PART #	QTY
	MOUNT ASSEMBLY, SELECTOR VALVE/CONTROL	074668	1
1	Plate, Selector Valve Mount	074667	1
2	Plate, Selector Valve Spacer	074669	1
	Valve Assembly, Pop Up Stop Selector Valve A	074680	1
3	Fitting, #10SAE-3/8JIC Straight	017640	1
4	Fitting, 3/8JIC Swivel Nut 90 Elbow	042756	1
5	Valve, 3-Way Selector	074286	1
6	Fitting, 10SAE-6JIC 90° Elbow	074303	2
	Valve Assembly, Pop Up Stop Selector Valve B	074681	1
7	Fitting, #10SAE-3/8JIC Straight	017640	1
8	Valve, 3-Way Selector	074286	1
9	Fitting, 10SAE-6JIC 90° Elbow	074303	2
	Control Assembly, Ind. Mill Sec. Side Support	078051	1
10	Enclosure, Ind. Edger Laser Interface	051309	1
11	Connector, 1/2" NPT .17-.47	051299	3
12	Ring, 1/2" Sealing	E20460	3
13	Nut, 1/2" NPT Connector Lock	E20461	3
14	Bolt, 1/4-20 x 1" Hex Head Grade 5	F05005-101	2

REF	DESCRIPTION	PART #	QTY
15	Bolt, 5/16-18 x 6" Hex Head Grade 5	F05006-73	2
16	Nut, 5/16-18 Nylok Hex	F05010-58	2
17	Nut, 1/4-20 Nylock	F05010-69	2
18	Washer, 1/4" SAE Flat	F05011-11	4
19	Washer, 5/16" SAE Flat	F05011-17	8
20	Clamp, 1/2" EMT Coated	P07584	1
	TEE ASSEMBLY, POP UP STOP HOSE	074679	2
21	Fitting, 3/8" JIC Tee	015487	1
22	Fitting, 3/8" JIC Swivel Nut 90 Elbow	042756	1