

# FORM 1495

## ACCUSET 2 RETROFIT INSTRUCTIONS

### Part No. 069655

The enclosed parts can be retrofitted to LT30, LT40, LT50, LT60 & LT70 non-remote DC sawmills equipped with Accuset. The new Accuset 2 system will provide improved reliability and functionality.

### Installation Instructions

1. Use the sawmill controls to move the saw carriage so the hydraulic power strip (if applicable) is not engaged and the saw head is positioned so the blade height scale indicates 12".
2. Turn the key switch to the OFF (#0) position and remove the key.
3. Remove the battery box cover and disconnect the negative battery terminal.



**WARNING!** Disconnect the negative battery terminal cable before performing any service to the 12-volt electrical system. Failure to do so may cause injury or electrical system damage.



**CAUTION!** Loose battery and/or fuse terminal connections may cause damage to Accuset 2 electrical components. Prior to installation, check all connections are clean and tight.

**See Figure 1.** Before removing any panel from the control box, disconnect the cable from the negative battery terminal.

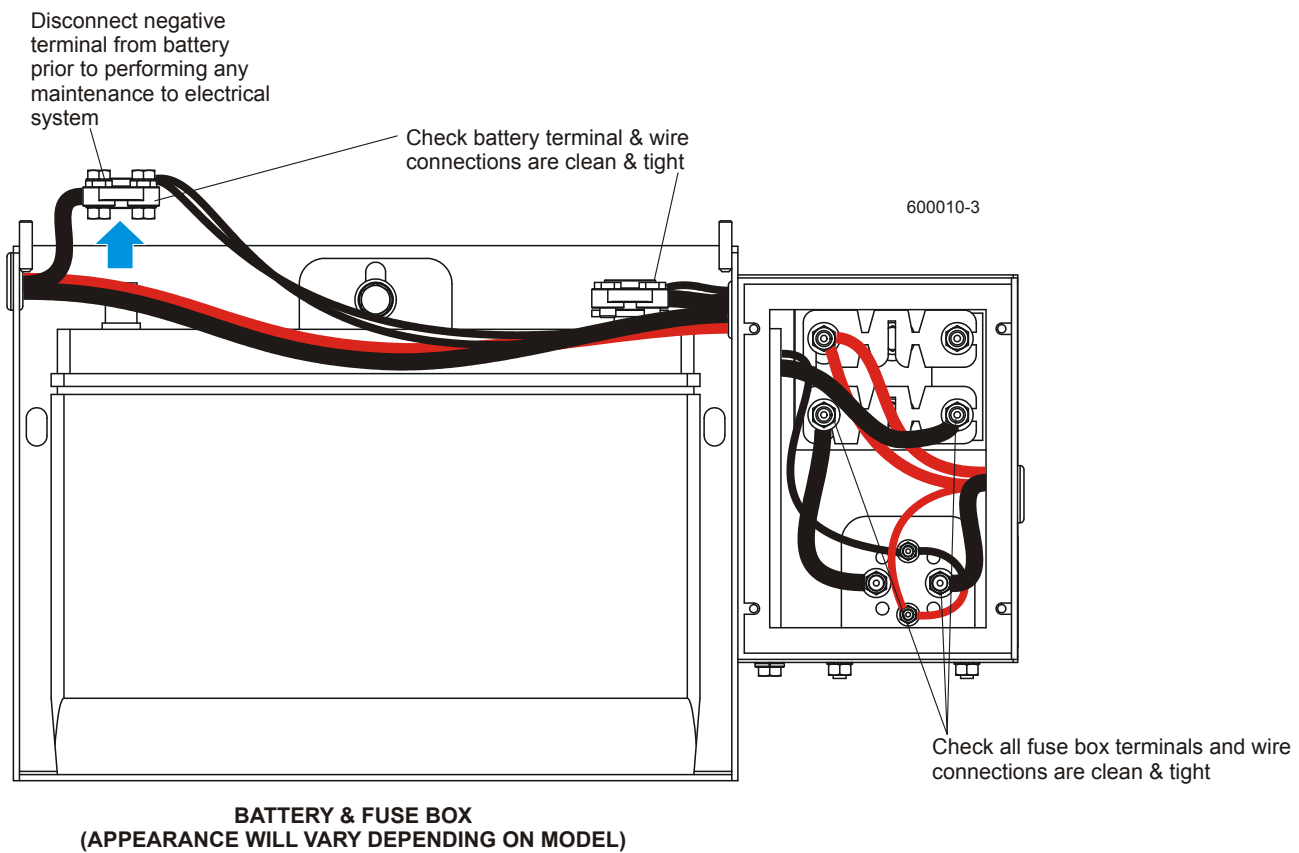

**FIGURE 1**

4. Remove the fuse box cover. Inspect all connections inside the battery and fuse boxes. Be sure all surfaces are clean and connections are tight.

**NOTE:** Any loose fuse connections may cause the mounting hardware to burnish (discolor). If this condition exists, an adequate electrical connection will be difficult to achieve and the fuse block assembly should be replaced.

5. Replace the fuse box cover.

See Figure 2.

6. At the operator control box, use a Phillips screw driver to remove the rear and front control box panels.
7. Disconnect the transducer cable from the back of the Accuset control box
8. Use a 5/16" socket wrench to loosen the four Accuset control box hold-down bar bolts. Use a Phillips screwdriver to remove the four screws at the front of the Accuset control box.

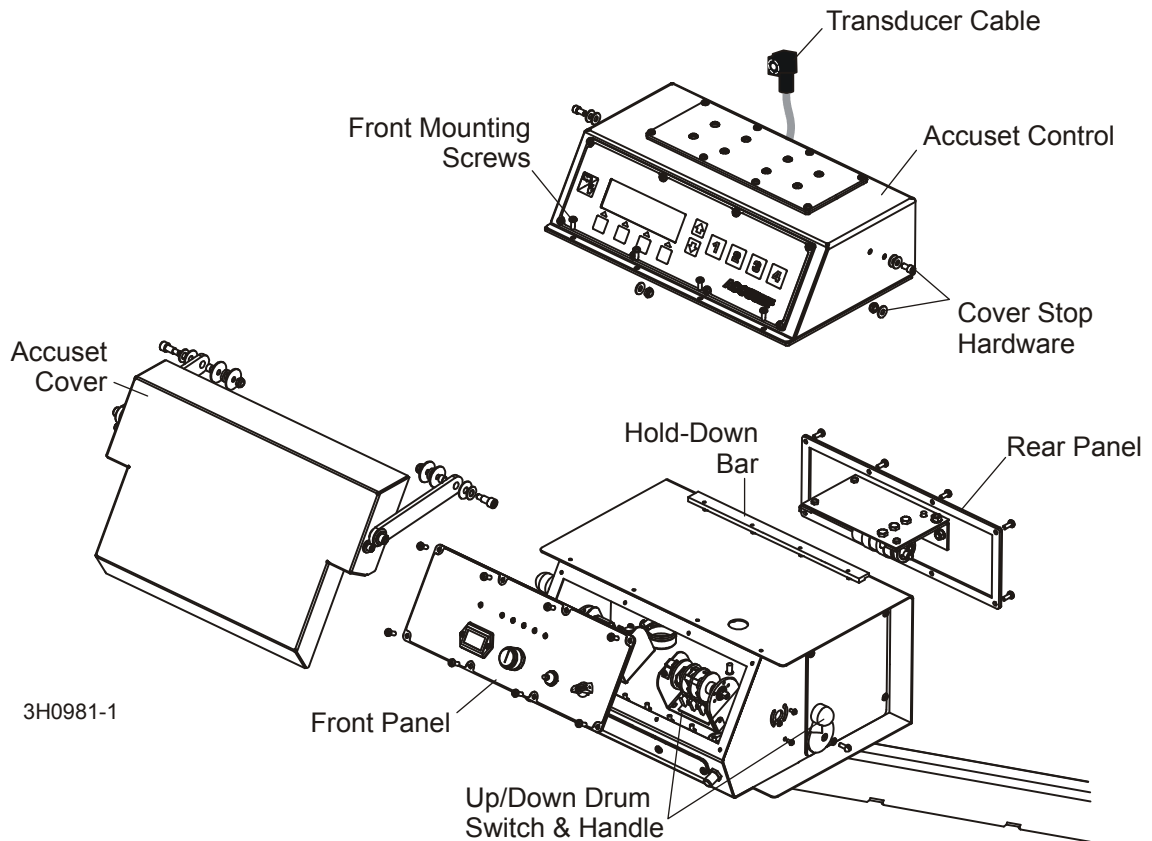
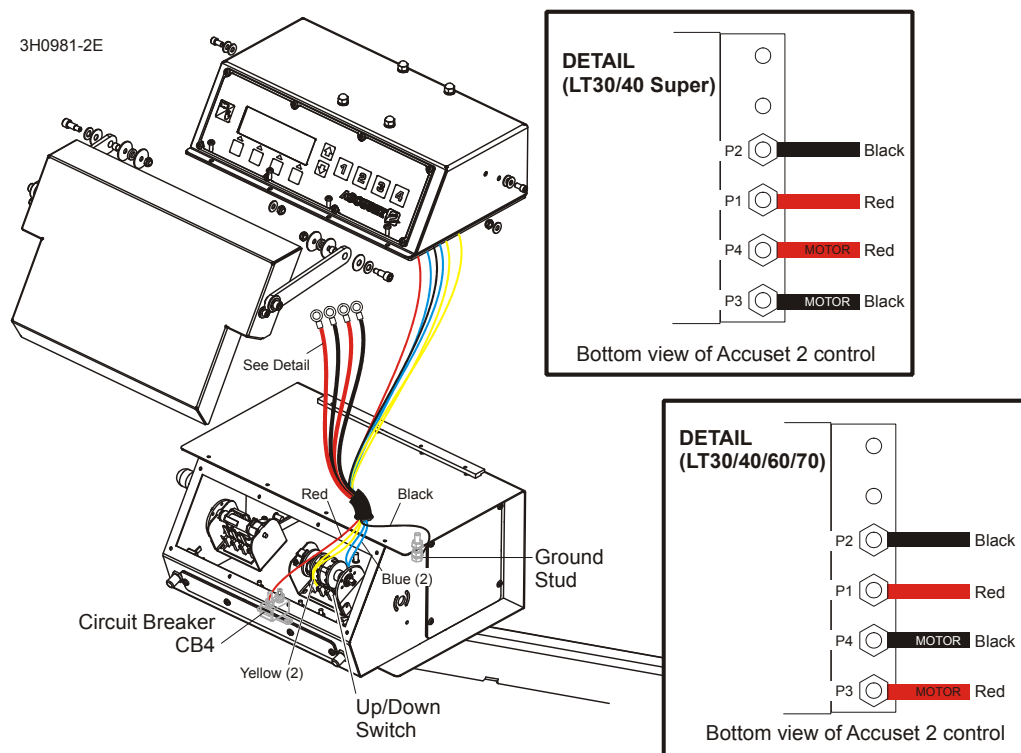

FIGURE 2

9. Lift the Accuset control box from the sawmill control and disconnect the two black and two red wires from the sawmill control connected to the Accuset panel 12V, MTRR, GND and MTRL terminals.
10. Locate the red wire from the Accuset panel connected to the ACC key switch terminal and disconnect from the key switch.
11. Disassemble the up/down drum switch handle and mounting screws. Locate the black and red wires from the Accuset panel connected to the up/down drum switch and disconnect from the drum switch (leave all other wires connected to the drum switch).

12. Cut wire ties around the Accuset harness and pull the three disconnected wires up and out of the sawmill control. Set the Accuset control aside.
  13. Use a 5/32" hex wrench to loosen the two screws securing the cover to the Accuset control box. Use a 3/16" hex wrench to loosen the two cover stop screws. Remove all cover and stop screw hardware and install to the new Accuset 2 control box.
- See Figure 3.**
14. Position the Accuset 2 control box on top of the sawmill control and route the black, red, blue and yellow Accuset harness wires through the conduit into the sawmill control box. Be sure all wires are contained inside the conduit. If the existing conduit is too small, replace it with the supplied 6" piece of conduit.
  15. Connect the red Accuset harness wire to the front terminal of the Accessory circuit breaker (CB4).
  16. Connect the black Accuset harness wire to the ground stud at the rear (on Standard models) or side (on Super models) of the control box and secure with the 1/4-20 self-locking hex nut supplied.
  17. Connect the two yellow Accuset wires to terminal #4 of the drum switch (leave any existing wires connected). Connect the blue Accuset wires to terminal #1 (leave any existing wires connected).
  18. Connect the four wires from the sawmill control to the Accuset control circuit board as shown.



**FIGURE 3**

- 19.** Use two of the supplied wire ties to secure the conduit around all wires.
- 20.** Secure the Accuset 2 control box to the top of the sawmill control, positioning the rear lip under the hold-down bar. Tighten the four hold-down bolts and secure the front of the Accuset 2 control with the four #10 screws provided.
- 21.** Reinstall the up/down drum switch and handle to the side of the control box. Replace the front and rear control box panels.
- 22.** Connect the supplied transducer cable to the connector on the back of the Accuset 2 control.
- 23.** Follow the path of the existing transducer cable to route the new transducer cable, removing the wire ties and the old cable as you go. Disconnect the old cable from the transducer sensor and connect the new cable.
- 24.** Secure the transducer cable to the control pedestal with the provided wire ties.
- 25.** Recheck that all connections are tight & secure.
- 26.** Reconnect the negative battery terminal cable and replace the battery box lid.
- 27.** See the Setup section of the provided manual to calibrate your new Accuset 2 control.