

Wood-Mizer[®]

from forest to final form[®]

OPERATING INSTRUCTIONS

**MES203EA3U-S (FM300S)
3HP DUST COLLECTOR
WITH TWO COTTON FILTER BAGS
3880 m³/h, 1PH x 120 V, 60 Hz**



Please keep this instruction manual for future reference.

CONTENTS

TECHNICAL DATA.....	3
UNPACKING AND CHECKING CONTENTS.....	4
ASSEMBLY.....	5
SAFETY RULES.....	7
WIRING DIAGRAM.....	9
PARTS DIAGRAM.....	10
PARTS LIST.....	11
CERTIFICATE.....	12

TECHNICAL DATA

Motor power	2200 Watt
Motor speed	3450 rpm (60Hz)
Power supply	1x 120 V, 60 Hz, 19.5A
Inlet diameter	150 mm
Number and diameter of intake holes	2x 100 mm
Filter bag size diameter X height	500 mm x 850 mm
Collection bag size diameter X height	500 mm x 850 mm
Filter bag area	1,6507 x2 m ²
Pressure Drop	2.7 kPa
Maximum Capacity	3905 m ² /h
Noise	87,1 dB LpA
Fan diameter	305 mm
Bag capacity	0.307 m ³
Overall size (LxWxH)	1450 mm x 800 mm x 2000 mm
Packing size (mm)	1170x560x570
Weight net/gross	48/50 kg

READ THIS MANUAL CAREFULLY BEFORE ASSEMBLY, TESTING AND OPERATING.

WARNING: DO NOT OPERATE THIS UNIT UNTIL THE PVC HOSE IS INSTALLED ONTO THE DUST INLET PORT.

UNPACKING AND CHECKING CONTENTS

Unpack carton, check machine, to see parts listed below:

- A. CONNECTOR
- B. COLLECTOR BODY & FAN/MOTOR ASSEMBLY
- C. TWO COLLECTOR
- D. BASE PLATE
- E. TWO UPPER BAG SUPPORT
- F. TWO SUPPORT
- G. INLET
- H. FOUR BAGS
- I. PACKING
- J. FOUR CASTERS
- K. NUTS, SCREWS, WASHERS, SPRING WASHERS
- L. MOTOR BASE
- O. BAG CLAMP

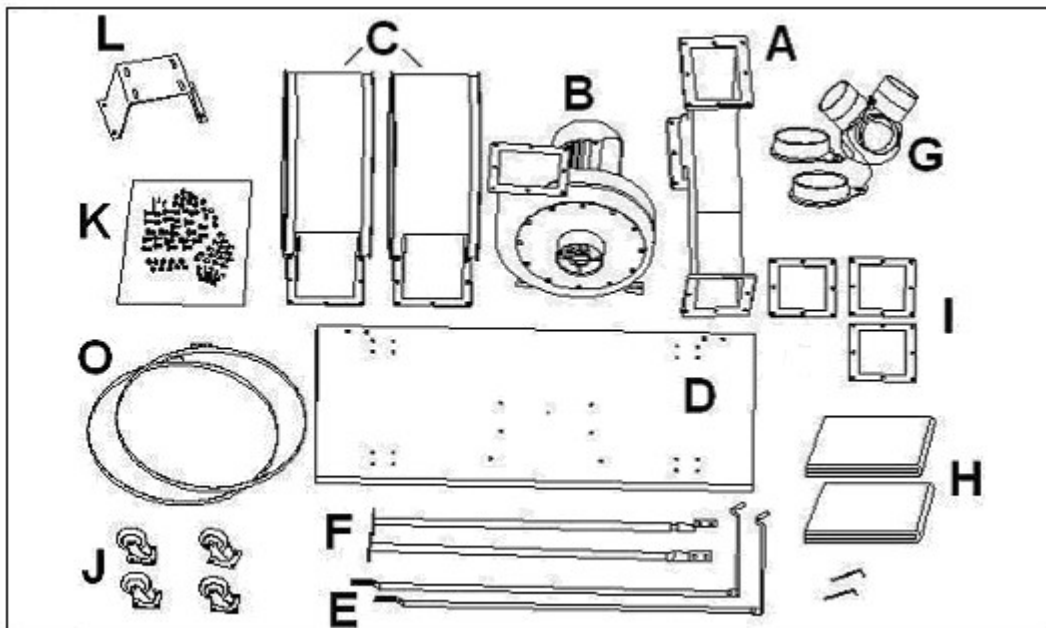

ASSEMBLY

To assemble, first place the base plate upside down and attach the four casters to the holes provided and tighten with wrench. Fig 1

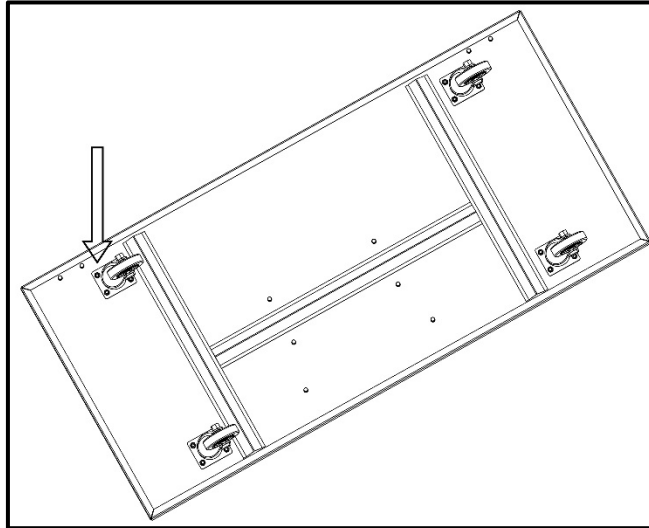

Fig 1

With the motor base, collector body & fan/motor assembly in place, secure it to the base plate using the screw and washers provided as shown in Fig 2.

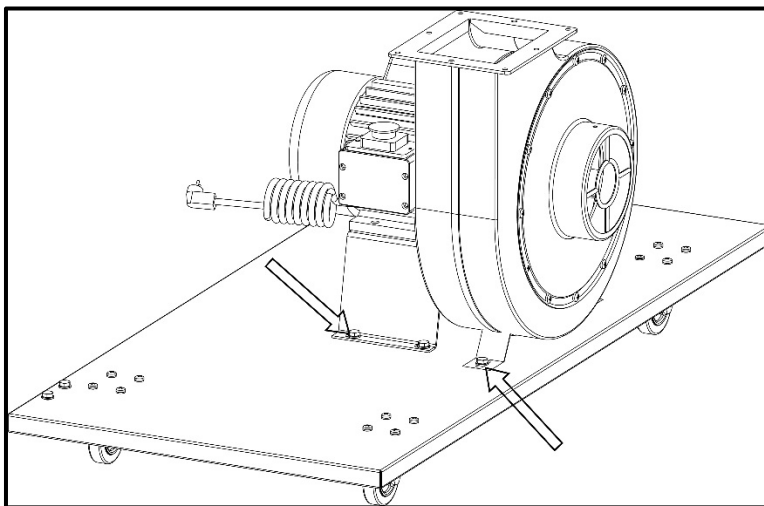

Fig 2

Install the packing and square connecting tube, connector to the collector body assembly using screw and washers provided. Fig 3 & Fig 4.

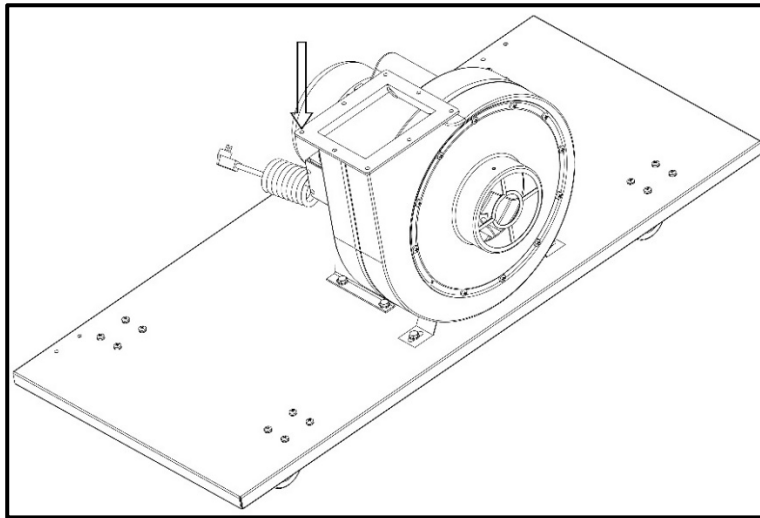

Fig 3

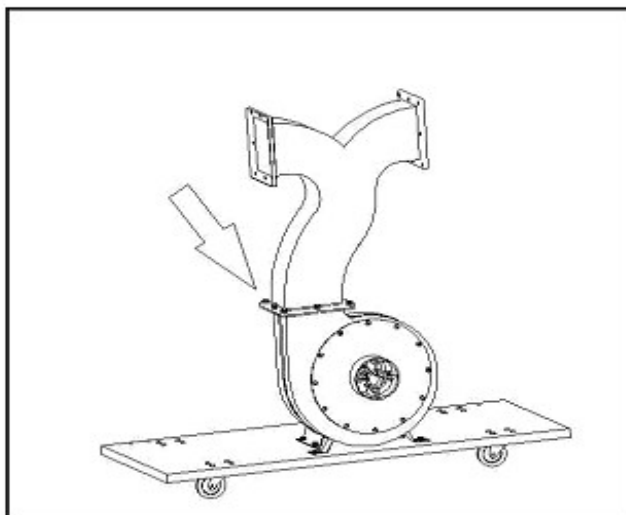

Fig 4

Next install the two collectors (C) two packing (I) to the outlet as shown in Fig5.

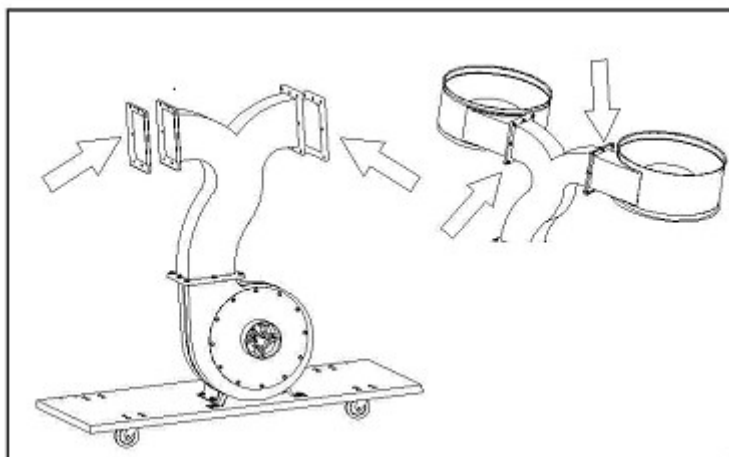

Fig5

Install the two collector supports (F) and two upper bag support (E) as shown in Fig 6.

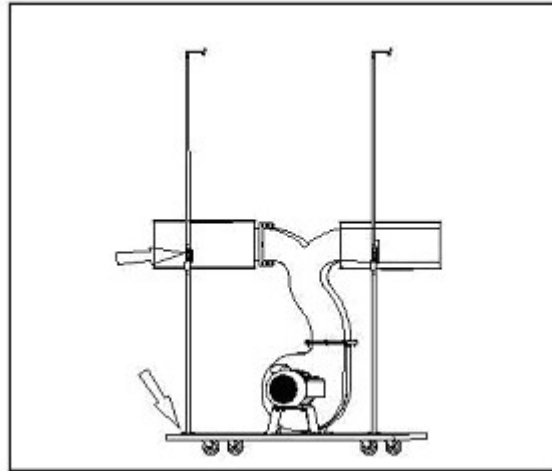

Fig 6

Next, hang the two bags (H) from the support rods. Then attach the two filter bags and two collection bags to the collectors using bag clamp.

The inlet can now be placed on the intake hole of the fan/motor assembly as shown Fig 7.

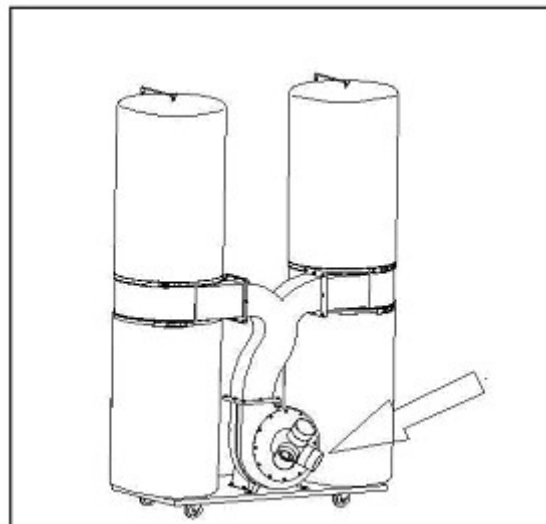

Fig 7

The dust collector is now ready to be placed into service. Before connecting to a power source, be sure the power source is properly grounded and is of proper voltage and amperage.

SAFETY RULES

1. Read and become familiar with the entire operating manual.
2. Keep guards and cover in place and in working order.
3. Wear eye protection at all times. Use safety glasses with side shields or safety goggles, meeting the national safety standards, while operating this machine.
4. Keep work area clean and well lighted. Clutter and inadequate lighting invite potential hazards.
5. Ground all tools. If a machine is equipped with a three-prong plug, it must be plugged into a three-hole electrical outlet or grounded extension cord. If using an adapter to aid in accommodating a two hole receptacle, ground using a screw to a known ground.
6. Avoid dangerous environments. Do not operate this machine in wet or flame environments. Airborne dust particles could cause an explosion and severe fire hazard.
7. Make sure switch is in the "OFF" position before connecting power to machine.
8. Keep children and visitors away. All visitors should be kept a safe distance away while operating unit.
9. Childproof workshop with padlocks, master switch or by removing starter keys.
10. Disconnect machine when cleaning, adjusting or servicing.
11. Do not force tool. The machine will do a safer and better job at the rate for which it was designed.
12. Use correct tool. Do not force machine or attachment to do a job for which it was not designed.
13. Wear proper apparel. Do not wear loose clothing, neck ties, gloves, jewelry, etc.
14. Remove adjusting keys and wrenches. Before turning the machine on, make it a habit to check that all adjusting keys and wrenches have been removed.
15. Do not leave machine unattended. Wait until it comes to a complete stop before leaving the area.
16. Do not use dust collector for anything except wood dust. Material such as liquids, metal shavings, metal dust, screw, glass, plastic or rock can cause sparks when coming into contact with any part of the collection system.
17. Do not place your hands, lumber or tools near inlet opening while machine is running or connected to power.
18. Always wear a respirator and safety glasses when removing, emptying or replacing collection bags. Secure bags tightly to dust collector to avoid bags from "blowing off".

WIRING DIAGRAM (120V/60Hz, 1 phase)

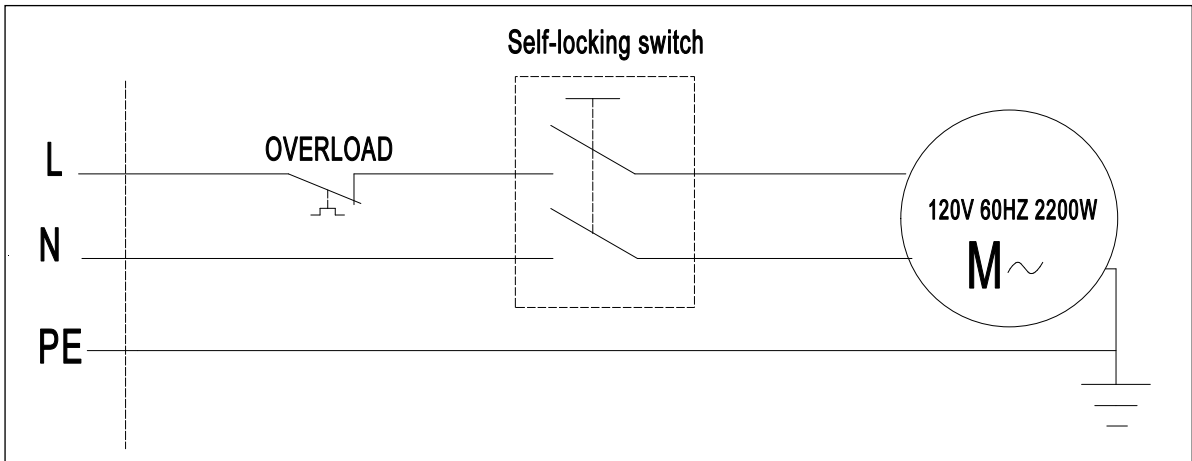

PARTS DIAGRAM

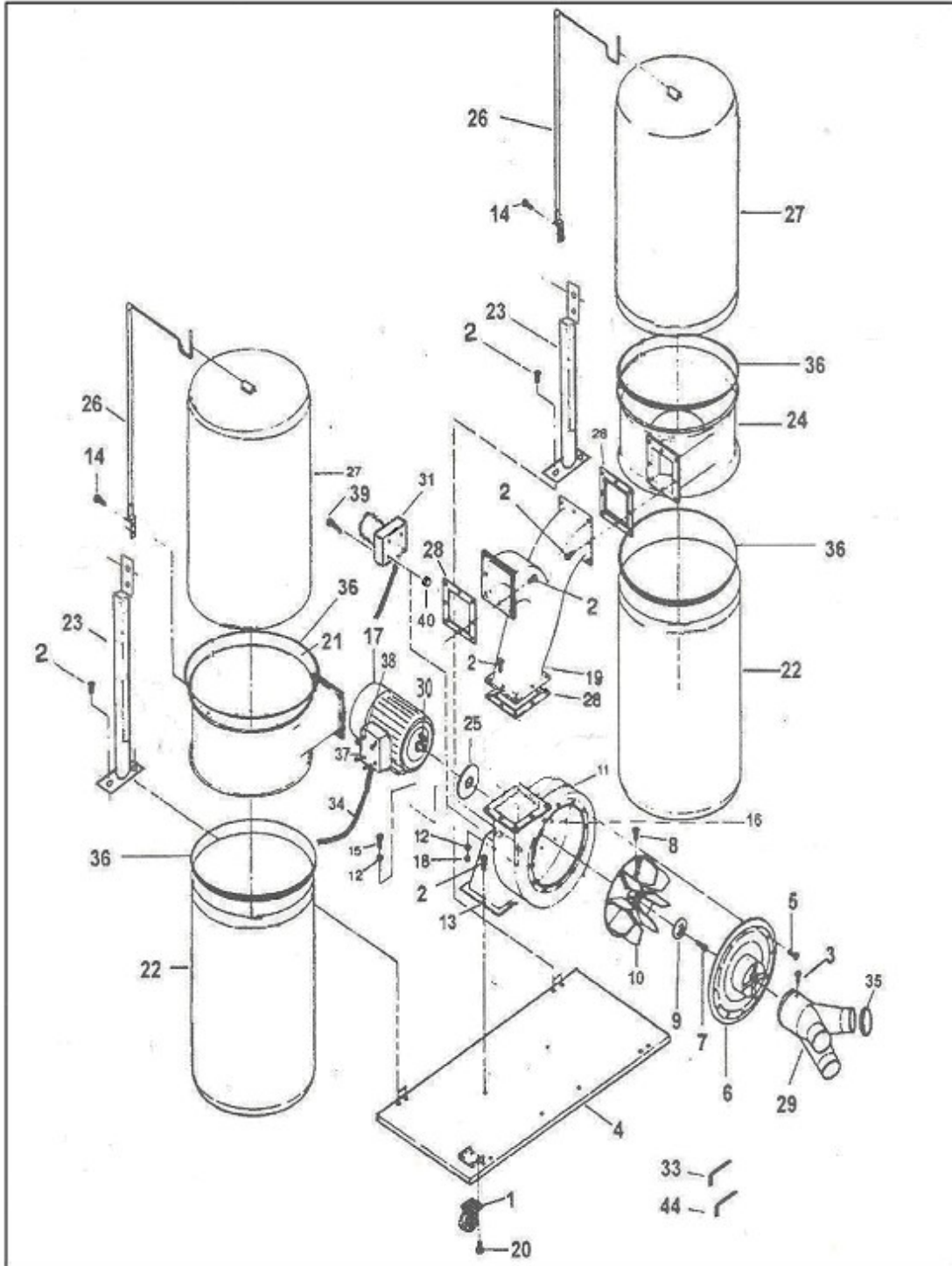

PARTS LIST

Part No.	Description	Part No.	Description
1	CASTER	23	COLLECTOR SUPPORT
2	SCREW	24	RIGHT-COLLECTOR
3	SCREW	25	WASHER
4	BASE PLATE	26	UPPER BAG SUPPORT
5	SCREW	27	FILTER BAG
6	INLET	28	PACKING
7	SCREW	29	INLET
8	SCREW HEX	30	KEY
9	WASHER	31	SWITCH
10	TURBO FAN	33	WRENCH HEX
11	COLLECTOR	34	CABLE
12	WASHER	35	CAP
13	MOTOR BASE	36	BAG CLAMP
14	SCREW HEX	37	SWITCH BOX
15	SCREW HEX	38	HEAD SCREW
16	BOLT	39	SCREW
17	MOTOR	44	WRENCH
18	NUT		
19	CONNECTOR		
20	SCREW		
21	LEFT-COLLECTOR		
22	COLLECTOR BAG		

Certificate of Compliance

Certificate: 1079145

Master Contract: 184841

Project: 1694428

Date Issued: February 15, 2006

Issued to: **Shandong Laizhou Light Industry Machine Factory**
989 Laizhou North Rd.
Laizhou
Shandong 261400
CHINA
Attention: Mr. Jing-Dong Zhang

The products listed below are eligible to bear the CSA Mark shown with adjacent indicators 'C' and 'US'

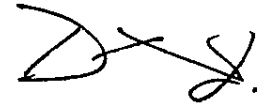

Issued by: Dominic Ng, P. Eng.
Advanced Authorization

Authorized by: Fred Mark, P. Eng.
Area Director, Asia

PRODUCTS

CLASS 1611 01 - CLEANING MACHINES

CLASS 1611 81 - CLEANING MACHINES - CERTIFIED TO U.S. STANDARDS

Dust collectors, commercial, cord connected, grounded,

PART A - Model FM300S, rated 120Vac, 60Hz, 16A or 240Vac, 60Hz, 7.8A

PART B - Model FM300, rated 120Vac, 60Hz, 16A, or 240Vac, 60Hz, 7.8A.

PART C - Models FM230, KC2015C, rated 120Vac, 60Hz, 7.4A

For details related to rating, size, configuration, etc. reference should be made to the CSA Certification Record or the descriptive report.

APPLICABLE REQUIREMENTS

CAN/CSA-C22.2 No. 243-01- 3rd Edition - Vacuum Cleaners and Blower Cleaners

UL Std No. 1017-7th Edition - Electric Vacuum Cleaning Machines and Blower Cleaners

The 'C' and 'US' indicators adjacent to the CSA Mark signify that the product has been evaluated to the applicable CSA and ANSI/UL Standards, for use in Canada and the U.S., respectively. This 'US' indicator includes products eligible to bear the 'NRTL' indicator. NRTL, i.e. National Recognized Testing Laboratory, is a designation granted by the U.S. Occupational Safety and Health Administration (OSHA) to laboratories which have been recognized to perform certification to U.S. Standards 107914 December 1, 2001 84841 694428

Certificate of Compliance

Certificate: 1079145

Master Contract: 184841

Project: 2408188

Date Issued: March 18, 2011

Issued to: **Laizhou Planet Machinery Co., Ltd**
Yutai West Street
Laizhou
Shandong 261400
CHINA
Attention: Mr. Jing-Dong Zhang

The products listed below are eligible to bear the CSA Mark shown with adjacent indicators 'C' and 'US' for Canada and US or with adjacent indicator 'US' for US only or without either indicator for Canada only



Issued by: *Ramos Tao*
Ramos Tao

PRODUCTS

CLASS 1611 01 - CLEANING MACHINES

CLASS 1611 81 - CLEANING MACHINES - CERTIFIED TO U.S. STANDARDS

Dust collectors, commercial, cord connected, grounded, models FM230, FM230M, FM300, FM300S, KC2105C.

For details related to rating, size, configuration, etc. reference should be made to the CSA Certification Record or the descriptive report.

APPLICABLE REQUIREMENTS

CAN/CSA-C22.2 No. 243-01

UL Std No.1017-7th Edition

- Vacuum Cleaners and Blower Cleaners
- Electric Vacuum Cleaning Machines and Blower Cleaners



Supplement to Certificate of Compliance

Certificate: 1079145

Master Contract: 184841

*The products listed, including the latest revision described below,
are eligible to be marked in accordance with the referenced Certificate.*

Product Certification History

Project	Date	Description
2408188	March 18, 2011	Corrected FM230 rating from 9.5A to 7.4A and FM300S and FM300 rating from 7.8A to 9.5A.
2331681	Aug. 19, 2010	Added new model FM230M.
1694428	Feb. 20, 2006	Added Model KC2105C, Added alternate 240Vac motor to Models FM300 and FM300S.
1470519	Sept. 5, 2003	Added alternate impeller with 1 vane less
1079145	April 28, 2000	Original Certification. Models FM230, FM300, FM300S.