

**FORM 2484  
LT15W BED EXTENSION INSTRUCTIONS**

**Part No. LT15BSW**

REF	DESCRIPTION	PART #	QTY.	
	<b>BED ASSEMBLY, LT15 - 6'8" BED EXT, WIDE</b>	LT15BSW	1	
	Outrigger Wldmt, LT15	046615	4	
	Splice Assy, Pinned Bed Rail	016170	2	
	Bag Assy, LT15BSW Hardware	074296	1	
	Bolt, 3/8-16x1 HH Gr5	F05007-87	4	
	Bolt, 1/2-13x5 HHC Gr5	F05008-66	4	
	Nut, 1/2-13 Nyl Hex Lock	F05010-8	4	
	Nut, 7/8-9 Free	F05010-136	4	
	Nut, 7/8-9 Square Zinc	F05010-186	4	
	Inst Sheet, LT15W Bed Extension	LT15BSW-2484	1	



**WARNING!** If adding to an LT15 sawmill, turn the key switch to the OFF (0) position and remove the key prior to performing service near moving parts such as blades, pulleys, motors, belts, or chains.

**Unpack Parts**

1. Check your LT15BSW as soon as it is received. Report any transport damage to Wood-Mizer and shipping agent immediately.
2. Remove shipping straps/crating on flat, level surface.
3. Check for any missing components.

**Leg Assembly**

1. Place a hex nut on each leg approximately half way down the shaft.
2. Slide the outrigger (nut keeper) plate into the mounting bracket.
3. Position the square nut between the plate and the bracket.
4. Thread each leg through the bracket, the square nut, and the plate. (See FIG. 1-1.)
5. Finger tighten the hex nut around the leg bracket.
6. Assemble four legs to the bed section.

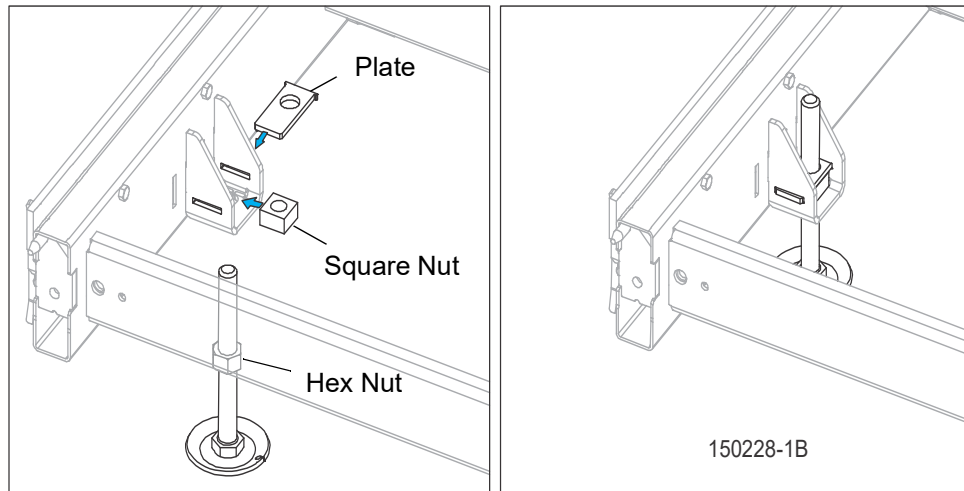
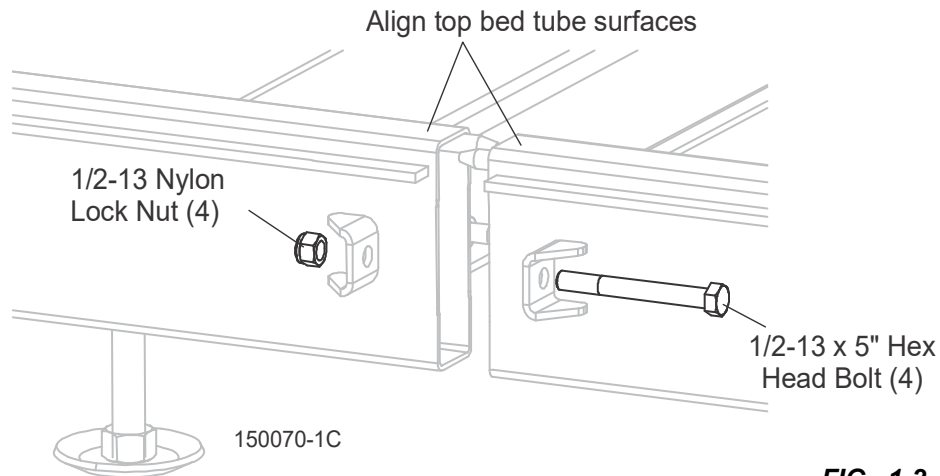

**FIG. 1-1**

### Bed Section Assembly

**MULTIPLE LT15BSW BED EXTENSION SEGMENTS CAN BE LINKED TOGETHER AND/OR CAN BE USED TO LENGTHEN THE LT15WIDE SAWMILL BED. FOLLOW THE INSTRUCTIONS IN THIS SECTION TO ASSEMBLE MULTIPLE SEGMENTS.**

1. Lay the bed sections end-to-end so the track portion of each section is on the same side.
2. Slide the sections together and secure with four 1/2-13 x 5" hex head bolts and nylon lock nuts.



**FIG. 1-2**

3. Insert the splice pins into the holes in the track rail and secure with two 3/8-16 x 1" hex head bolts

**NOTE:** Make sure the top surfaces of the outer side of the bed sections are aligned. It may be necessary to pry one bed section up or down until the surfaces are aligned, then tighten the bolts.

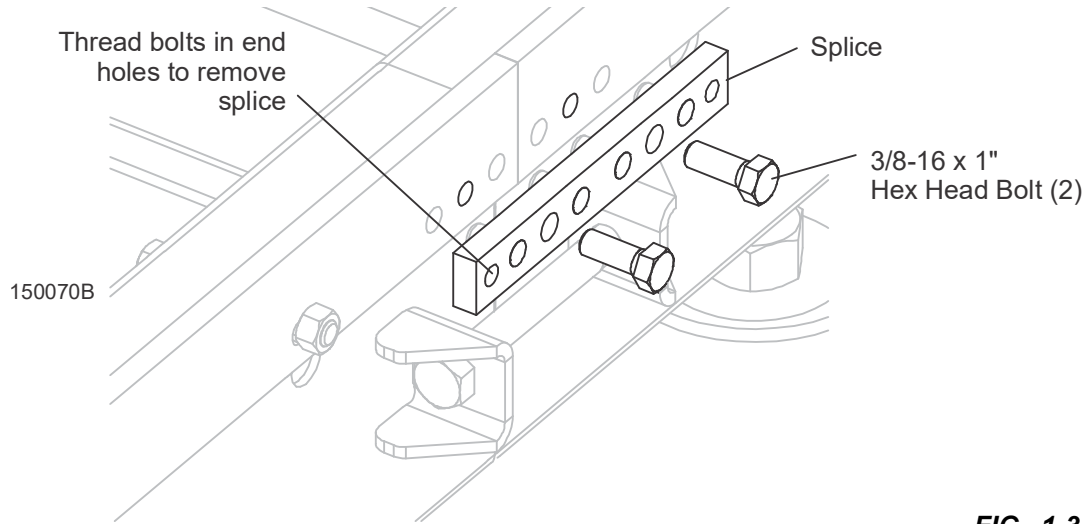

FIG. 1-3

**NOTE:** The threaded holes at the end of the splice are provided to help remove the splice if you wish to disassemble the bed sections. Remove the two splice bolts from the middle holes and thread into the end holes. Evenly turn the bolts clockwise to push the splice pins out of the track rail holes.

## Frame Leg Adjustment

Use a 1 1/4" wrench to adjust each leg until the top of the leg is approximately 1" (25mm) below the bed tube.

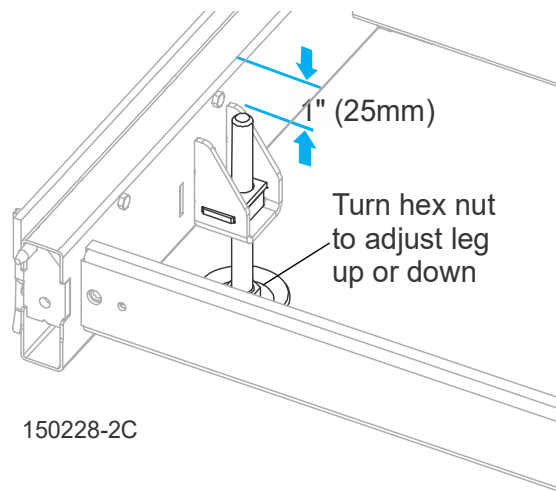
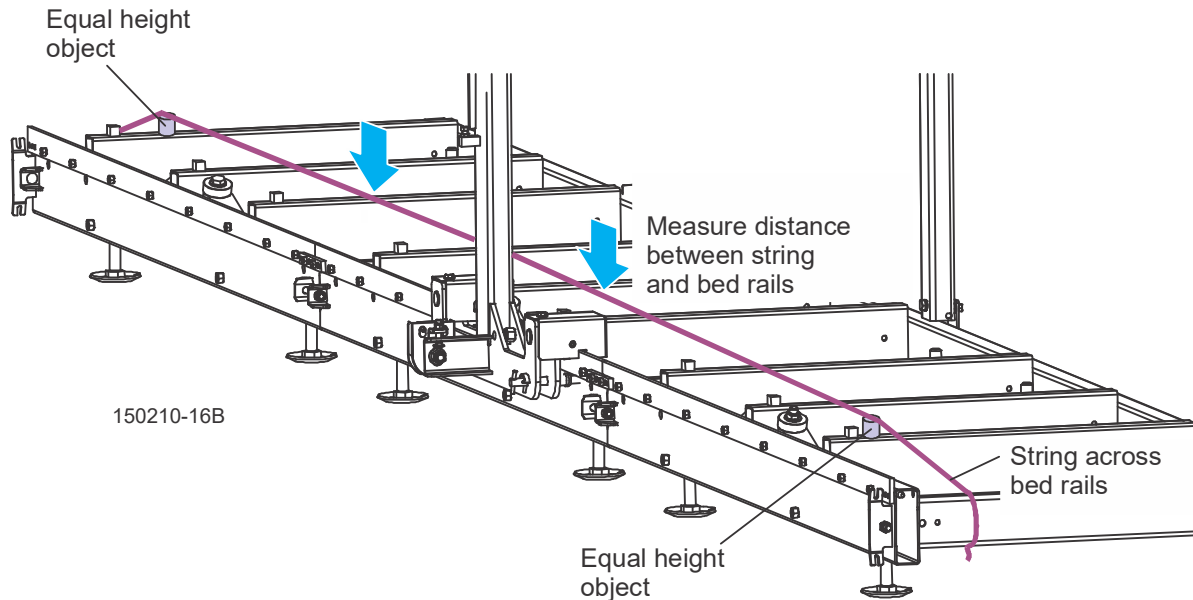

FIG. 1-4

## Leveling the Log Bed

1. Adjust the frame legs so the bed appears level. If bed is on soft ground, use shims under the legs if necessary.
2. Run a string from the front bed rail to the rear bed rail near the operator's side of the frame.
3. Place spacer objects of equal height between the string and the front and rear bed rails.
4. Measure the distance between the string and the other bed rails.
5. Adjust the frame legs until all bed rails measure the same distance from the string.
6. Repeat the bed rail adjustment with the string at the other side of the frame.



**FIG. 1-5**

7. Tighten the hex nut around each leg bracket with a 1 5/16" wrench.